



THOR EQUITIES

Last-mile opportunity
Cross Dock Building

4219

Richmond Street
Philadelphia, PA



Property Specifications

63,200

square feet

6.10

acres

188

auto parking spots

16'

clear height

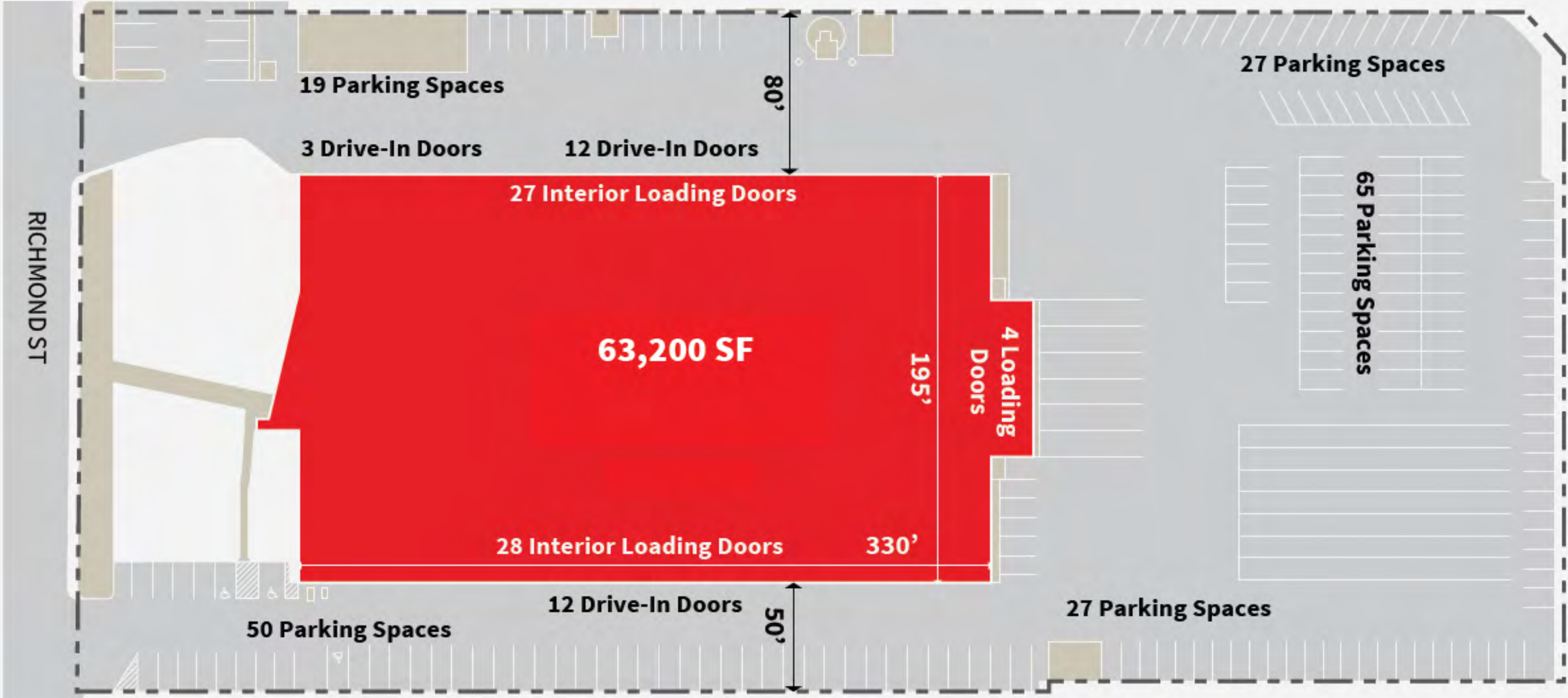

Building dimensions 330' x 195'

Truck court depth 50' - 80'

Dock doors 4 External
55 Internal

Trailer parking 7

Zoning ICMX

HVAC Fully Air Conditioned
(installed 2019-2020)

FLOOR PLAN

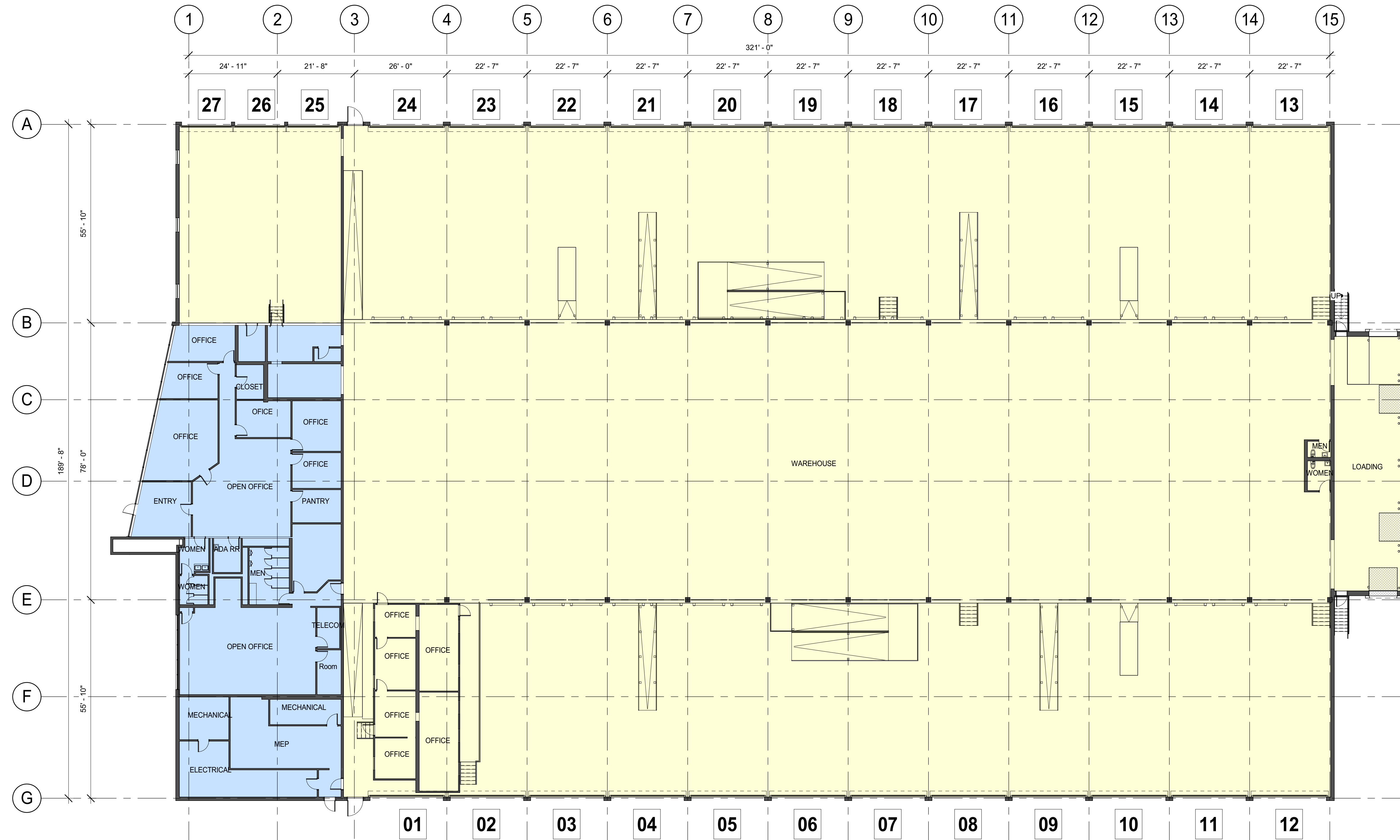

INTERIOR AXON

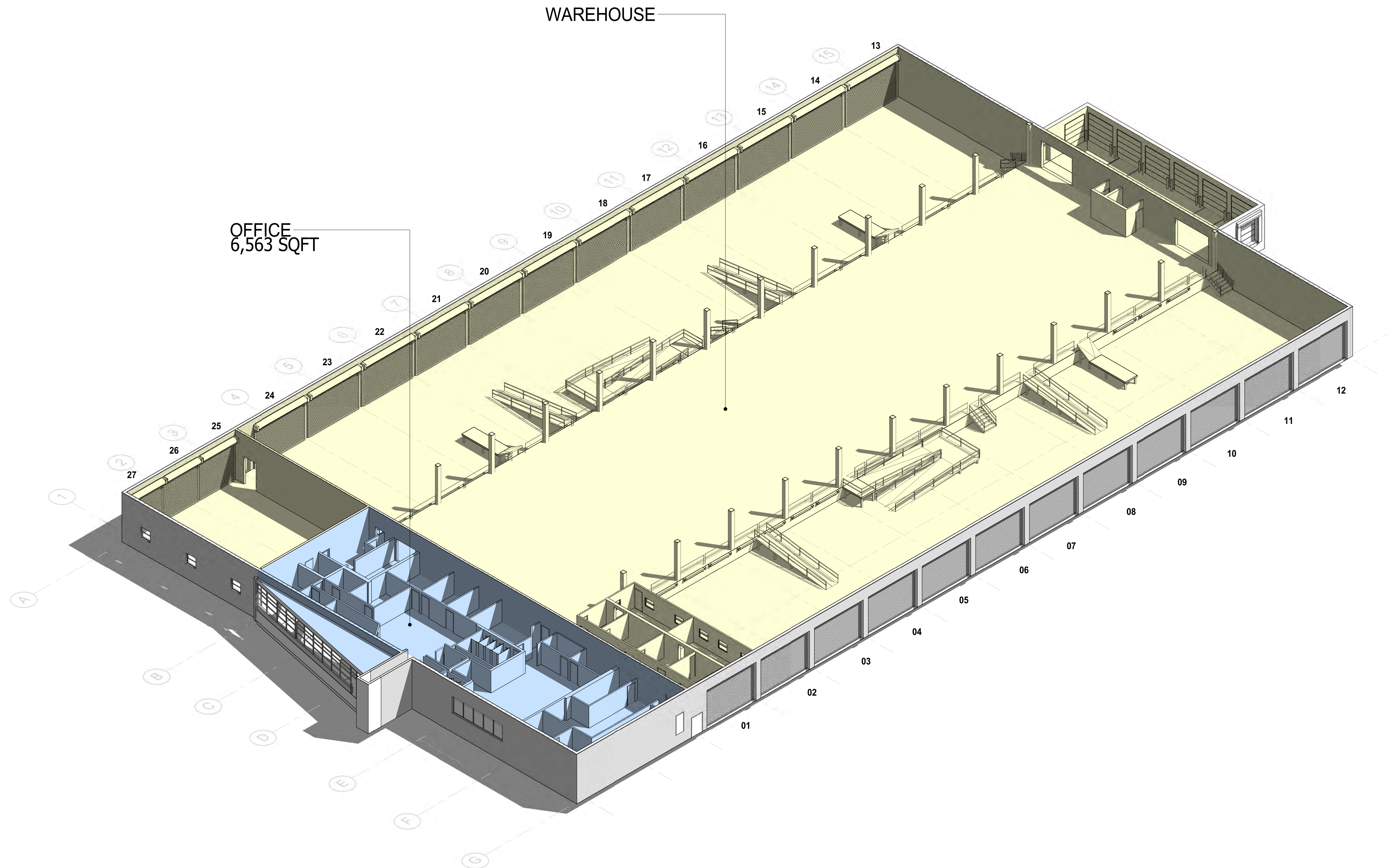

Location & Population



1,883,737

population within a 25-minute drive

\$50.7B

annual budget expenditures with a 25-minute drive

immediate proximity to

I-95

proximity to regional parcel

**Philadelphia
International Airport
& PhilaPort**

Public Transportation

to the site

Distance

Distances to Cities

Philadelphia, PA	7	20 min.
New York, NY	88	1 hour 35 min.
Baltimore, MD	108	2 hours
Washington, D.C.	142	2 hours 43 min.
Boston, MA	311	5 hours 11 min.

Distances to Ports

Port of Philadelphia Tioga Marine Terminal	2	5 min.
Port of Philadelphia Packer Ave. Marine Terminal	10	16 min.
Port of Wilmington	36	45 min.
Port of NY/NJ	89	1 hour 37 min.
Ports of Baltimore	108	1 hour 57 min.

Distances to Intermodal

CSX Philadelphia	10	18 min.
Norfolk Southern	20	27 min.

Distance (miles) Drive Time (hours)

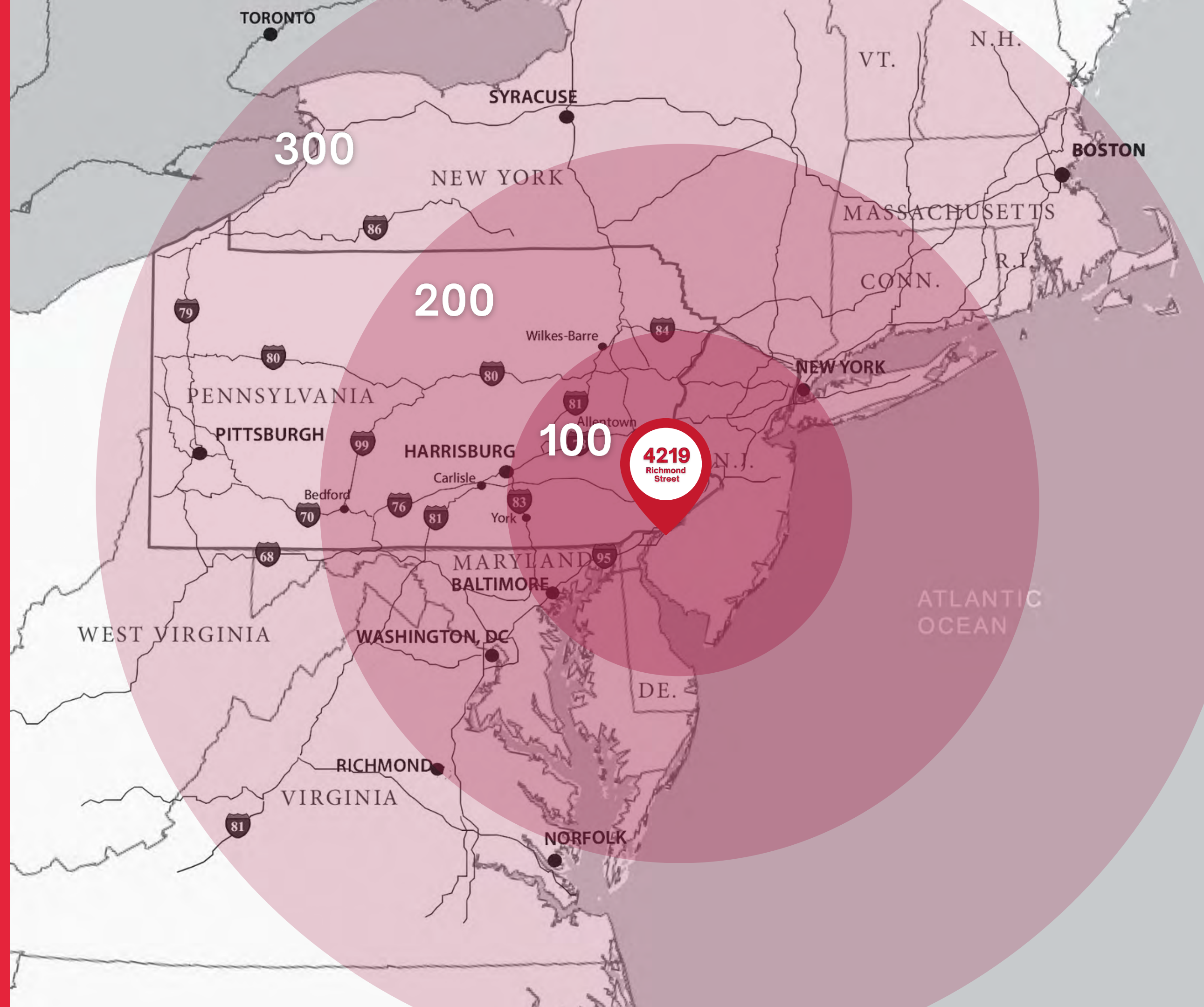



Contact:
Sam Sabin
212-529-7413
ssabin@thorequities.com



THOR EQUITIES