



New Industrial Space

AVAILABLE

- 12,800± SF to 77,500± SF (multiple SF options available)
 - Office Area built to suit
- Site Work to begin Q3 2023

SITE FEATURES

- 4.9995 Acres
- Planned Community Zone District (PC)
- Fenced Truck Courts

FEATURES

- Concrete Tilt Construction
- 28' Clear Height
- 40' x 40' Column Spacing
- ESFR Fire Suppression
- Dock and Drive-In Access (Cross Dock)

The information contained herein is believed to be reliable, however Johnson Commercial Real Estate LC makes no warranty, representation or guarantee as to its accuracy. Interested parties should conduct its own investigations to determine the suitability of its intended use for the property.

FOR LEASE

5550 Turing Dr SE

Albuquerque, NM 87106

Located at the NEC of Turing & Fritts Crossing in Mesa del Sol

CONTACT

Erick Johnson, CCIM, SIOR
NM Lic. 19234
Mobile (505) 710-8501
erick@jcrenm.com



4811 Hardware Dr NW, Suite C-5, Albuquerque, NM 87109



Aerial View



CONTACT
Erick Johnson, CCIM, SIOR
NM Lic. 19234
Mobile (505) 710-8501
erick@jcrenm.com

**JOHNSON**
Commercial Real Estate
(505) 831-3333 ■ jcrenm.com



Site Plan

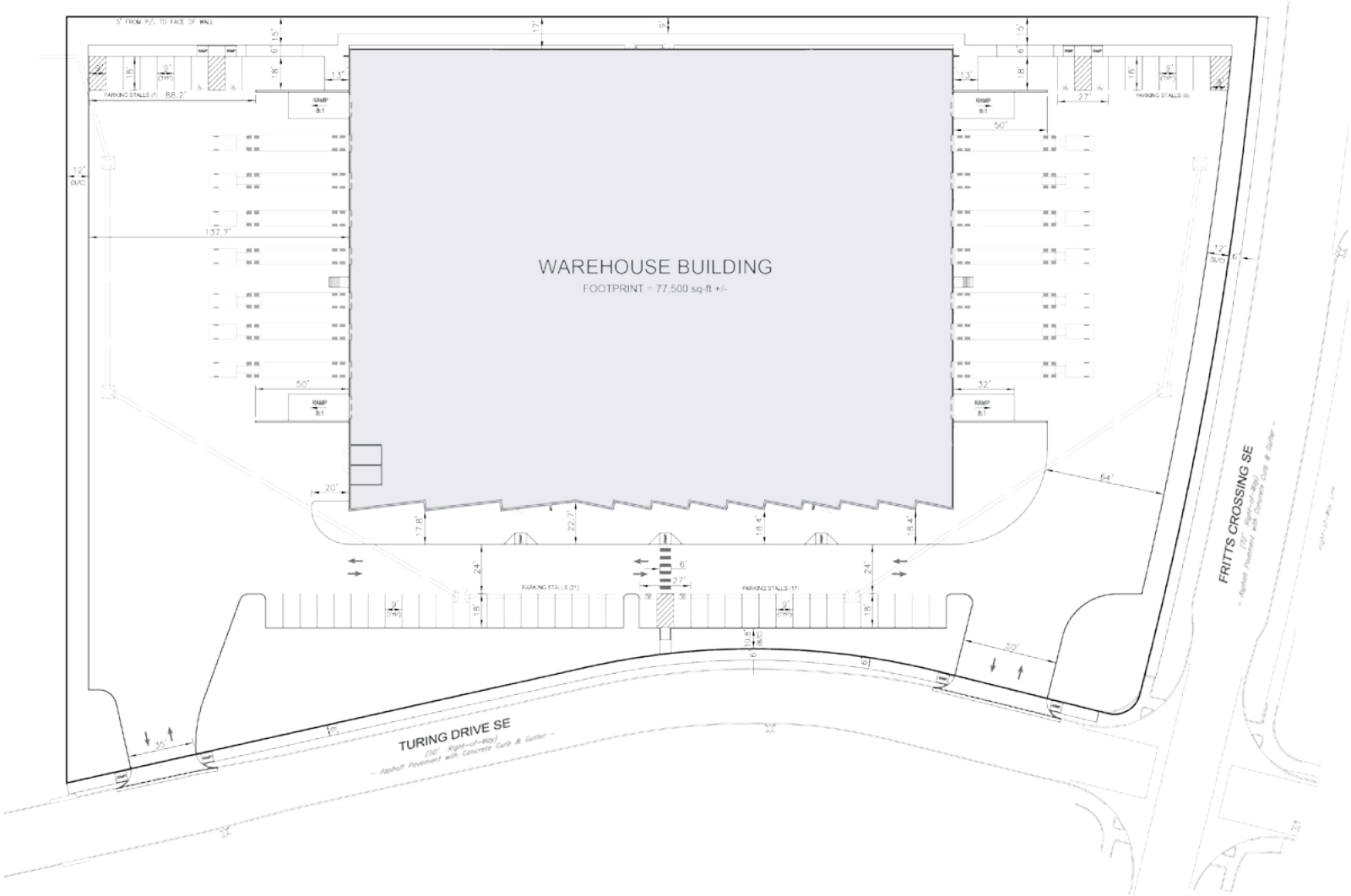

CONTACT
Erick Johnson, CCIM, SIOR
 NM Lic. 19234
 Mobile (505) 710-8501
 erick@jcrenm.com

JOHNSON
 Commercial Real Estate
 (505) 831-3333 ■ jcrenm.com



Shell Floor Plan

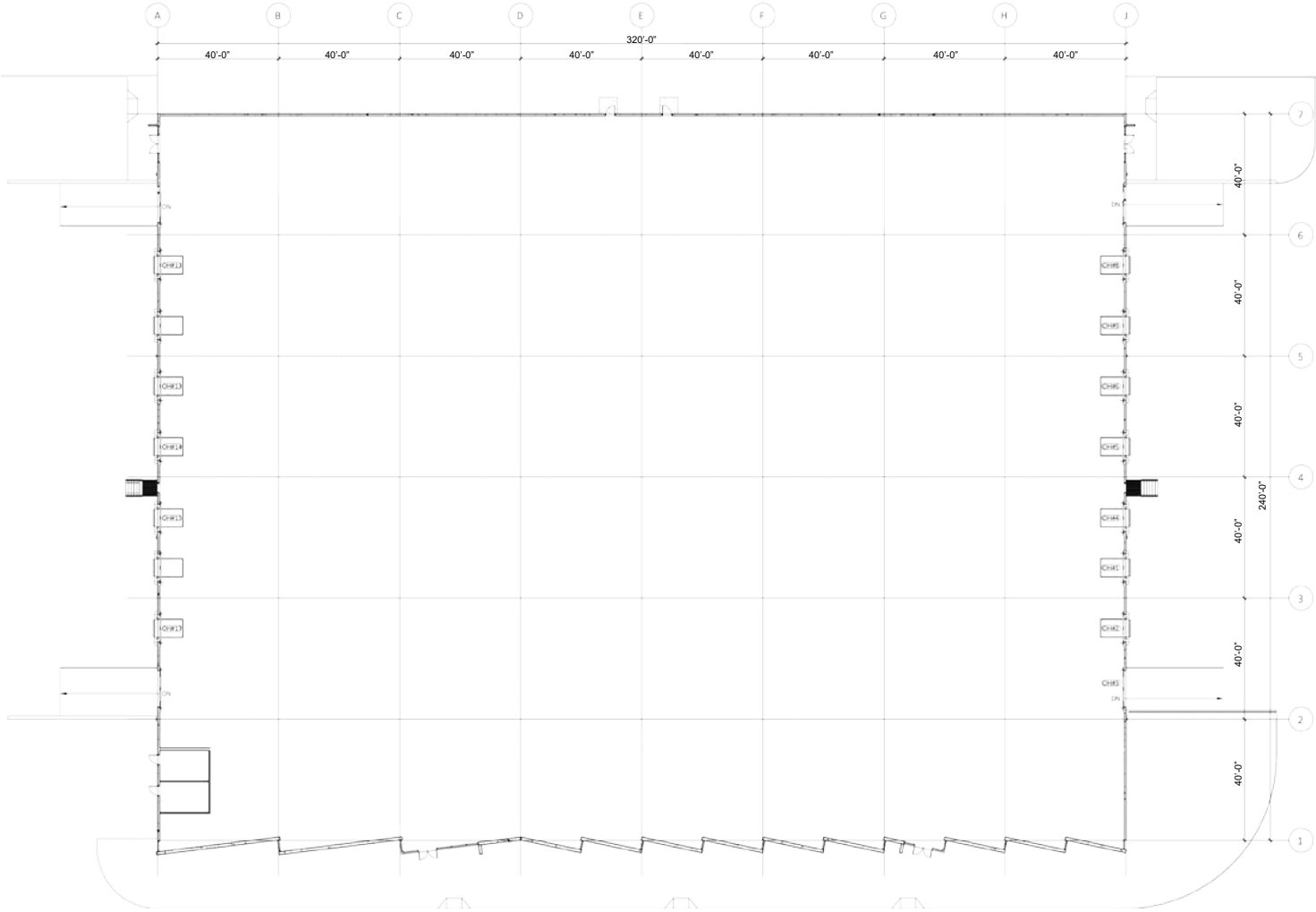

CONTACT
Erick Johnson, CCIM, SIOR
 NM Lic. 19234
 Mobile (505) 710-8501
 erick@jcrenm.com





Architectural Renderings



Daytime Architectural Rendering



Nighttime Architectural Rendering