



**F.C. Tucker
Commercial**

AVAILABLE
1800 Lynch Road
EVANSVILLE, IN 47711



- **Lease Price:** \$4.95 / NNN
- **Available SF:** 51,398 SF
 - Warehouse SF: 48,282 SF
 - Office SF: 3,116 SF
- **Lot Size:** 7.254 Acres +/-
- **Year Built:** 1986
- **Zoning:** M-2
- **Ceiling Height:** 18' - 20' Clear Varies
- **Drive-in Doors:** 1
- **Docks:** 5
- **Silos :** 6 80,000 lbs each
- **# of Parking Spaces:** 23 +Trailer Storage
- **Ext. Construction:** Steel

- **Roof:** Membrane/Steel
- **Floor:** Concrete
- **Interior Walls:** Frame/Steel
- **Sprinkler:** Wet
- **Electrical:** Heavy Electric 480, 3-Phase
- **# of Restrooms:** 2
- **Water/Sewer:** City
- **Current Use:** Manufacturing
- **Taxes:** \$19,673.72 (2024 Pay 2025)
- **Showing:** Contact Listing Broker
- **Location:** East of Highway 41
- **Adjacent Property:** 1700 Lynch Road
- **Additionally Available:** 141,333 SF

For More Information, Contact:

Aaron Kendall, CCIM

Direct: 812.480.8100

Office: 812.473.6677

AK@fcte.com

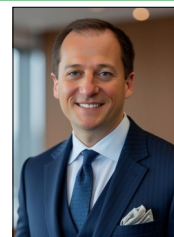

7820 Eagle Crest Blvd. Suite 200
Evansville, IN • 47715
812-473-6677 • Fax: 812-473-6684



FCTuckerCommercial.com

The information contained herein was obtained from sources we consider reliable. We cannot be responsible, however, for errors, omissions, prior sale, and withdrawal from the market or change in price.

AVAILABLE
1800 Lynch Road
EVANSVILLE, IN 47711

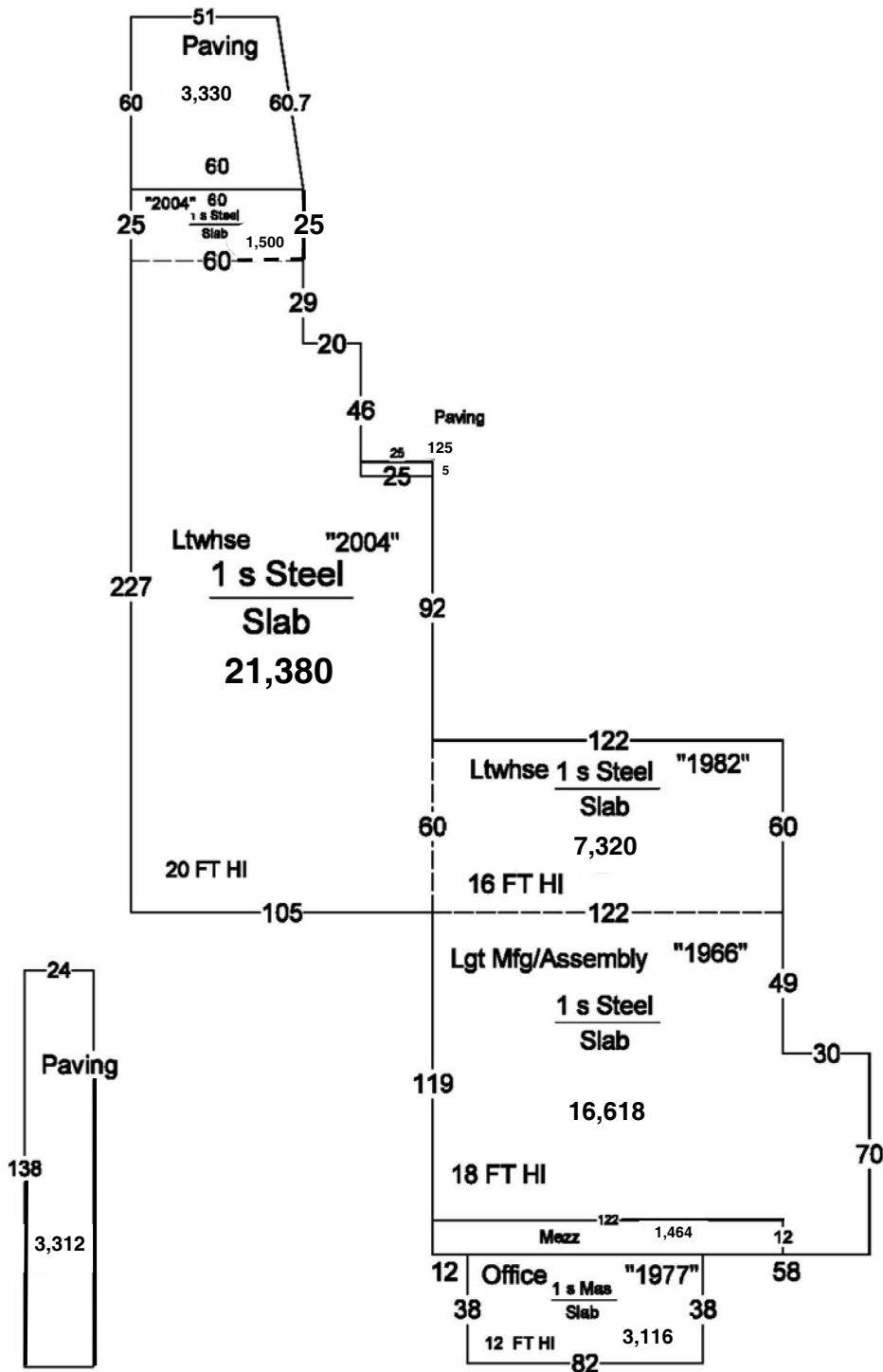

For More Information, Contact:

Aaron Kendall, CCIM

Direct: 812.480.8100

Office: 812.473.6677

AK@fcte.com

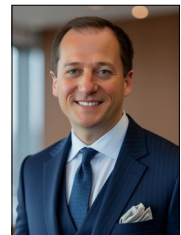

7820 Eagle Crest Blvd. Suite 200
Evansville, IN • 47715
812-473-6677 • Fax: 812-473-6684



FCTuckerCommercial.com

The information contained herein was obtained from sources we consider reliable. We cannot be responsible, however, for errors, omissions, prior sale, and withdrawal from the market or change in price.