

# ±9,912 SF FOR SALE OR LEASE

10675 San Sevaine Way

Jurupa Valley, California



## FEATURES

- Excellent Owner-User Opportunity
- Great Business Park Environment
- ±730 SF of First Floor Office Space
- ±930 SF of Mezzanine Office Space
- 1 Ground Level Door
- 22' Minimum Warehouse Clearance
- .45 gpm/2,000 SF Sprinkler System
- Warehouse Lighting
- Foil Insulated Warehouse Ceiling
- Excellent Access to 60, I-10, and I-15 Freeways



For Further Information, Please Contact:

**NEWMARK**

DEAN WASHLE

d 909-974-4027

dean.washle@nmrk.com

CA RE Lic. #01396224

# ±9,912 SF FOR SALE OR LEASE

10675 San Sevaine Way

Jurupa Valley, California

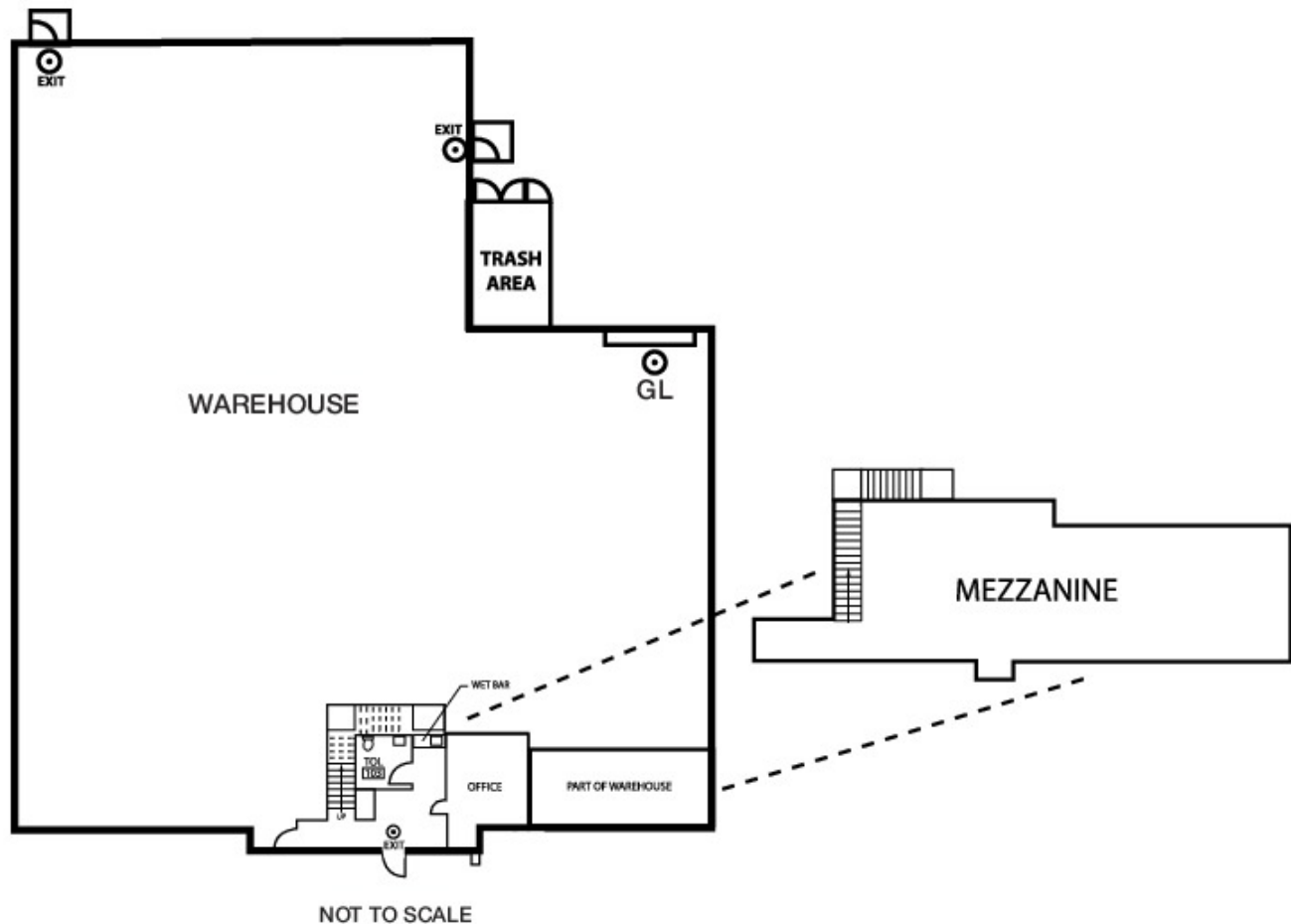



# ±9,912 SF FOR SALE OR LEASE

10675 San Sevaine Way

Jurupa Valley, California



3281 East Guasti Road, Suite 370 | Ontario, CA 91761 | Corporate RE Lic. #01355491 | [www.nmrk.com](http://www.nmrk.com)  
Although all information furnished regarding property for sale, rental, or financing is from sources deemed reliable, such information has not been verified and no express representation is made nor is any to be implied as to the accuracy thereof and it is submitted subject to errors, omissions, change of price, rental or other conditions, prior sale, lease or financing, or withdrawal without notice and to any special conditions imposed by our principal.

**NEWMARK**

DEAN WASHLE

d 909-974-4027

[dean.washle@nmrk.com](mailto:dean.washle@nmrk.com)

CA RE Lic. #01396224