

FOR LEASE

HEAVY INDUSTRIAL YARD

2637 CLEMENTS FERRY RD
& 615 KLISTER LN
CHARLESTON, SC

- » 4.3 ACRES AVAILABLE
- » TRAILER PARKING
- » LAYDOWN YARD
- » EQUIPMENT STORAGE

CBRE



2637 CLEMENTS FERRY ROAD

MULTI-USE GRAVEL YARD

2.00 ACRES

AVAILABLE

\$7,500

ASKING RATE
ACRE/MONTH

NNN

TYPE

HEAVY INDUSTRIAL

ZONING

FENCED & SECURE

DELIVERY CONDITION



SITE PLAN

2637 CLEMENTS FERRY ROAD

**2.00 ACRES
AVAILABLE**

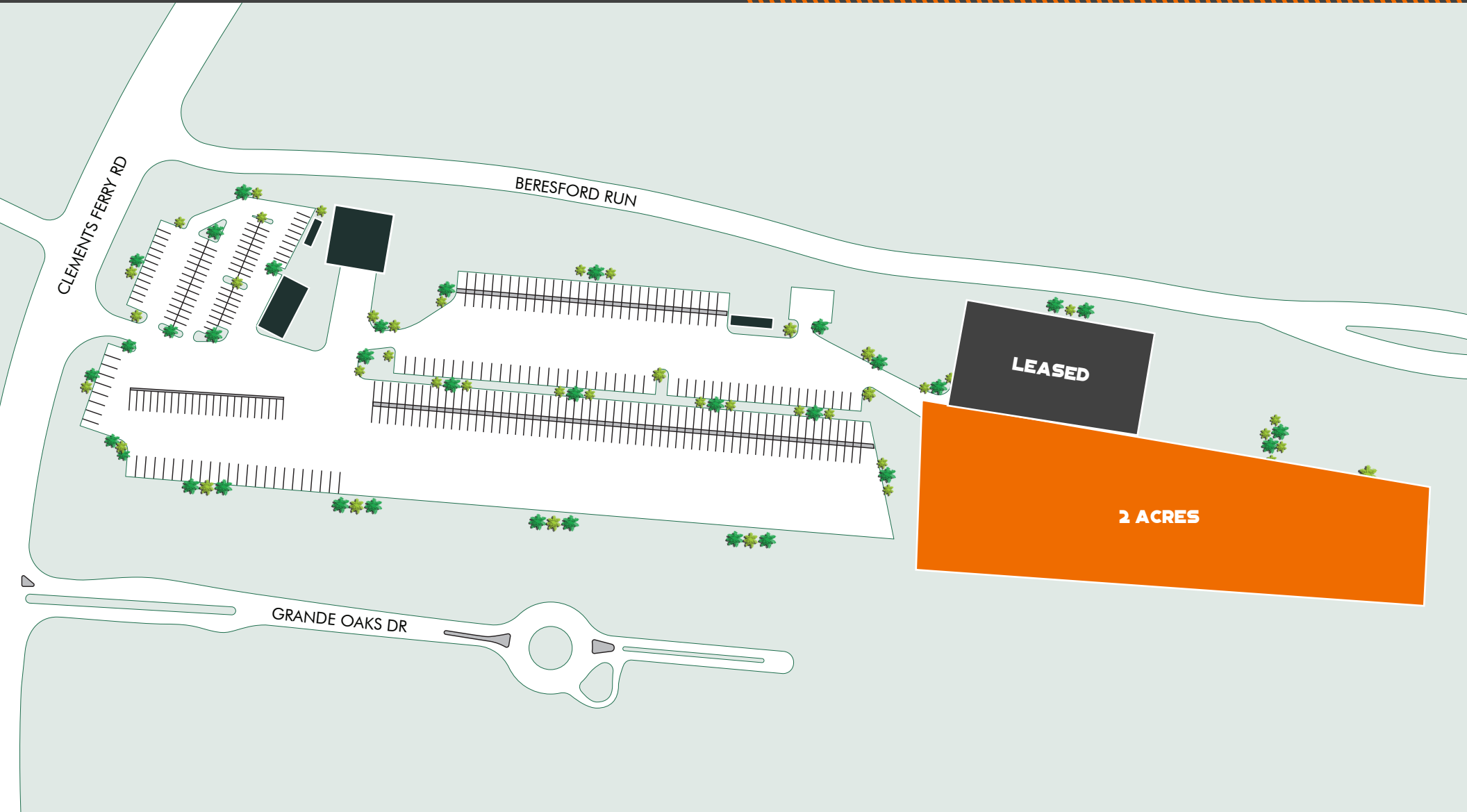

615 KLISTER LANE

MULTI-USE GRAVEL YARD

615 Klister Ln

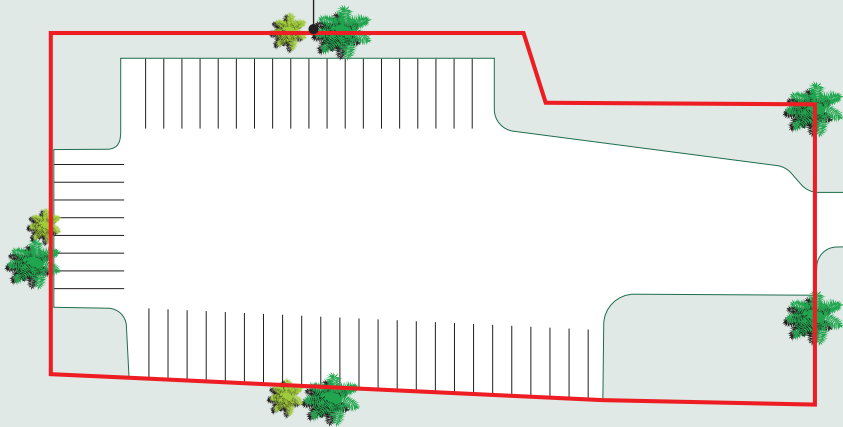

KLISTER LN

2.30 ACRES
AVAILABLE

2/1/2026
AVAILABILITY

TURN KEY
YARD

FENCED & SECURE
DELIVERY CONDITION

SITE PLAN

2637 CLEMENTS FERRY ROAD
& 615 KLISTER LANE

**4.30 ACRES
AVAILABLE**

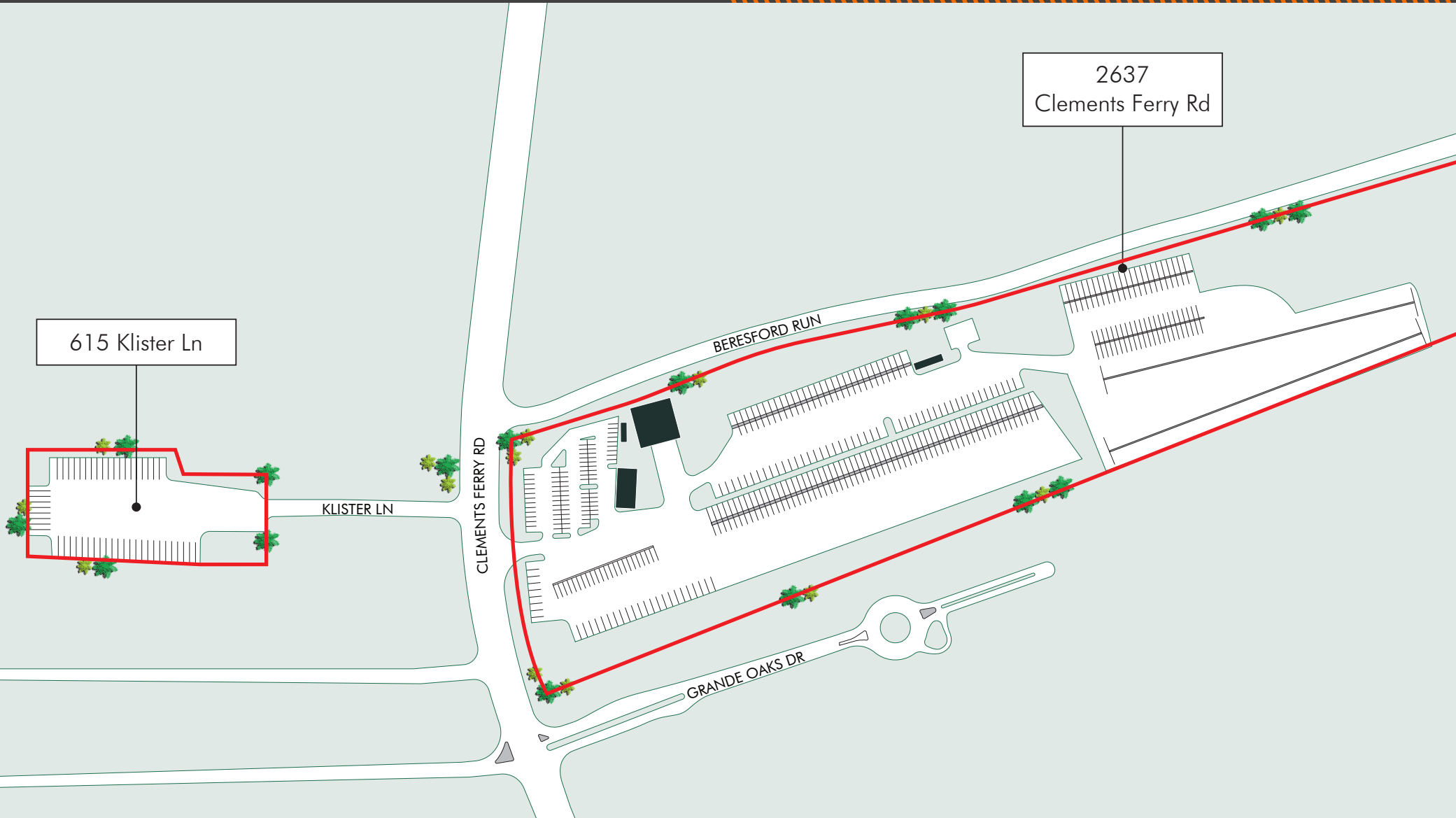



CHARLESTON
INTERNATIONAL AIRPORT

9.4 MILES
14 MINS



7.2 MILES
12 MINS

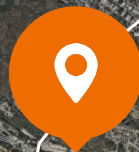

10.7 MILES
18 MINS



14.9 MILES
22 MINS



7.4 MILES
12 MINS



CONTACT

TIM RABER, SIOR

Vice President

+1 843 972 3220

tim.raber@cbre.com

BRENDAN REDEYOFF, SIOR

Senior Vice President

+1 843 793 8839

brendan.redeyoff@cbre.com

BOB BARRINEAU

Senior Vice President

+1 843 270 7851

robert.barrineau@cbre.com

INTERSTATE 526

0.8 MILES | 2 MINUTES

INTERSTATE 26

6.8 MILES | 9 MINUTES

© 2025 CBRE, Inc. All rights reserved. This information has been obtained from sources believed reliable but has not been verified for accuracy or completeness. CBRE, Inc. makes no guarantee, representation or warranty and accepts no responsibility or liability as to the accuracy, completeness, or reliability of the information contained herein. You should conduct a careful, independent investigation of the property and verify all information. Any reliance on this information is solely at your own risk. CBRE and the CBRE logo are service marks of CBRE, Inc. All other marks displayed on this document are the property of their respective owners, and the use of such marks does not imply any affiliation with or endorsement of CBRE. Photos herein are the property of their respective owners. Use of these images without the express written consent of the owner is prohibited.

CBRE