



For Lease

# Alberta Park

11425 163 Street | Edmonton, AB

±6,043 SF Dock loading warehouse

- Showroom and warehouse space with ongoing building improvements
- 163 Street exposure with close proximity to Yellowhead Highway and Anthony Henday

For more information contact:

**Kent Simpson**

Vice President

780 203 0425

[Kent.Simpson@jll.com](mailto:Kent.Simpson@jll.com)

**Bronwyn Scrivens**

Vice President, SIOR

780 807 4564

[Bronwyn.Scrivens@jll.com](mailto:Bronwyn.Scrivens@jll.com)

 **JLL** SEE A BRIGHTER WAY

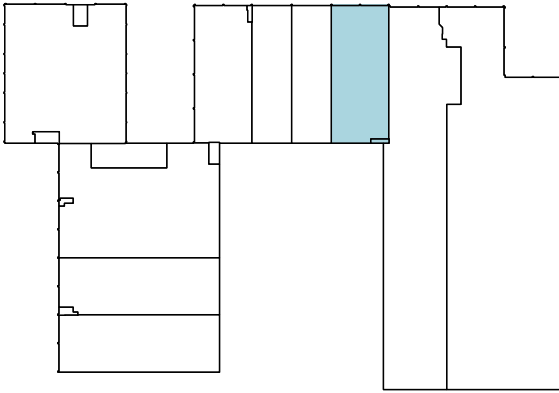

# Property Details

<b>Municipal Address</b>	11425 163 Street
<b>Available Area</b>	Showroom: ±1,788 SF Warehouse: ±4,255 SF Total: ±6,043 SF
<b>Zoning</b>	IB - Business Industrial
<b>Year Built</b>	1981
<b>Power</b>	600 Amp (TBC by tenant)
<b>Ceiling Height</b>	22' Clear
<b>Heating</b>	HVAC Forced air
<b>Lighting</b>	LED
<b>Loading</b>	(1) Dock loading
<b>Parking</b>	Scramble
<b>Lease Rate (PSF)</b>	\$9.50
<b>Op. Costs (PSF)</b>	\$5.98
<b>Occupancy</b>	March 1, 2025

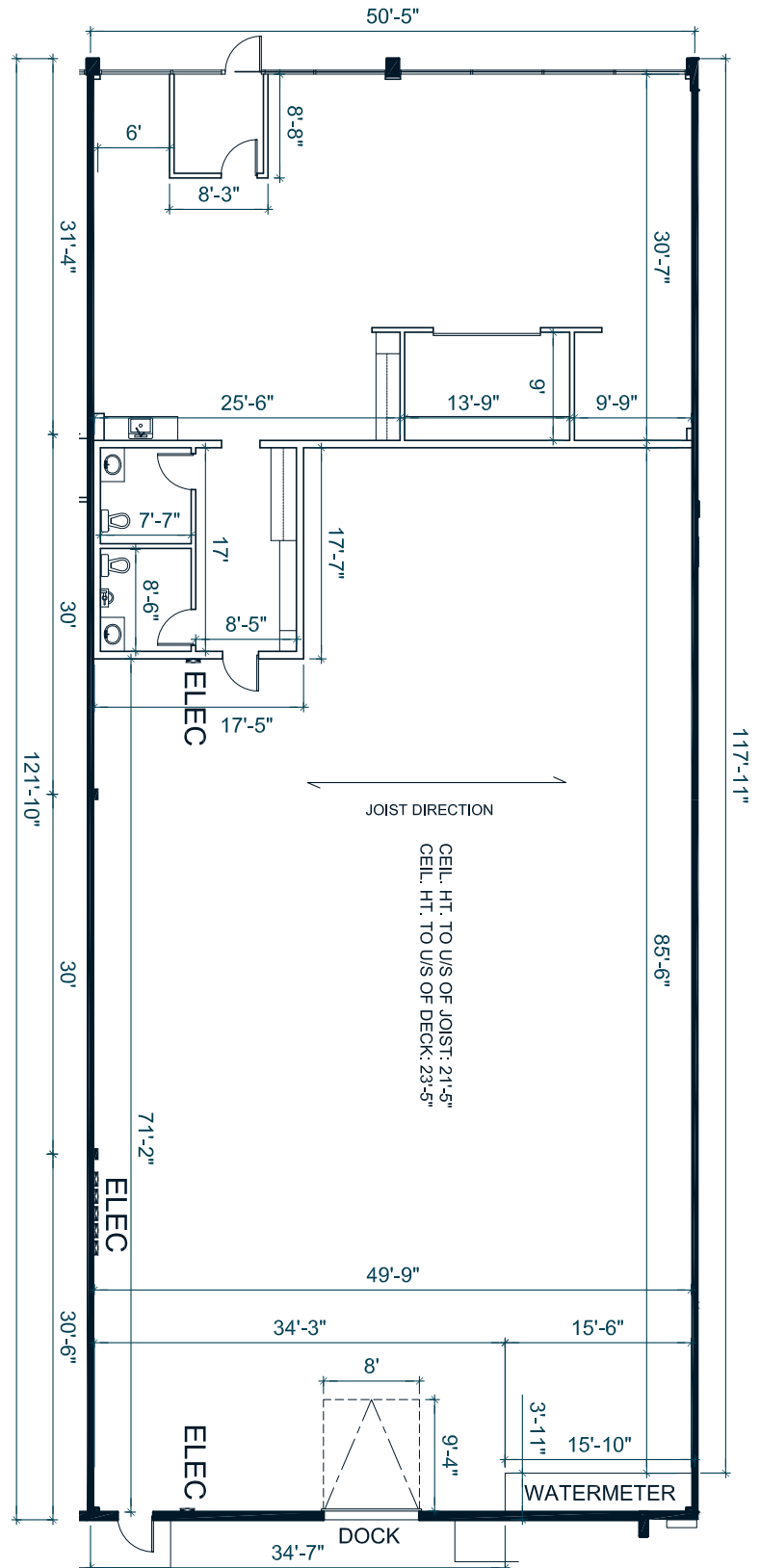



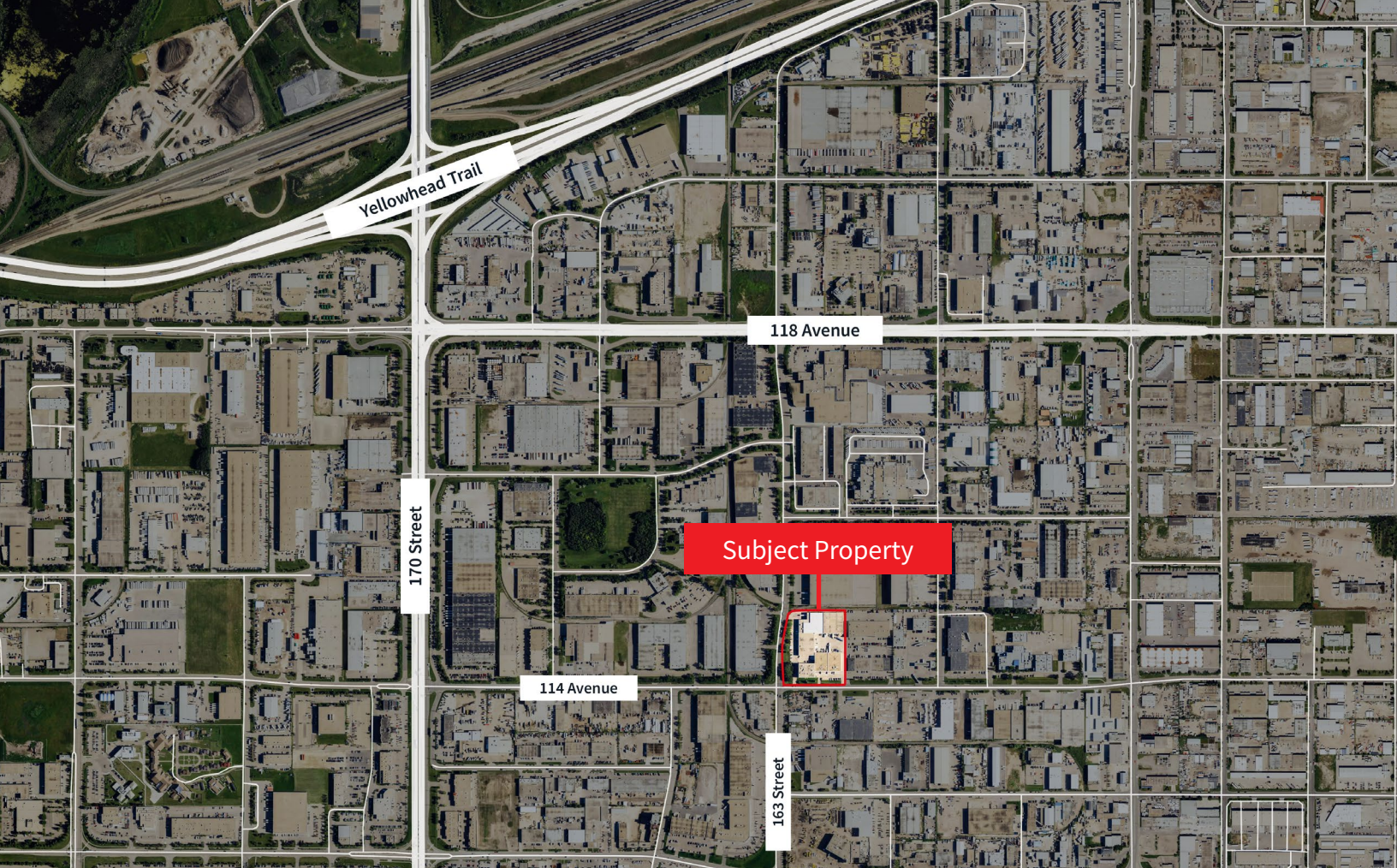



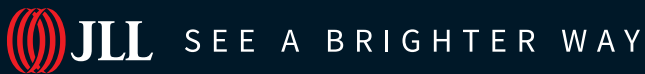

**Darryl McGavigan**  
Senior Vice President  
780 328 0064  
Darryl.McGavigan@jll.com

**Bronwyn Scrivens**  
Vice President, SIOR  
780 807 4564  
Bronwyn.Scrivens@jll.com

**Adam Butler**  
Executive Vice President  
780 328 0065  
Adam.Butler@jll.com

**Mackenzie York**  
Associate Vice President  
780 920 8463  
Mackenzie.York@jll.com

**Kent Simpson**  
Vice President  
780 203 0425  
Kent.Simpson@jll.com

**Kailee Campbell**  
Senior Transaction Analyst  
780 328 0069  
Kailee.Campbell@jll.com

**JLL Edmonton Industrial** | Suite 2101, 10088 102 Avenue NW Edmonton, Alberta T5J 2Z1

DISCLAIMER: ©2024 Jones Lang LaSalle IP, Inc. All rights reserved. All information contained herein is from sources deemed reliable; however, no representation or warranty is made to the accuracy thereof. The Property may be withdrawn without notice. Neither Owner nor JLL accepts any liability for any loss or damage suffered by any party resulting from reliance on this information. Jones Lang LaSalle Real Estate Services, Inc.