

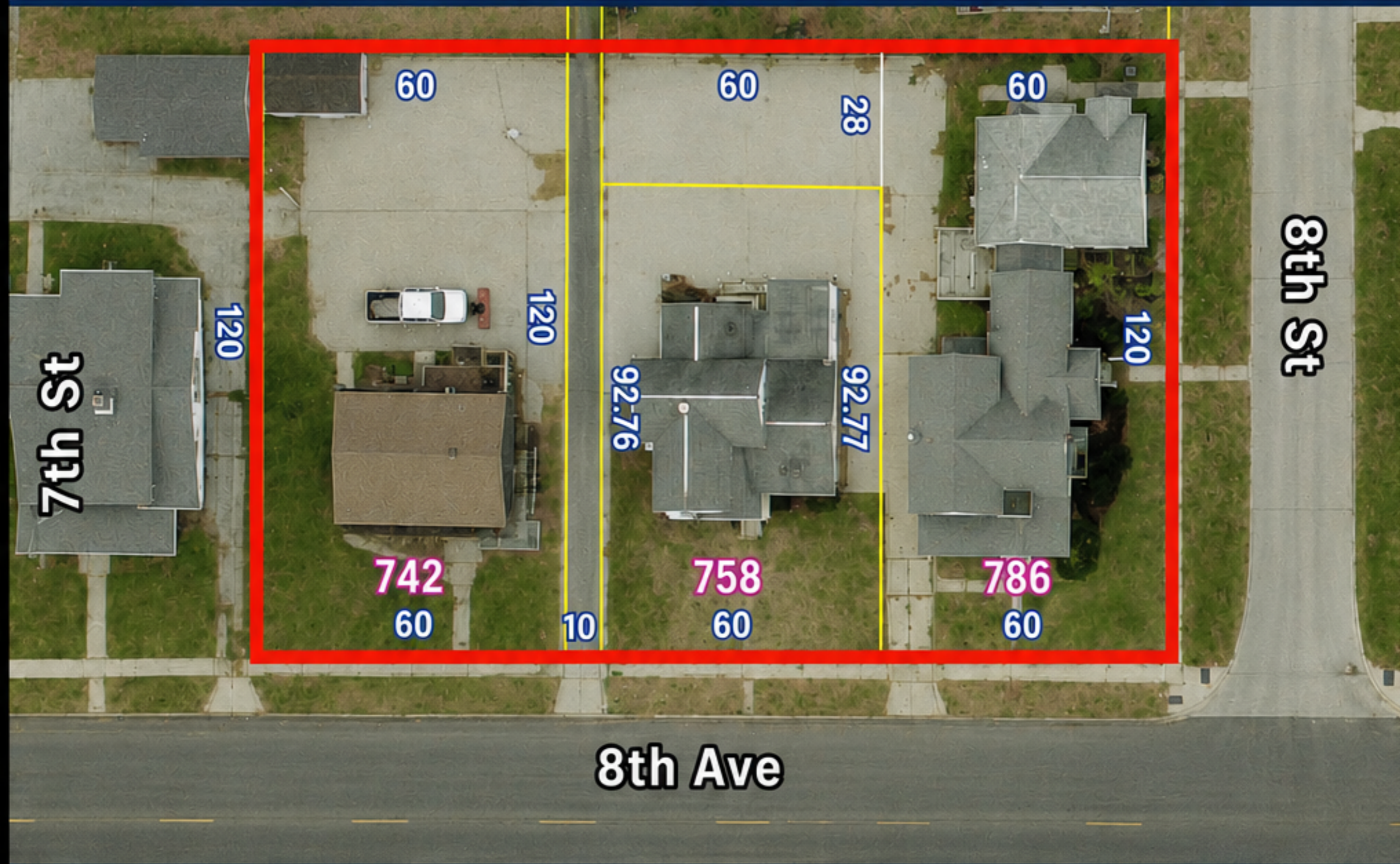

742, 758, 786 8TH AVE

MARION, IA

2 MINUTES FROM DOWNTOWN MARION



ZONED URBAN TRANSITION COMMERCIAL

The district is designed to encourage:

- Small-scale commercial businesses
- Professional offices
- Retail and service businesses
- Mixed-use buildings



ASKING PRICE
\$500,000



LOT SIZE
.496 ACRES



MULTIPLE OPTIONS
BEING SOLD AS REDEVELOPMENT
OR AS A RESIDENTIAL PORTFOLIO

CONTACT US TODAY

TROT CAREY

☎ 319-743-5663

✉ Trot@Hlandire.com

ISAIAH GARMAN

☎ 319-540-9070

✉ Isaiah@Hlandire.com

Hlandire.com