

FOR LEASE

62,784 SF AVAILABLE



1 EDEN PARKWAY, BUILDING D

LA GRANGE, KY 40031

PROPERTY HIGHLIGHTS



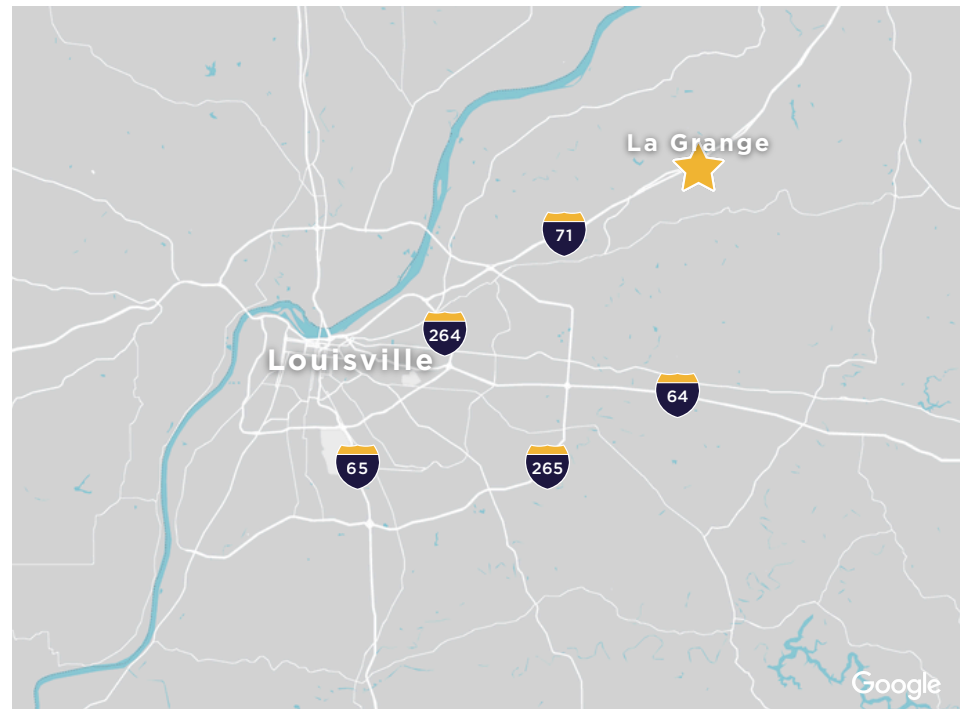

Three full floors are available at 1 Eden Parkway, a premier Class A office building ideally situated in La Grange, Kentucky. The property benefits from exceptional visibility and strong traffic generators, with Walmart and Baptist Health Hospital nearby. Convenient access to I-71 makes for an easy commute to and from Louisville. Each floor offers expansive, open floor plans that provide maximum flexibility for a variety of office configurations and uses. The building also features an exceptional parking ratio of 5.37 spaces per 1,000 square feet, ensuring abundant on-site parking for tenants and their visitors.

Building Size:	62,784 SF
Available Space:	62,784 SF
Building Class:	Class A
Average Floorplate:	20,928 SF
Year Built:	2007
Parking:	1,343 spaces (5.37/1,000 SF)
Zoning:	PUD



AMENITIES

LEGEND

-  Hospitality
-  Dining
-  Retail
-  1 Eden Pkwy

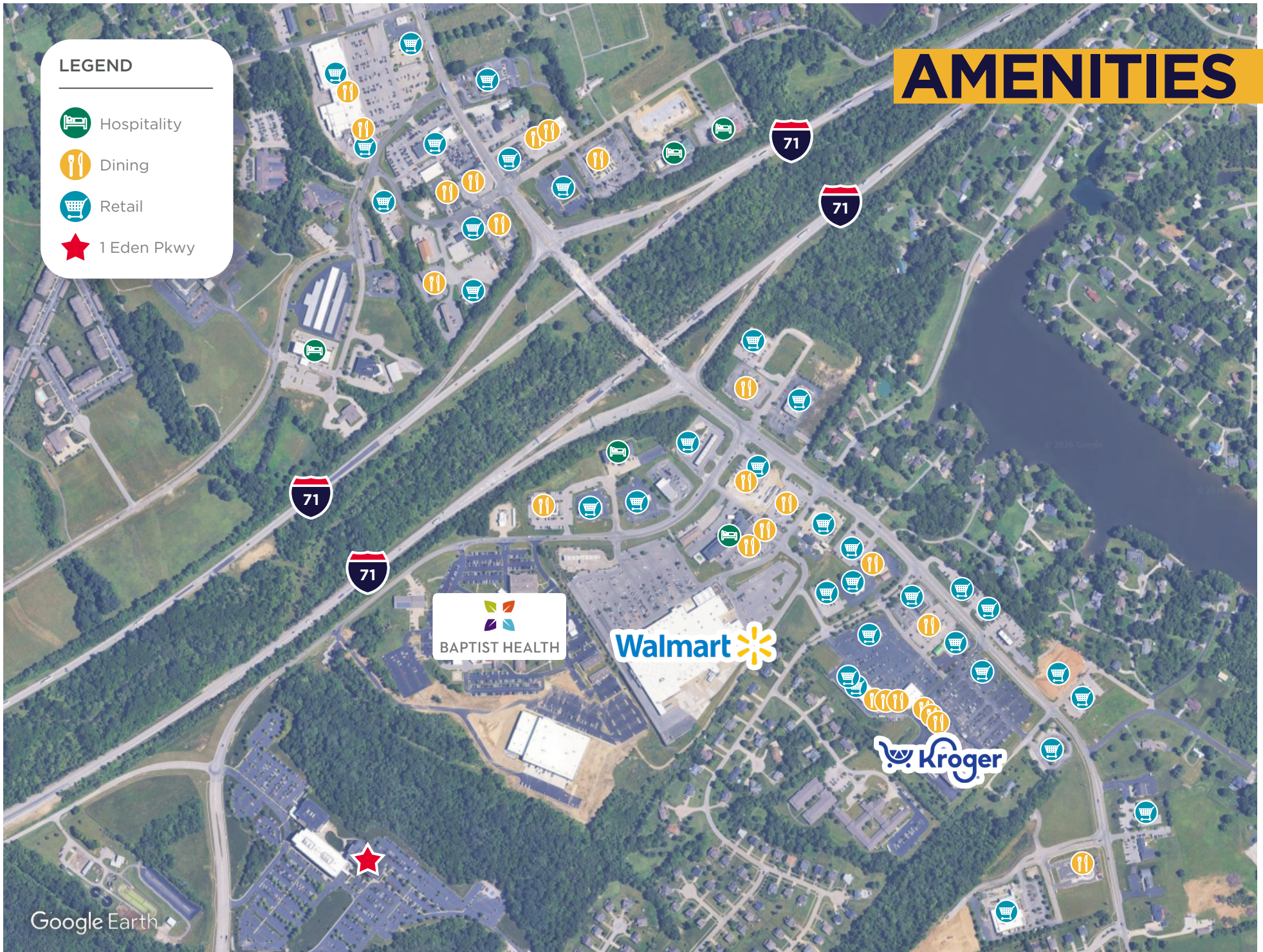

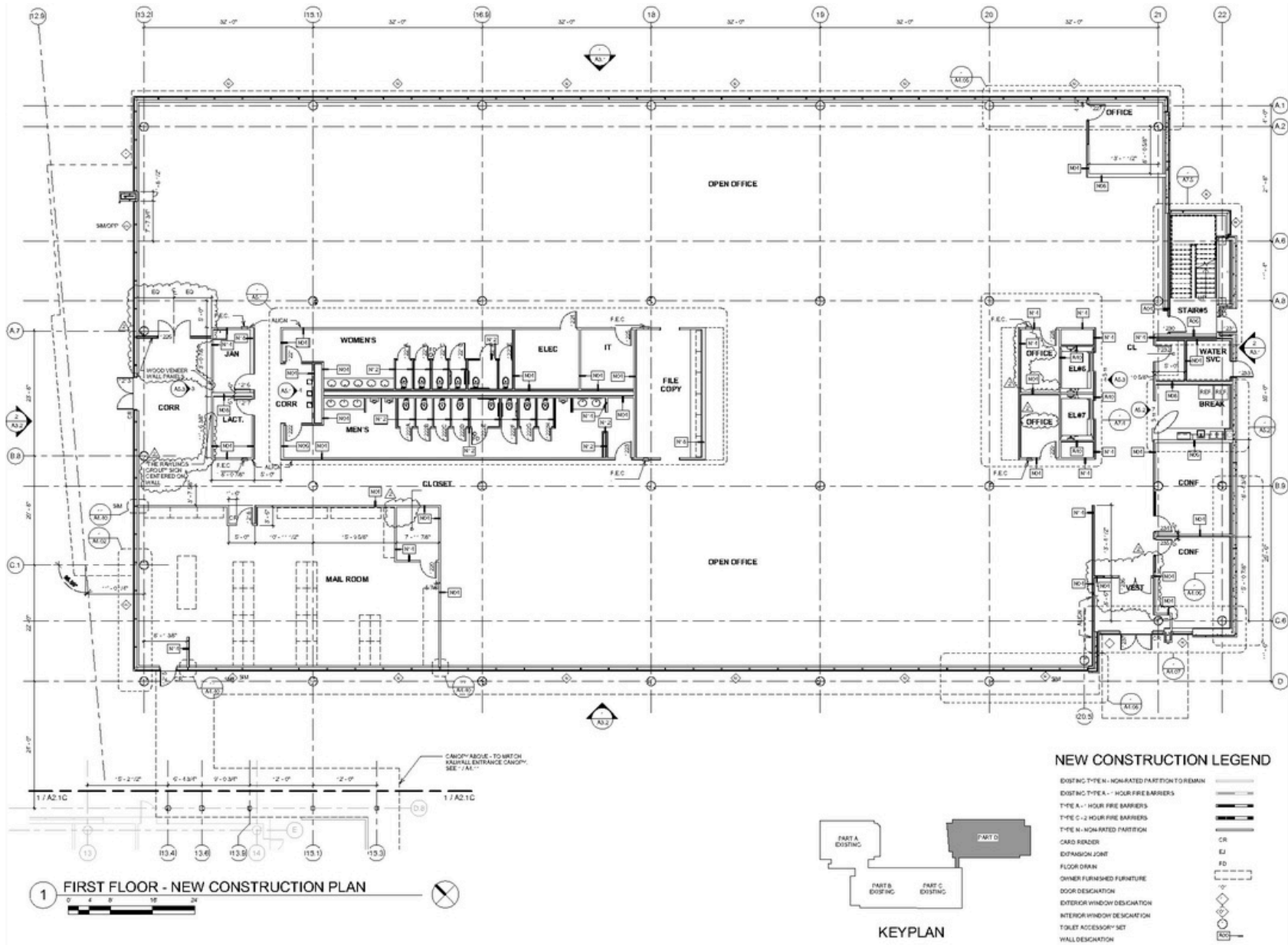

1ST FLOOR
20,928 SF

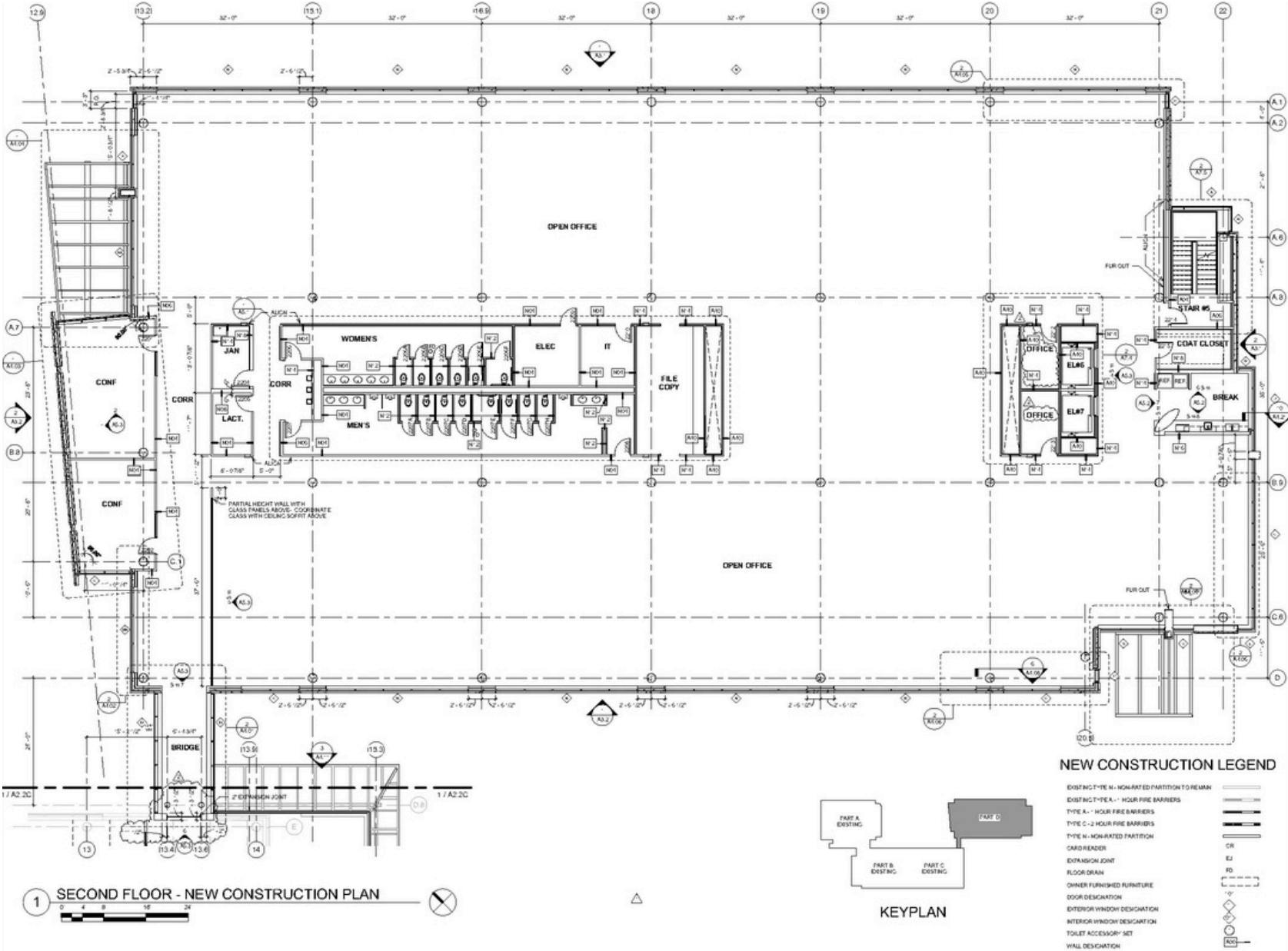

2ND FLOOR
20,928 SF

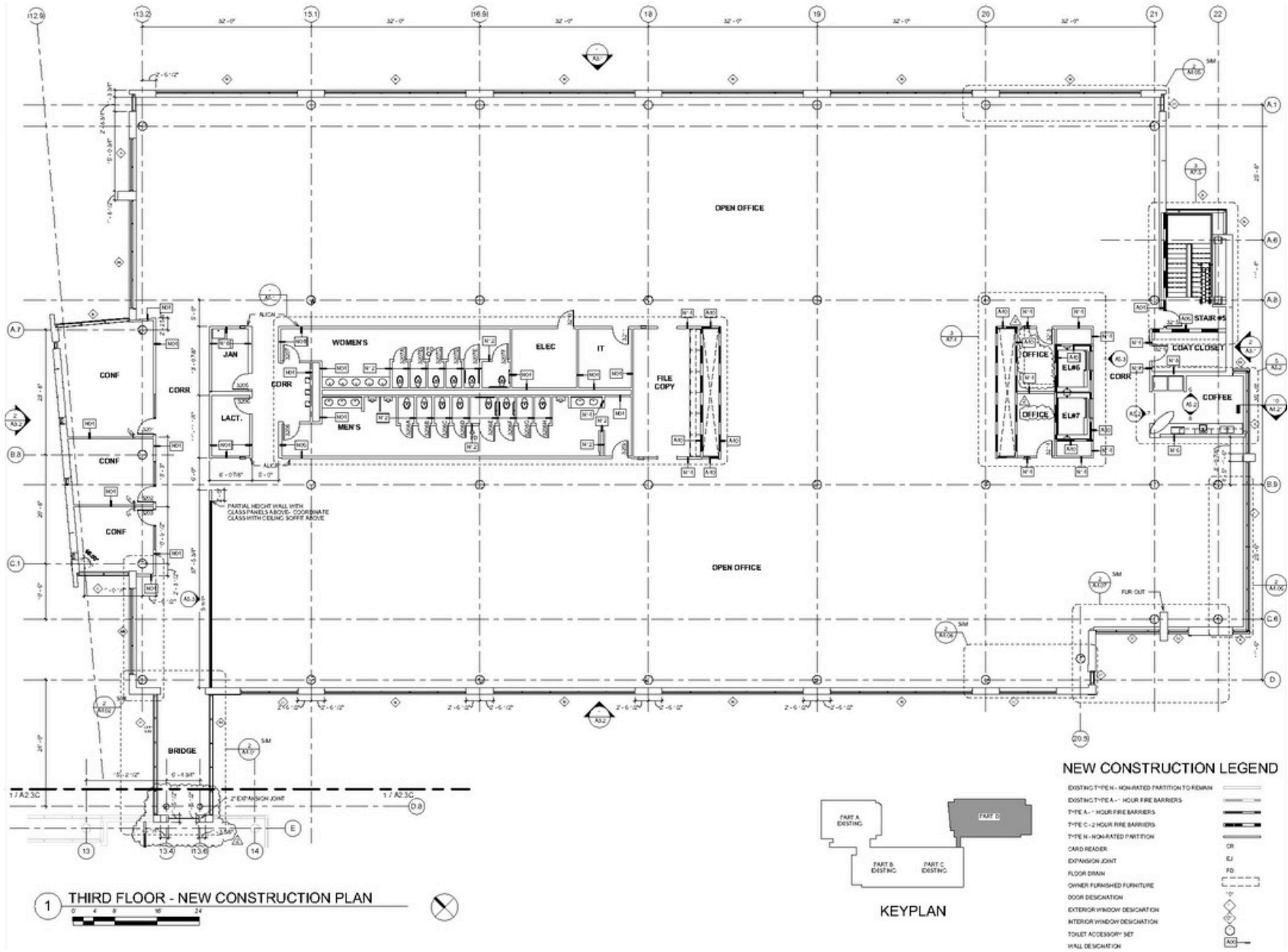

3RD FLOOR
20,928 SF

CONTACT INFORMATION

BRENT DOLEN, SIOR, CCIM

Executive Managing Director
bdolen@commercialkentucky.com
+1 502 719 3262

SAM GRAY, CCIM

Director
samgray@commercialkentucky.com
+1 502 719 3240



©2026 Cushman & Wakefield. All rights reserved. The information contained in this communication is strictly confidential. This information has been obtained from sources believed to be reliable but has not been verified. NO WARRANTY OR REPRESENTATION, EXPRESS OR IMPLIED, IS MADE AS TO THE CONDITION OF THE PROPERTY (OR PROPERTIES) REFERENCED HEREIN OR AS TO THE ACCURACY OR COMPLETENESS OF THE INFORMATION CONTAINED HEREIN, AND SAME IS SUBMITTED SUBJECT TO ERRORS, OMISSIONS, CHANGE OF PRICE, RENTAL OR OTHER CONDITIONS, WITHDRAWAL WITHOUT NOTICE, AND TO ANY SPECIAL LISTING CONDITIONS IMPOSED BY THE PROPERTY OWNER(S). ANY PROJECTIONS, OPINIONS OR ESTIMATES ARE SUBJECT TO UNCERTAINTY AND DO NOT SIGNIFY CURRENT OR FUTURE PROPERTY PERFORMANCE.

Independently Owned & Operated / A Member of the Cushman & Wakefield Alliance