

8 JENKINS COURT - OFFICE SPACES

8 Jenkins Court, Durham, NH 03824



PROPERTY DESCRIPTION

This private, secure office has 2 private spaces with a shared space. There is a common waiting room and kitchenette shared with 1 other office space. With easy walk to downtown businesses and campus this space is ideal for those serving UNH as well as the seacoast region.

PROPERTY HIGHLIGHTS

- Hosted a very successful restaurant that's easy walking distance to UNH campus
- Central heating and cooling system
- Heavy traffic count with daily count of 11,000 and pedestrian count
- Outdoor seating available

OFFERING SUMMARY

Lease Rate:	\$13.25 - 20.00 SF/yr (NNN)
Number of Units:	2
Available SF:	624 - 2,026 SF
Lot Size:	0.21 Acres
Building Size:	24,665 SF

DEMOGRAPHICS	1 MILE	3 MILES	5 MILES
Total Households	1,072	4,529	14,288
Total Population	4,700	18,638	42,111
Average HH Income	\$70,777	\$84,517	\$83,311

We obtained the information above from sources we believe to be reliable. However, we have not verified its accuracy and make no guarantee, warranty or representation about it. It is submitted subject to the possibility of errors, omissions, change of price, rental or other conditions, prior sale, lease or financing, or withdrawal without notice. We include projections, opinions, assumptions or estimates for example only, and they may not represent current or future performance of the property. You and your tax and legal advisors should conduct your own investigation of the property and transaction.

ETHAN ASH
Commercial & Investment Specialist, MiCP
O: 603.610.8500 X1430
C: 603.707.2319
ethan.ash@kw.com
NH #071469

DAVE GARVEY
Managing Director
O: 603.610.8523
C: 603.491.2854
dave@kwclcg.com
NH #004637

VIKTORIA ALKOVA
Commercial Specialist, MiCP
O: 603.610.8500
C: 646.577.1194
viktoria@kwclcg.com
NH #074657

WHITNEY TAYLOR
Commercial Realtor
O: 978.228.1055
C: 978.228.1055
whitney@kwclcg.com
NH #080690

KELLER WILLIAMS COASTAL REALTY
603.610.8500
750 Lafayette Rd.
Suite 201 - Coastal Land & Commercial Group
Portsmouth, NH 03801

Each Office Independently Owned and Operated kwclcg.com

OFFICE FOR LEASE

8 JENKINS COURT-104 RETAIL OR OFFICE

8 Jenkins Court, Durham, NH 03824



We obtained the information above from sources we believe to be reliable. However, we have not verified its accuracy and make no guarantee, warranty or representation about it. It is submitted subject to the possibility of errors, omissions, change of price, rental or other conditions, prior sale, lease or financing, or withdrawal without notice. We include projections, opinions, assumptions or estimates for example only, and they may not represent current or future performance of the property. You and your tax and legal advisors should conduct your own investigation of the property and transaction.

ETHAN ASH
Commercial & Investment Specialist, MiCP
O: 603.610.8500 X1430
C: 603.707.2319
ethan.ash@kw.com
NH #071469

DAVE GARVEY
Managing Director
O: 603.610.8523
C: 603.491.2854
dave@kwclcg.com
NH #004637

VIKTORIA ALKOVA
Commercial Specialist, MiCP
O: 603.610.8500
C: 646.577.1194
viktoria@kwclcg.com
NH #074657

WHITNEY TAYLOR
Commercial Realtor
O: 978.228.1055
C: 978.228.1055
whitney@kwclcg.com
NH #080690

KELLER WILLIAMS COASTAL REALTY
603.610.8500
750 Lafayette Rd.
Suite 201 - Coastal Land & Commercial Group
Portsmouth, NH 03801

Each Office Independently Owned and Operated kwclcg.com

OFFICE FOR LEASE

8 JENKINS COURT - OFFICE SPACE

8 Jenkins Court, Durham, NH 03824



We obtained the information above from sources we believe to be reliable. However, we have not verified its accuracy and make no guarantee, warranty or representation about it. It is submitted subject to the possibility of errors, omissions, change of price, rental or other conditions, prior sale, lease or financing, or withdrawal without notice. We include projections, opinions, assumptions or estimates for example only, and they may not represent current or future performance of the property. You and your tax and legal advisors should conduct your own investigation of the property and transaction.

ETHAN ASH
Commercial & Investment Specialist, MiCP
O: 603.610.8500 X1430
C: 603.707.2319
ethan.ash@kw.com
NH #071469

DAVE GARVEY
Managing Director
O: 603.610.8523
C: 603.491.2854
dave@kwclcg.com
NH #004637

VIKTORIA ALKOVA
Commercial Specialist, MiCP
O: 603.610.8500
C: 646.577.1194
viktorija@kwclcg.com
NH #074657

WHITNEY TAYLOR
Commercial Realtor
O: 978.228.1055
C: 978.228.1055
whitney@kwclcg.com
NH #080690

KELLER WILLIAMS COASTAL REALTY
603.610.8500
750 Lafayette Rd.
Suite 201 - Coastal Land & Commercial Group
Portsmouth, NH 03801

Each Office Independently Owned and Operated kwclcg.com

8 JENKINS COURT - RETAIL SPACE

8 Jenkins Court, Durham, NH 03824

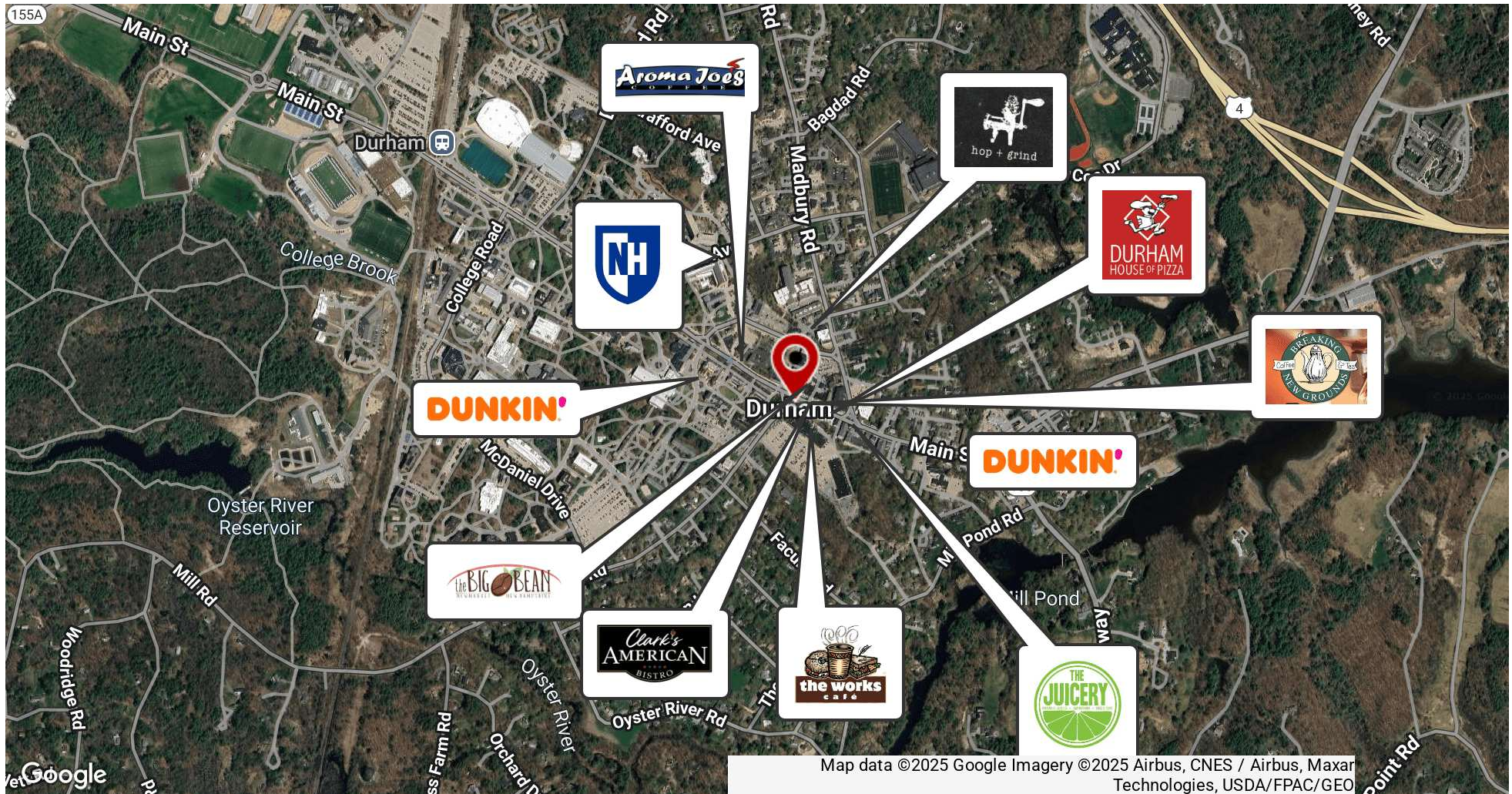

Map data ©2025 Google Imagery ©2025 Airbus, CNES / Airbus, Maxar Technologies, USDA/FPAC/Geo

We obtained the information above from sources we believe to be reliable. However, we have not verified its accuracy and make no guarantee, warranty or representation about it. It is submitted subject to the possibility of errors, omissions, change of price, rental or other conditions, prior sale, lease or financing, or withdrawal without notice. We include projections, opinions, assumptions or estimates for example only, and they may not represent current or future performance of the property. You and your tax and legal advisors should conduct your own investigation of the property and transaction.

ETHAN ASH
Commercial & Investment Specialist, MiCP
O: 603.610.8500 X1430
C: 603.707.2319
ethan.ash@kw.com
NH #071469

DAVE GARVEY
Managing Director
O: 603.610.8523
C: 603.491.2854
dave@kwclcg.com
NH #004637

VIKTORIA ALKOVA
Commercial Specialist, MiCP
O: 603.610.8500
C: 646.577.1194
viktoria@kwclcg.com
NH #074657

WHITNEY TAYLOR
Commercial Realtor
O: 978.228.1055
C: 978.228.1055
whitney@kwclcg.com
NH #080690

KELLER WILLIAMS COASTAL REALTY
603.610.8500
750 Lafayette Rd.
Suite 201 - Coastal Land & Commercial Group
Portsmouth, NH 03801

Each Office Independently Owned and Operated kwclcg.com

FLOOR PLAN OPTION 1

8 Jenkins Court, Durham, NH 03824

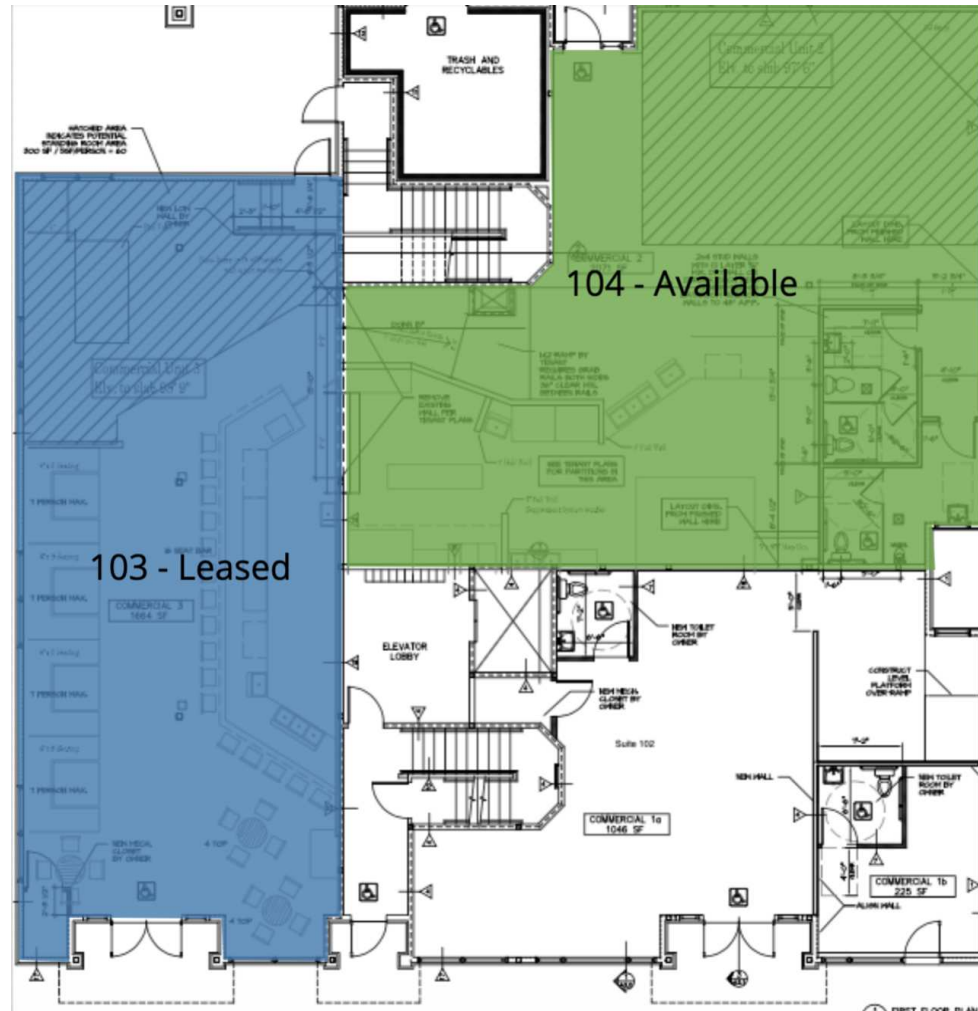

We obtained the information above from sources we believe to be reliable. However, we have not verified its accuracy and make no guarantee, warranty or representation about it. It is submitted subject to the possibility of errors, omissions, change of price, rental or other conditions, prior sale, lease or financing, or withdrawal without notice. We include projections, opinions, assumptions or estimates for example only, and they may not represent current or future performance of the property. You and your tax and legal advisors should conduct your own investigation of the property and transaction.

ETHAN ASH
Commercial & Investment Specialist, MiCP
O: 603.610.8500 X1430
C: 603.707.2319
ethan.ash@kw.com
NH #071469

DAVE GARVEY
Managing Director
O: 603.610.8523
C: 603.491.2854
dave@kwclcg.com
NH #004637

VIKTORIA ALKOVA
Commercial Specialist, MiCP
O: 603.610.8500
C: 646.577.1194
viktoria@kwclcg.com
NH #074657

WHITNEY TAYLOR
Commercial Realtor
O: 978.228.1055
C: 978.228.1055
whitney@kwclcg.com
NH #080690

KELLER WILLIAMS COASTAL REALTY
603.610.8500
750 Lafayette Rd.
Suite 201 - Coastal Land & Commercial Group
Portsmouth, NH 03801

OFFICE FOR LEASE

8 JENKINS COURT - OFFICE SPACE

8 Jenkins Court, Durham, NH 03824



LOCATION DESCRIPTION

Downtown Durham is the heart of this college town. With close proximity to most of the academic buildings as well as where most of the off campus housing, the area is bustling for most of the year. Durham has some of the best demographics in the area and one of the most populated communities for over half the year. This building sits in the heart of it all with close proximity to 3 municipal lots and plenty of short term street parking on Main St., Jenkins Ct., and Pettee Brooke.

LOCATION DETAILS

County	Strafford
Street Parking	Yes
Signal Intersection	No
Road Type	Paved
Market Type	Small



We obtained the information above from sources we believe to be reliable. However, we have not verified its accuracy and make no guarantee, warranty or representation about it. It is submitted subject to the possibility of errors, omissions, change of price, rental or other conditions, prior sale, lease or financing, or withdrawal without notice. We include projections, opinions, assumptions or estimates for example only, and they may not represent current or future performance of the property. You and your tax and legal advisors should conduct your own investigation of the property and transaction.

ETHAN ASH
Commercial & Investment Specialist, MiCP
O: 603.610.8500 X1430
C: 603.707.2319
ethan.ash@kw.com
NH #071469

DAVE GARVEY
Managing Director
O: 603.610.8523
C: 603.491.2854
dave@kwclcg.com
NH #004637

VIKTORIA ALKOVA
Commercial Specialist, MiCP
O: 603.610.8500
C: 646.577.1194
viktoria@kwclcg.com
NH #074657

WHITNEY TAYLOR
Commercial Realtor
O: 978.228.1055
C: 978.228.1055
whitney@kwclcg.com
NH #080690

KELLER WILLIAMS COASTAL REALTY
603.610.8500
750 Lafayette Rd.
Suite 201 - Coastal Land & Commercial Group
Portsmouth, NH 03801

Each Office Independently Owned and Operated kwclcg.com

OFFICE FOR LEASE

8 JENKINS COURT - OFFICE SPACE

8 Jenkins Court, Durham, NH 03824



LEASE INFORMATION

Lease Type:	NNN	Lease Term:	12 months
Total Space:	624 - 2,026 SF	Lease Rate:	\$13.25 - \$20.00 SF/yr

AVAILABLE SPACES

SUITE	TENANT	SIZE (SF)	LEASE TYPE	LEASE RATE	DESCRIPTION
Suite 104	Available	1,300 - 2,026 SF	NNN	\$20.00 SF/yr	This space is ideal for quick service and professionals looking for a first floor unit. As retail/cafe space, it has excellent access from the municipal lot on Pettee Brook. The optional kitchen has a walk in cooler and hood in place with plenty of plumbing and 2 large bathrooms.
Suite 401-2 & 3	Available	624 SF	NNN	\$13.25 SF/yr	Maximum lease period is 1 year. Elevator and reception area is included.

We obtained the information above from sources we believe to be reliable. However, we have not verified its accuracy and make no guarantee, warranty or representation about it. It is submitted subject to the possibility of errors, omissions, change of price, rental or other conditions, prior sale, lease or financing, or withdrawal without notice. We include projections, opinions, assumptions or estimates for example only, and they may not represent current or future performance of the property. You and your tax and legal advisors should conduct your own investigation of the property and transaction.

ETHAN ASH
Commercial & Investment Specialist, MiCP
O: 603.610.8500 X1430
C: 603.707.2319
ethan.ash@kw.com
NH #071469

DAVE GARVEY
Managing Director
O: 603.610.8523
C: 603.491.2854
dave@kwclcg.com
NH #004637

VIKTORIA ALKOVA
Commercial Specialist, MiCP
O: 603.610.8500
C: 646.577.1194
viktorija@kwclcg.com
NH #074657

WHITNEY TAYLOR
Commercial Realtor
O: 978.228.1055
C: 978.228.1055
whitney@kwclcg.com
NH #080690

KELLER WILLIAMS COASTAL REALTY
603.610.8500
750 Lafayette Rd.
Suite 201 - Coastal Land & Commercial Group
Portsmouth, NH 03801

Each Office Independently Owned and Operated kwclcg.com