



PROPERTY DESCRIPTION

Introducing a versatile leasing opportunity at 432 N Royal St, Jackson, TN. This property seamlessly integrates office and warehouse spaces, offering a perfect balance of functionality and flexibility. The office area provides a professional environment with ample space for various business needs, while the adjoining warehouse space delivers the practicality required for storage or operational activities. Featuring high ceilings, expansive windows, and convenient loading facilities, this property is poised to accommodate a wide range of business ventures. Embrace the potential of this prime location and its adaptable layout to elevate your operations and establish a thriving business in Jackson's dynamic commercial landscape.

PROPERTY HIGHLIGHTS

- Convenient access to I-40
- Modern office space
- Spacious warehouse area
- Ample parking facilities
- Flexible floor plan options
- High ceilings for warehouse

CLAY FOWLER

731.467.0036 | Cfowler@prosperwith.us

OFFERING SUMMARY

Lease Rate:	\$25,000.00 per month (Gross)
Number of Units:	1
Available SF:	25,000 SF
Lot Size:	336,985 SF
Building Size:	25,000 SF

DEMOGRAPHICS	0.3 MILES	0.5 MILES	1 MILE
Total Households	213	703	3,296
Total Population	529	1,673	8,907
Average HH Income	\$35,536	\$36,903	\$40,813

JACKSON, TN 38301

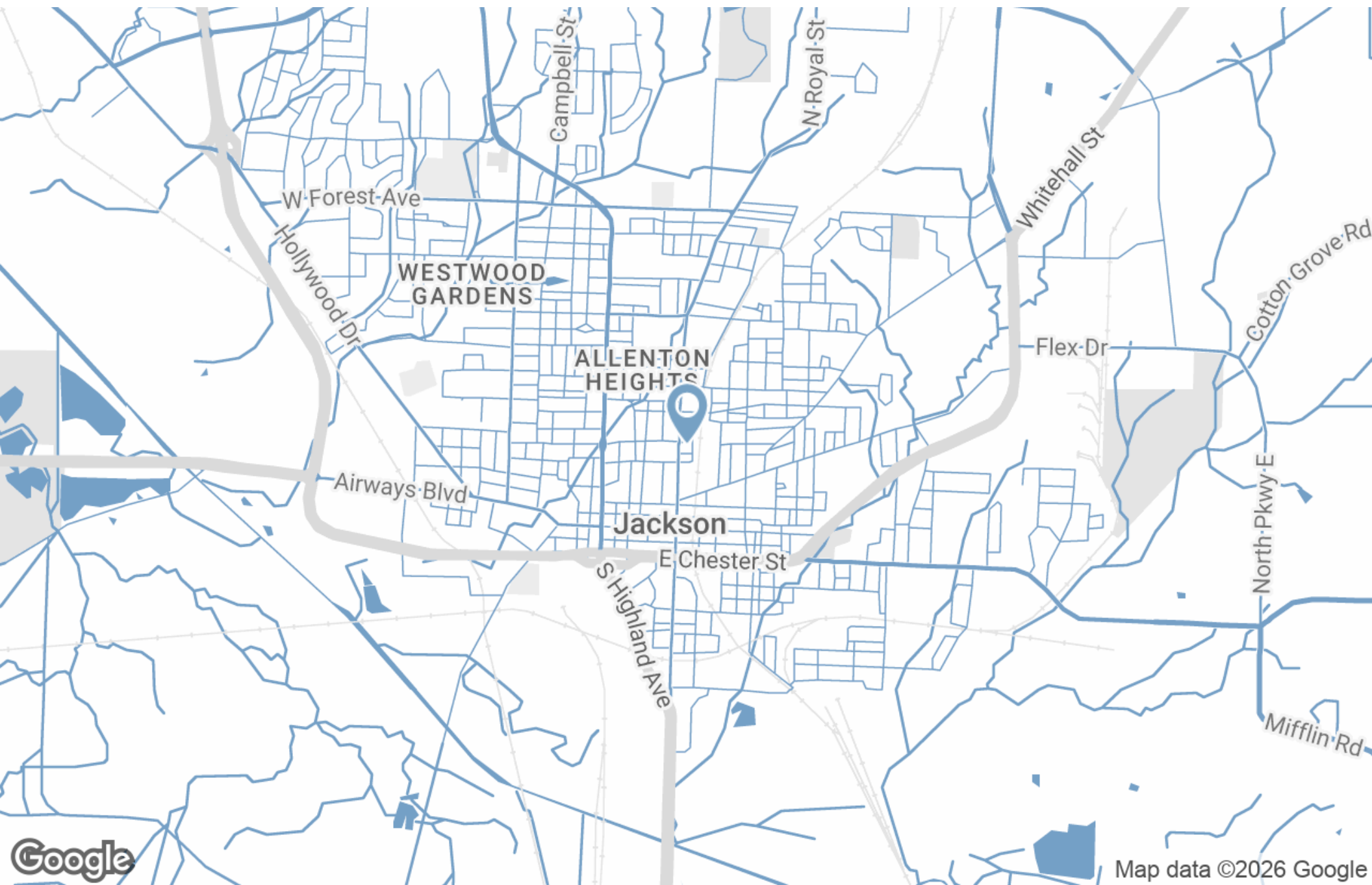

Map data ©2026 Google

CLAY FOWLER
731.467.0036 | Cfowler@prosperwith.us

 **PROSPER**
REALTY GROUP
prosperwith.us

JACKSON, TN 38301

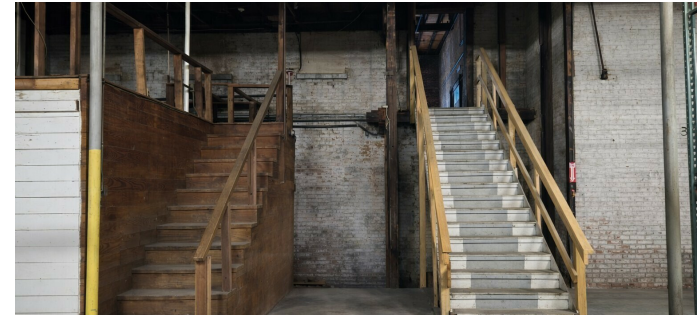

JACKSON, TN 38301

POPULATION	0.3 MILES	0.5 MILES	1 MILE
Total Population	529	1,673	8,907
Average Age	38	38	38
Average Age (Male)	37	37	36
Average Age (Female)	39	40	39

HOUSEHOLDS & INCOME	0.3 MILES	0.5 MILES	1 MILE
Total Households	213	703	3,296
# of Persons per HH	2.5	2.4	2.7
Average HH Income	\$35,536	\$36,903	\$40,813
Average House Value	\$145,520	\$149,560	\$142,490

Demographics data derived from AlphaMap

