



**EXCLUSIVELY  
LISTED BY:**



**Mike Tan**  
[miket@spencerhines.com](mailto:miket@spencerhines.com)  
864.357.1136



**Grayson Atkins**  
[graysonatkins@spencerhines.com](mailto:graysonatkins@spencerhines.com)  
864.316.0702

[WWW.SPENCERHINES.COM](http://WWW.SPENCERHINES.COM)

COMMERCIAL REAL ESTATE SALES,  
LEASING, & INVESTMENTS  
380 S. Pine Street, Spartanburg, SC 29302  
864.583.1001



Mike Tan and Grayson Atkins of Spencer/Hines Properties are excited to officially list the vacancies at the Westgate Mall in Spartanburg, South Carolina for lease.

Westgate Mall was officially opened in 1975 and renovated in 1996 and remains the only enclosed mall in Spartanburg County today. Anchored by Belk, Dillard's and JC Penney, the Westgate Mall caters to a variety of retail needs for its customers. The Westgate Mall sits on over 52 acres with visibility from Interstate 26.

Contact us today to explore the available spaces and secure your place in the Westgate Mall!



**EXCLUSIVELY  
LISTED BY:**



**Mike Tan**

[miket@spencerhines.com](mailto:miket@spencerhines.com)  
864.357.1136



**Grayson Atkins**

[graysonatkins@spencerhines.com](mailto:graysonatkins@spencerhines.com)  
864.316.0702

[WWW.SPENCERHINES.COM](http://WWW.SPENCERHINES.COM)

COMMERCIAL REAL ESTATE SALES,  
LEASING, & INVESTMENTS

380 S. Pine Street, Spartanburg, SC 29302

864.583.1001



# AVAILABLE UNITS FOR LEASE

Unit Number	Square Footage	Closest Big Box Tenant
040	7,640	Belk
120	1,366	Dillard's
131	1,515	Dillard's
140	1,570	Dillard's
142	504	Dillard's
330	2,905	Former Sears
380	2,196	Former Sears
390	1,550	Former Sears
415	691	JCPenney
610	557	Restaurant Space in Food Court
630	900	Restaurant Space in Food Court
640	1,196	Food Court
680	6,000	Food Court
760	1,541	JCPenney
860	941	Belk
910	2,812	Belk
920	3,113	Belk
930	2,920	Belk
940	36,162	Former Sears
950	35,011	Former Sears
Building G	23,360	Above Food Court



**CALL BROKERS FOR PRICING**

# SITE PLAN

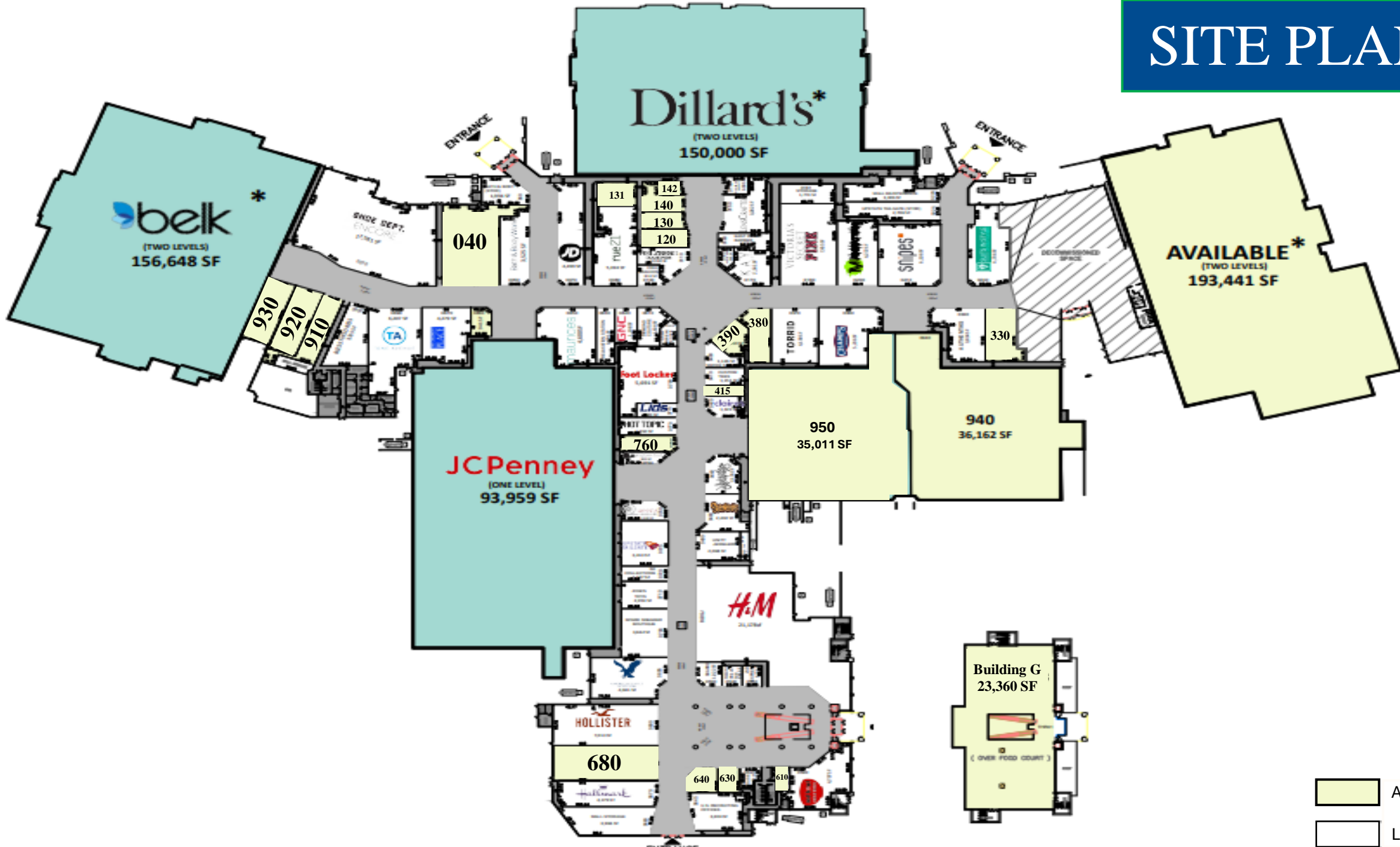

\*NOT OWNED

Available  
Leased



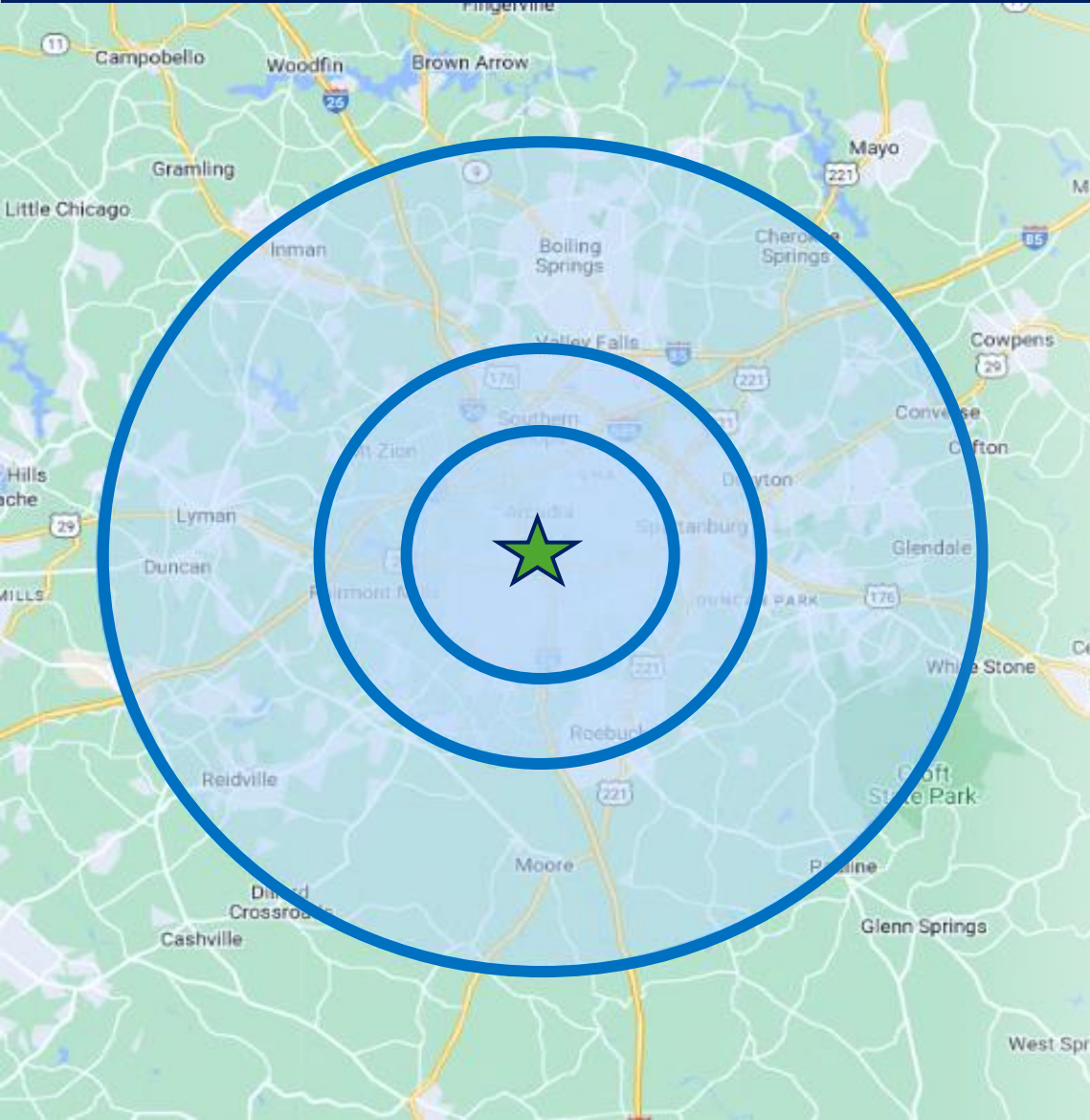

<b>Drive Time Demographics</b> (Data Generated by Placer.ai)	<b>5 Minute</b>	<b>10 Minute</b>	<b>20 Minute</b>
<b>Population</b>	1,756	31,246	248,503
<b>Number of Households</b>	776	12,346	95,724
<b>Average Household Income</b>	\$62,722.56	\$65,272.51	\$81,372.73
<b>Median Age</b>	31.37	35.75	37.66
<b>Households with Children</b>	272	3,377	28,114
<b>Projected 2029 Population</b>	1698	30,837	256,317
<b>Projected 2034 Population</b>	1,703	31,274	266,054



# RETAIL AERIAL VIEW





# SPARTANBURG AREA MAP

