



For Lease
Office/Warehouse
Space Available



715 E. Sprague Ave.
Spokane, Washington 99202

Office Lease Rates:
\$14.00/SF/YR

- Suite 101 - 1,020 SF ±
 - 5 Private Offices
 - Reception Area
 - Copy / Supply Room
- Suite 115 - 1,925 SF ±
 - 10 Private Offices
 - Conference Room
- Floor 2
 - (8) 200 SF ± Private offices
 - \$350/ Month FS (Less Janitorial)
 - Suite 208 - 1,000 SF ±
 - \$1,000/ Month FS (Less Janitorial)

Suite 90 Lease Rates:

Warehouse Space
\$0.40 / Month NNN
\$1.00 / Month NNN (Office)

- 16,500 ± SF
- Insulated
- Fire Sprinkler
- 13' Clear Height
- New Roof
- Exposed Wood Beams

For More Information: **Darren Slackman, SIOR**
Managing Broker
+1 509 622 3595
dslackman@naiblack.com

Jon Jeffreys, SIOR
Broker
+1 509 622 3566
jjeffreys@naiblack.com

NO WARRANTY OR REPRESENTATION, EXPRESS OR IMPLIED, IS MADE AS TO THE ACCURACY OF THE INFORMATION CONTAINED HEREIN, AND THE SAME IS SUBMITTED SUBJECT TO ERRORS, OMISSIONS, CHANGE OF PRICE, RENTAL OR OTHER CONDITIONS, PRIOR SALE, LEASE OR FINANCING, OR WITHDRAWAL WITHOUT NOTICE, AND OF ANY SPECIAL LISTING CONDITIONS IMPOSED BY OUR PRINCIPALS NO WARRANTIES OR REPRESENTATIONS ARE MADE AS TO THE CONDITION OF THE PROPERTY OR ANY HAZARDS CONTAINED THEREIN OR ANY TO BE IMPLIED.

Black Commercial, Inc.
107 South Howard Street
Spokane, Washington
+1 509 623 1000
naiblack.com

Parking

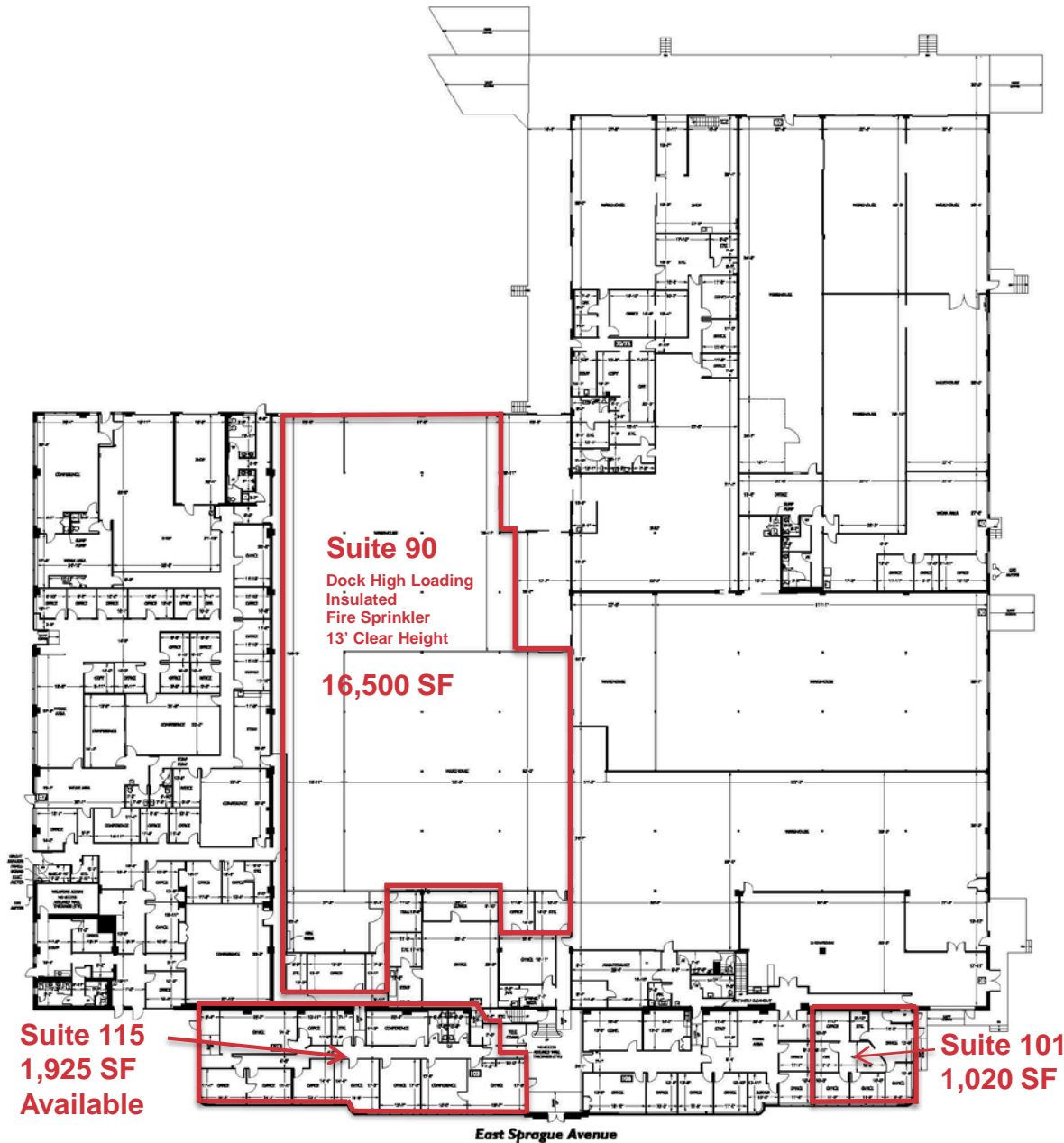

Client Silvey Construction 10221 East Montgomery Drive Suite A Spokane, WA 99206	Subject Industrial Building 715 East Sprague Avenue Spokane, WA 99202	Floor Plan 	Scale 0 10 20 30 40 50	2-D FLOOR PLANS 2DFLOORPLANS.COM 206-328-7410 600 NW Gilman Blvd. Suite E Issaquah, WA 98027 Measured: December 2015 Project: C15-1178
--	---	-----------------------	----------------------------------	--



Jon Jeffreys, SIOR
 Broker
 +1 509 622 3566
 jjeffreys@naiblack.com

Darren Slackman, SIOR
 Managing Broker
 +1 509 622 3595
 dslackman@naiblack.com

Black Commercial, Inc.
 107 South Howard Street
 Spokane, Washington
 +1 509 623 1000
 naiblack.com

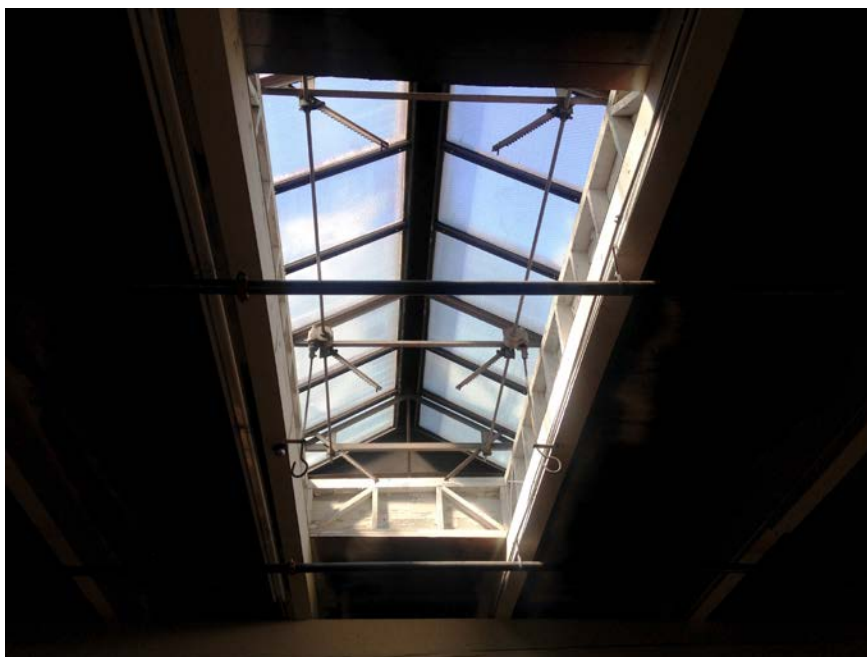

Jon Jeffreys, SIOR
+1 509 622 3566
jjeffreys@naiblack.com

Darren Slackman, SIOR
Managing Broker
+1 509 622 3595
dslackman@naiblack.com

Black Commercial, Inc.
107 South Howard Street
Spokane, Washington
+1 509 623 1000
naiblack.com