

485 Jimmy Deloach Parkway

Savannah, Georgia 31322

Executive Summary

Set to be completed early 2025, the new 14,000-square-foot shopping center at the corner of Jimmy Deloach Boulevard and Benton Boulevard in Port Wentworth, GA, will offer 8-9 retail units. Strategically located, this vibrant center is just minutes from surrounding residential neighborhoods, making it a convenient destination for local shoppers. It's also ideally situated a short drive from Savannah/Hilton Head International Airport, catering to both residents and travelers. With easy access and ample parking (Over 100 spaces), it promises to become a bustling hub for the community.

The property is currently under construction, so the spaces are now available for prelease.



BUILDING 1	6,810SF
BUILDING 2	6,810SF
TOTAL SQ/FT	13,620SF

For more information:

Zack Allen

+1 912-655-2135 • zallen@naisavannah.com

	UNIT	SQ/FT	LEASE TYPE	DESCRIPTION
BUILDING A	A	1,362	NNN	RETAIL BOX
	B	1,362	NNN	RETAIL BOX
	C	1,362	NNN	RETAIL BOX
	D	2,725	NNN	RESTAURANT
BUILDING B	A	1,362	NNN	RETAIL BOX
	B	1,362	NNN	RETAIL BOX
	C	1,362	NNN	RETAIL BOX
	D	2,725	NNN	RETAIL BOX

FOR LEASE
13,620 SQ/FT



FOR LEASE
13,620 SQ/FT

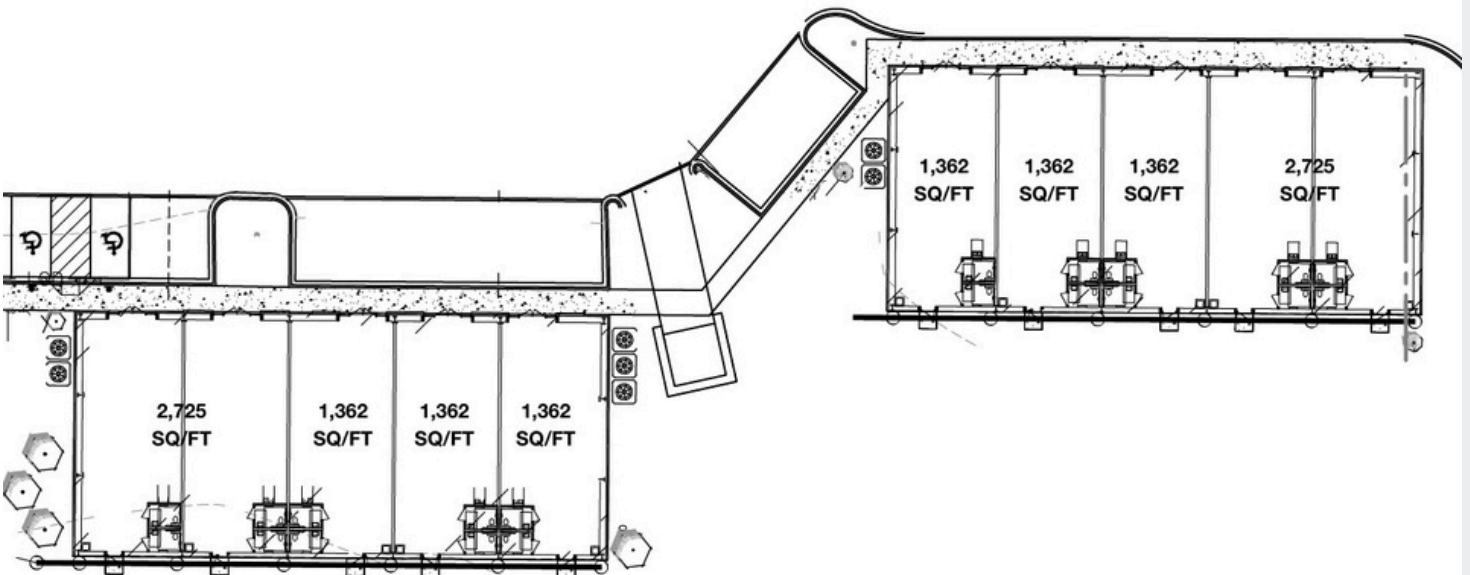

FOR LEASE

13,620 SQ/FT

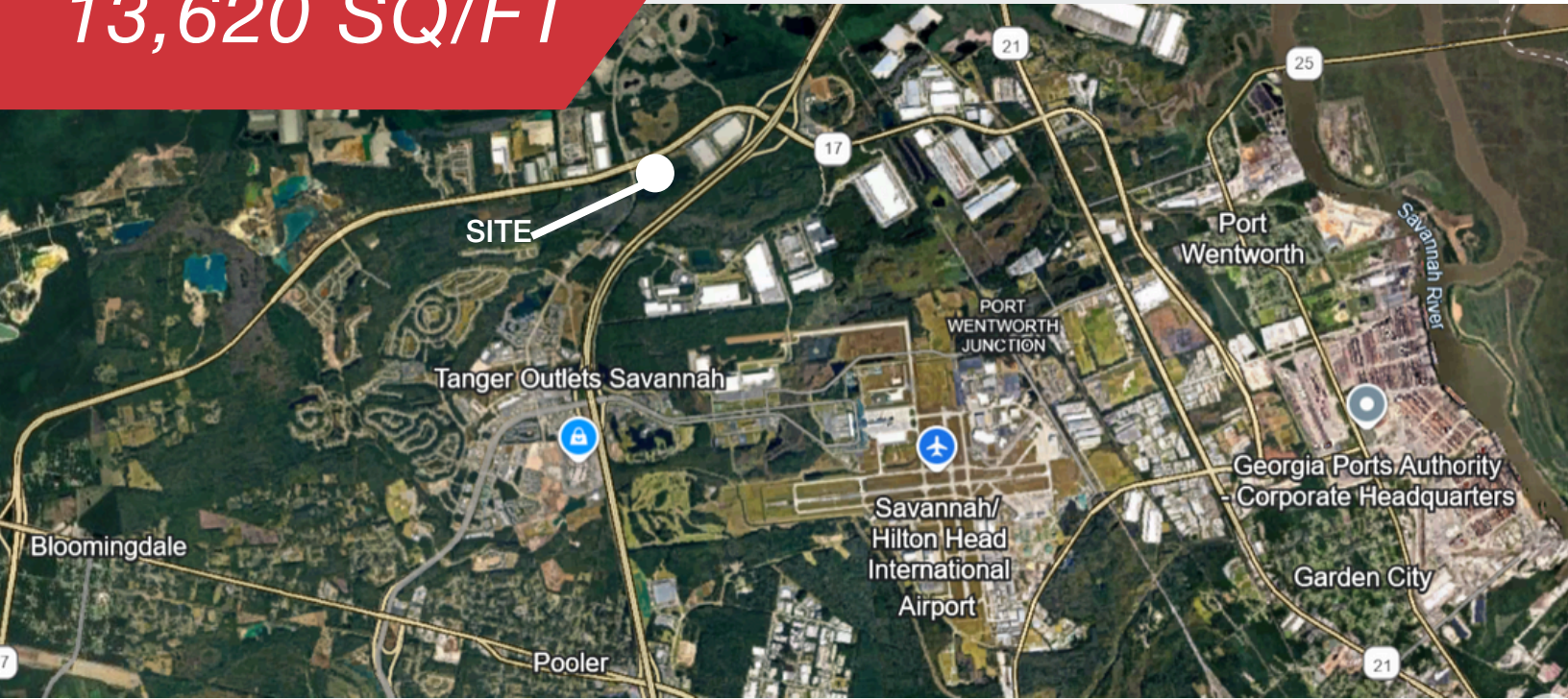

Driving Distance to Major Cities from Property

Atlanta, GA	231 Miles
Charleston, SC	113 Miles
Orlando, FL	272 Miles
Athens, GA	194 Miles
Macon, GA	159 Miles
Jacksonville, FL	132 Miles

For more information:

Zack Allen

+1 912-655-2135 • zallen@naisavannah.com

Location Advantages

- Nearby communities are Marion Lake, Monarch Godley Station, Belmont Park West, and Parkside at the Highlands Apartments
- 14k vehicles per day

Property Highlights

- 100 Parking Spaces
- Monument Signage
- Grease Trap for Restaurant Space
- Delivered as a vanilla box

1650 E VICTORY DRIVE
Savannah, GA
+1 912-358-5600
naisavannah.com