

For Sale 1523 Yale Street

Houston, TX 77008

±8,195 SF Building
±19,798 SF Land

EXECUTE CONFIDENTIALITY AGREEMENT



Barrett Von Blon
First Vice President
T +1 713 577 1777
barrett.vonblon@cbre.com

Chris Bergmann Jr.
Executive Vice President
T +1 713 577 3847
chris.bergmann@cbre.com

CBRE

CAPITAL MARKETS | LAND SERVICES

Commute & Demographics

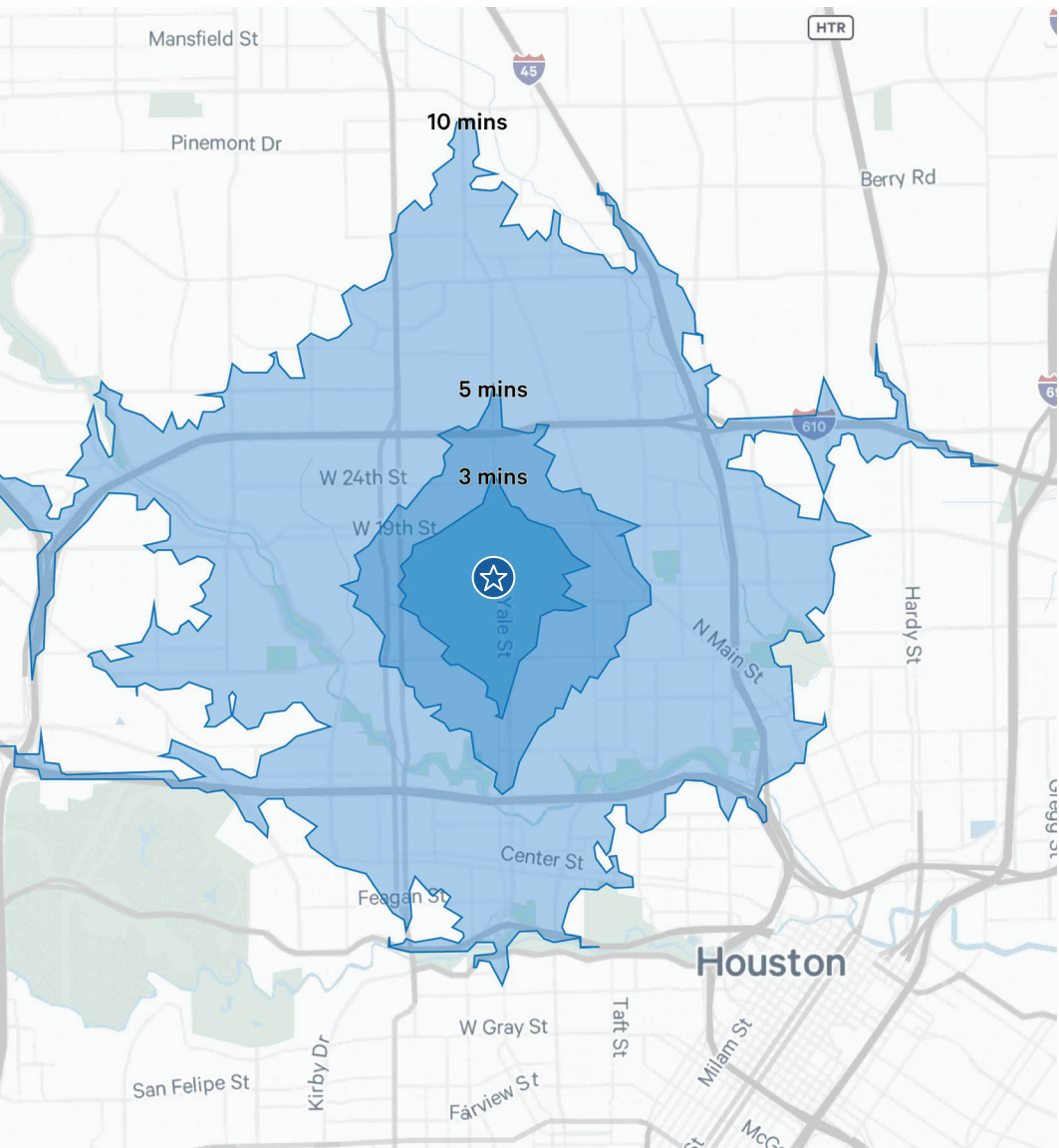

Drive Times	Minutes
MKT	6
Downtown Houston	15
Galleria Houston	20
Texas Medical Center	25

Property Information

Location

- 1523 Yale Street Houston, TX 77008

Property Information

- ±8,915 SF of building (3 levels, built 2013)
- ±19,798 SF of land (+0.454 acres)
- 31 parking spots
- Outside of floodplains
- Utilities via City of Houston
- Total tax rate: \$2.092362 (2024)
- HISD (Love Elementary, Hamilton Middle, Heights High School)

Surrounding Area

- Located in the Houston Heights, this charming and historic neighborhood has undergone significant growth and revitalization in recent years, with the emergence of new businesses, trendy restaurants, and modern residential developments, all while maintaining its unique character and historic charm.

Price

Call Broker for Pricing



Commute

Traffic Counts	Vehicles Per Day
Yale St	13,922
Heights Blvd	12,827
16th St	1,175



2024 Demographics

Population Summary	1-Miles	3-Miles	5-Miles
Population	24,391	177,867	445,423
Median Age	38.1	35.8	35.7
Average Household Income	\$213,598	\$166,928	\$142,569
Average Home Value	\$684,251	\$550,629	\$550,291
College Degree or Higher	79.6%	63.8%	54.6%

Property Aerial

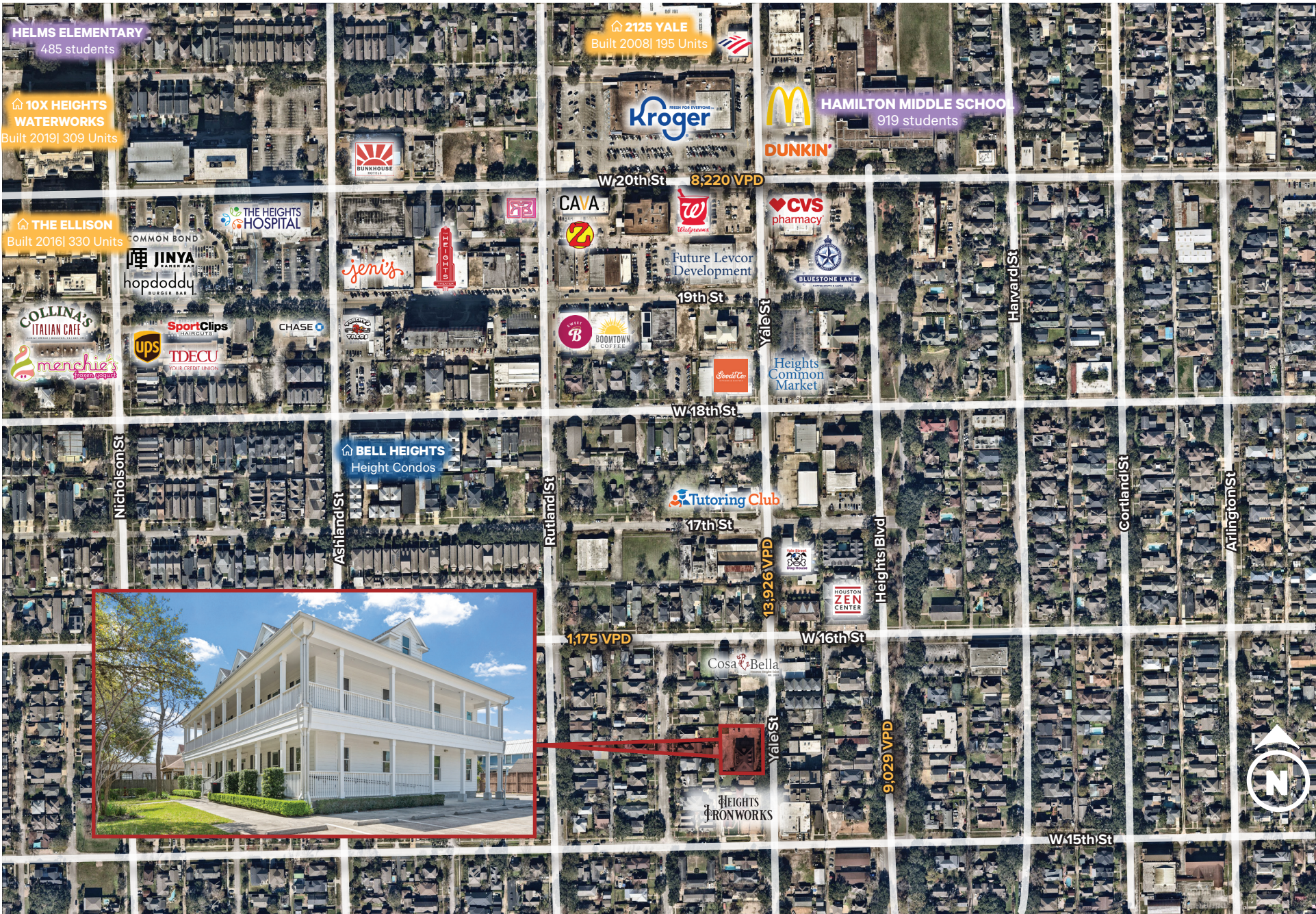

Interior Photos



Site Plan

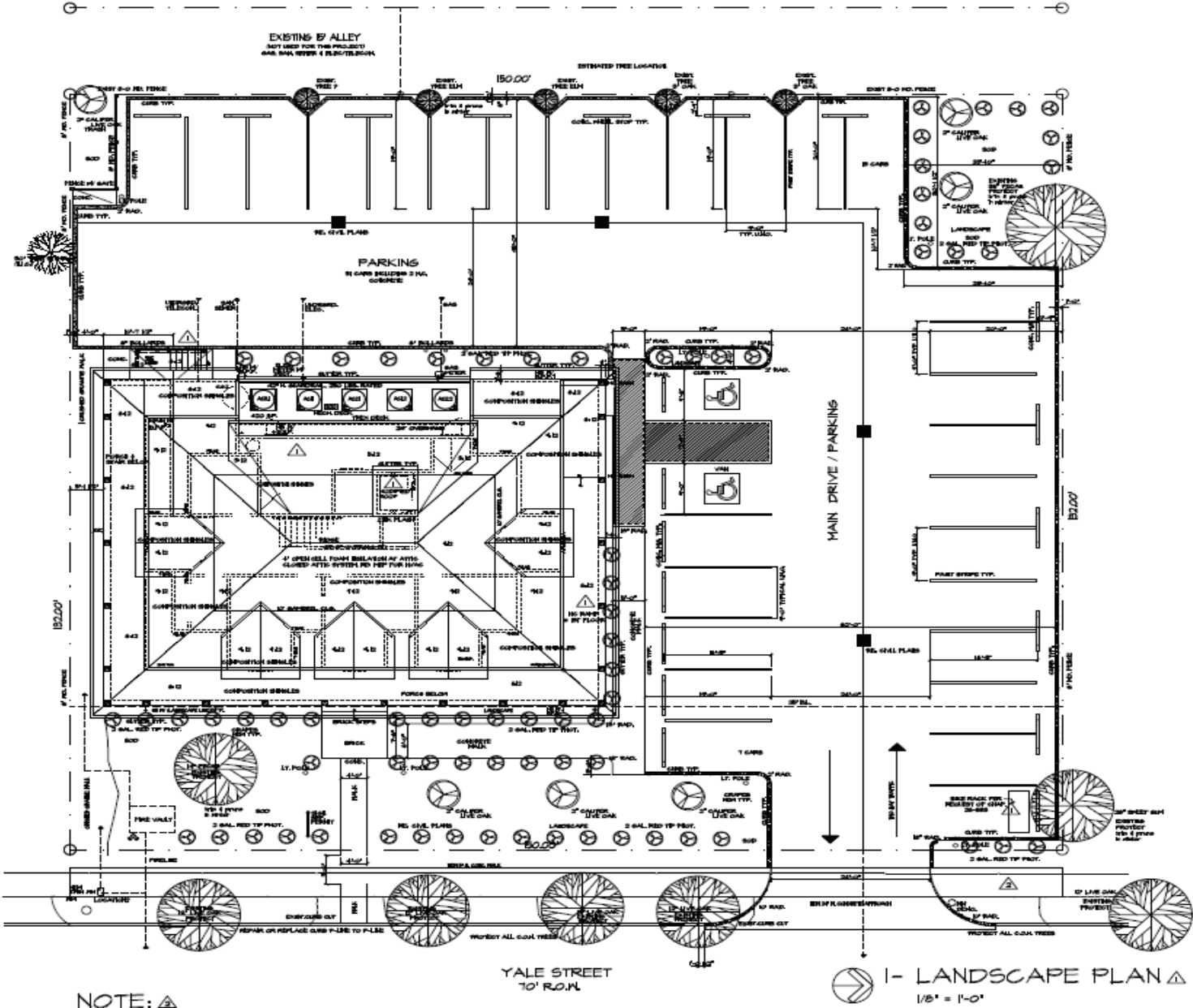

For Sale

1523 Yale Street

Houston, TX 77008

EXECUTE CONFIDENTIALITY AGREEMENT

www.cbre.com

Contact Us

Barrett Von Blon

First Vice President

T +1 713 577 1777

barrett.vonblon@cbre.com

Chris Bergmann Jr.

Executive Vice President

T +1 713 577 3847

chris.bergmann@cbre.com

CAPITAL MARKETS | LAND SERVICES

CBRE

© 2023 CBRE, Inc. All rights reserved. This information has been obtained from sources believed reliable, but has not been verified for accuracy or completeness. You should conduct a careful, independent investigation of the property and verify all information. Any reliance on this information is solely at your own risk. CBRE and the CBRE logo are service marks of CBRE, Inc. All other marks displayed on this document are the property of their respective owners, and the use of such logos does not imply any affiliation with or endorsement of CBRE. Photos herein are the property of their respective owners. Use of these images without the express written consent of the owner is prohibited.