

KARBANK

REAL ESTATE COMPANY

INDUSTRIAL | OFFICE | COMMERCIAL
BROKERAGE & DEVELOPMENT
ESTABLISHED 1950

86,556 SF
FOR SUBLEASE



14300 NORTH PLEASANT AVENUE KANSAS CITY, MO OFFICE AND WAREHOUSE BUILDING

FEATURES

- 2,000 SF office area
- 17 dock-high doors
- 1 12' x 14' drive-in door
- 36' clear ceiling height
- ESFR sprinkler system
- LED lights
- 56 car parking
- Available within 30 days
- Sublease through 10/31/27

BASE RATE:
\$6.25/SF NNN

For more information
please contact

JOHN DELZER
jd@karbank.com

PAUL FOGEL, SIOR
pf@karbank.com



THE BARNEY BUILDING
2000 SHAWNEE MISSION PARKWAY
SUITE 400
MISSION WOODS, KS 66205

816.221.4488
816.221.4494

KARBANK.COM

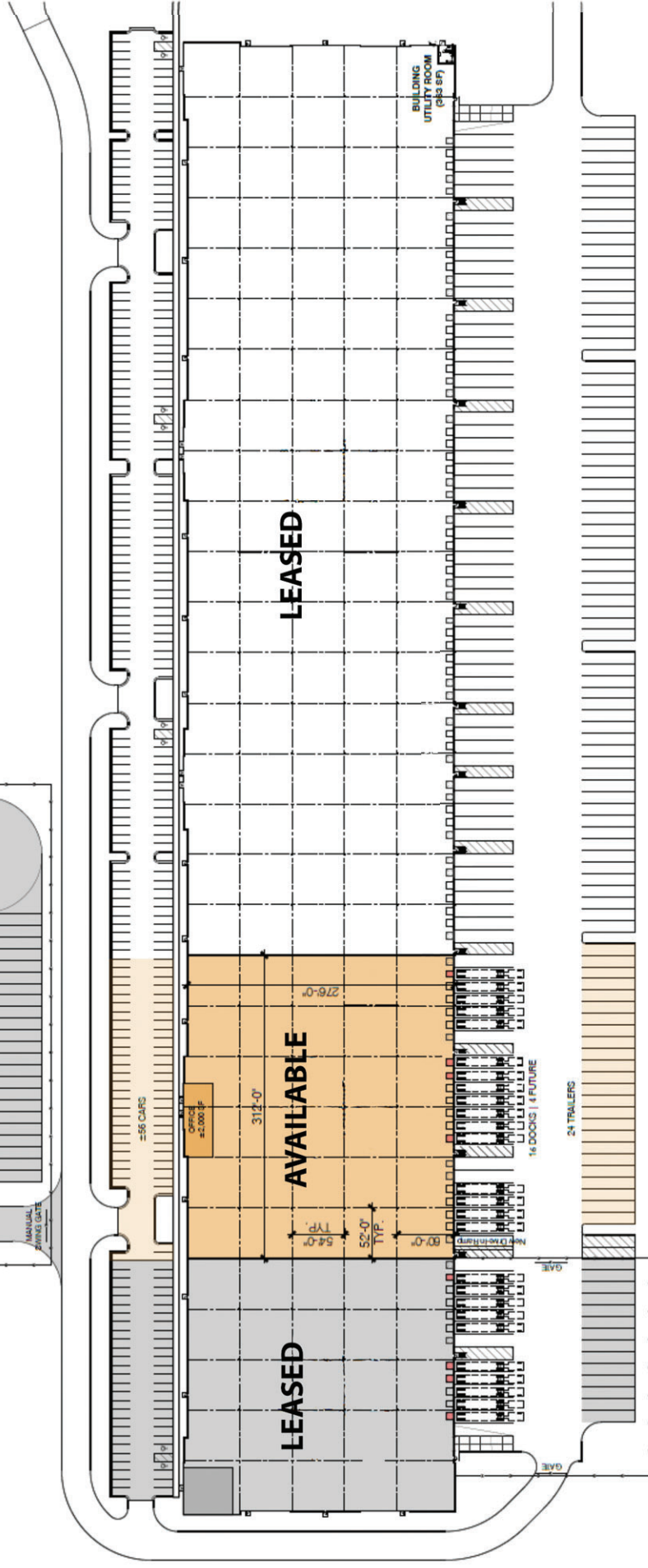
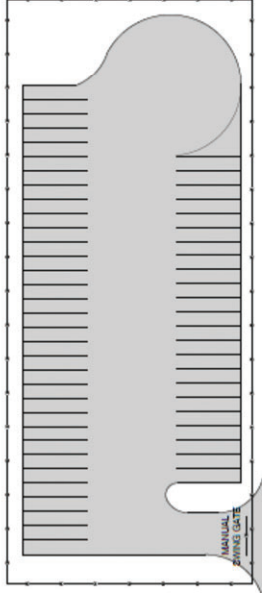
Information furnished regarding property is from sources deemed reliable but no warranty or representation is made as to the accuracy thereof and same is submitted subject to errors, omissions, prior sale or lease or withdrawal without notice.



 <p>THE BARNEY BUILDING 2000 SHAWNEE MISSION PARKWAY SUITE 400 MISSION WOODS, KANSAS 66205 KARBANK.COM</p>	<p>ADDRESS 14300 N. PLEASANT AVENUE KANSAS CITY, MO</p>	<p>TOTAL SF 86,556 SF</p>	<p>DATE 4-13-2023</p>	
	<p>PLAN TYPE FLOOR PLAN</p>	<p>TOTAL OFFICE SF 2,000 SF</p>	<p>SCALE</p>	