



7517

Precision Drive
Raleigh, NC 27617

For Sale

Justin Booth
Senior Vice President
919-424-8464
Justin.Booth@jll.com

Austin Jackson
Associate
919-424-8456
Austinp.Jackson@jll.com



7517 Precision Drive

Raleigh, NC 27617

Dock Doors	Eight (8)
Grade Level	One (1) ramped dock
Building Size	19,905 SF
Parking Spaces	40 spaces
Parcel Size	1.63 Acres
Zoning	IX-3
Year Built / Remodeled	1989 / 2016
Occupancy	100%
Projected Annual Revenue	\$281,982 as of December 1, 2024
# of Tenants	Five (5)

- Easy access to US Highway 70/Glenwood Avenue and I-540
- Approximately 5 minutes away from RDU International Airport and Brier Creek Shopping Center

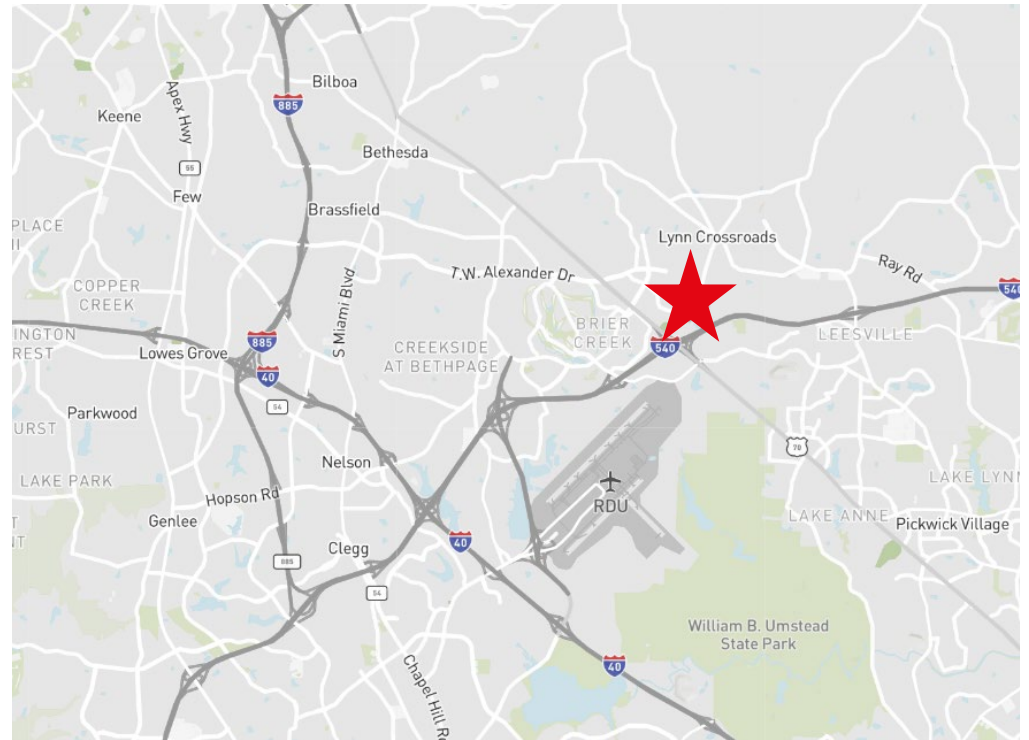

7517 Precision Drive

Floorplan

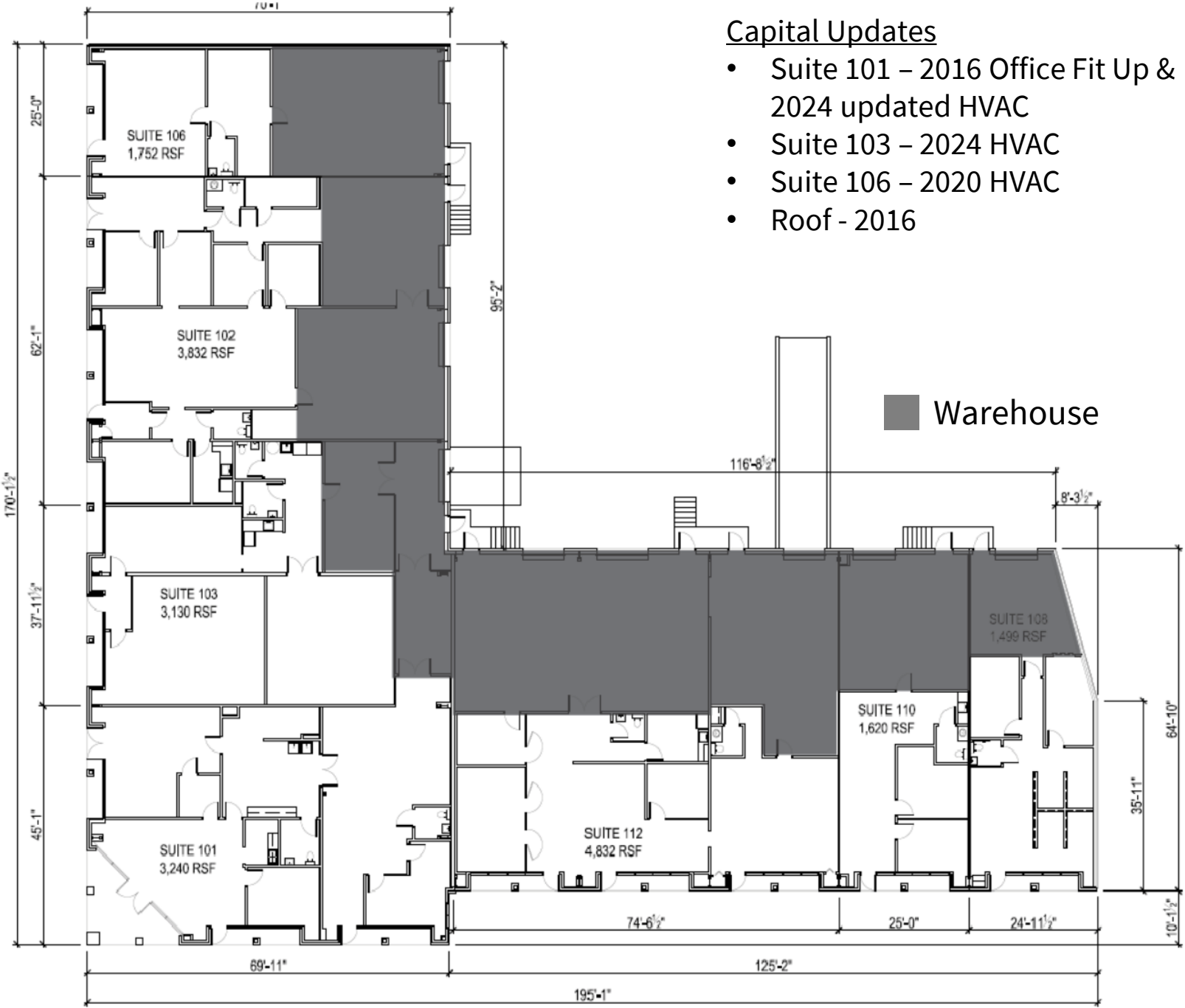

Capital Updates

- Suite 101 – 2016 Office Fit Up & 2024 updated HVAC
- Suite 103 – 2024 HVAC
- Suite 106 – 2020 HVAC
- Roof - 2016

7517 Precision Drive

Raleigh, NC 27617

Nearby Amenities:

- 1 Alexander Place
- 2 Angus Barn
- 3 Brierdale Shopping Center
- 4 Brier Creek Commons
- 5 Raleigh Durham International Airport
- 6 The Corners at Brier Creek

*Quick access to abundant restaurants, retail, hotels, and entertainment options

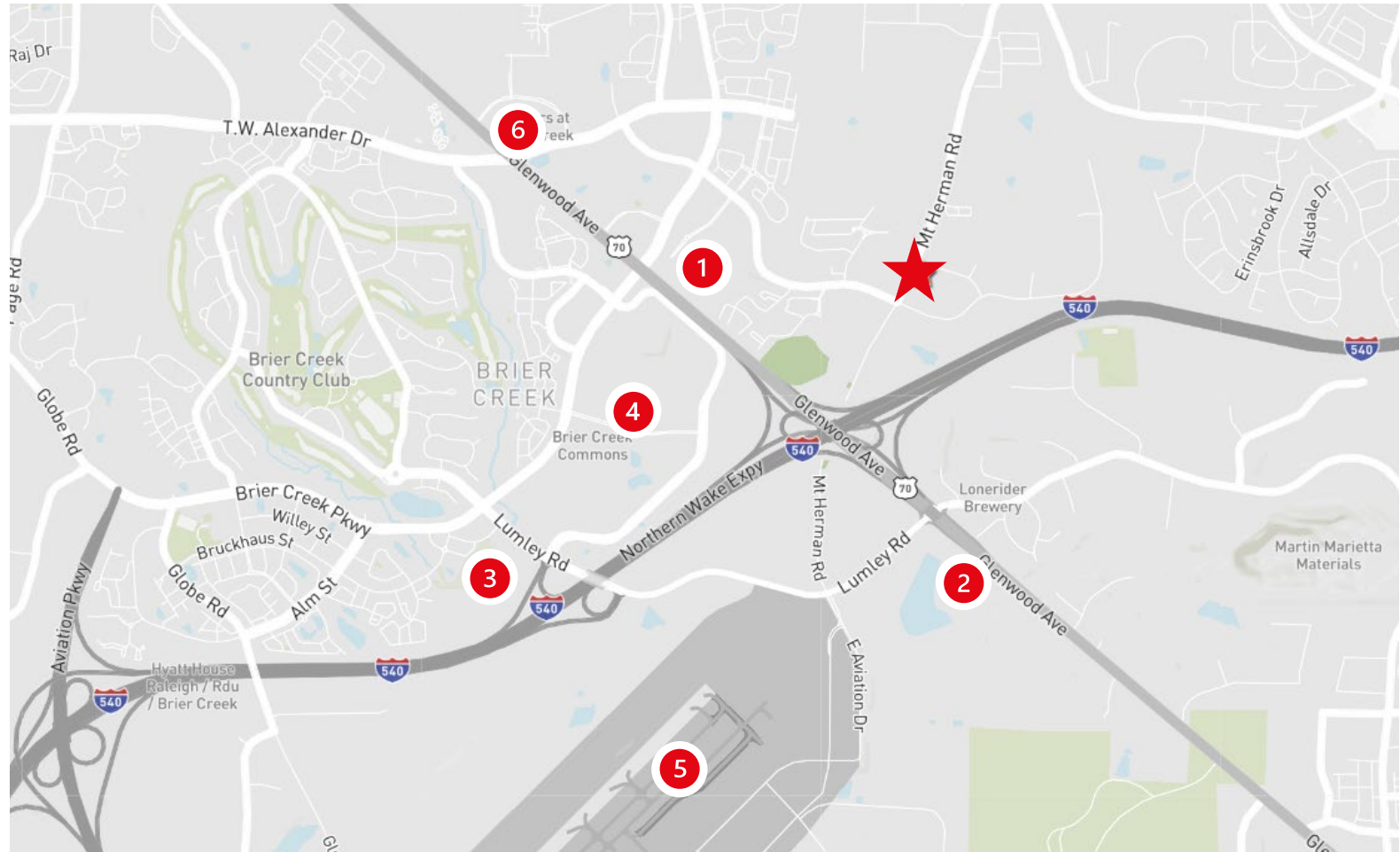

Justin Booth
Senior Vice President
919-424-8464
Justin.Booth@jll.com

Austin Jackson
Associate
919-424-8456
Austinp.Jackson@jll.com

