

3500 GRAPEVINE MILLS PKWY #200
GRAPEVINE TX 76051

Colliers

Retail Pad Site

REDEVELOPMENT OPPORTUNITY



Ground Lease
or Sale

.7604 ACRE
33,125 SF

PROPERTY *Highlights*



Located at the intersection of Grapevine Mills Blvd and Grapevine Mills Pkwy with excellent accessibility



Available pad site with existing 2-story Drive-Thru



Near various mixed-use projects, housing, restaurants, and retail in the center of the DFW Metroplex

0.7604 ACRE REDEVELOPMENT OPPORTUNITY



7,110 SF EXISTING BUILDING WITH DRIVE-THRU



Demographics	1 Mile	3 Miles
Population	3,955	48,827
Households	2,252	18,023
Median HH Income	\$81,676	\$119,718
Daytime Employment	5,080	35,945

Tanya Hart

Executive Vice President
+1 214 725 9127
tanya.hart@colliers.com

Allison Frizzo

Senior Vice President
+1 214 499 5101
allison.frizzo@colliers.com

Lauren Jahner

Senior Associate
+1 214 217 4650
lauren.jahner@colliers.com

Colliers

GRAPEVINE MILLS PKWY

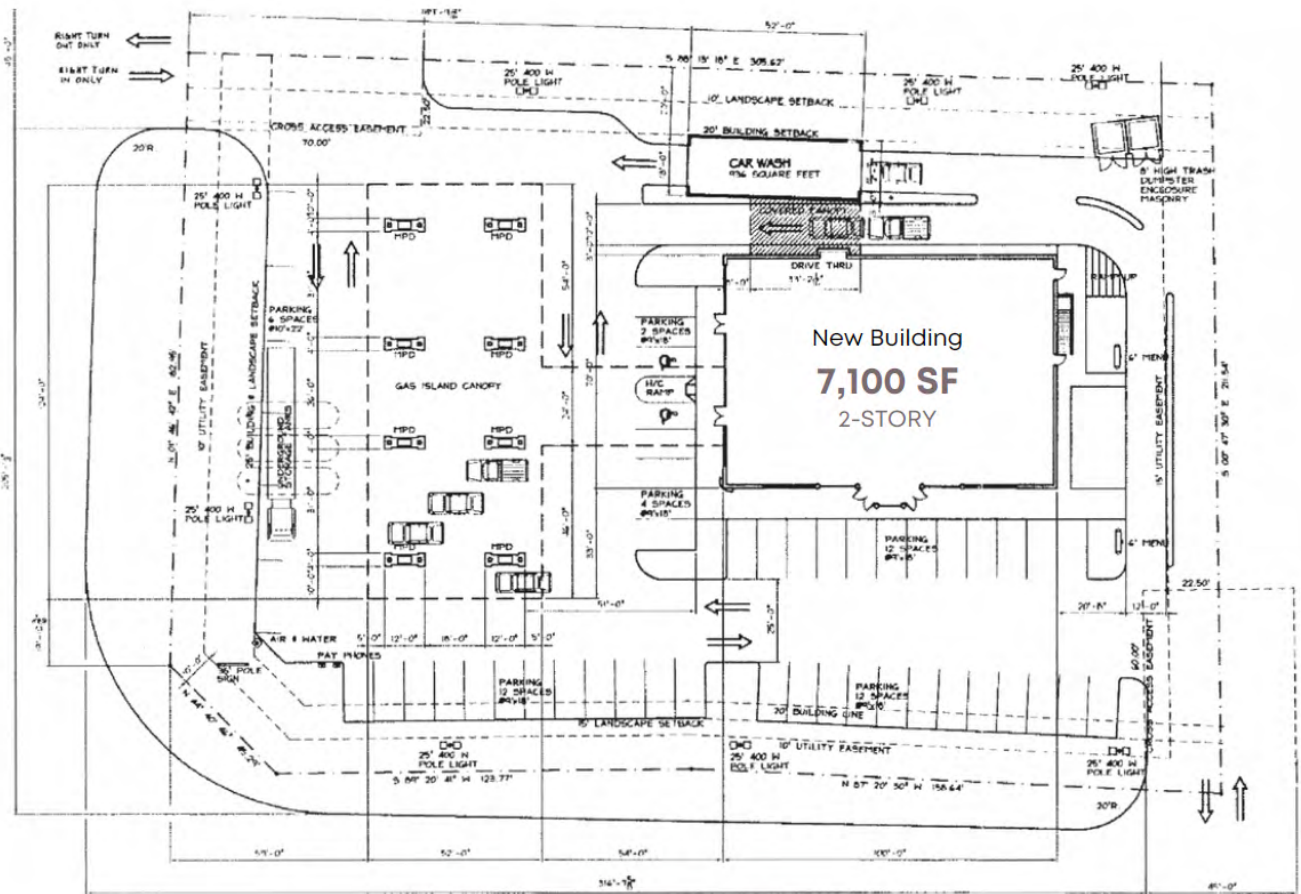

GRAPEVINE MILLS BLVD. NORTH

