



POWELL
COMMERCIAL REAL ESTATE

➤➤➤ **RETAIL SITES - WESTMORELAND, TN** <<<<



Steven Fox
Affiliate Broker
C 615.715.4825
steven@powellcre.com



139 Maple Row Blvd, Ste 104
Hendersonville, TN 37075
O 615.388.2558
www.powellcre.com

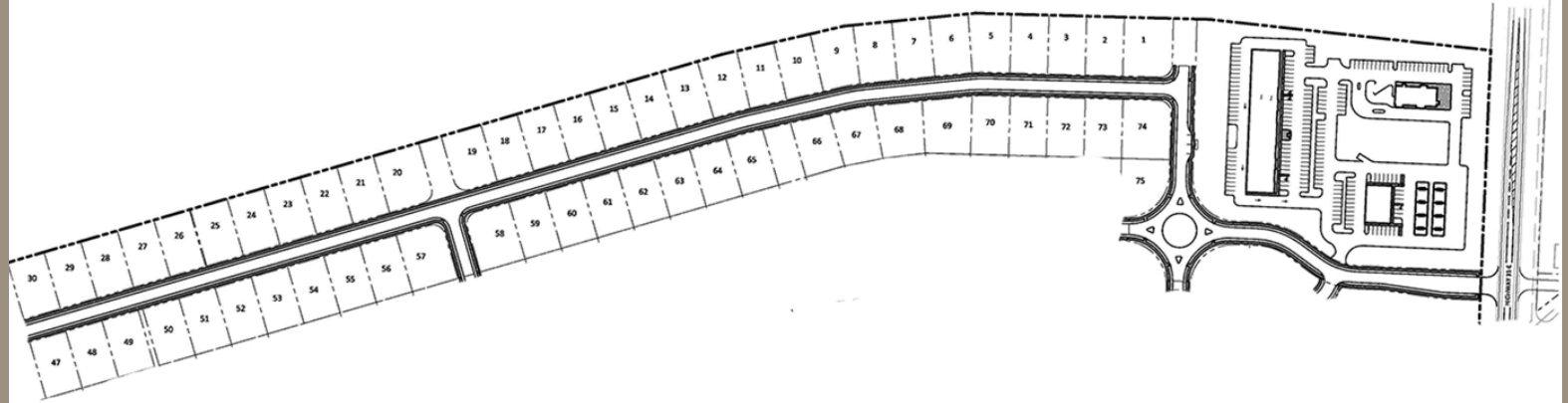

Pleasant Grove Farms

- Mastered Planned Community with Retail/Office Outparcels.
- Pleasant Grove Farms will have approximately 1,400 single family homes in total to be developed with Lennar building the first 60 single family homes.
- Westmoreland, TN is located on the Highland Rim in northern Sumner County and 4.3 miles from the southern Kentucky Border.
- With a current population of 2,803, Westmoreland is growing over 0.68% annually with a 2.79% growth from their 2020 census.
- Westmoreland has 651.9 inhabitants per square mile.
- With an average household income of \$74,029, the median age in Westmoreland is 36.8 years.

PLEASANT GROVE FARMS



PARCEL 1
2 ACRES

RETAIL/OFFICE OPPORTUNITIES

Potential Uses:

- Urgent Care Facility
- Medical Office
- General Office
- Bank
- Daycare

WESTMORELAND, TN



PARCEL 2
8.5 ACRES
(Divisible by 1.5 acres)

RETAIL/OFFICE OPPORTUNITIES

Potential Uses:

- C-Store Site
- QSR/Restaurant
- Grocery Store
- 12,000sf Stand-Alone Retail Center
- Car Wash