

Brand New Trophy Sublease



2100 L STREET, NW
WASHINGTON, DC 20037

AVISON
YOUNG



Opportunity

- 5,220 SF on the 3rd Floor
- Asking Rate: \$60 PSF
- Available: April 1, 2025
- Term: 3-10 years
- Located on prime CBD corner of 21st and L Street
- Easy access to Foggy Bottom and Farragut West Metro stations

Space Features

- Brand new trophy quality buildout (HYL design)
- Fully furnished plug & play suite
- Private suite entry with direct elevator lobby exposure
- 8 Private offices (6 windowed)
- 4 Workstations
- 2 Phone rooms
- 2 Conference rooms

Building Features

- Trophy quality building
- Rooftop terrace and lounge
- Rooftop conference center
- Spa quality fitness center
- Art gallery and pocket park

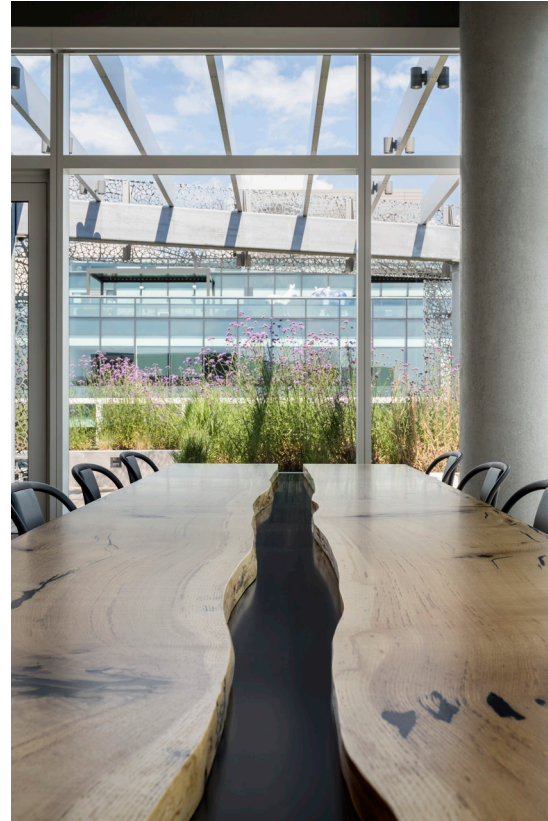

2100 L STREET, NW

3rd Floor | 5,220 SF



2100 L STREET, NW

Please note: The actual finishes selected may differ slightly from those shown in the renderings.

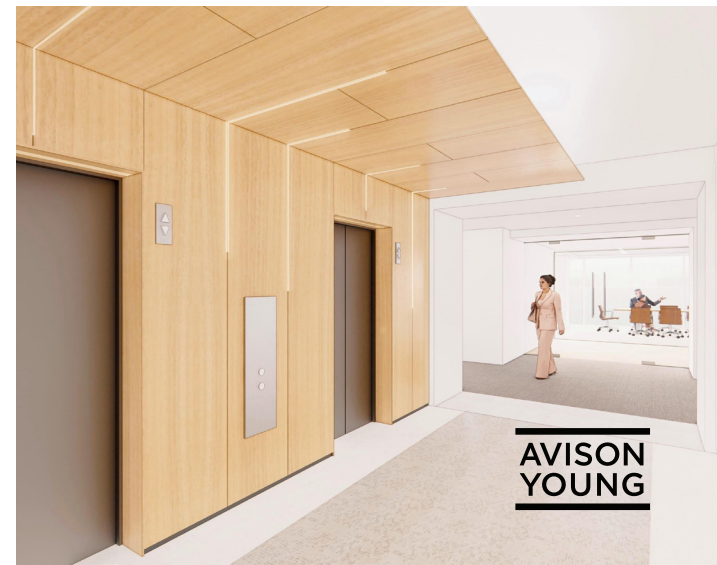



For more information, contact:

JENNA BERK

Senior Associate

202 936 7920

jenna.berk@avisonyoung.com

LAURA PETERSON

Principal

202 644 8692

laura.peterson@avisonyoung.com

BRUCE MCNAIR

Principal

202 302 1151

bruce.mcnair@avisonyoung.com