

SINGLE-TENANT NET LEASED  
INVESTMENT FOR SALE

# 261-271 GEMINI AVENUE

BREA | CA 92821



FOR MORE INFORMATION, CONTACT:

**DENNIS HOLT**

Executive Vice President

P: 949.242.1714

[dennis.holt@daumcommercial.com](mailto:dennis.holt@daumcommercial.com)

CADRE #01948978

**PAUL GINGRICH**

Executive Vice President

P: 714.941.5333

[paul.gingrich@daumcommercial.com](mailto:paul.gingrich@daumcommercial.com)

CADRE #01299770

**CHRIS MIGLIORI**

President

P: 714.941.5320

[chris.migliori@daumcommercial.com](mailto:chris.migliori@daumcommercial.com)

CADRE #00972843



D/AQ Corp. #01129558. Maps Courtesy ©Google & ©Microsoft. Although all information is furnished regarding for sale, rental or financing is from sources deemed reliable, such information has not been verified and no express representation is made nor is any to be implied as to the accuracy thereof, and it is submitted subject to errors, omissions, changes of price, rental or other conditions, prior sale, lease or financing, or withdrawal without notice.

**SINGLE-TENANT NET LEASED  
INVESTMENT FOR SALE**

# 261-271 GEMINI AVENUE

BREA | CA 92821

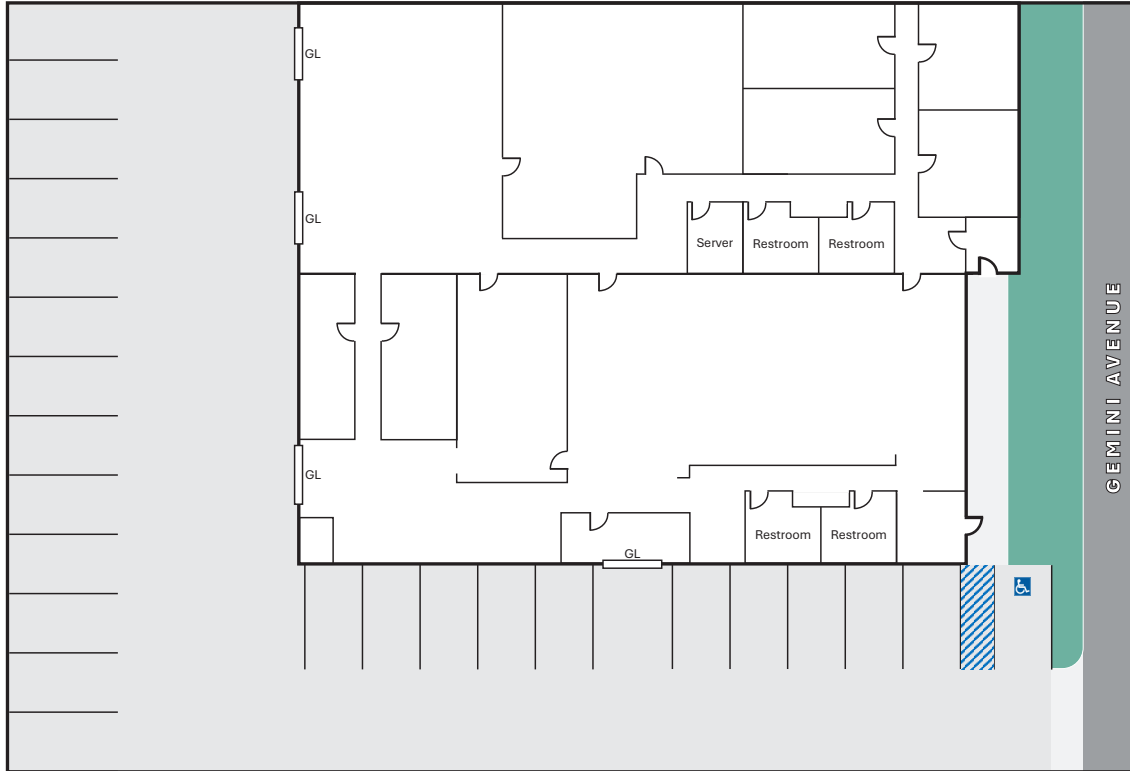

\*NOT TO SCALE

## PROPERTY HIGHLIGHTS:

- ±10,242 Square Foot Industrial Building
- Long-Term Lease In Place
- Divisible into 2 Units
- Four (4) Ground Level Loading Doors
- Highly Improved Building w/ HVAC in Warehouse
- 400 Amps of Power (verify)
- 15'-16' Warehouse Clearance Height
- Recently Renovated
- Concrete Tilt-Up Construction
- Possible Fenced Yard (verify)
- ±22,465 SF Parcel
- M2 Zoning
- Convenient Access to 57 Freeway
- Expandable to ±20,484 SF (Adjacent Building at 241-251 Gemini is For Sale)



FOR MORE INFORMATION, CONTACT:

### DENNIS HOLT

Executive Vice President

P: 949.242.1714

dennis.holt@daumcommercial.com

CADRE #01948978

### PAUL GINGRICH

Executive Vice President

P: 714.941.5333

paul.gingrich@daumcommercial.com

CADRE #01299770

### CHRIS MIGLIORI

President

P: 714.941.5320

chris.migliori@daumcommercial.com

CADRE #00972843



D/AQ Corp. #01129558. Maps Courtesy ©Google & ©Microsoft. Although all information is furnished regarding for sale, rental or financing is from sources deemed reliable, such information has not been verified and no express representation is made nor is any to be implied as to the accuracy thereof, and it is submitted subject to errors, omissions, changes of price, rental or other conditions, prior sale, lease or financing, or withdrawal without notice.

**SINGLE-TENANT NET LEASED  
INVESTMENT FOR SALE**

# 261-271 GEMINI AVENUE

BREA | CA 92821

## TENANT AND RENT ROLL

| Tenant                            | Lease Start | Lease Expiration | Lease Term Rem. | Lease Structure | Rent Start | Rent End | Annual Rent | Monthly Rent | Rent RSF | Escalations | Options    |
|-----------------------------------|-------------|------------------|-----------------|-----------------|------------|----------|-------------|--------------|----------|-------------|------------|
| QCM INC., DBA VERIS MANUFACTURING | 10/1/22     | 9/30/32          | 6.8 Years       | NNN             | 10/1/25    | 9/30/26  | \$172,812   | \$14,401     | \$1.41   | 4%          | No Options |
|                                   |             |                  |                 |                 | 10/1/26    | 9/30/27  | \$179,724   | \$14,977     | \$1.46   | 4%          |            |
|                                   |             |                  |                 |                 | 10/1/27    | 9/30/28  | \$186,912   | \$15,576     | \$1.52   | 4%          |            |
|                                   |             |                  |                 |                 | 10/1/28    | 9/30/29  | \$194,388   | \$16,199     | \$1.58   | 4%          |            |
|                                   |             |                  |                 |                 | 10/1/29    | 9/30/30  | \$202,164   | \$16,847     | \$1.64   | 4%          |            |
|                                   |             |                  |                 |                 | 10/1/30    | 9/30/31  | \$210,252   | \$17,521     | \$1.71   | 4%          |            |
|                                   |             |                  |                 |                 | 10/1/31    | 9/30/32  | \$218,664   | \$18,222     | \$1.78   | 4%          |            |

### TENANT SUMMARY

**QCM INC., A CALIFORNIA CORPORATION DBA VERIS MANUFACTURING**

**GUARANTOR:**  **Emerald TECHNOLOGIES**

The lease is guaranteed by Emerald Technologies U.S. Acquisition Co., Inc. . Emerald Technologies is a global electronics manufacturing services (EMS) provider for original equipment manufacturer (OEM) customers, with a focus on high-reliability general and custom electronic assemblies. The company has manufacturing facilities in California, Oregon, Michigan, New Hampshire, China and Malaysia. With ISO certification the company specializes in high-mix manufacturing for high-reliability markets in the Aerospace & Defense, Energy, Life Sciences, Industrial & Semiconductor and Enterprise Communications sectors.

### LEASE SUMMARY

|                             |  |
|-----------------------------|--|
| <b>Lease Type:</b>          | Standard AIR Industrial/Commercial Single-Tenant Lease- NNN  |
| <b>Commencement Date:</b>   | 10/1/2022  |
| <b>Expiration Date:</b>     | 9/30/2032  |
| <b>Current Base Rent:</b>   | \$14,401   |
| <b>Annual Increases:</b>    | 4%   |
| <b>Security Deposit:</b>    | \$20,000   |
| <b>Options To Extend:</b>   | None   |
| <b>Options to Purchase:</b> | None   |
| <b>Guarantor:</b>           | Emerald Technologies U.S. Acquisition Co., Inc. <a href="http://emeraldtechnologies.com">emeraldtechnologies.com</a> |

#### FOR MORE INFORMATION, CONTACT:

**DENNIS HOLT**  
Executive Vice President  
P: 949.242.1714  
[dennis.holt@daumcommercial.com](mailto:dennis.holt@daumcommercial.com)  
CADRE #01948978

**PAUL GINGRICH**  
Executive Vice President  
P: 714.941.5333  
[paul.gingrich@daumcommercial.com](mailto:paul.gingrich@daumcommercial.com)  
CADRE #01299770

**CHRIS MIGLIORI**  
President  
P: 714.941.5320  
[chris.migliori@daumcommercial.com](mailto:chris.migliori@daumcommercial.com)  
CADRE #00972843



D/AQ Corp. #01129558. Maps Courtesy ©Google & ©Microsoft. Although all information is furnished regarding for sale, rental or financing is from sources deemed reliable, such information has not been verified and no express representation is made nor is any to be implied as to the accuracy thereof, and it is submitted subject to errors, omissions, changes of price, rental or other conditions, prior sale, lease or financing, or withdrawal without notice.



# CORPORATE NEIGHBORS & NEARBY AMENITIES

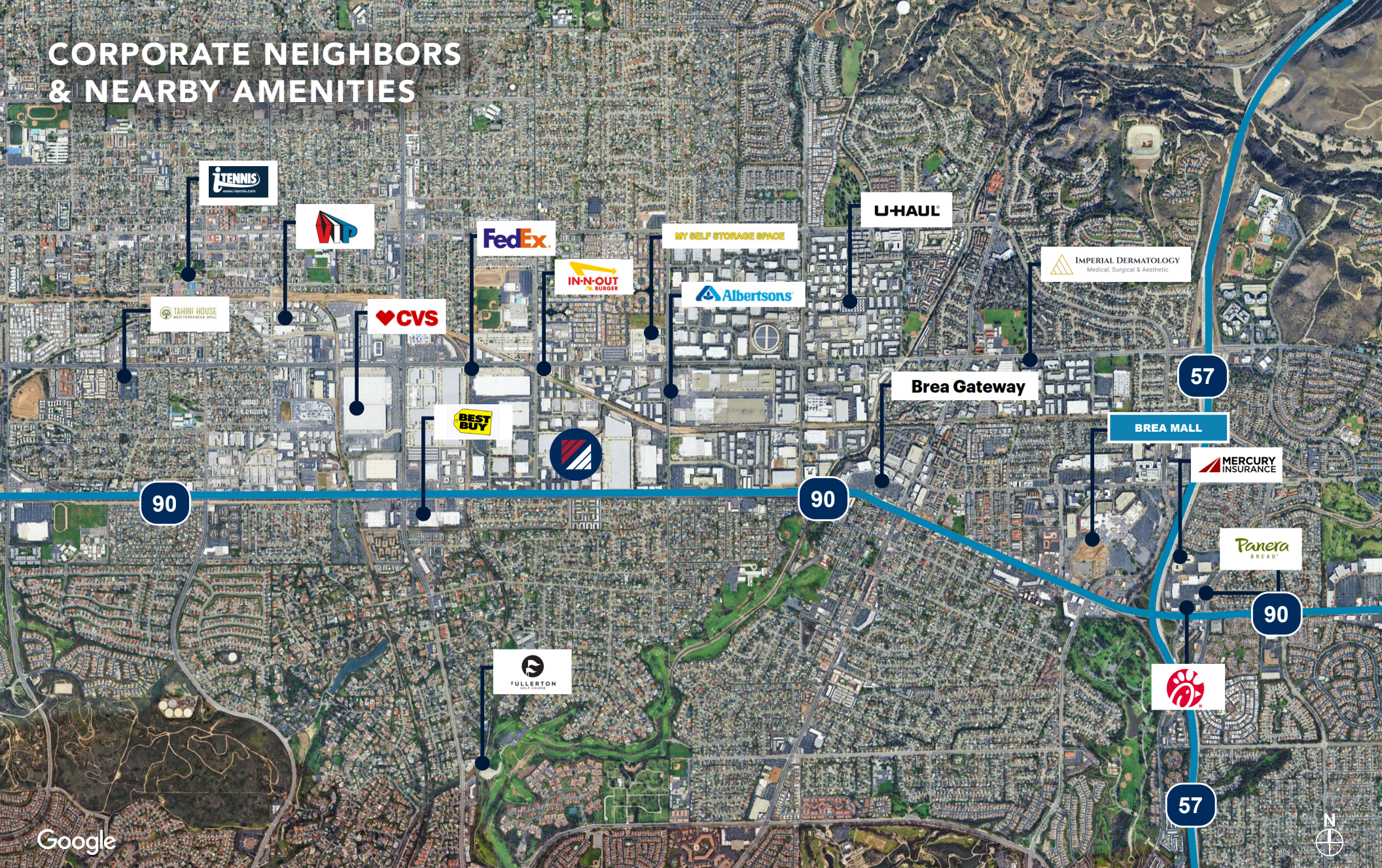

FOR MORE INFORMATION, CONTACT:

**DENNIS HOLT**  
Executive Vice President  
P: 949.242.1714  
dennis.holt@daumcommercial.com  
CADRE #01948978

**PAUL GINGRICH**  
Executive Vice President  
P: 714.941.5333  
paul.gingrich@daumcommercial.com  
CADRE #01299770

**CHRIS MIGLIORI**  
President  
P: 714.941.5320  
chris.migliori@daumcommercial.com  
CADRE #00972843

**DAUM**  
COMMERCIAL REAL ESTATE SERVICES

D/AQ Corp. #01129558. Maps Courtesy ©Google & ©Microsoft. Although all information is furnished regarding for sale, rental or financing is from sources deemed reliable, such information has not been verified and no express representation is made nor is any to be implied as to the accuracy thereof, and it is submitted subject to errors, omissions, changes of price, rental or other conditions, prior sale, lease or financing, or withdrawal without notice.