

- GENERAL LIGHTING NOTES**
1. ALL INTERIOR AND EXTERIOR LIGHTING FIXTURES SHALL BE PURCHASED BY OWNER. THE CONTRACTOR SHALL BE RESPONSIBLE FOR RECEIVING, INSPECTING, STORING, AND INSTALLING ALL LIGHTING FIXTURES. CONTRACTOR SHALL INVENTORY LIGHT FIXTURES AND LAMPS UPON RECEIPT. CONTRACTOR WILL REPORT DAMAGE AND SHORTAGES WITHIN 48 HOURS OF RECEIPT OF SHIPMENT. PACKING LISTS ARE TO BE FAXED TO 913-288-8026 ATTENTION: LIGHTING DEPARTMENT. ANY DAMAGE OR SHORTAGES CLAIMED OUTSIDE THE 48 HOUR WINDOW WILL BE THE FINANCIAL RESPONSIBILITY OF THE CONTRACTOR TO REPLACE.
 2. IT IS THE RESPONSIBILITY OF THE CONTRACTOR TO FINISH THE ELECTRICAL SYSTEM DESIGN (DESIGN BUILD).
 3. IT IS THE RESPONSIBILITY OF THE CONTRACTOR TO MAKE SURE THAT ALL ELECTRICAL LOCAL, STATE, AND NATIONAL CODES AND LIGHTING STANDARDS ARE MET.
 4. IT IS THE RESPONSIBILITY OF THE CONTRACTOR TO DESIGN BUILD THE EMERGENCY SYSTEM.
 5. CONTRACTOR/OWNER IS RESPONSIBLE TO PROVIDE ANY AND ALL LIGHTING NOT SHOWN ON THIS L-1 PLAN.
 6. THE ELECTRICAL CONTRACTOR SHALL COMPLY WITH ALL REQUIREMENTS, REGULATIONS, CODES, ORDINANCE, RULING OR FIRE UNDERWRITER'S APPLICABLE TO THIS CLASS OF WORK AS ADOPTED BY THE CITY AND SHALL CONFORM TO THE REQUIREMENTS OF THE LOCAL POWER COMPANY.
 7. THE ELECTRICAL CONTRACTOR SHALL PROVIDE ALL CEILING SPACERS, BOXER, FITTINGS, CHANNEL ALIGNERS AND ANY OTHER HARDWARE REQUIRED FOR COMPLETE INSTALLATION OF ALL LIGHT FIXTURES PROVIDED BY OWNER AND/OR CONTRACTOR UNLESS OTHERWISE NOTED.
 8. REFER TO LIGHT FIXTURE SCHEDULE (FOR INFORMATION ON LIGHT FIXTURE TYPES AND RESPONSIBILITIES).
 9. ALL EMERGENCY LIGHTS AND EXIT SIGNS SHALL BE CONNECTED TO A SEPARATE UNSWITCHED CONDUCTOR BYPASSING ALL OTHER CONTROLS AND CONTRACTORS WHEN NOT ON PANELBOARD "EM". EMERGENCY BATTERY PACKS/BALLASTS FOR EMERGENCY LIGHTS AND EXIT SIGNS SHALL NOT BE SWITCHED. REFER TO MANUFACTURER'S WRITTEN INSTRUCTIONS FOR PROPER INSTALLATION AND TESTING. ALLOW BATTERY TO CHARGE FOR A MINIMUM OF 168 HOURS BEFORE INITIAL TESTING. AFTER EMERGENCY LIGHT HAS BEEN POWERED DO NOT TURN OFF POWER FOR EXTENDED PERIODS OF TIME.
 10. CONTRACTOR SHALL BE RESPONSIBLE FOR INSURING THAT COORDINATION AND CONFLICT ISSUES BE RESOLVED BY DSG AND CONTRACTOR PRIOR TO INSTALLATION OF LIGHT FIXTURES. CONTRACTOR SHALL BE HELD FINANCIALLY RESPONSIBLE FOR COMPLYING WITH REQUEST THAT DSG BE CONTACTED IN CASE OF CONFLICT WITH LIGHTING POSITIONS AS INDICATED ON SHEET LTG, AND WITH ANY OTHER TRADES.
 11. ALL LIGHT FIXTURES OVER OPEN FOOD AREAS, COFFIN CASES AND FOOD PREP AREAS SHALL PROVIDED WITH PROTECT-A-LAMP COVERS OR EQUIVALENT SHIELDED OR SHATTERPROOF LAMPS. CONTRACTOR SHALL VERIFY THAT ALL AREAS ARE PROPERLY PROTECTED AFTER STORE SET-UP IS COMPLETE.

LIGHTING PLAN NOTES

- NOTE 1: ALL TYPE ML-1 & ML-3 TRACK IS CABLE MOUNTED WITH A 9'-0" AFF.
- NOTE 2: TYPE K TO BE CABLE MOUNTED WITH BOTTOM OF FIXTURE TO BE 7'-0" AFF. MFG WILL SUPPLY CABLES.
- NOTE 3: INSTALL TYPE ML-2 AT 6'-6" AFF.
- NOTE 4: SECURE TYPE B8 & B4 WALLWASH FIXTURES 3'-0" FROM WALL UNLESS OTHERWISE DIMENSIONED CONTRACTOR SHALL ORIENT FIXTURE'S REFLECTOR TO FACE WALL.

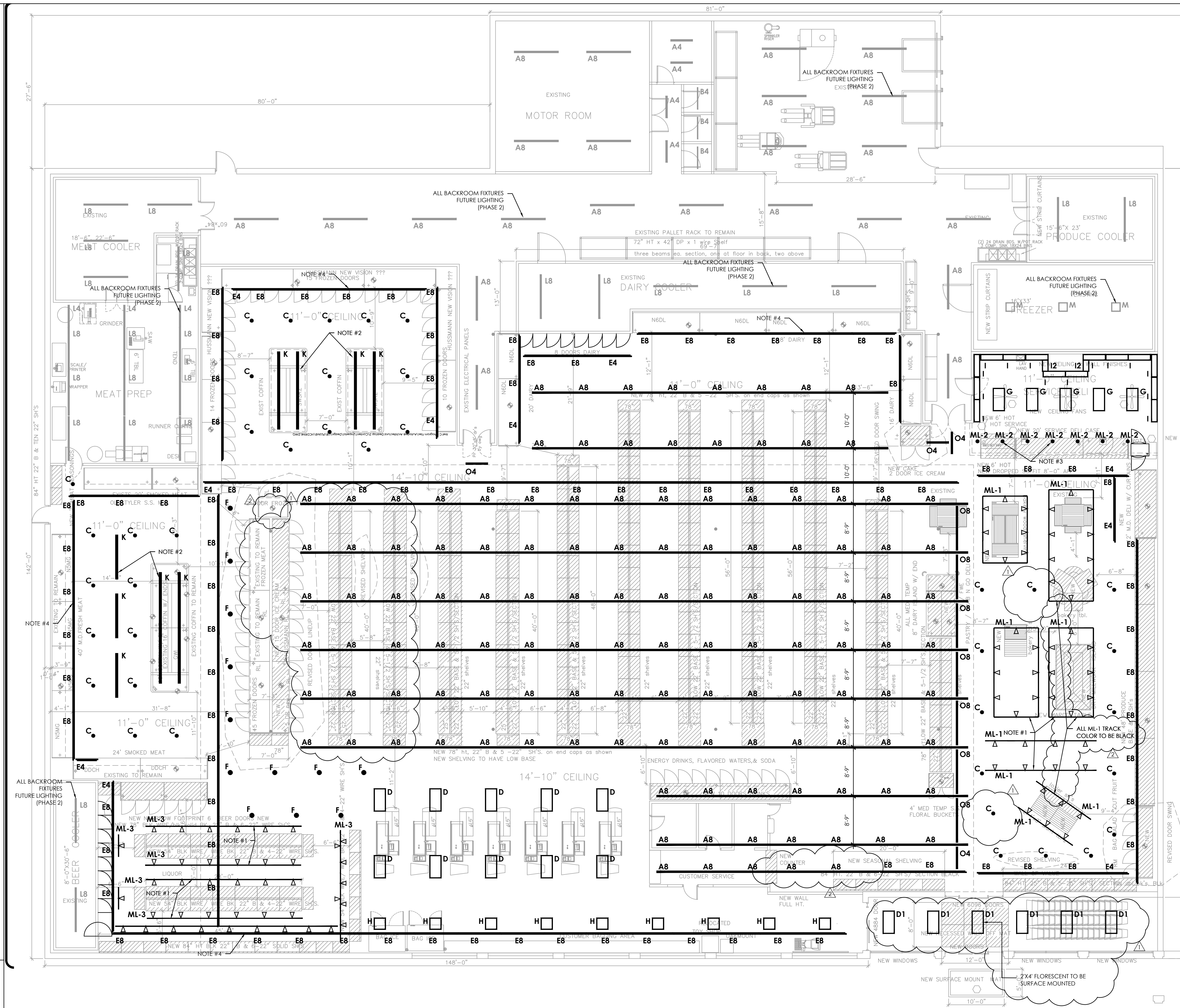

REVISIONS	DATE
△ REMOVED A4, F & K FIXTURES; ADDED/MOVED C & A8 FIXTURES PER UPDATED PLAN;	6/7/11
RELABELLED VESTIBULE LIGHTING AND ADDED NOTE	
△ REMOVED E8 & F FIXTURES, ADDED A8 & NOTE TO ML-1	6/16/11

STORE PROPOSAL FOR:
PRICE CHOPPER
4639 HOUSE SPRINGS CENTER
HOUSE SPRINGS, MO 63051



DESIGN
SOURCE
GROUP

417 S. 42nd St.
Kansas City, KS 66106
913-288-8008

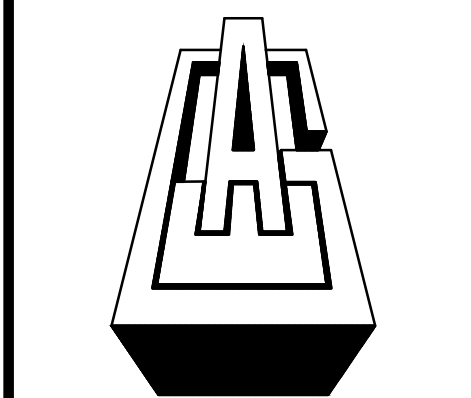

ASSOCIATED WHOLESALE
GROCERS, INC.



DRAWN BY CDV
DESIGNED BY CDV
ISSUE DATE 6/3/11
PROJECT NUMBER 0807.1
SCALE 1/8" = 1'-0"
LIGHTING SHEET L1