

# 51<sup>st</sup> Avenue Warehouse And Yard

9759 - 51<sup>st</sup> Avenue  
Edmonton, Alberta  
[www.cbre.ca](http://www.cbre.ca)

Heavy Power | Cranes | Drive-Thru Loading



**51<sup>st</sup> Avenue Warehouse And Yard**  
9759 - 51<sup>st</sup> Avenue | Edmonton, Alberta

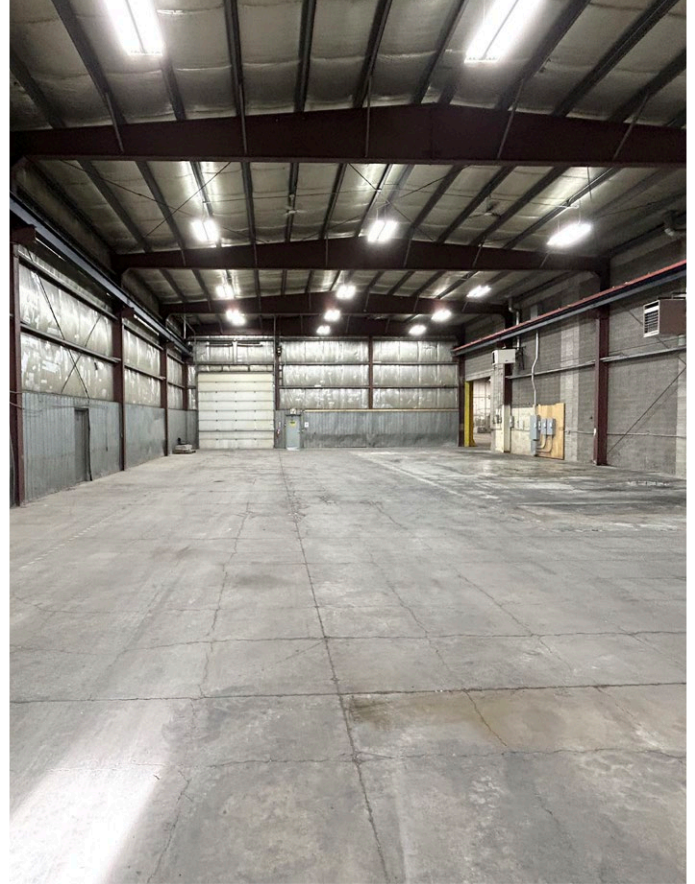

# 51<sup>st</sup> Avenue Warehouse And Yard

The site offers great exposure to 51<sup>st</sup> Avenue, featuring drive-thru loading, heavy power, wide-span craneways and two acres of graveled yard. Excellent access to 99<sup>th</sup> Street, Whitemud Drive, Anthony Henday Drive, and the QEII Highway.

## Property Details

Legal Address	Plan 7721481; Block 2; Lot 5
Zoning	BE - Business Employment
Year Built	1974
Site Size	±2.10 Acres
Available Area	Building 1: ±23,200 sq. ft. Building 2: ±3,945 sq. ft.
Construction	Metal cladding and concrete block
Op Costs	\$4.25 per sq. ft. / annum
Lease Rate	\$12.25 per sq. ft. / annum
Available	Immediately

# Building 1

Available Area	±23,200 sq. ft.
Loading	(2) 14' x 16' drive-thru grade (1 automatic) (1) 16' x 14' grade
Ceiling Height	East Shop: 22' 10" clear 17' underhook West Shop: 24' clear 18' 6" underhook
Power	600 amp, 208 volt, 3-phase <i>*To be confirmed</i>
Heating	Shop: forced air heating Office: HVAC
Lighting	Fluorescent throughout
Downdraft Fans	Yes
Trench Drains	Yes
Cranes	East Shop: 54'8" crane span West Shop: 57'8" crane span

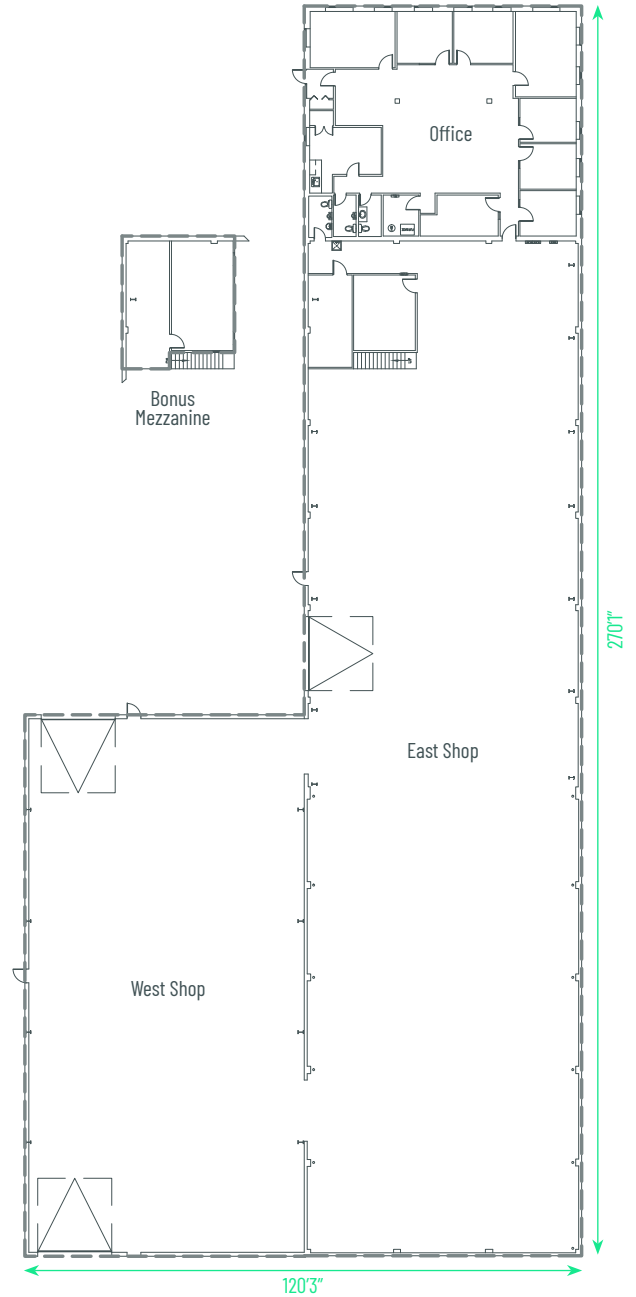

# Building 2

Available Area	3,945 sq. ft.
Loading	(2) 12' x 14' grade
Ceiling Height	18' clear
Power	200 amp, 200 volt, 3-phase <i>*To be confirmed</i>
Heating	Radiant tube
Lighting	Fluorescent throughout
Downdraft Fans	Yes
Trench Drains	Yes

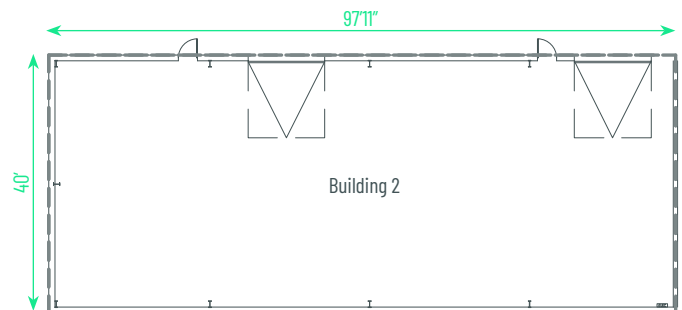



## Contact Us

**Kevin Hughes**

Senior Vice President  
+1 780 917 4634  
kevin.hughes@cbre.com

**Gregg Maimann**

Senior Vice President  
+1 780 917 4632  
gregg.maimann@cbre.com

**Trevor Schmidt**

Vice President  
+1 780 917 4641  
trevor.schmidt@cbre.com

**Jordan Adams**

Vice President  
+1 780 917 4645  
jordan.adams@cbre.com

**Braylon Klemchuk**

Vice President  
+1 780 229 4687  
braylon.klemchuk@cbre.com

**Jay Olmstead**

Sales Representative  
+1 780 554 1191  
jay.olmstead@cbre.com  
**\*Lead Broker**

**John Allan McKay**

Associate  
+1 780 915 5020  
johnallan.mckay@cbre.com

**Lucas Neumeyer**

Associate  
+1 780 850 2267  
lucas.neumeyer@cbre.com

\*(Sub) Tenant / Purchaser is responsible to confirm the electrical service to the premises / building and ensure it is sufficient for their intended use.

This disclaimer shall apply to CBRE Limited, Real Estate Brokerage, and to all other divisions of the Corporation; to include all employees and independent contractors ("CBRE"). The information set out herein, including, without limitation, any projections, images, opinions, assumptions and estimates obtained from third parties (the "Information") has not been verified by CBRE, and CBRE does not represent, warrant or guarantee the accuracy, correctness and completeness of the Information. CBRE does not accept or assume any responsibility or liability, direct or consequential, for the Information or the recipient's reliance upon the Information. The recipient of the Information should take such steps as the recipient may deem necessary to verify the Information prior to placing any reliance upon the Information. The Information may change and any property described in the Information may be withdrawn from the market at any time without notice or obligation to the recipient from CBRE. CBRE and the CBRE logo are the service marks of CBRE Limited and/or its affiliated or related companies in other countries. All other marks displayed on this document are the property of their respective owners. All Rights Reserved.