

Downtown Office

600 S Main Street

3rd & 4th Floor Available

Greenville, South Carolina
Site #2414

±12,012 SF Across from Falls Park in Downtown Greenville



Floor Plans & Photos

±12,012 SF Available | Suite 300 & 400

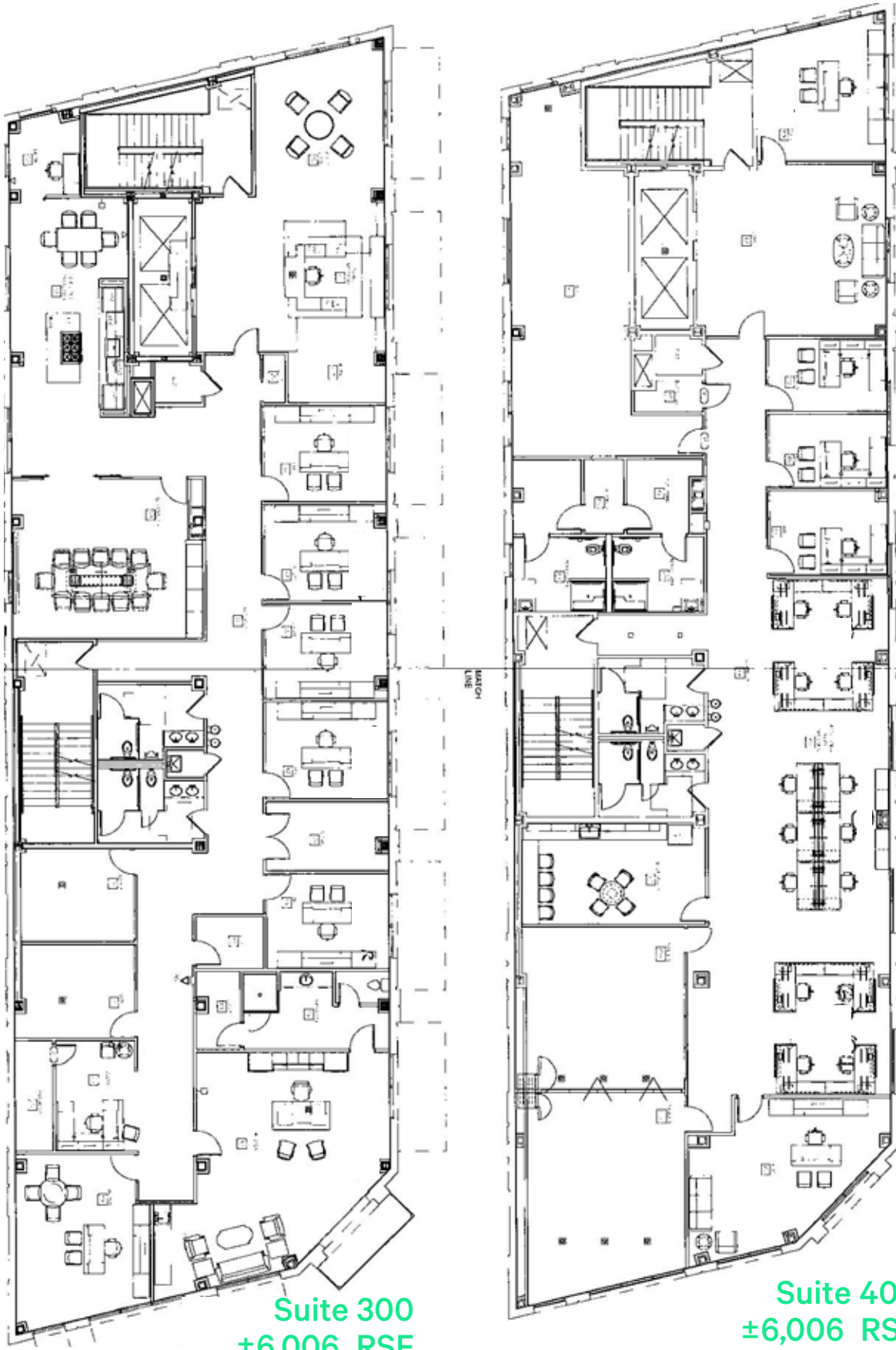

Suite 300
±6,006 RSF

Suite 400
±6,006 RSF

Downtown Office Space

600 S Main Street, Greenville, SC 29601

For Sublease



Property Details

Office Space Across from Falls Park in Downtown Greenville

- + 3rd & 4th Floor available
 - Suite 300 | ±6,006 RSF
 - Suite 400 | ±6,006 RSF
- + Master lease expires 4/30/2027
- + Parking in adjacent city garage
- + Building amenities include two retail tenants Jianna & Lululemon
- + The 4th floor contains a full catering kitchen & fitness center
- + Lease Rate: \$42.00/SF Full Service



Contact Us

Charles Gouch, CCIM, SIOR

Senior Vice President

+1 864 527 6035

charles.gouch@cbre.com

© 2024 CBRE, Inc. All rights reserved. This information has been obtained from sources believed reliable, but has not been verified for accuracy or completeness. You should conduct a careful, independent investigation of the property and verify all information. Any reliance on this information is solely at your own risk. CBRE and the CBRE logo are service marks of CBRE, Inc. All other marks displayed on this document are the property of their respective owners, and the use of such logos does not imply any affiliation with or endorsement of CBRE. Photos herein are the property of their respective owners. Use of these images without the express written consent of the owner is prohibited.