

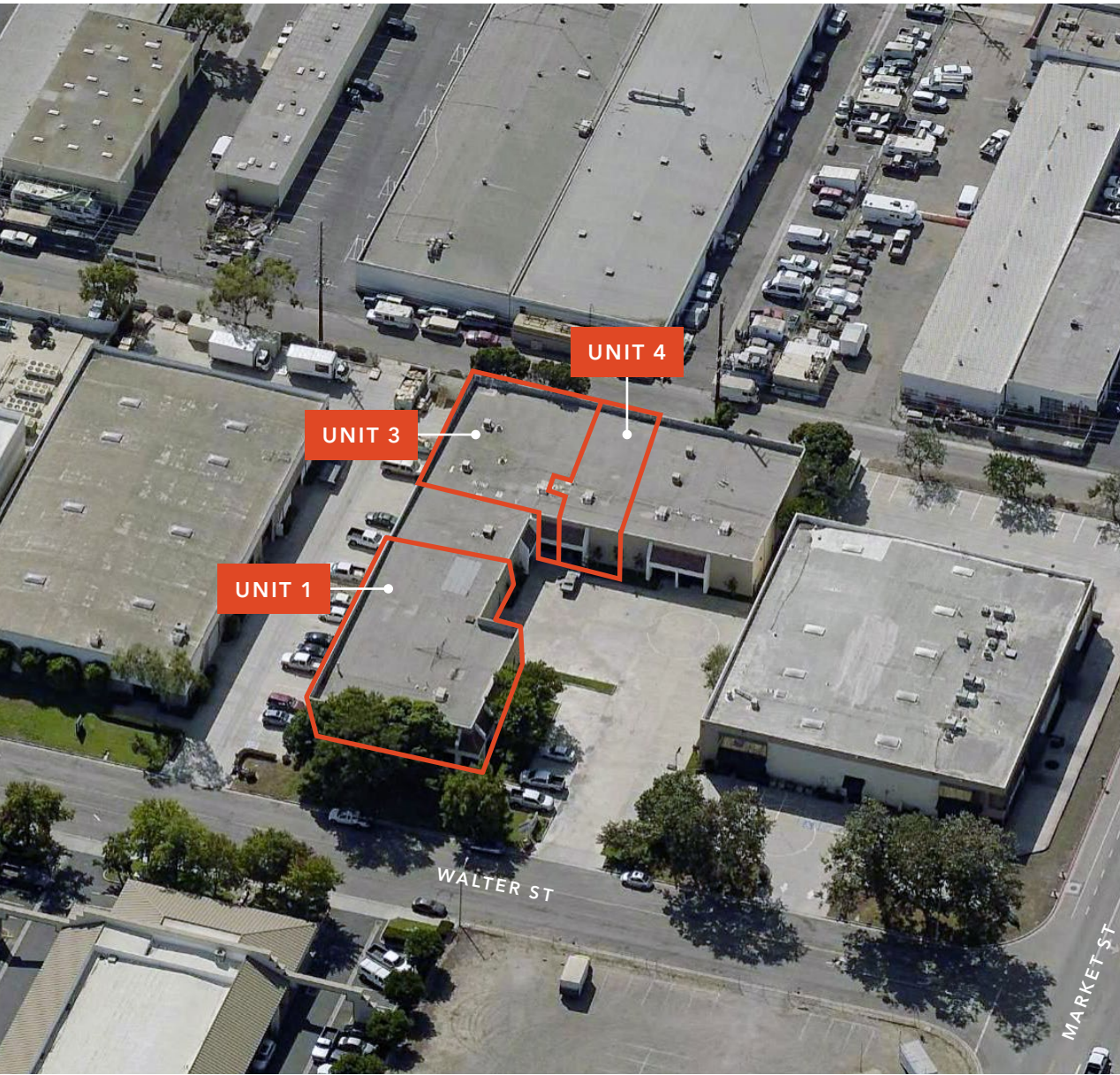

1595 WALTER ST UNITS 1, 3, & 4

*3 Individual Industrial
Units with Roll Up Doors*

VENTURA, CA 93003



Property Overview

UNIT SIZES

| | |
|---------------|-------------------------------------|
| UNIT 1 | 5,600 SF + 1,900 SF Bonus Storage |
| UNIT 3 | 4,500 SF |
| UNIT 4 | 2,730 SF |
| LOT SIZE | 1.01 AC |
| YEAR BUILT | 1984 |
| ZONING | MPD (Ventura) |
| PARKING | 37 Total |
| ROLL UP DOORS | 1 (10' x 10') per unit |
| CLEAR HEIGHT | 14' |
| SPRINKLERS | Wet |
| POWER | 480v 3 Phase (400 amps to building) |

Property Highlights

- Private Entrances
- Highly Flexible Office Spaces
- 101 Freeway Accessibility
- Commercial-Business Area
- Nearby Amenities

Unit 1 Overview

| | |
|---------------|----------------------------|
| UNIT SIZE | 5,600 SF |
| BONUS STORAGE | 1,900 SF |
| ZONING | MPD |
| OFFICE | 15% |
| ROLL UP DOORS | 1 (10' x 10') |
| CLEAR HEIGHT | 14' |
| SPRINKLERS | Yes |
| POWER | 200 amps 240/120 v 3 Phase |
| LEASE RATE | \$6,440/Mo/IG |
| LEASE RATE/SF | \$1.15 IG |

Property Highlights

Street Visible Front Unit

Recently Renovated

Minimal Office

Bonus Mezzanine Storage





FLOOR PLAN

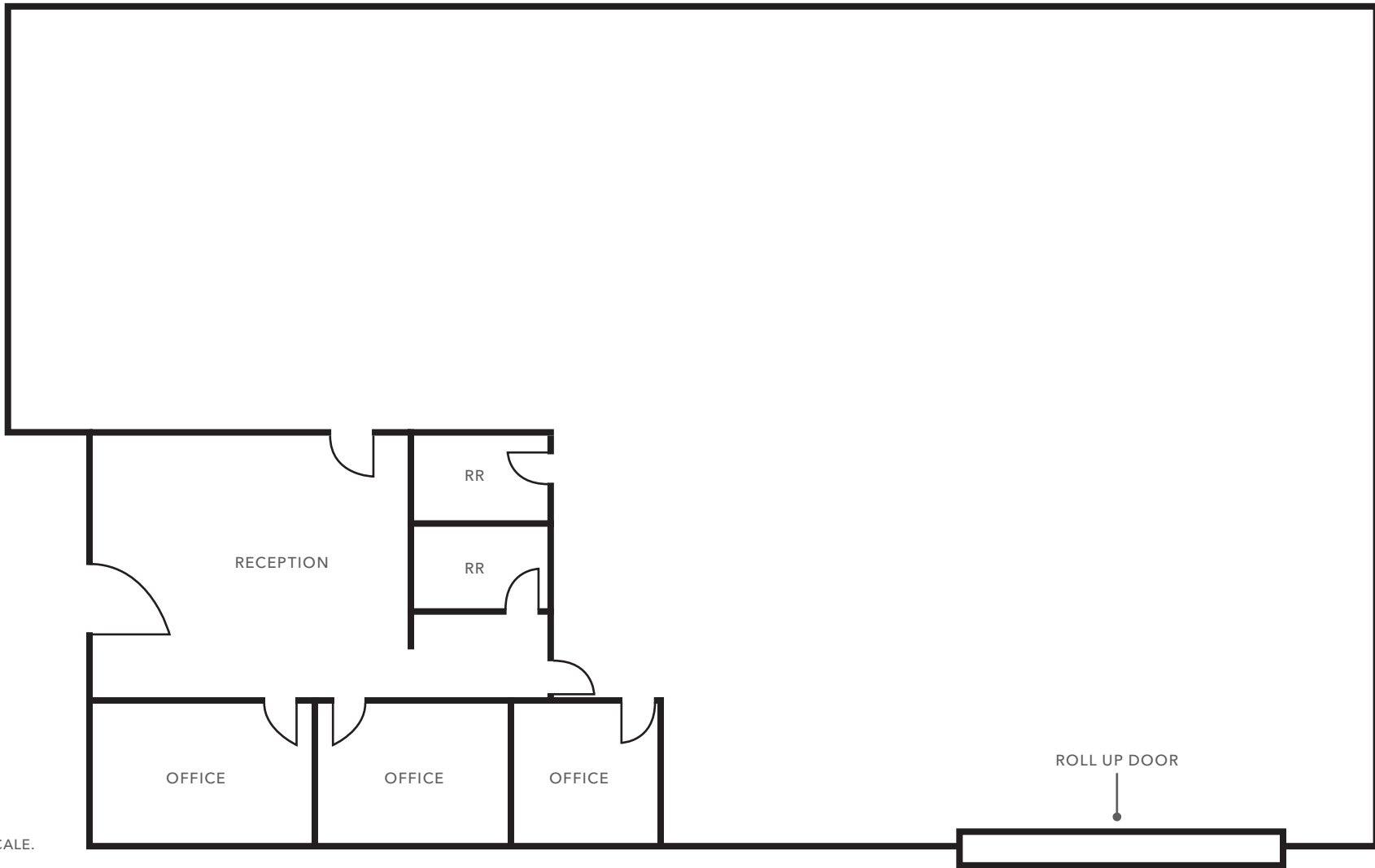

NOT TO SCALE.

Unit 3 Overview

| | |
|---------------|---------------------------|
| UNIT SIZE | 4,500 SF |
| ZONING | MPD |
| OFFICE | 19% |
| ROLL UP DOORS | 1 (10' x 10') |
| CLEAR HEIGHT | 14' |
| SPRINKLERS | Yes |
| POWER | 225 amps 24/120 v 3 Phase |
| LEASE RATE/SF | \$1.11 IG |
| LEASE RATE/MO | \$5,000 IG |

Unit Highlights

Recently Renovated

HVAC in Warehouse

Gated Loading



FLOOR PLAN

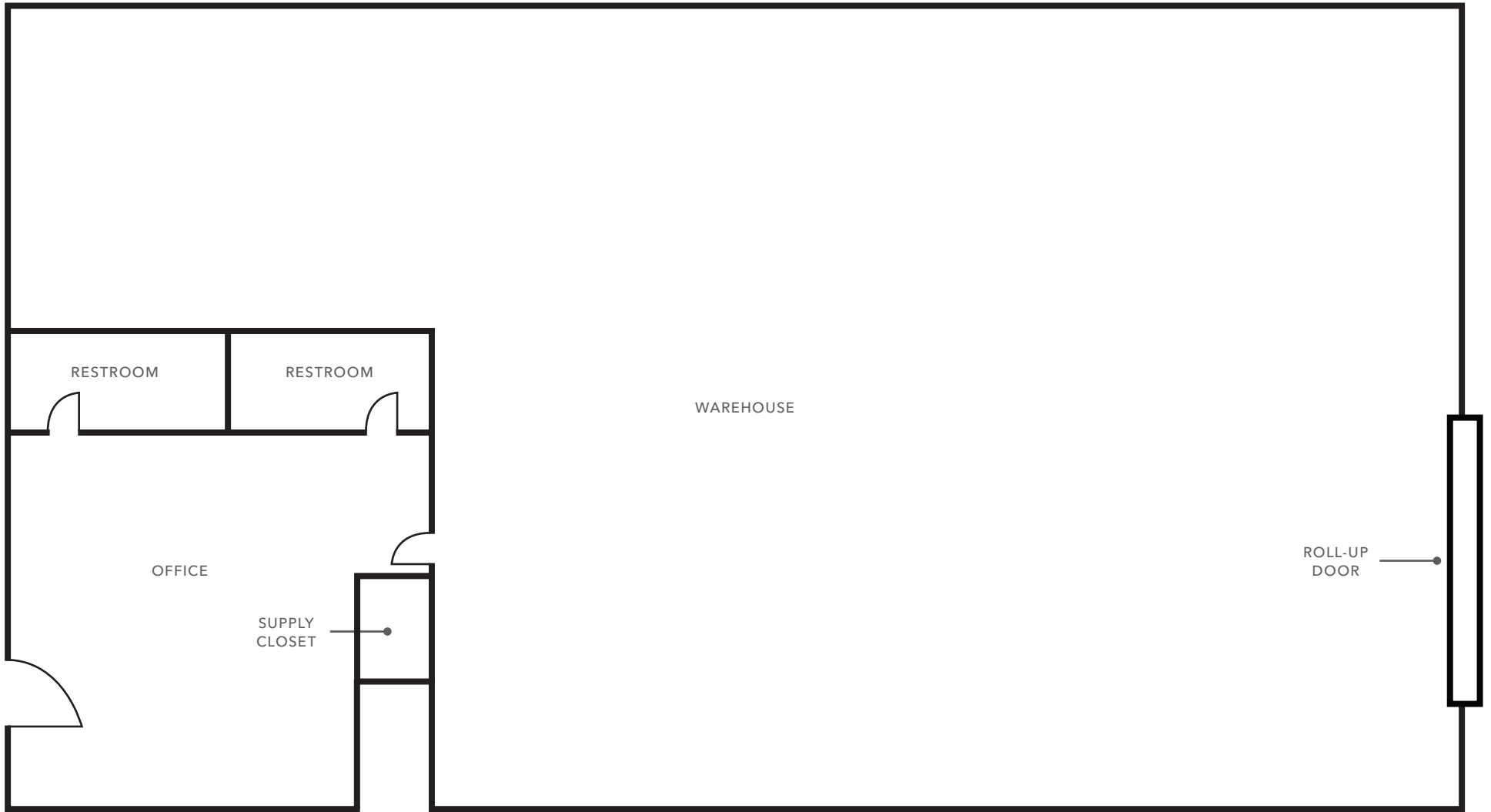

Unit 4 Overview

| | |
|---------------|----------------------------|
| UNIT SIZE | 2,730 SF |
| ZONING | MPD |
| OFFICE | 39% |
| ROLL UP DOORS | 1 (10' x 10') |
| CLEAR HEIGHT | 14' |
| SPRINKLERS | Yes |
| POWER | 200 amps 240/120 v 3 Phase |
| LEASE RATE/SF | \$1.15 /IG |
| LEASE RATE/MO | \$3,140 IG |

Unit Highlights

Recently Renovated

Available Now

Gated Loading



FLOOR PLAN

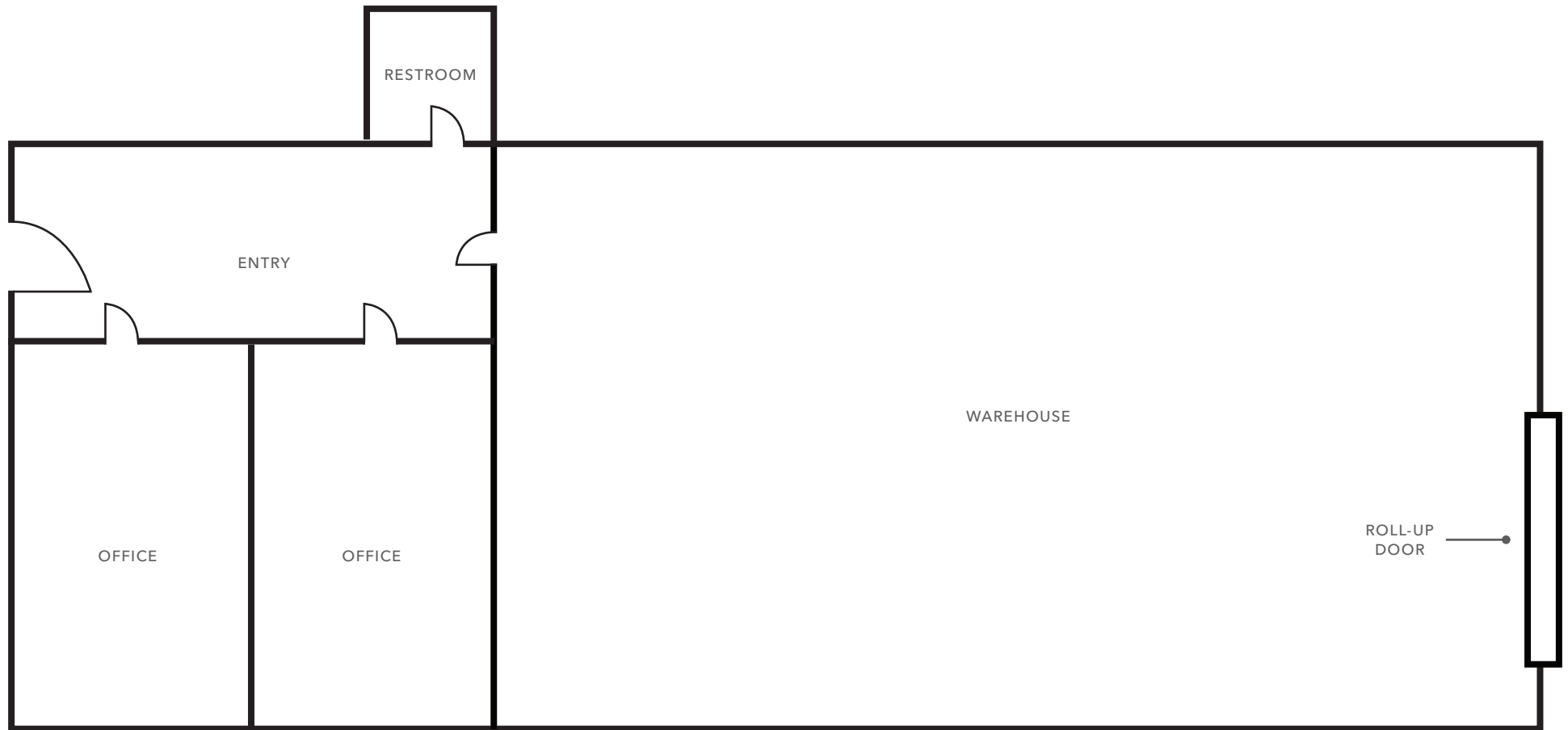



1595 WALTER ST

CALLENS RD

MARKET ST

WALTER ST

UNIT 4

UNIT 3

UNIT 1



AVAILABLE FOR LEASE

KIDDER MATHEWS | CROCKERMCKEAN.COM

1595 WALTER ST

E MAIN ST

verizon  **PACIFIC HIGH SCHOOL** 

usbank 

Lowe's 

Big Brand TIRE & SERVICE 

enterprise 

POINSETTIA PLAZA

| | | | |
|--|---|---|---|
|  |  |  |  |
|  |  |  |  |

















VENTURA GATEWAY

| | | | |
|---|---|---|---|
|  |  |  |  |
|  |  |  |  |
|  |  |  |  |

PACIFIC VIEW MALL

| | | | |
|---|---|---|---|
|  |  |  |  |
|  |  |  |  |
|  |  |  |  |

101

Mobil 







ExtraSpace Storage 

1595 WALTER ST

Chevron 



REGENCY THEATRES 

GOODYEAR AVE



EASTERN AVE

MARKET ST

101



MCGRATH ST

PALMA DR

PORTOLA RD



FedEx Ground 

POINSETTIA PLAZA

| | | | |
|---|---|---|--|
|  | Office DEPOT  |  | SALLY BEAUTY  |
| petco  | LAMPS PLUS  | ROSS DRESS FOR LESS  | MATTRESS FIRM  |
| Orangetheory FITNESS  |  | LaKeshore LEARNING STORE  | FedEx  |

RIVIERA PLAZA

| | | | |
|--|---|---|--|
| WinCo FOODS  |  |  | WaBa  |
|  |  | the Habit BURGER GRILL  |  |
| Durlington  |  |  | BLAZE PIZZA  |

DUPONT CT

MARKET ST

1595 WALTER ST, UNITS 1, 3 & 4

Exclusively leased by

JEFFREY M. CROCKER

First Vice President

805.626.6550

jeffrey.crocker@kidder.com

LIC N° 01457097

BENTLEY MCKEAN, CCIM

First Vice President

805.626.7120

bentley.mckean@kidder.com

LIC N° 02080641

CRISTIAN CONTRERAS

Senior Associate

818.475.6054

cristian.contreras@kidder.com

LIC N° 02137897

KIDDER.COM

This information supplied herein is from sources we deem reliable. It is provided without any representation, warranty, or guarantee, expressed or implied as to its accuracy. Prospective Buyer or Tenant should conduct an independent investigation and verification of all matters deemed to be material, including, but not limited to, statements of income and expenses. Consult your attorney, accountant, or other professional advisor.

