

**FOR SALE**  
**± 76.93 AC**

**15670 Bethel Ave Ext**  
**Midland, NC 28107**

**Mackenzie Moser, CCIM**  
Broker  
O: 704.882.1700 ext. 4  
M: 704.280.4649  
[mmoser@themosergroupinc.com](mailto:mmoser@themosergroupinc.com)

## Property Overview

---

### 15670 Bethel Ave Ext-Midland, NC 28107

AMAZING +/- 77 acres of residential property located off Hwy 601 in Midland, Union County NC. Drive through the property's elegant gated entrance to view open pastures, wooded acreage and a pond...perfect for equestrian activities, fishing, hunting or merely enjoying the open space. There are multiple garages, sheds, workshops, and stables as well as a large red barn available for use. The home is full brick with a large front porch and a back deck perfect for entertaining. There is also a mobile home for additional housing.

## Property Details

---

**Address** 15670 Bethel Ave Ext- Midland, NC 28107

---

**SF** +/- 3,549 SF Home; 2 Barns, 3 Workshops, Mobile Home

---

**Acres** +/- 76.93 Acres

---

**County** Union

---

**Parcel ID** 08177009 & 08177010

---

# Pricing \$2,999,000

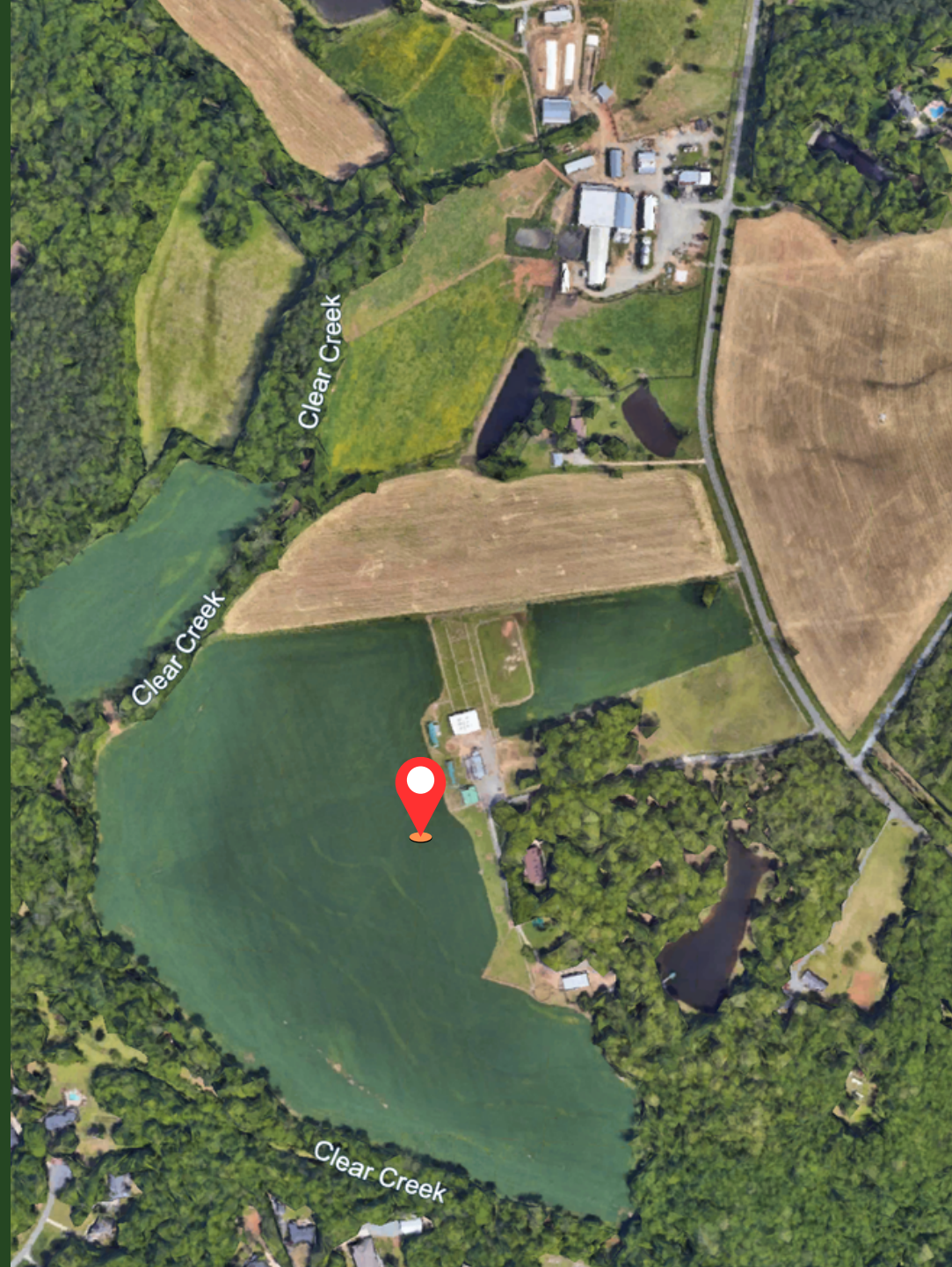

# Photos



# House Floor Plan

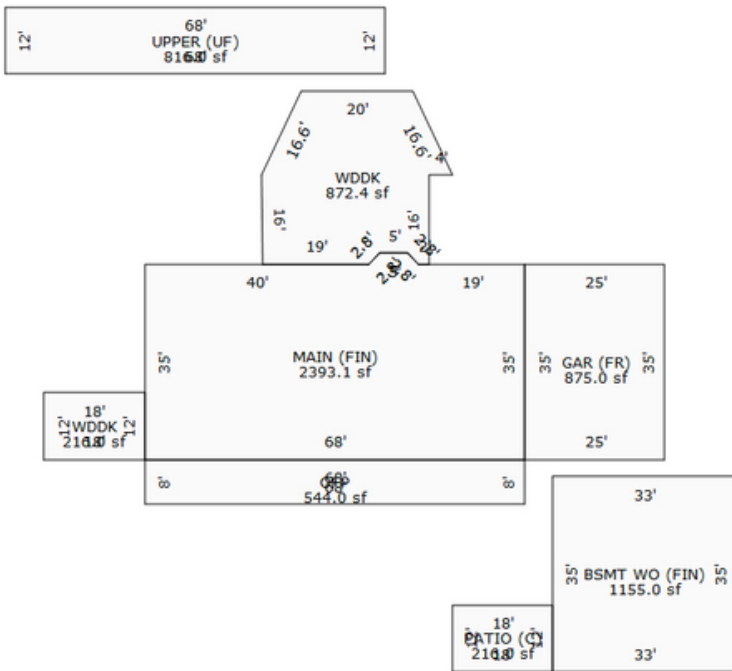

# Interior House Pictures



# Map

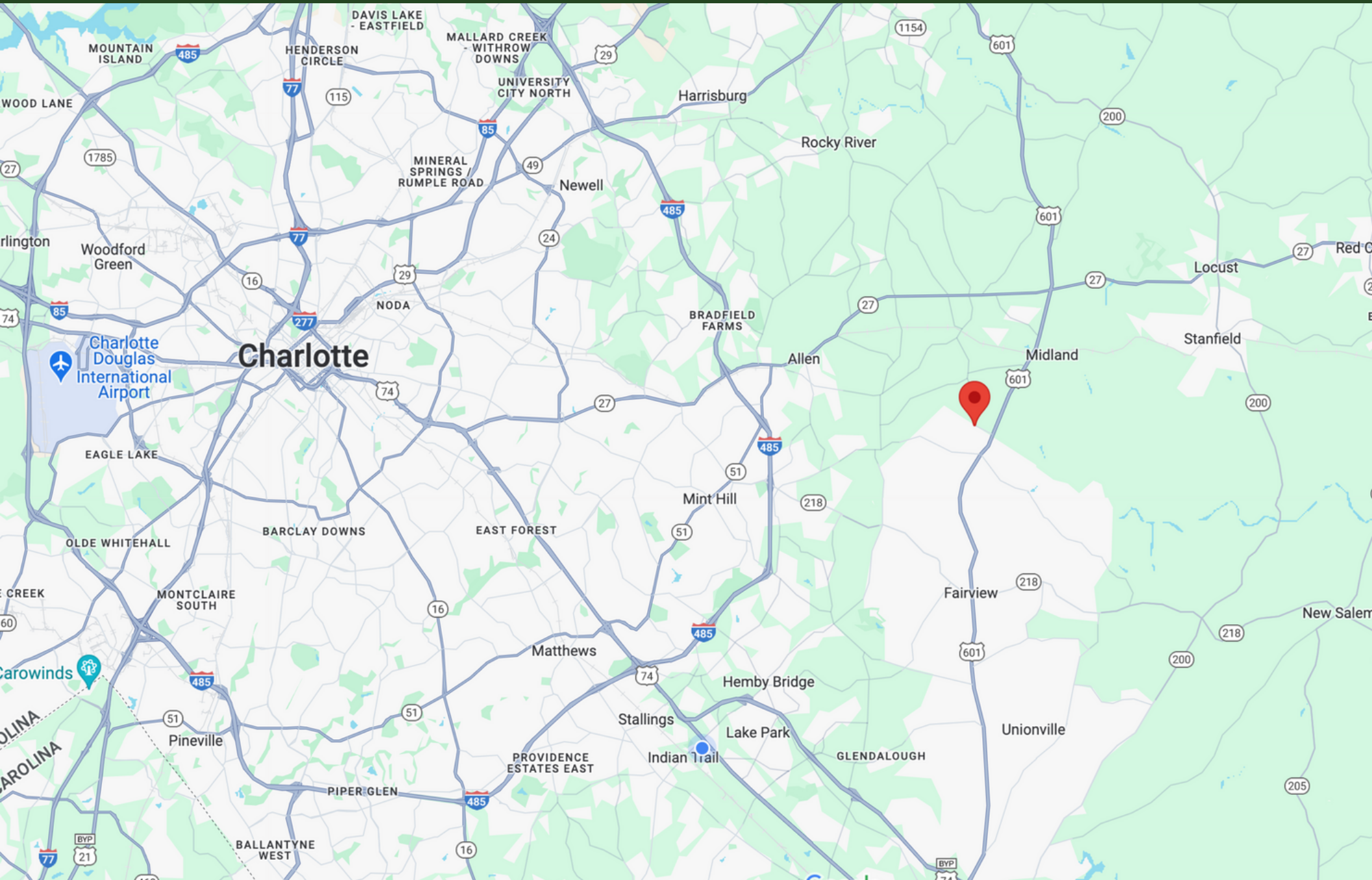

# Midland

## North Carolina

Midland is a thriving community located on the Rocky River in Union/Cabarrus County just 25 minutes from Uptown Charlotte. We are the home to Corning's Charlotte Region Fiber Optic Manufacturing Facility. Midland is a proud Carolina Thread Trail community with two greenways and a five mile paddle trail on the Rocky River.

