

An aerial photograph of a modern, single-story office building with a grey metal roof and large windows. The building is surrounded by a paved parking lot with several white cars parked. There are green bushes and trees in the background under a blue sky with scattered clouds.

FOR SALE

Gateway Office Park

**11701 I-30
Little Rock, AR 72209**

Nathan Monan
501 850 0710
nathan.monan@ar.colliers.com

Graham Gordon
501 978 6503
graham.gordon@ar.colliers.com

Isaac Smith, CCIM, SIOR
501 850 0736
isaac.smith@ar.colliers.com

Colliers | AR
1 Allied Dr, Suite 1500
Little Rock, AR 72202
501 372 6161
www.colliers.com

Key Features

- Building 2: 9,211 SF
- Sale price: \$795,000
- Lot size: 0.91 acres
- Suite 200: 5,308 SF - Fully built out with 12 offices
- Suite 205: 3,903 SF
- Zoning: "C-2," Commercial
- Traffic count: approx. 92,000 vehicles per day on I-30
- Right off of I-30 with interstate signage visibility
- Across from Gateway Town Center, Outlets of Little Rock and Bass Pro Shops

Copyright © 2025 Colliers International. Information herein has been obtained from sources deemed reliable, however its accuracy cannot be guaranteed. The user is required to conduct their own due diligence and verification.

Building 2 Floor Plan

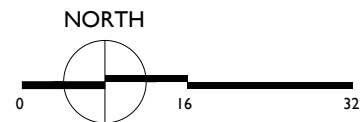
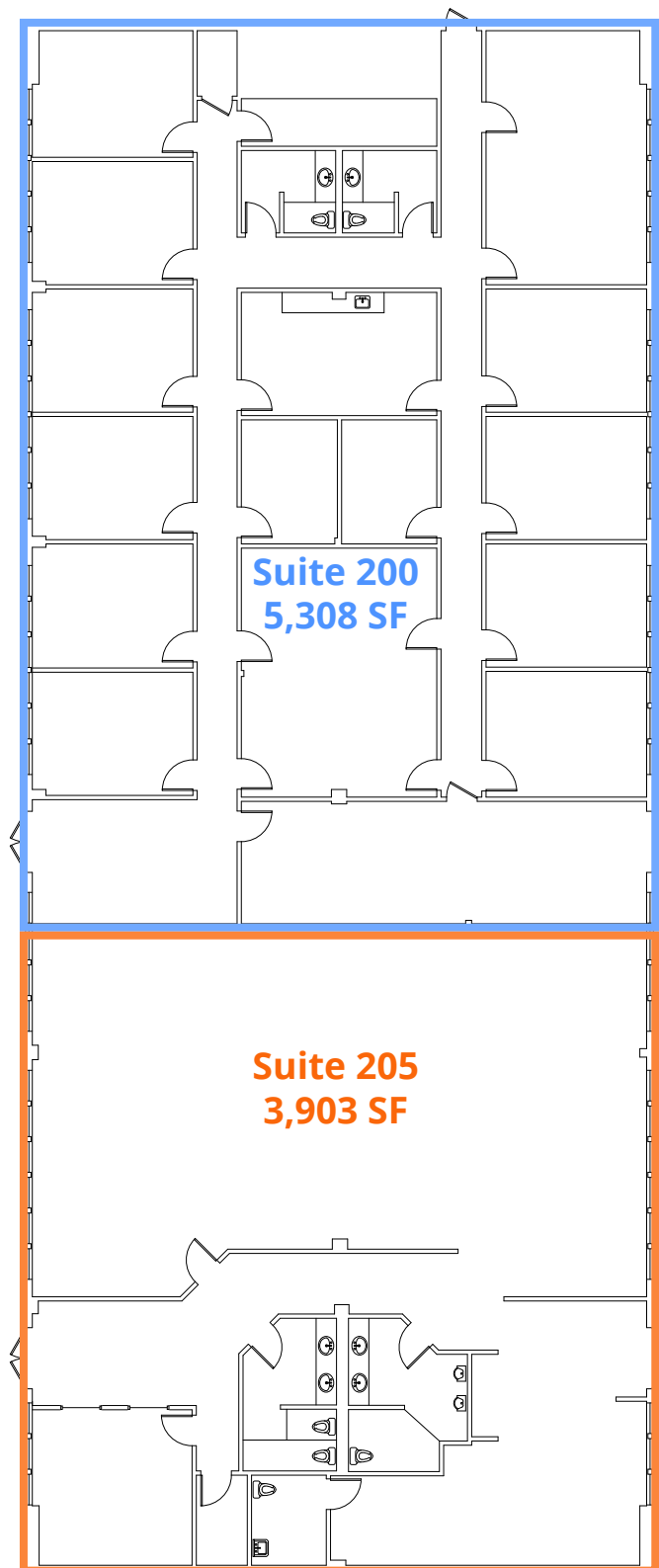

April 11, 2019

Building 2
Gateway Office Park
Little Rock, Arkansas

Smith Associates
Architects, P.A.

2701 Kavanaugh Blvd, Suite 208
Little Rock, AR 72205

(501) 614-8822 FAX 614-8826
www.smithassociatespa.com

For Sale

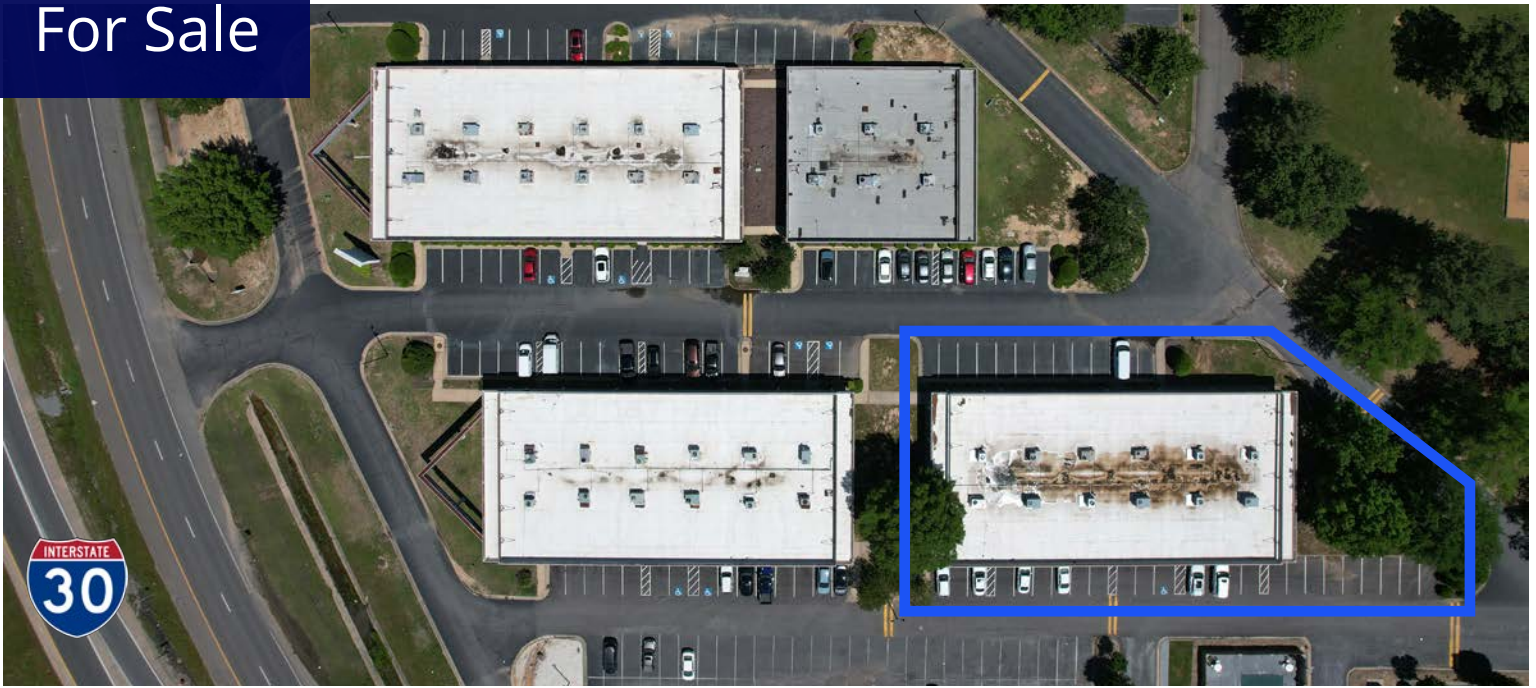

Neighborhood Map



Copyright © 2025 Colliers International. Information herein has been obtained from sources deemed reliable, however its accuracy cannot be guaranteed. The user is required to conduct their own due diligence and verification.



Colliers | AR
1 Allied Dr, Suite 1500
Little Rock, AR 72202
+1 501 372 6161
www.colliers.com