

FOR LEASE



## WOODSTOCK SQUARE

4109 SE WOODSTOCK BLVD | PORTLAND, OR 97202

For more information or a property tour, please contact:

**RAYMOND DUCHEK**

503.225.8492

[RDuchek@norris-stevens.com](mailto:RDuchek@norris-stevens.com)

Information contained herein has been obtained from others and considered to be reliable; however, a prospective purchaser or lessee is expected to verify all information to their own satisfaction.

06/13/2024

**Norris & Stevens**

INVESTMENT REAL ESTATE SERVICES



900 SW 5TH AVE, 17TH FLOOR | PORTLAND, OR 97204  
503.223.3171 • [NORRIS-STEVENS.COM](http://NORRIS-STEVENS.COM)



# WOODSTOCK SQUARE

4109 SE Woodstock Blvd | Portland, OR 97202

## RETAIL SPACE FOR LEASE

### DETAILS

- Lease rate: Call for rate
- Size: ± 2,879 SF (Divisible)

### FEATURES

- Vibrant retail trade area
- Highly desirable Woodstock neighborhood
- Neighboring retailers include: New Seasons, Safeway, Bi-Mart, Ace Hardware, The UPS Store, Key Bank, Chase Bank
- Mix of national, regional and local business's in a 16 block trade area
- Reed College and Eastmoreland Golf Course in neighborhood
- Off-street parking

### DEMOGRAPHICS

	1 MILES	3 MILES	5 MILES
2023 Population	21,533	177,897	465,529
2028 Proj. Population	21,086	176,878	464,958
2023 Households	8,763	76,335	206,747
2028 Proj. Households	8,534	75,684	206,523
Avg Household Income	\$124,007	\$104,640	\$102,545
Median Household Income	\$99,560	\$82,958	\$76,979

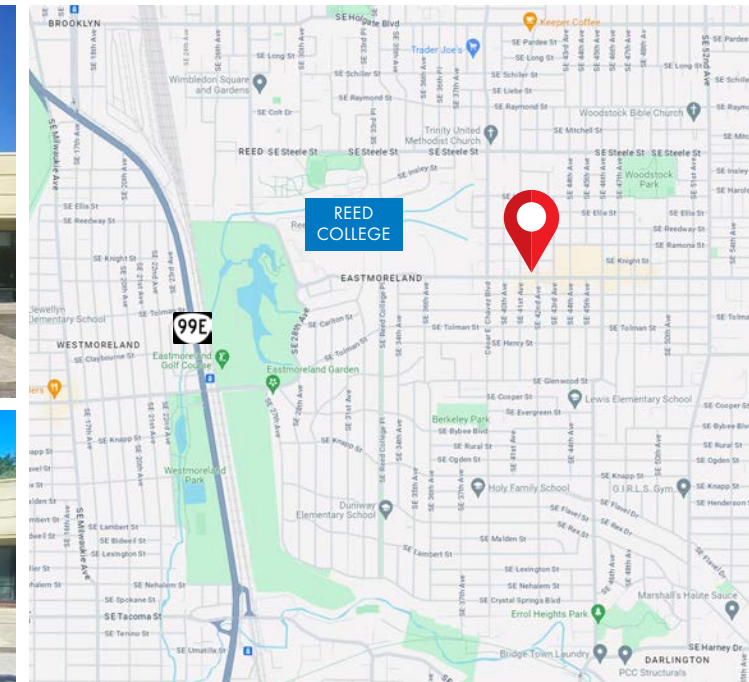

For more information or a property tour, please contact:

**RAYMOND DUCHEK**

503.225.8492

RDuchek@norris-stevens.com

Information contained herein has been obtained from others and considered to be reliable; however, a prospective purchaser or lessee is expected to verify all information to their own satisfaction.

## Norris & Stevens

INVESTMENT REAL ESTATE SERVICES



900 SW 5TH AVE, 17TH FLOOR | PORTLAND, OR 97204  
503.223.3171 • NORRIS-STEVENS.COM

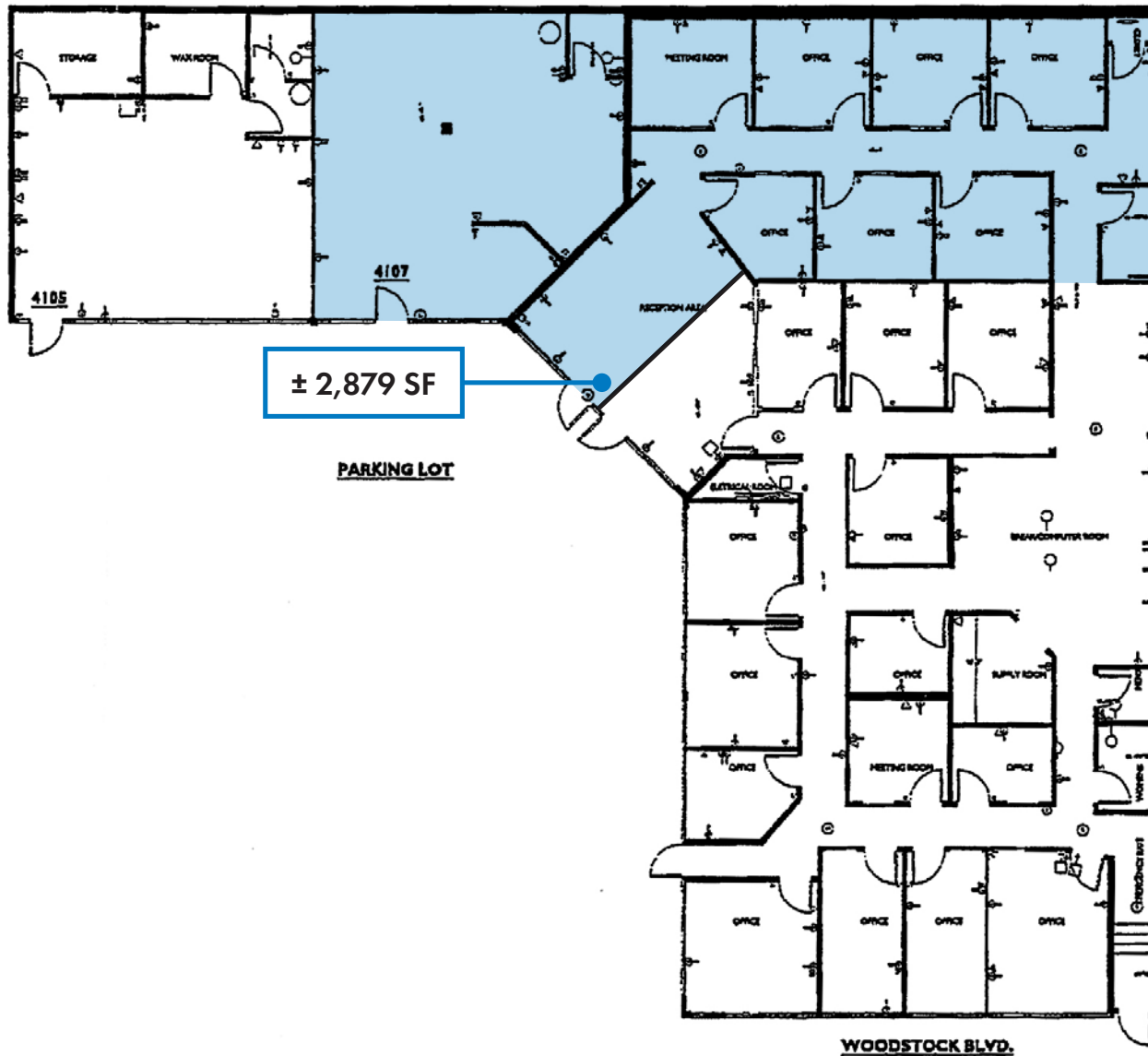

For more information or a property tour, please contact:

**RAYMOND DUCHEK**

503.225.8492

RDuchek@norris-stevens.com

Information contained herein has been obtained from others and considered to be reliable; however, a prospective purchaser or lessee is expected to verify all information to their own satisfaction.

**Norris & Stevens**

INVESTMENT REAL ESTATE SERVICES



900 SW 5TH AVE, 17TH FLOOR | PORTLAND, OR 97204

503.223.3171 • NORRIS-STEVENS.COM



# WOODSTOCK SQUARE

4109 SE Woodstock Blvd | Portland, OR 97202



For more information or a property tour, please contact:

**RAYMOND DUCHEK**

503.225.8492

[RDuchek@norris-stevens.com](mailto:RDuchek@norris-stevens.com)

Information contained herein has been obtained from others and considered to be reliable; however, a prospective purchaser or lessee is expected to verify all information to their own satisfaction.

## Norris & Stevens

INVESTMENT REAL ESTATE SERVICES



900 SW 5TH AVE, 17TH FLOOR | PORTLAND, OR 97204  
503.223.3171 • [NORRIS-STEVENS.COM](http://NORRIS-STEVENS.COM)