

**FOR SALE**

**±9.7 Acres | Industrial Land Site**



PARSONS COMMERCIAL  
GROUP | BOSTON

**71 PARMENTER ROAD HUDSON, MA**



**Jake Parsons** | Senior Advisor | 508.271.9227 | [jake.parsons@svn.com](mailto:jake.parsons@svn.com)

1881 Worcester Road, Suite 200 | Framingham, MA 01701 | 508.820.2700 | [www.svnpcgboston.com](http://www.svnpcgboston.com)



# PROPERTY OVERVIEW

*71 PARMENTER ROAD HUDSON, MA*

SVN | Parsons Commercial Group | Boston is pleased to announce the opportunity to purchase approximately 9.7 acres at 71 Parmenter Road in Hudson, Massachusetts.

The site presents the unique opportunity to develop up to 90,000 square feet of Class A industrial space on flat usable land. The potential to sub-divide the land into smaller parcels also exists. This is a great opportunity for an owner/user.

The site is conveniently located just a seven minute drive from Route 20 and a 12 minute drive to the I-290 and I-495 intersection. The site abuts Hudson's Charter Oak Country Club as well as the Marlborough-Sudbury State Forest.

For pricing information or any other questions regarding the listing please inquire with the listing agent, Jake Parsons at 508.271.9227.

## ALLOWED USES INCLUDE:

Distribution and Storage	Contractor's Offices and Storage Yard
Warehouses and Food Distribution Center	Manufacturing
Trucking Garages and Terminals	Retail Sales and Service Occupations
Garages Including Body Repairs	Laundries, Dry Cleaning Establishment



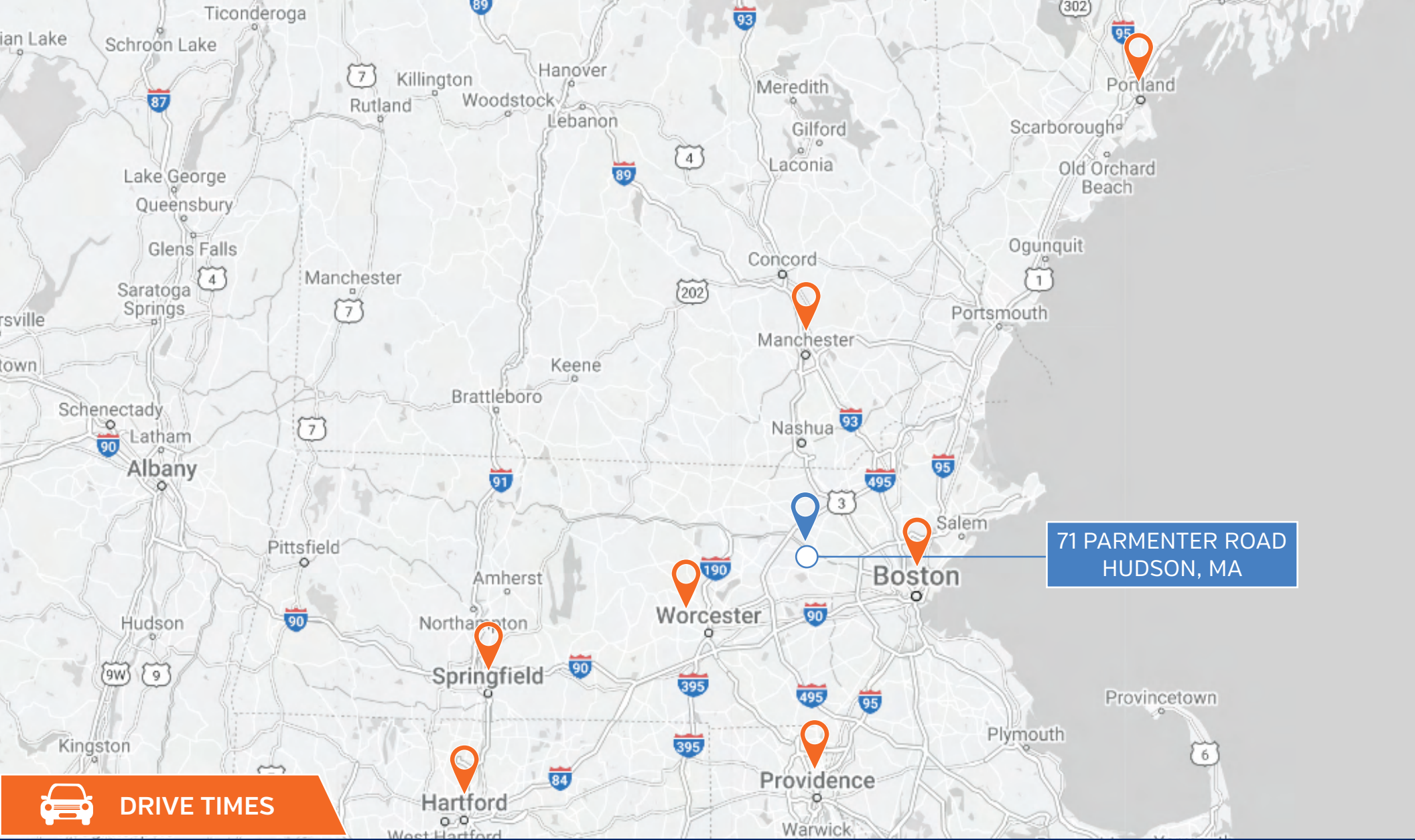

**30 MIN**

WORCESTER, MA

**45 MIN**

BOSTON, MA

**1 HOUR**

PROVIDENCE, RI

**2 HOURS**

PORTLAND, ME

**1.25 HOURS**

SPRINGFIELD, MA

**1.5 HOURS**

HARTFORD, CT

**1.5 HOURS**

MANCHESTER, NH

# PARMENTER ROAD

71 PARMENTER ROAD, HUDSON MA 01749

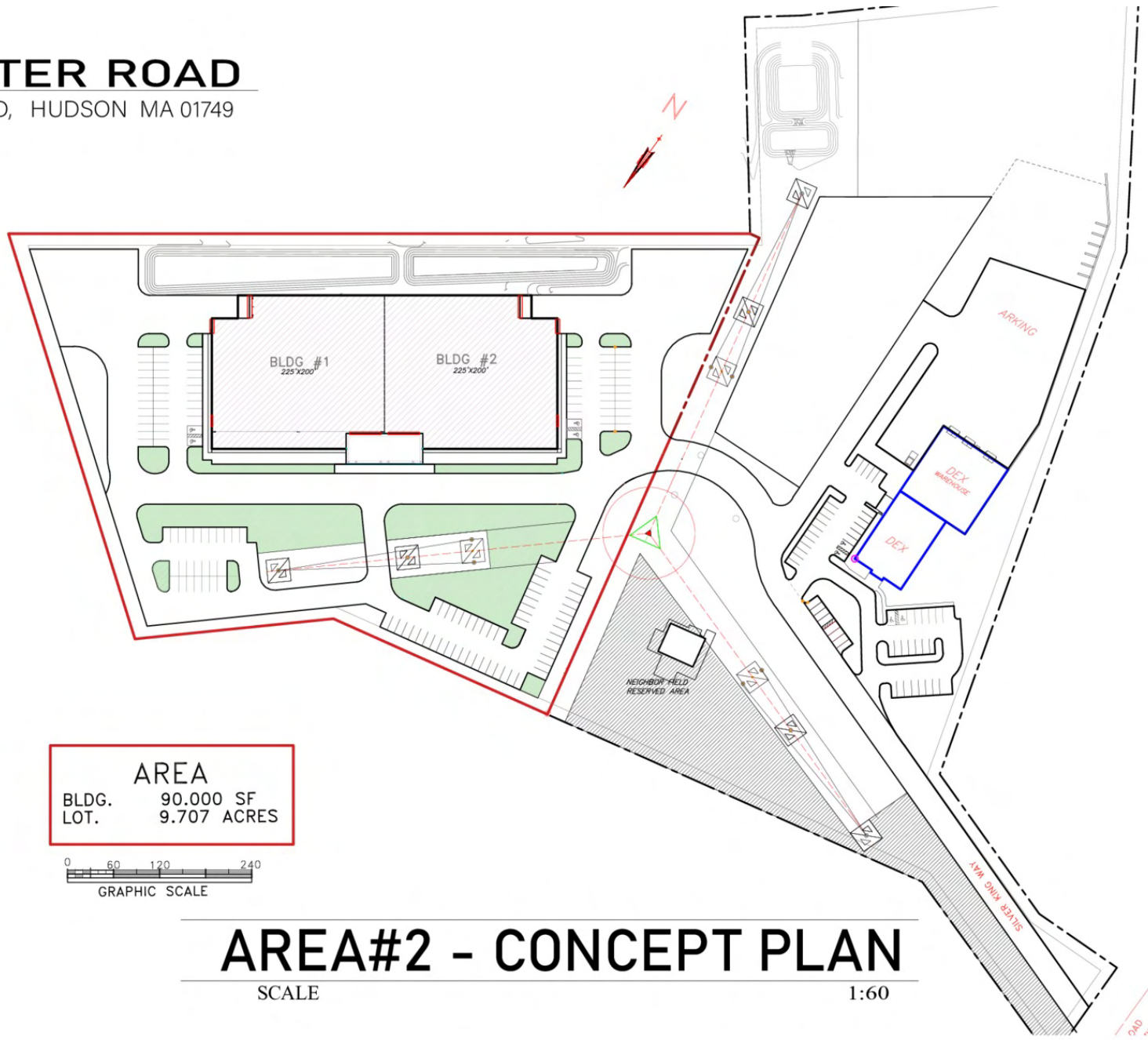

AREA	
BLDG.	90,000 SF
LOT.	9.707 ACRES

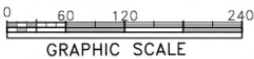

## AREA#2 - CONCEPT PLAN

SCALE

1:60

10.28.2022



