

FOR LEASE

3850 W Hardman Way  
Lehi, UT 84043

## Smith's #210 Shopping Center

- Grocery Anchored Retail PAD's
- Opportunities for Ground Lease or BTS
- High Traffic Counts
- Grocery Store Opens in Fall of 2026

## Property Specs

LEASE RATE

Contact Agent

LOT SIZE

± 0.5 - 1 Acres

ZONING

Commercial

TYPE

Land | Retail/Office

- Grocery Anchored Retail PAD's
- Opportunities for Ground Lease or BTS
- High Traffic Counts
- Grocery Store Opens in Fall of 2026



EAST ELEVATION / EAST



OR TEXT 23022 TO 39200

Message frequency will vary. Message and data rates may apply. Reply HELP for help or STOP to cancel.

[ARTI Terms of Service](#) | [ARTI Privacy Statement](#)





PHOTOS

Grocery Store Opens in Fall of 2026  
High Traffic Counts





# AREA MAP



- Shops/Tenants
- Schools
- Public Parks
- Govt. Buildings
- Airport



## NORTHWEST COUNTY & NEW DEVELOPMENT

As the Northwest continues to grow, UDOT plans to expand roadways and freeway access. This bodes well for future development within the retail sphere - increasing traffic counts and improving flow of traffic.

To view upcoming news and announcements, or to stay in the know visit <https://udotinput.utah.gov/Portal/Y8318>

### 2100 North Freeway Project

The 2100 North Freeway Project will improve transportation in Lehi and improve the east/west connection from I-15 to Mountain View Corridor. The 2100 North Project will enhance connectivity between Redwood Road and I-15, providing a 2.8-mile freeway segment designed to improve traffic flow and reduce congestion. This project includes the construction of a system-to-system interchange at I-15, approximately 20 roadway structures, and three shared-use-path structures to support pedestrians and cyclists. Additionally, two miles of shared-use path will be realigned or reconstructed to enhance safety and accessibility.

**Learn More at:** <https://udotinput.utah.gov/r76871>

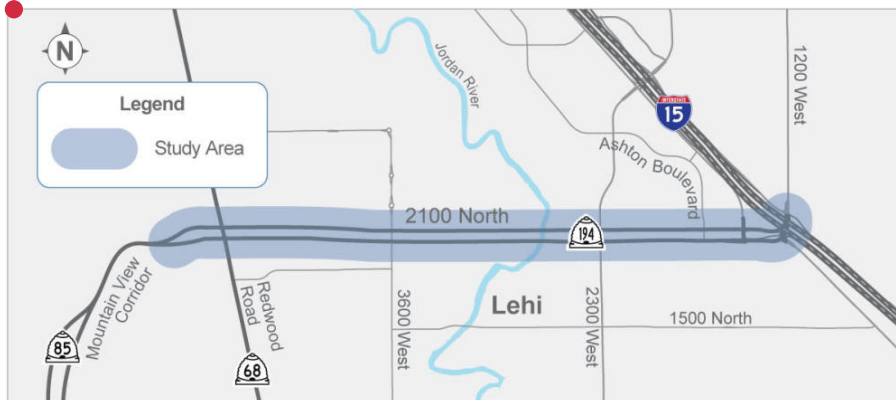

### Northwest Utah County Program

As the population in Utah continues to grow, transportation planning and development play a key role. The Utah Department of Transportation (UDOT) is planning and implementing several transportation improvement projects in Northwest Utah County to keep Utah moving while facilitating a strong economy, and maintaining a high quality of life

### Coordinated Communication

The Northwest Utah County Program was created to provide a “one-stop-shop” of transportation information for the area.

Rather than starting and stopping outreach efforts with each individual project, the Northwest Utah County Program will remain a consistent source of information for years to come.

**Learn More at:** <https://udotinput.utah.gov/h13702>

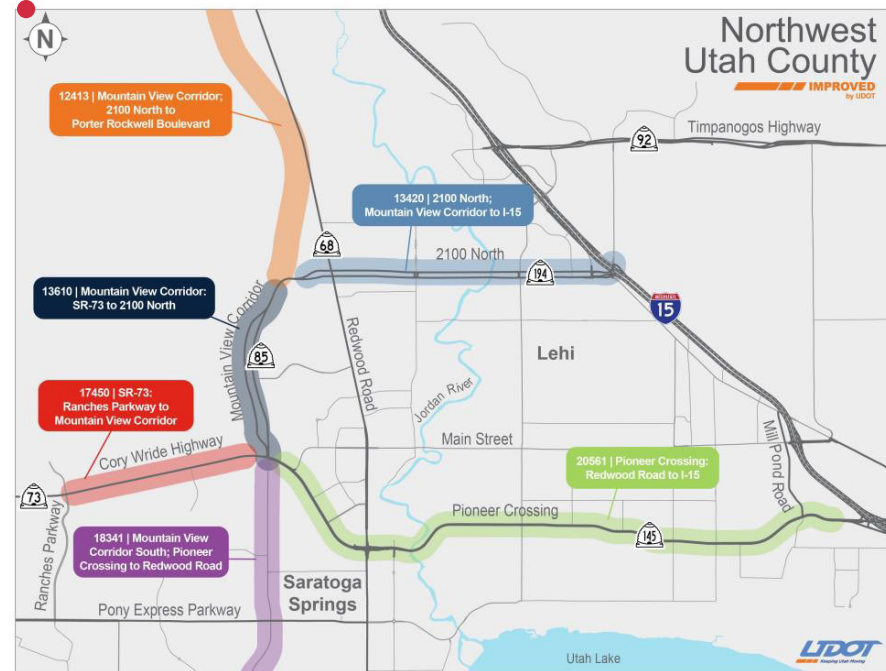

# SITE MAP

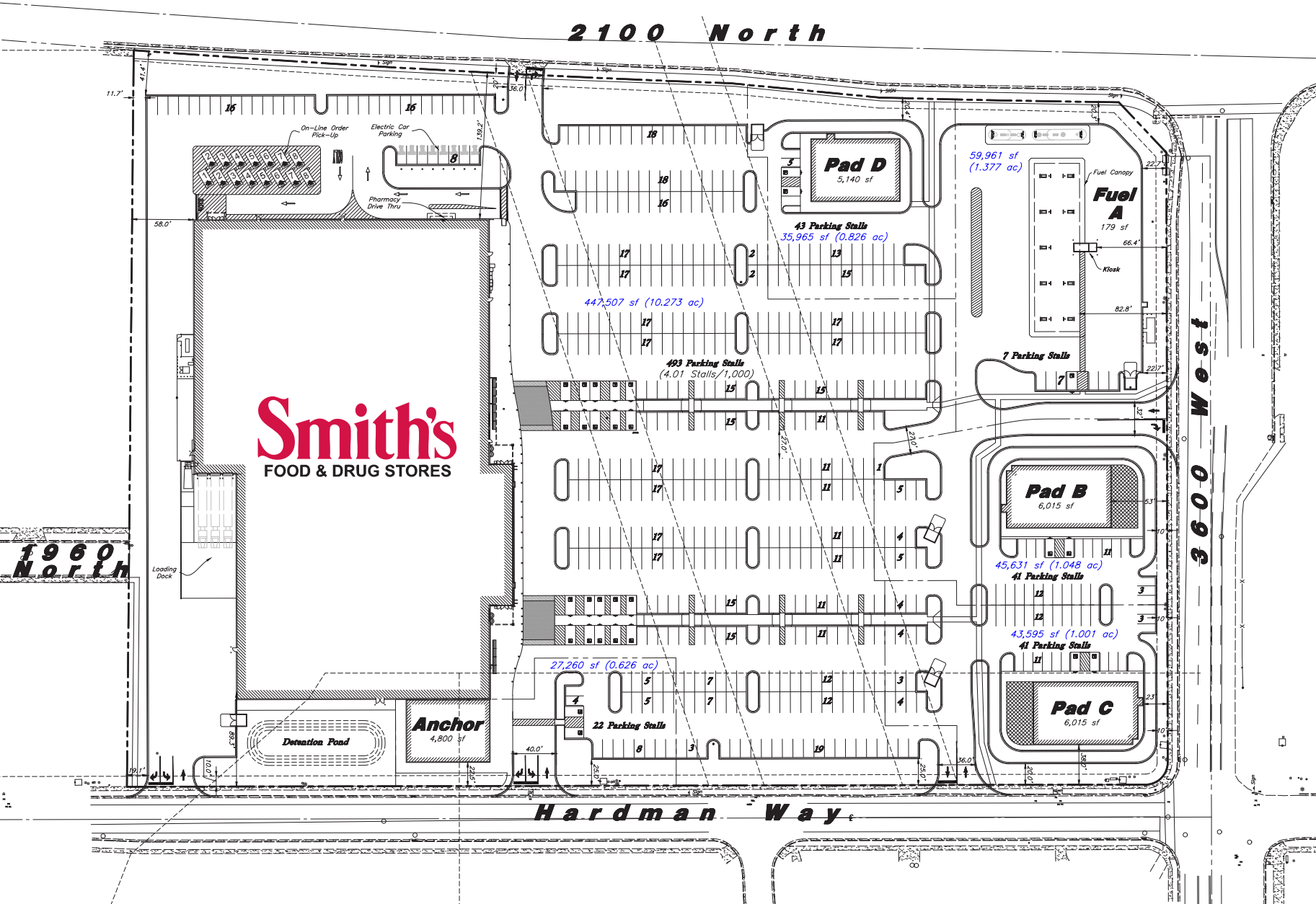



# DEMOGRAPHICS

	1-mile	3-mile	5-mile
<b>POPULATION</b>			
2024 Population	13,591	76,117	168,294
<b>HOUSEHOLDS</b>			
2024 Households	4,364	21,104	45,750
<b>INCOME</b>			
2024 Average HH Income	\$164,744	\$156,429	\$155,327

## Traffic Counts

STREET	AADT
2100 North	20,687
North Redwood Road	20,924

## Neighboring Cities

Bluffdale	16 miles
Provo	28 miles
Spanish Fork	36 miles
Salt Lake City	38 miles
Cedar City	224 miles

# TERMS & CONDITIONS

## **Terms and Conditions**

This offering, including any related digital marketing, contains selected information pertaining to the Property and does not purport to be a representation of the state of the Property, to be all-inclusive, or to contain all or part of the information which interested parties may require to evaluate a purchase or lease of real property.

## **Financial Information**

Any and all financial projections and information are provided for general reference purposes only and have been gathered from sources deemed reliable. Certain assumptions have been made relating to the general economy, market conditions, competition and other factors beyond the control of seller and NAI Vegas. Therefore, all projections, assumptions and other information provided and made herein are subject to material variation.

## **Summary Documents**

Additionally, all references to acreage, square feet, and other measurements are approximations. Any demographics, geographic information systems(GIS), maps, photography, zoning, site plan, survey, engineering, architectural drawings, and any other information are without assurance of their accuracy, time sensitivity, completeness, or status of approval. Documents presented may be preliminary, have no assurance of being “as built”, and may not reflect actual property boundaries or improvements. Additional information and an opportunity to inspect the Property can be made available to qualified parties. In this Memorandum, certain documents are described in summary form. These summaries do not purport to be complete nor necessarily accurate descriptions of the full documents referenced herein. Interested parties are expected to review and confirm all such summaries and other documents of whatever nature independently and not rely on the contents of this Memorandum in any manner.

## **Non-Warranty**

Neither the seller or NAI Excel, nor any of their respective directors, officers, Affiliates or representatives make any representation or warranty, expressed or implied, as to the accuracy or completeness of this Offering Memorandum or any of its contents, as to the financial performance of the property, or as to the condition of the Property, malfunctions or mechanical defects on the Property or to any improvements thereon, including but not limited to the material, workmanship or mechanical components of the structures, foundations, roof, heating, plumbing, electrical or sewage system, drainage or moisture conditions, air conditioning, or damage by the presence of pests, mold or other organisms, environmental condition, soils conditions, the zoning of the Property, the suitability of the Property for Interested parties intended use or purpose, or for any other use or purpose.

## **No Obligation**

No legal commitment or obligation shall arise by reason of your receipt of this Memorandum or use of its contents; Interested Parties are to rely solely on its investigations and inspections of the Property in evaluating a possible purchase or lease of the real property. The seller expressly reserves the right, at its sole discretion, to reject any or all offers to purchase or lease the Property, and/or to terminate discussions with any entity at any time, with or without notice, which may arise as a result of review of this Memorandum.

## **Confidentiality**

By receipt of this Memorandum, you agree that this Memorandum and its contents are confidential in nature, that you will hold and treat such in the strictest confidence and that you will not disclose this Memorandum, or any of its contents, to any other entity without the prior written authorization of the seller or NAI Vegas. If after reviewing this Memorandum, you have no further interest in purchasing or leasing the Property, please delete or return this Memorandum to NAI Excel.





# WHY NAI

Our professionals leverage decades of experience, industry-leading technology, and a leading global network to help you excel in your real estate goals.

**325+**

OFFICES

**1.1 BIL**

SF MANAGED

**5,800+**

PROFESSIONALS

**TOP 6**

2024 LIPSEY RANKING



LEARN MORE AT  
[naixel.com](https://naixel.com)

**NAI Excel**

COMMERCIAL REAL ESTATE SERVICES, WORLDWIDE

2901 Ashton Blvd Ste 102  
Lehi, Utah 84043  
801.341.0900 | [naixel.com](https://naixel.com)

**Zach Hatch**

801.633.6313  
[zhatch@naixel.com](mailto:zhatch@naixel.com)

**Jay Blacker**

801.341.0992  
[jblacker@naixel.com](mailto:jblacker@naixel.com)

This offering, including any related digital marketing, contains selected information pertaining to the Property and does not purport to be a representation of the state of the Property, to be all-inclusive, or to contain all or part of the information which interested parties may require to evaluate a purchase or lease of real property.

Neither the seller or NAI Excel, nor any of their respective directors, officers, Affiliates or representatives make any representation or warranty, expressed or implied, as to the accuracy or completeness of this Offering Memorandum or any of its contents, as to the financial performance of the property, or as to the condition of the Property, malfunctions or mechanical defects on the Property or to any improvements thereon, including but not limited to the material, workmanship or mechanical components of the structures, foundations, roof, heating, plumbing, electrical or sewage system, drainage or moisture conditions, air conditioning, or damage by the presence of pests, mold or other organisms, environmental condition, soils conditions, the zoning of the Property, the suitability of the Property for interested parties intended use or purpose, or for any other use or purpose. ARTI Terms of Service | <https://brokerstechnology.com/terms-of-use/> ARTI Privacy Policy | <https://brokerstechnology.com/privacy-policy/>