

100 Park Avenue

Southwest Corner of East 41st Street
Midtown



100 Park Avenue

Southwest Corner of East 41st Street
Midtown

Size:

Ground Floor 3,426 SF
Selling Lower Level 5,589 SF

Frontage:

100' Wraparound (approx.)

Possession:

Arranged

Property Highlights:

- Base of 907,000 SF Office Tower
- Steps from One Vanderbilt, Bryant Park & New York Public Library
- Currently "Willner Chemists"

Transportation:

- Grand Central Station Terminal, which sees over 67 million passengers annually
- Accessible via **1 2 3 B D 4 5 6 N R Q W**
A C E trains as well as **M** Metro-North Railroad & **L** Long Island Rail Road

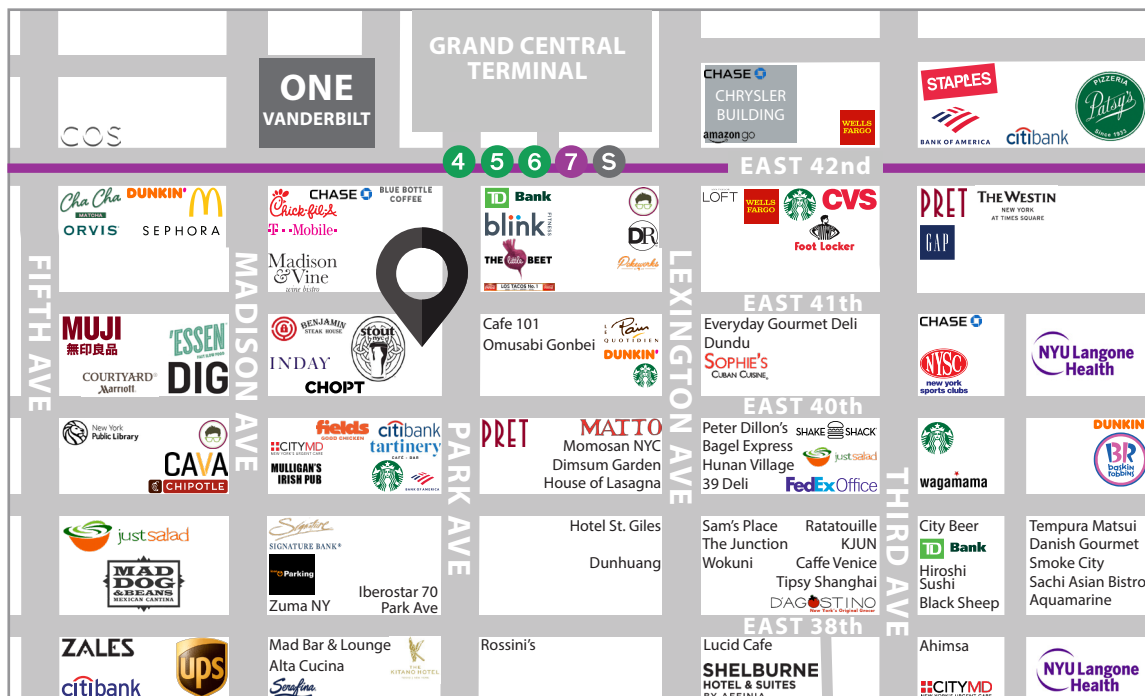

CONTACT OUR BROKERS FOR MORE INFORMATION:

Dorel Melloul

DMelloul@ksrny.com
347.922.4563

Marc Sitt

MSitt@ksrny.com
917.757.8863

Albert Manopla

AManopla@ksrny.com
212.380.8369



All information supplied in this marketing presentation and/or flyer is from sources deemed reliable and is furnished subject to errors, omissions, modifications, removal of listings from sale/lease and to any listing condition. Any square footage, dimensions, floor plans and/or technical data set forth are approximations and are subject to further elaboration/confirmation.

100 Park Avenue

Southwest Corner of East 41st Street
Midtown

Floor Plans:
Ground Floor - 3,426 SF

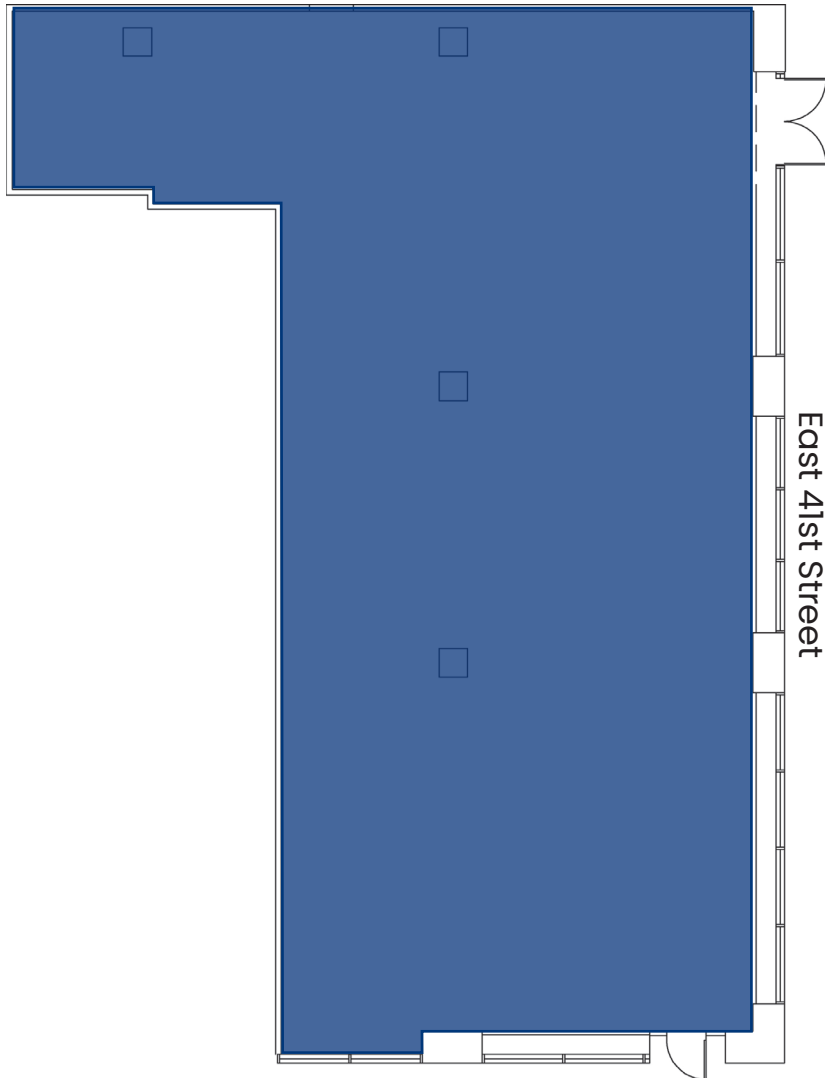

Selling Lower Level - 5,589 SF

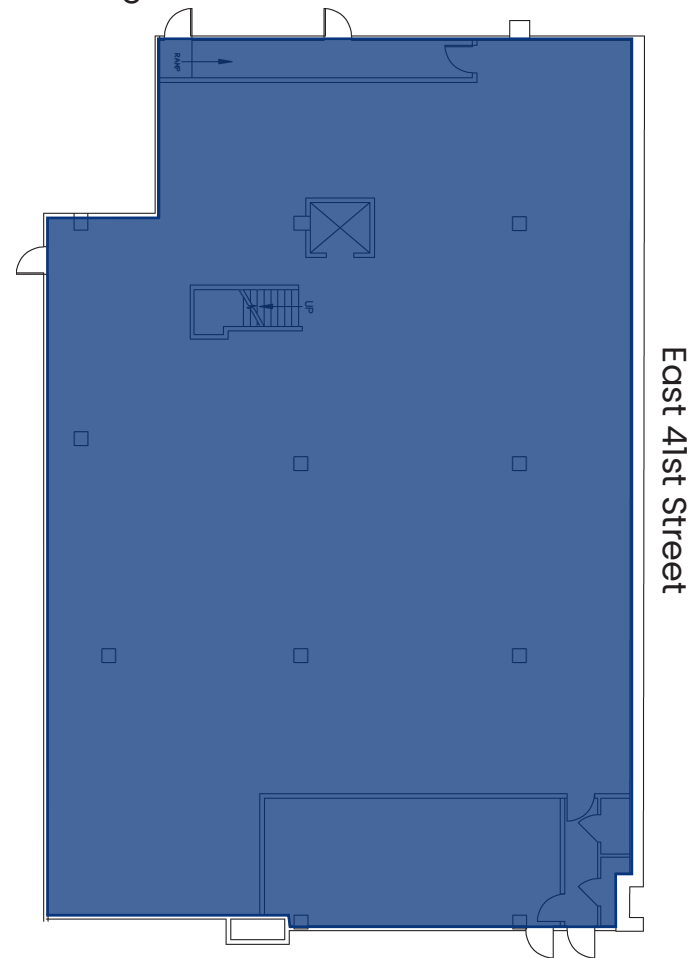

CONTACT OUR BROKERS FOR MORE INFORMATION:

Dorel Melloul
DMelloul@ksrny.com
347.922.4563

Marc Sitt
MSitt@ksrny.com
917.757.8863

Albert Manopla
AManopla@ksrny.com
212.380.8369



All information supplied in this marketing presentation and/or flyer is from sources deemed reliable and is furnished subject to errors, omissions, modifications, removal of listings from sale/lease and to any listing condition. Any square footage, dimensions, floor plans and/or technical data set forth are approximations and are subject to further elaboration/confirmation.