

KEYES WAY COMMERCIAL CONDOMINIUMS

FOR SALE

AVAILABLE NOW

UNIT SIZE: 1,250 SF

24 COMMERCIAL CONDOMINIUMS

4 KEYES WAY, WEST WARWICK, RI

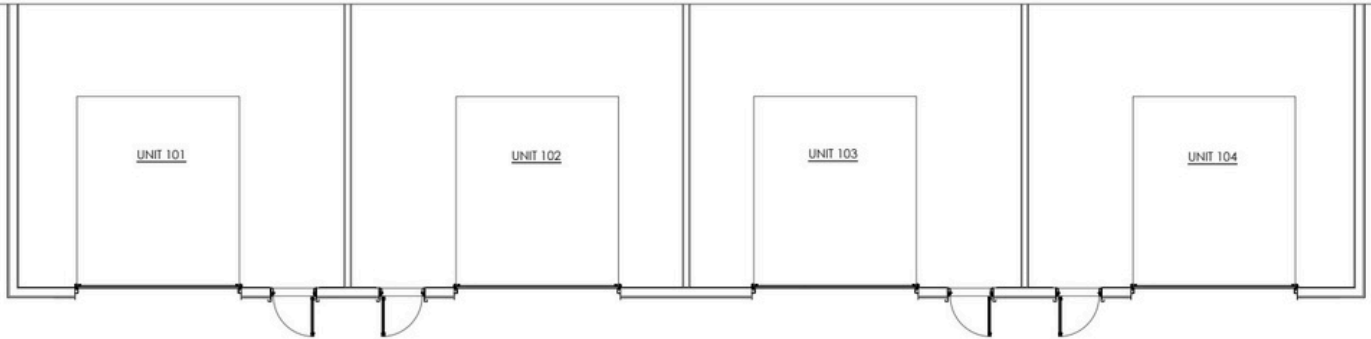

OWN YOUR WORKSPACE

A rare opportunity to purchase newly constructed contractor storage condominium units in the heart of West Warwick's industrial corridor. Designed for contractors, tradespeople, service businesses, and small industrial users, these versatile units offer ownership flexibility, modern construction, and convenient access to major highways throughout Rhode Island and southeastern Massachusetts.

PROPERTY FEATURES

- 24 Commercial Condominium Units
- 30,000 SF Development
- Individual 1,250 SF Units
- 14' x 14' Drive-In Overhead Door
- Gas-Fired Unit Heater
- 16'-20' Clear Ceiling Heights
- Located in the West Warwick Business Park
- Convenient Access to I-95, I-295 & Route 2
- Ideal for Contractors, Trades, Storage & Small Business Operations



For more information, please contact:

John Cregan / Principal

401-273-6100 / johnc@ppgrealstate.com

KEYES WAY COMMERCIAL CONDOMINIUMS

