

# DIERBERGS BRENTWOOD POINTE

# DIERBERGS BRENTWOOD POINTE BRENTWOOD, MISSOURI

# SANSONE group

FOR LEASE: 1,175 SF Retail Space Available

**NEW  
PRICE!**



## PROPERTY FEATURES

- Prominent location adjacent to Promenade at Brentwood and near St. Louis Galleria
- Excellent access and visibility from I-64 & I-170
- Additional access from Brentwood Blvd., Hanley Road, and Hanley Industrial Ct.
- Anchored by 69,631 SF Dierbergs Markets
- Join Dierbergs, HomeGoods, DSW Shoe Warehouse, dressbarn, Beauty Brands, Famous Footwear & Chick-fil-A
- Traffic Counts:  
173,325 VPD on I-64  
127,954 VPD on I-170  
30,650 VPD on Eager Road

SWC EAGER RD & HANLEY INDUSTRIAL CT  
8472 Eager Rd, St. Louis, MO 63144

## AREA DEMOGRAPHICS

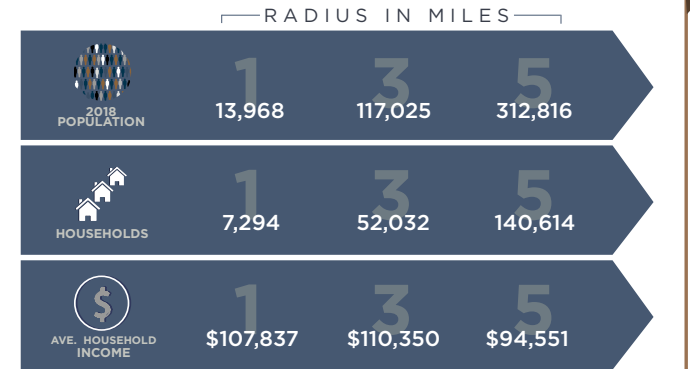

FOR MORE INFORMATION PLEASE CONTACT:

**Tim Cherre CRX, CLS**  
tcherre@sansonegroup.com

## TENANT INDEX

SUITE	TENANT	SQ.FT.
A-1	Supplement Superstore	1,883
A-2	Subway	1,327
A-3	LookAfter	1,061
A-4	VIP Cleaners	1,168
B	Dierbergs Markets	69,631
C-6	iTechShark	1,078
C-1	Beach House Bronze Tanning	1,308
C-2	Adler's Jewelry	1,600
C-3,4	Le Nail	2,371
<b>C-5</b>	<b>AVAILABLE</b>	<b>1,175</b>
D	DSW Shoe Warehouse	22,578
E-1-5	Famous Footwear	6,737
F-1	Foot Healers	1,150
F-2	dressbarn	7,560
F-3	Beltone Hearing Aid Center	1,150
H-1,2	Clarkson Eyecare	2,424
H-3	fit-flavors	1,200
H-4	Beauty Brands	5,600
K	Chick-fil-A	4,876
I-2	HomeGoods	17,806
I-1	Petco	14,360

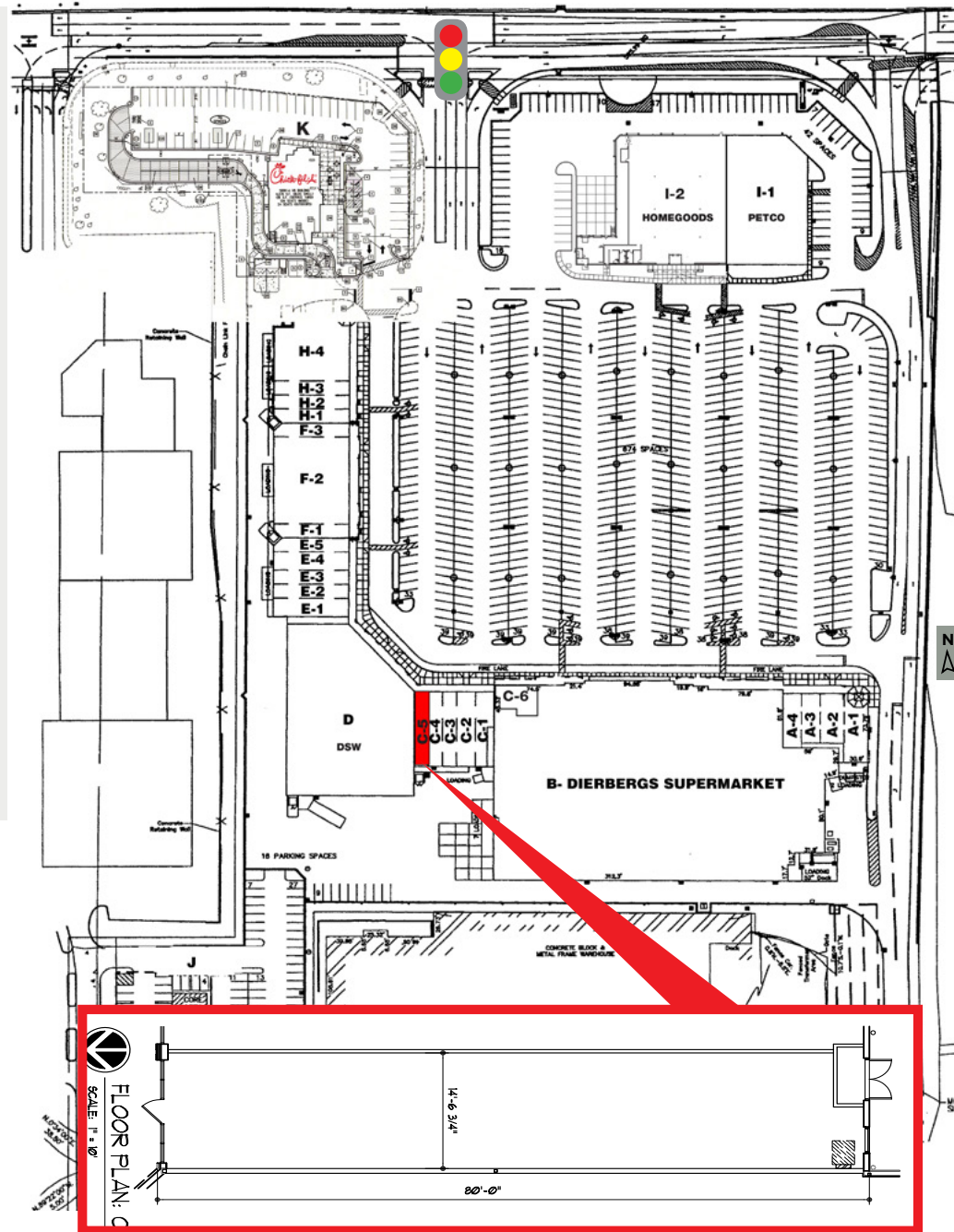

## Six Different Routes to Dierbergs Brentwood Pointe



FOR MORE INFORMATION:

**Tim Cherre CRX, CLS**  
tcherre@sansonegroup.com

**SANSONE**  
group

**314-727-6664**

120 S. Central, Suite 500  
St. Louis, Missouri 63105



The information contained herein is not warranted, although it has been obtained from the owner of the property or from other sources that we deem reliable. It is subject to change without notice. Seller and broker make no representation as to the environmental condition of the property and recommend purchaser's independent investigation.

**314-727-6664**

[www.sansonegroup.com](http://www.sansonegroup.com)

**120 S. Central, Suite 500**  
St. Louis, Missouri 63105

# DIERBERGS BRENTWOOD POINTE

SANSONE  
group

