



HOULIHAN LAWRENCE
COMMERCIAL

KLEIN | LANZA TEAM

Market Knowledge | Experience | Reputation

PETER CHEN

Licensed Real Estate Salesperson

M. 917.886.5188

PChen@hlcommercialgroup.com

Houlihan Lawrence Commercial
800 Westchester Avenue, Suite N-517
Rye Brook, NY 10573
O. 914 798 4900



Office/Medical Suite For Lease

5676 RIVERDALE AVENUE
BRONX, NY

FOR LEASE: \$35 PSF MODIFIED GROSS

- 3,000 SF Office or Medical Suite For Lease
- Great use for Professional Office, Medical General Practice or Educational Center
- Up to 9 Vehicle Parking Spaces Available
- Ground floor suite
- Space Can Be Divisible up to 1,500 SF



HOULIHAN LAWRENCE
COMMERCIAL

KLEIN | LANZA TEAM

Market Knowledge | Experience | Reputation

PETER CHEN

Licensed Real Estate Salesperson

M. 917.886.5188

PChen@hlcommercialgroup.com

Houlihan Lawrence Commercial
800 Westchester Avenue, Suite N-517
Rye Brook, NY 10573
O. 914 798 4900

Property Photos

5676 RIVERDALE AVENUE
BRONX, NY

FOR LEASE: \$35 PSF MODIFIED GROSS





HOULIHAN LAWRENCE
COMMERCIAL

Floor Plan

5676 RIVERDALE AVENUE
BRONX, NY

FOR LEASE: \$35 PSF MODIFIED GROSS

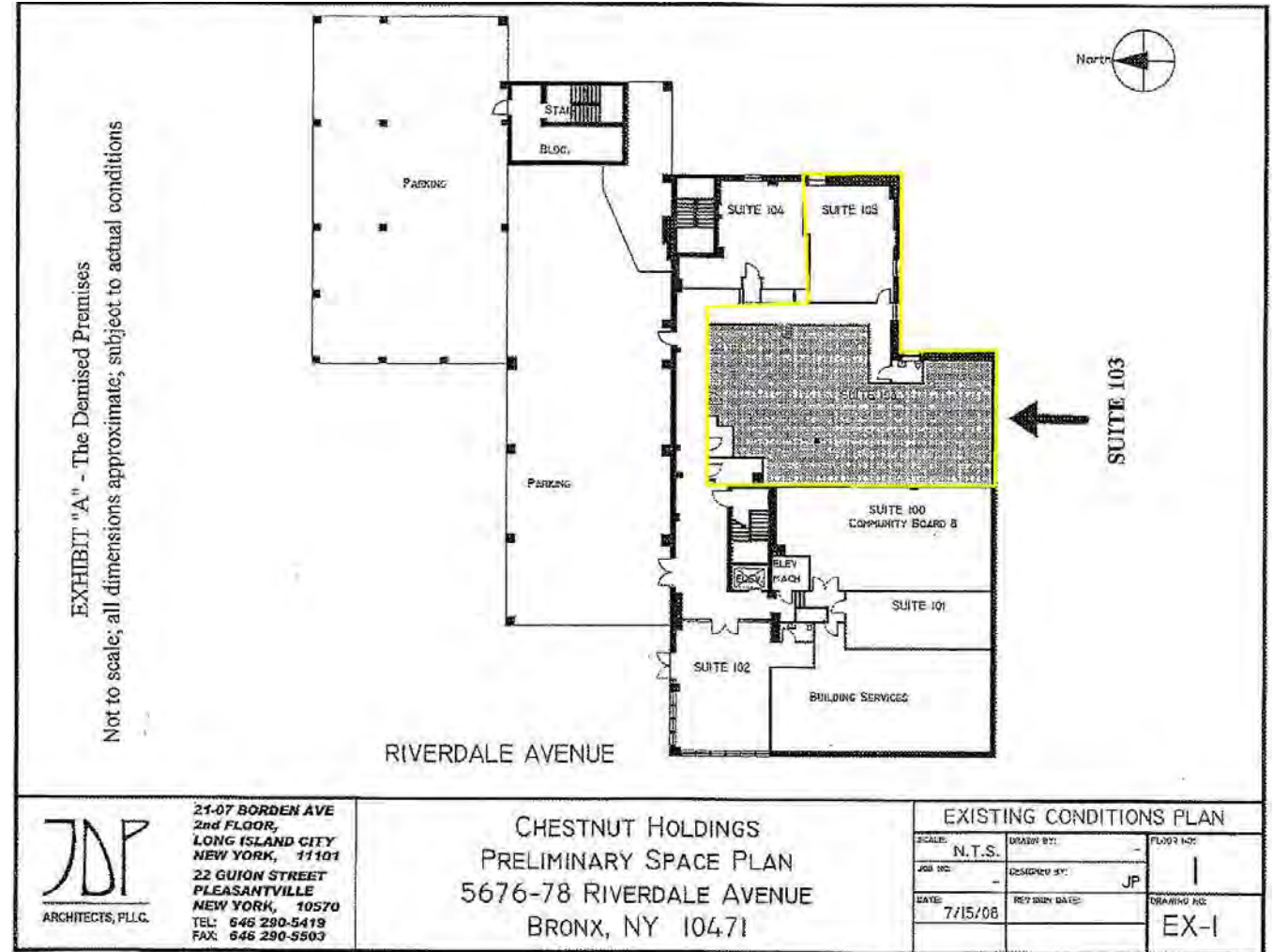

KLEIN | LANZA TEAM
Market Knowledge | Experience | Reputation

PETER CHEN

Licensed Real Estate Salesperson
M. 917.886.5188
PChen@hlcommercialgroup.com

Houlihan Lawrence Commercial
800 Westchester Avenue, Suite N-517
Rye Brook, NY 10573
O. 914 798 4900



HOULIHAN LAWRENCE
COMMERCIAL

KLEIN | LANZA TEAM

Market Knowledge | Experience | Reputation

PETER CHEN

Licensed Real Estate Salesperson

M. 917.886.5188

PChen@hlcommercialgroup.com

Houlihan Lawrence Commercial
800 Westchester Avenue, Suite N-517
Rye Brook, NY 10573
O. 914 798 4900

Aerial Overview

5676 RIVERDALE AVENUE
BRONX, NY

FOR LEASE: \$35 PSF MODIFIED GROSS





HOULIHAN LAWRENCE
COMMERCIAL

Regional Map

5676 RIVERDALE AVENUE
BRONX, NY

FOR LEASE: \$35 PSF MODIFIED GROSS

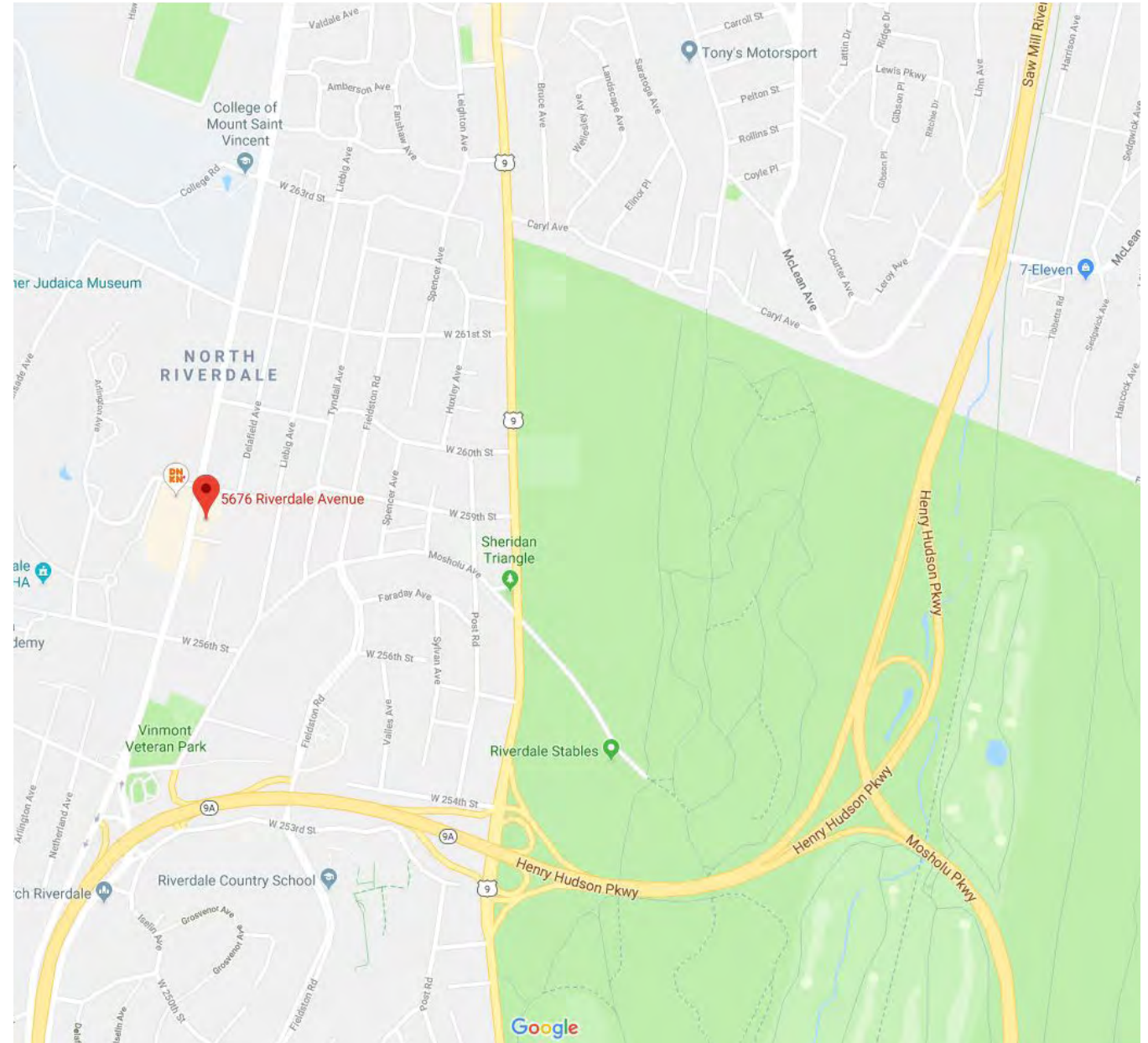

KLEIN | LANZA TEAM
Market Knowledge | Experience | Reputation

PETER CHEN

Licensed Real Estate Salesperson
M. 917.886.5188
PChen@hlcommercialgroup.com

Houlihan Lawrence Commercial
800 Westchester Avenue, Suite N-517
Rye Brook, NY 10573
O. 914 798 4900

The information contained in this Offering Memorandum is confidential, furnished solely for the purpose of review by a prospective purchaser of certain information relating to the property mentioned herein (the "Property"), and is not to be used for any other purpose or made available to any other person without the prior written consent of HLC. The material is subject to errors and omissions and based on part upon information supplied by sources deemed reliable.