



# Corner Ground Floor Retail/Office For Lease

4425 Ponce de Leon, Coral Gables, FL 33146





# Property Highlights

- 5,502 RSF corner suite available on the ground floor of the Offices at Merrick Park
- 8,425 RSF inline suite available next to the office lobby of the Offices at Merrick Park
- Both spaces can be combined for a total of 13,747 RSF with flexible division options
- Landlord open to all uses
- Corner space is currently built out as office, but previous tenant was restaurant
  - Grease trap/venting still in place
- Full on-site parking garage
- Nearby tenants include Nordstrom, Equinox, Tremble, Perry's Steakhouse, Trader Joe's, Lifetime Fitness, The Collection, Pure Barre, Sweat 440, and more
- Located in the heart of Merrick Park with easy access to US-1 and Downtown Coral Gables



## 3 Miles Demographics



**176,665**  
Population



**\$144,215**  
Average  
Household  
Income



**42**  
Median Age



**226,943**  
Daytime  
Population



# Area Overview





# Corner Suite Floor Plan - 5,502 RSF

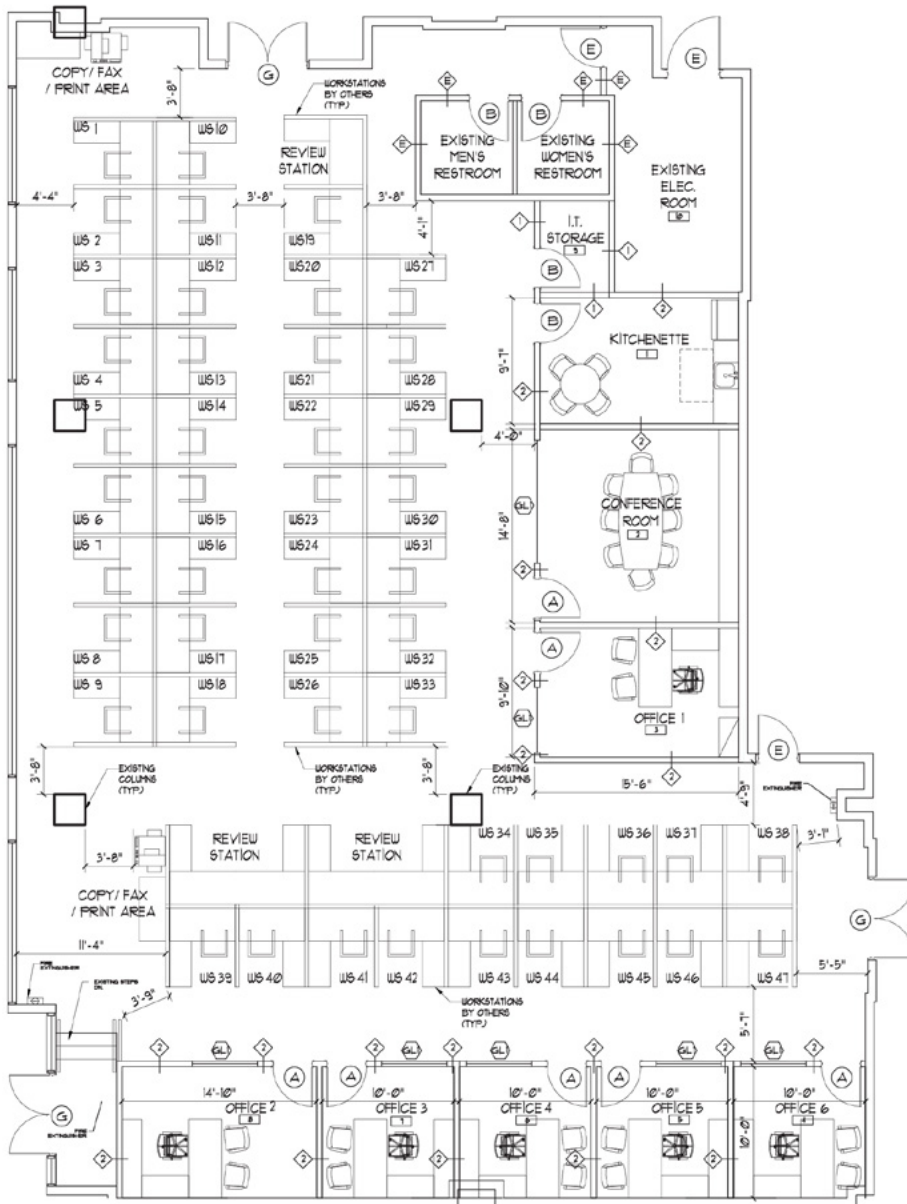

**Current layout/as-built**

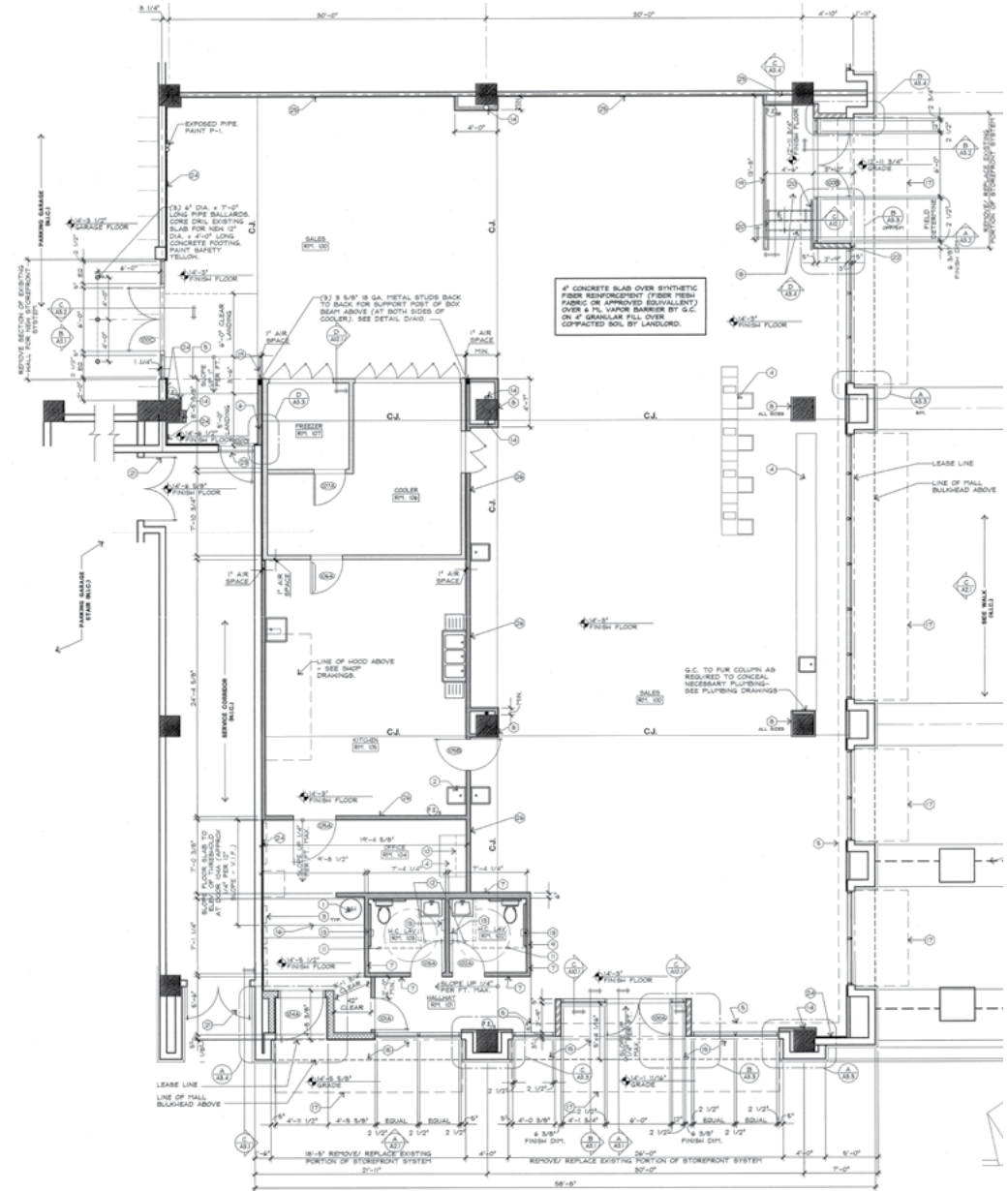

**Prior restaurant layout**

**Inline Suite Floor Plan - 8,245 RSF**

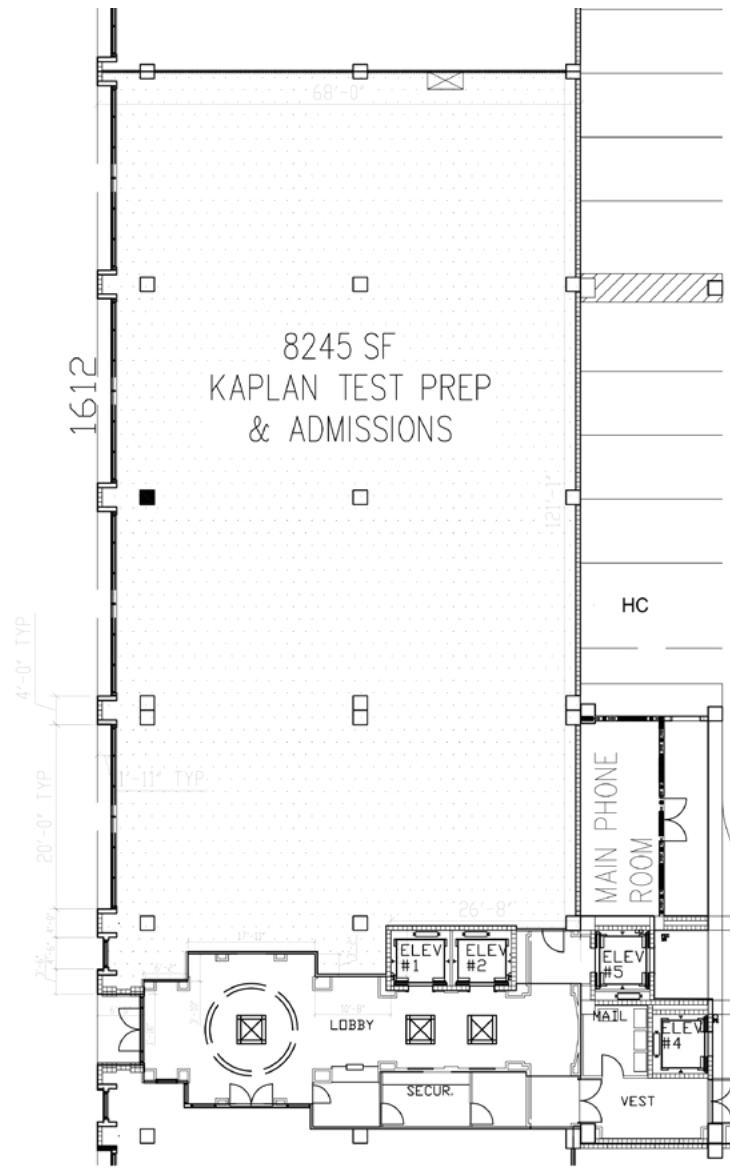

**LOD**

# Retail map





**For retail inquiries,  
please contact**

**Jonathan Rosen**  
+ 1 954 729 1074  
[jonathan.rosen@jll.com](mailto:jonathan.rosen@jll.com)

**Carter Nash**  
+ 1 305 704 1328  
[carter.nash@jll.com](mailto:carter.nash@jll.com)

**Michael Barashick**  
+ 1 561 444 6489  
[michael.barashick@jll.com](mailto:michael.barashick@jll.com)

---

**For office inquiries,  
please contact**

**Stephen Rutchik**  
+ 1 786 517 4985  
[stephen.rutchik@colliers.com](mailto:stephen.rutchik@colliers.com)

**Tom Farmer**  
+ 1 786 853 4973  
[tom.farmer@colliers.com](mailto:tom.farmer@colliers.com)

