

ROY MEDICAL

FOR LEASE



PROPERTY DETAILS

5682 S. 3500 W., Roy, UT 84067

Lease Rate: \$25.00/SF NNN

- 2,300 RSF available (shell condition)
- Tenant improvement allowance available
- Eyebrow and monument signage available
- Ample parking
- Excellent medical co-tenancy: Utah Cardiology, Wee Care Pediatrics, Oral Health Integrations, Tanner Clinic and Common Spirit
- \$7.50/SF NNN fees

2025 DEMOS



EST. POPULATION

1 MILE » **13,837**
3 MILE » **91,042**
5 MILE » **163,154**



EST. HOUSEHOLDS

1 MILE » **4,467**
3 MILE » **30,047**
5 MILE » **54,148**



EST. AVERAGE HH INCOME

1 MILE » **\$117,565**
3 MILE » **\$119,820**
5 MILE » **\$121,037**



CHRIS FALK, CCIM, SIOR
cfalk@newmarkmw.com
direct 801.499.6514
[View Profile](#)

BRAXTON WILLIE, CCIM
bwillie@newmarkmw.com
direct 801.803.3334
[View Profile](#)

BRANSON WOOD
bwood@newmarkmw.com
direct 801.510.5207
[View Profile](#)

**FULL SERVICE
COMMERCIAL REAL ESTATE**
1410 S University Park Blvd, Ste 120
Clearfield, Utah 84015
Office 801.578.5580
www.newmarkmw.com

ROY MEDICAL

TEST FIT EXAMPLES

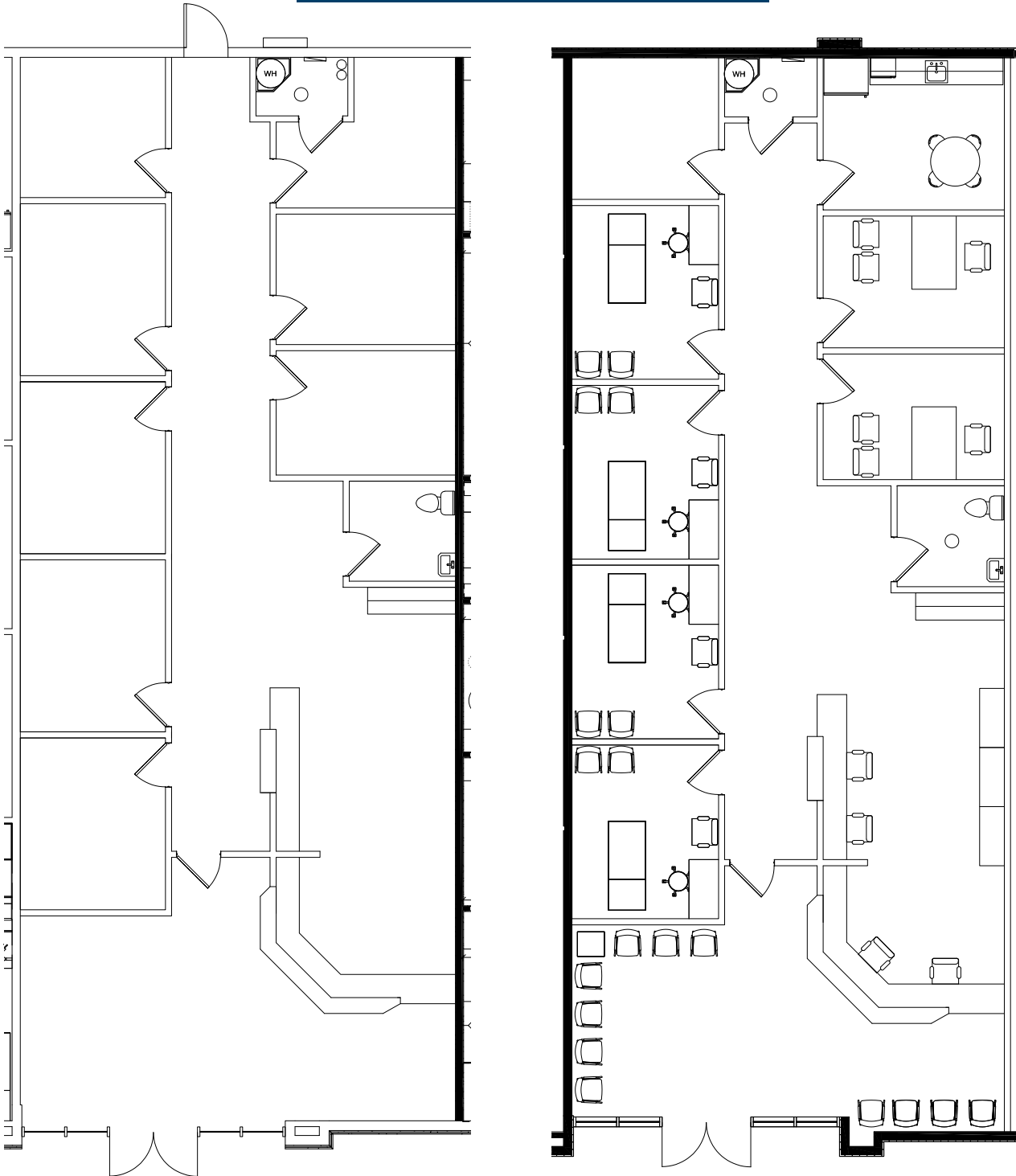

POTENTIAL MEDICAL SPACE PLAN DESIGN



CHRIS FALK, CCIM, SIOR
cfalk@newmarkmw.com
direct 801.499.6514
[View Profile](#)

BRAXTON WILLIE, CCIM
bwillie@newmarkmw.com
direct 801.803.3334
[View Profile](#)

BRANSON WOOD
bwood@newmarkmw.com
direct 801.510.5207
[View Profile](#)

**FULL SERVICE
COMMERCIAL REAL ESTATE**
1410 S University Park Blvd, Ste 120
Clearfield, Utah 84015
Office 801.578.5580
www.newmarkmw.com

ROY MEDICAL

TEST FIT EXAMPLES

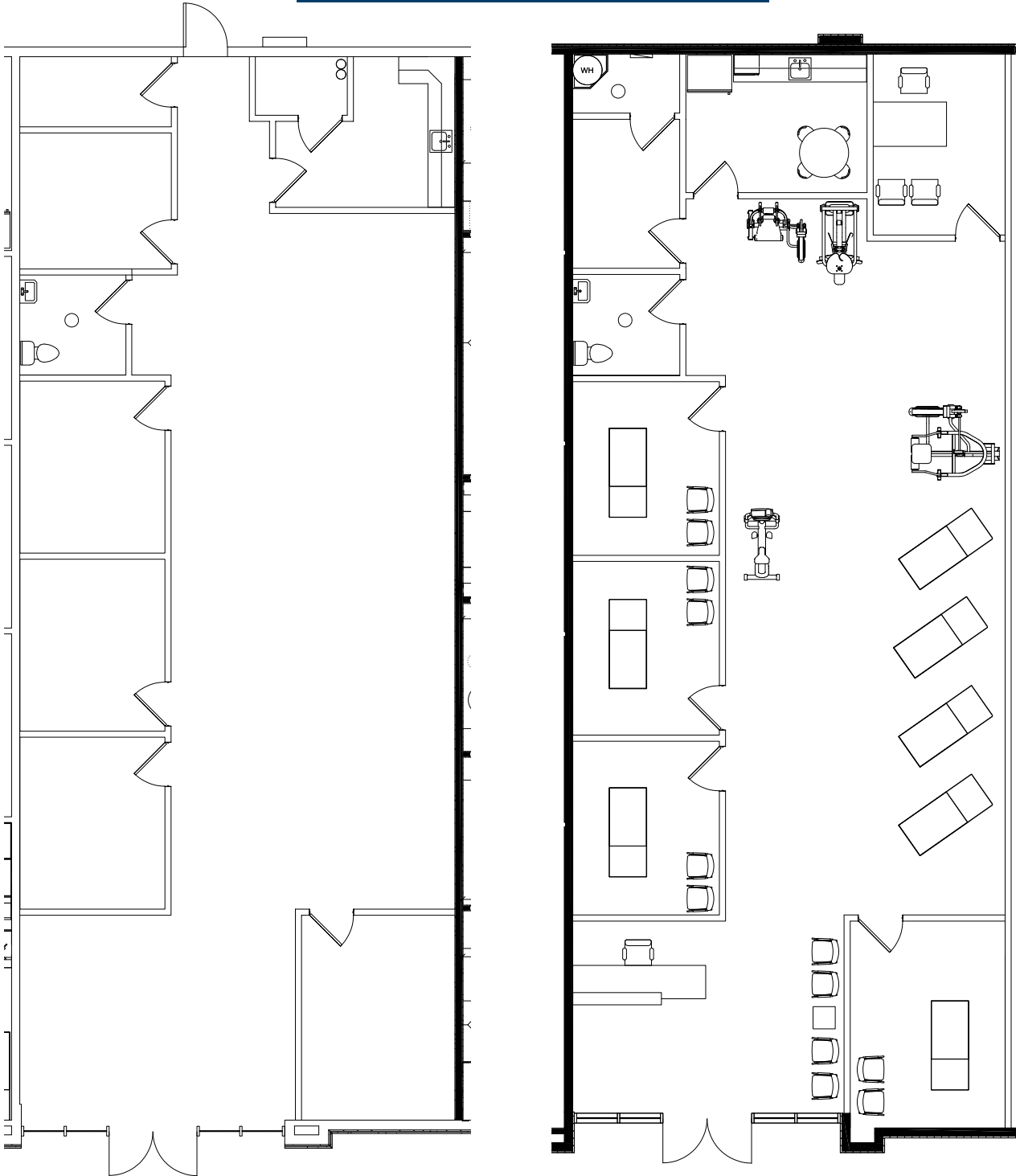

POTENTIAL PT SPACE PLAN DESIGN



CHRIS FALK, CCIM, SIOR
cfalk@newmarkmw.com
direct 801.499.6514
[View Profile](#)

BRAXTON WILLIE, CCIM
bwillie@newmarkmw.com
direct 801.803.3334
[View Profile](#)

BRANSON WOOD
bwood@newmarkmw.com
direct 801.510.5207
[View Profile](#)

**FULL SERVICE
COMMERCIAL REAL ESTATE**
1410 S University Park Blvd, Ste 120
Clearfield, Utah 84015
Office 801.578.5580
www.newmarkmw.com

ROY MEDICAL

MEDICAL SPACE TEST FIT 2,300 RSF AVAILABLE

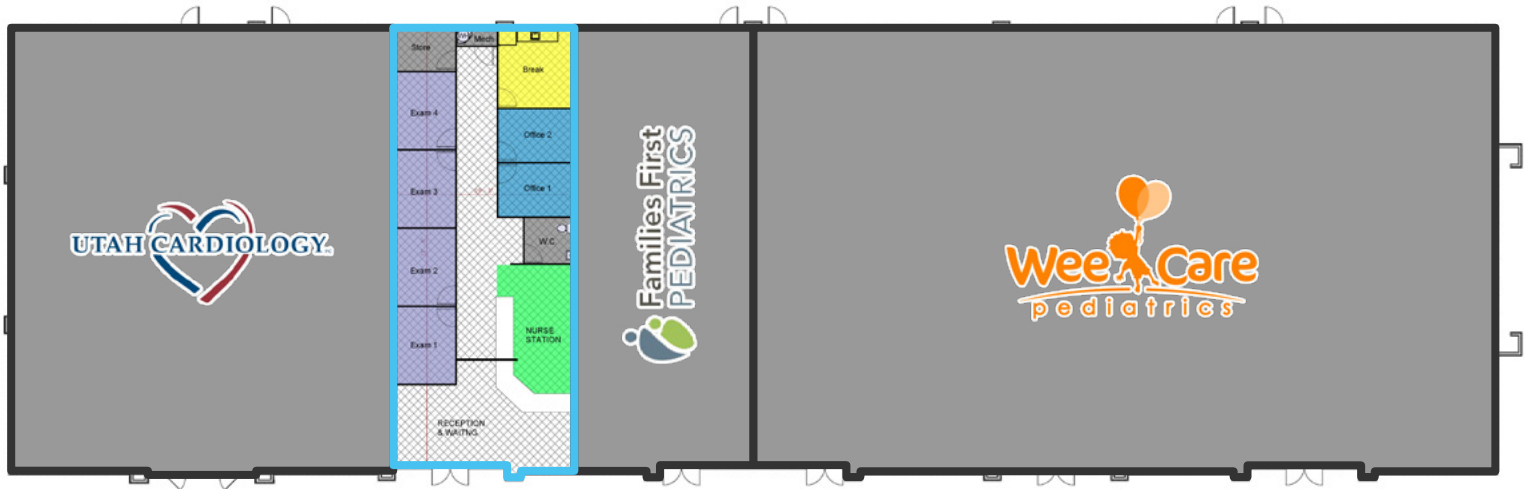

PT SPACE TEST FIT 2,300 RSF AVAILABLE

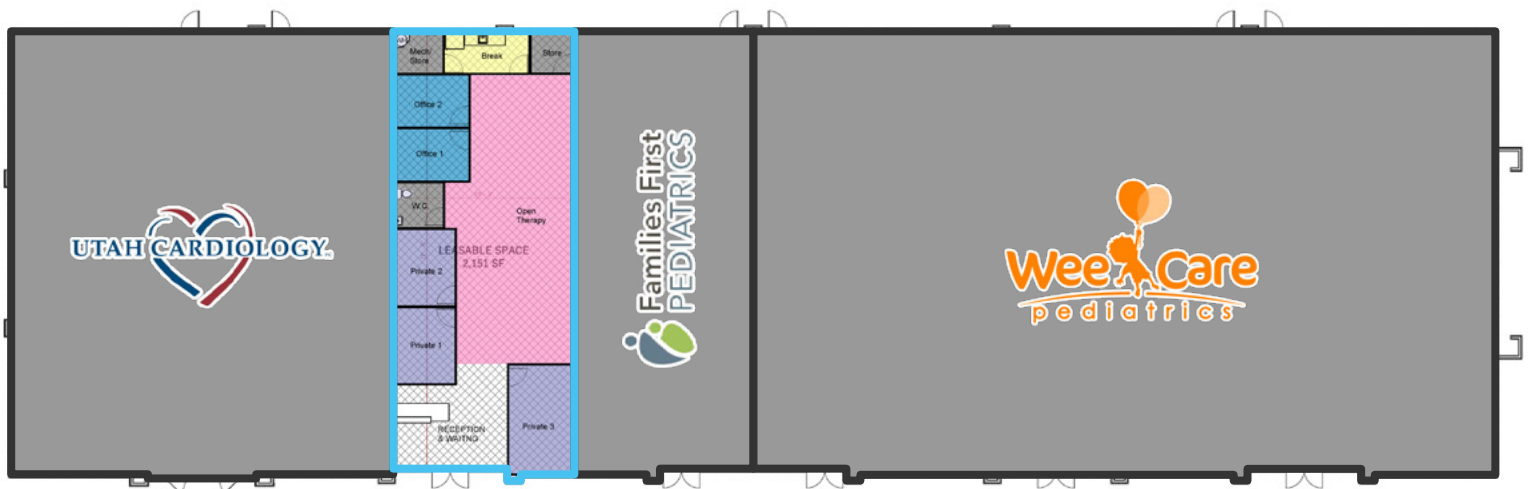



CHRIS FALK, CCIM, SIOR
 cfalk@newmarkmw.com
 direct 801.499.6514
[View Profile](#)

BRAXTON WILLIE, CCIM
 bwillie@newmarkmw.com
 direct 801.803.3334
[View Profile](#)

BRANSON WOOD
 bwood@newmarkmw.com
 direct 801.510.5207
[View Profile](#)

**FULL SERVICE
 COMMERCIAL REAL ESTATE**
 1410 S University Park Blvd, Ste 120
 Clearfield, Utah 84015
 Office 801.578.5580
www.newmarkmw.com