



105 Despatch Dr

East Rochester, NY 14445

Space Available: **3,500 SF**

- » Ideal for Office Use
- » Each Rentable Space has Own Entrance and Exit
- » Lots of Natural Light
- » High Ceilings
- » 130 Parking Spots
- » Great Street Exposure

New ownership of this class B office/medical/Flex space in a central eastside location. This pre-engineered metal and decorative block building has tinted glass windows from grade to 9 ft. above grade and is located on 3.0 acres in a parklike setting, 24/7 building access & loading docks, 4 ea. truck high with an overhead door are available.



Real Estate *it's in our blood!*
www.flaummgmt.com

Contact Us: 400 Andrews Street #500 | Rochester, NY 14604 | 585.546.4866

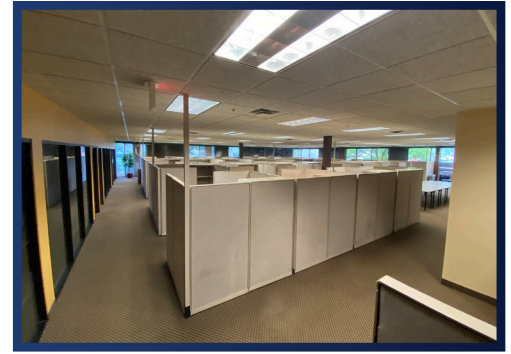

PROPERTY DETAILS

Rental Rate: TBD
Property Type: Office
Property Sub-Type: Medical
Building Class: B
Year Built: 1994

Date Available: Now
Lease Term: Negotiable
Total Building SF: 31,849 SF
Parking Spaces: 136

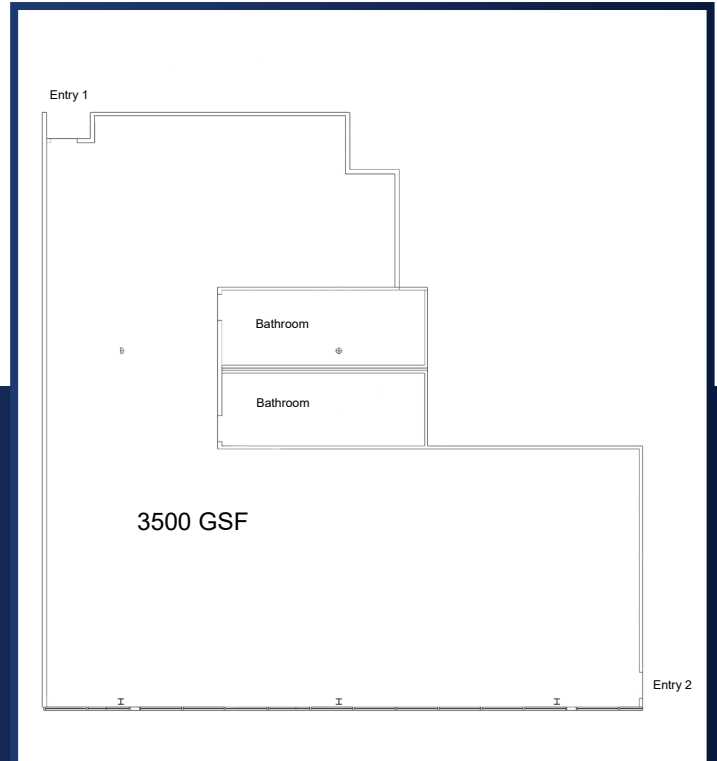
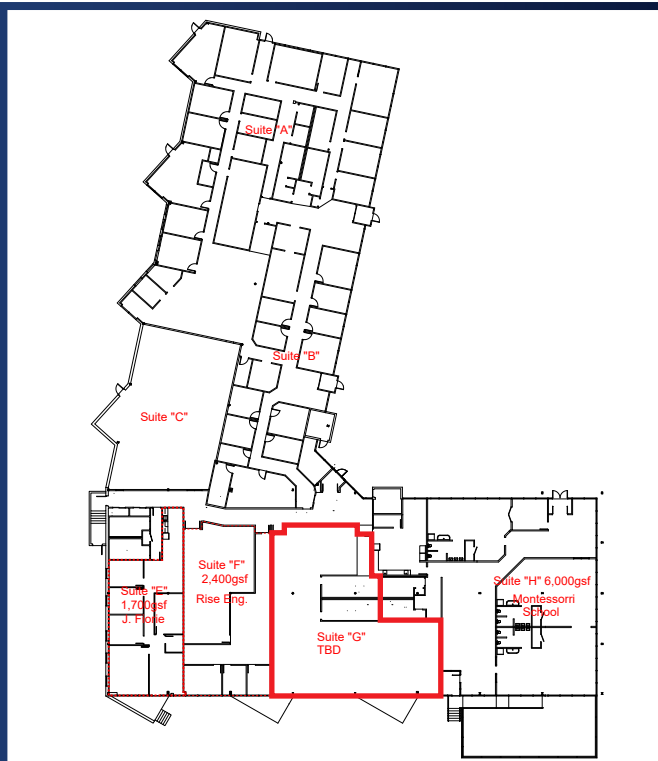

Let our experienced professionals help you today. With decades of experience, our team brings a wealth of experience in real estate, brokerage, and project management.

Real Estate *it's in our blood!*

www.flaummgmt.com