

COUNTRY NORTH PLAZA

NEC Country Club Dr & Brown Rd
1211 N Country Club Dr, Mesa, AZ



8767 E. Via de Ventura
Suite 290
Scottsdale, AZ 85258
RGcre.com

JAKE ERTLE

480.214.9419
Jake@RGcre.com

NIC CHAVIRA

480.214.9409
Nic@RGcre.com

FOR LEASE

COUNTRY NORTH PLAZA

Site Information

1211 N Country Club Dr
Mesa, AZ

FEATURES

- 1,227 - 9,933 SF Available
- Over 42,000 VPD at Intersection
- More than 316,000 Residents within a 5-Mile Radius
- Proximity to Loop 202 and Downtown Mesa
- Join:



AVAILABLE SUITES

- 1,227 SF
- 2,600 SF
Flex Space with Roll Up Door
- Up to 9,933 SF

DEMOGRAPHICS (2023)

	2 MILE	5 MILE	10 MILE
Population	68,043	316,466	1,061,181
Average Household Income	\$59,587	\$70,541	\$90,382
Total Households	25,547	120,160	418,686

The information contained herein has been obtained from sources we believe to be reliable, however, Rein & Grosseohme and its agents have not conducted any investigation regarding these matters and make no warranty or representation expressed or implied regarding the accuracy or completeness of the information. Interested parties need to verify any information that is critical to their decision process and bear all risk for inaccuracies. References to square footage or age are approximate.

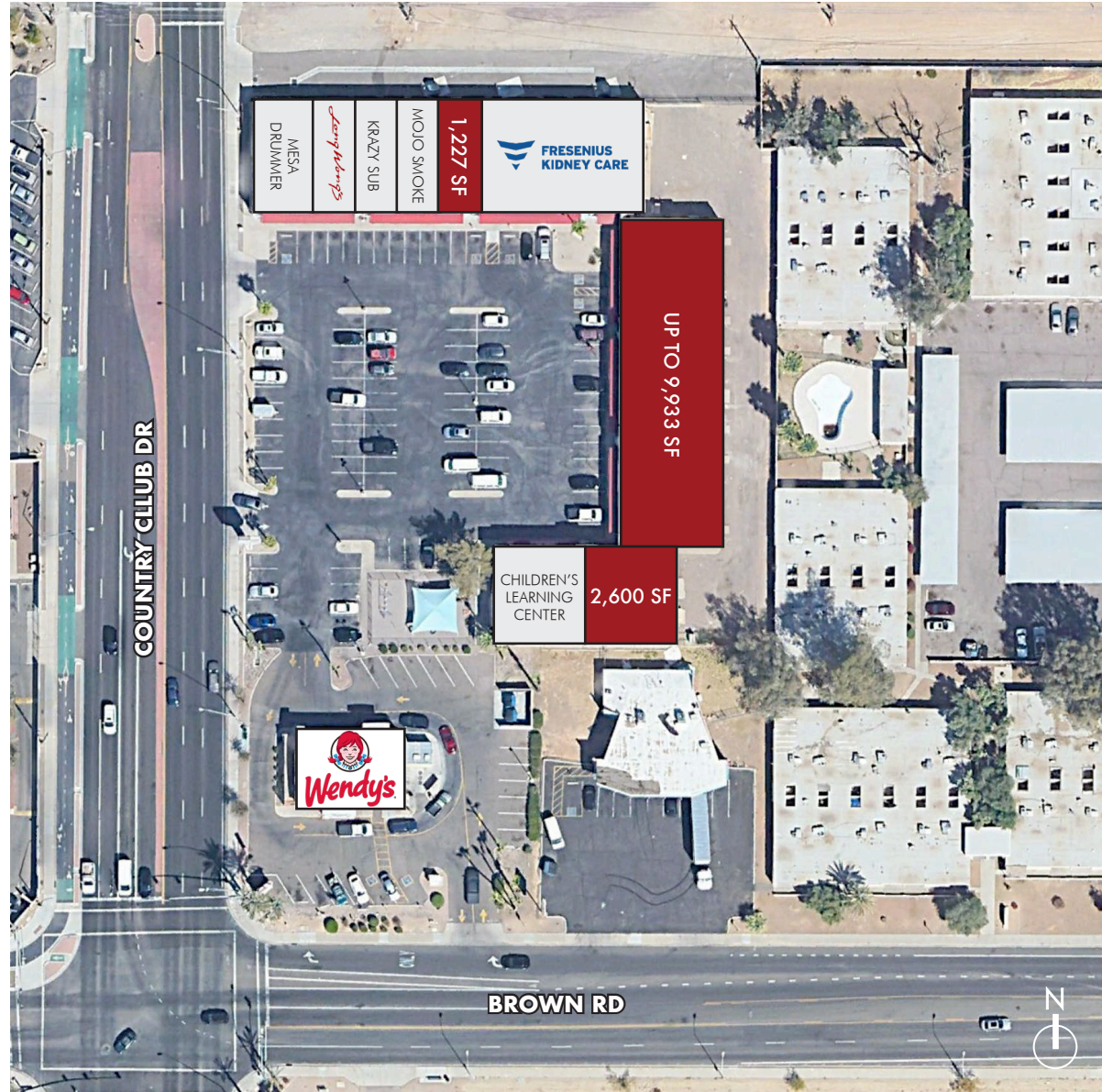

8767 E. Via de Ventura
Suite 290
Scottsdale, AZ 85258
RGcre.com

JAKE ERTLE

480.214.9419
Jake@RGcre.com

NIC CHAVIRA

480.214.9409
Nic@RGcre.com

FOR LEASE

COUNTRY NORTH PLAZA

Property Photos

R&G
REIN & GROSSEHME
COMMERCIAL REAL ESTATE



8767 E. Via de Ventura
Suite 290
Scottsdale, AZ 85258
RGcre.com

JAKE ERTLE
480.214.9419
Jake@RGcre.com

NIC CHAVIRA
480.214.9409
Nic@RGcre.com

FOR LEASE

COUNTRY NORTH PLAZA

Retailer Map

R&G
REIN & GROSSEHME
COMMERCIAL REAL ESTATE

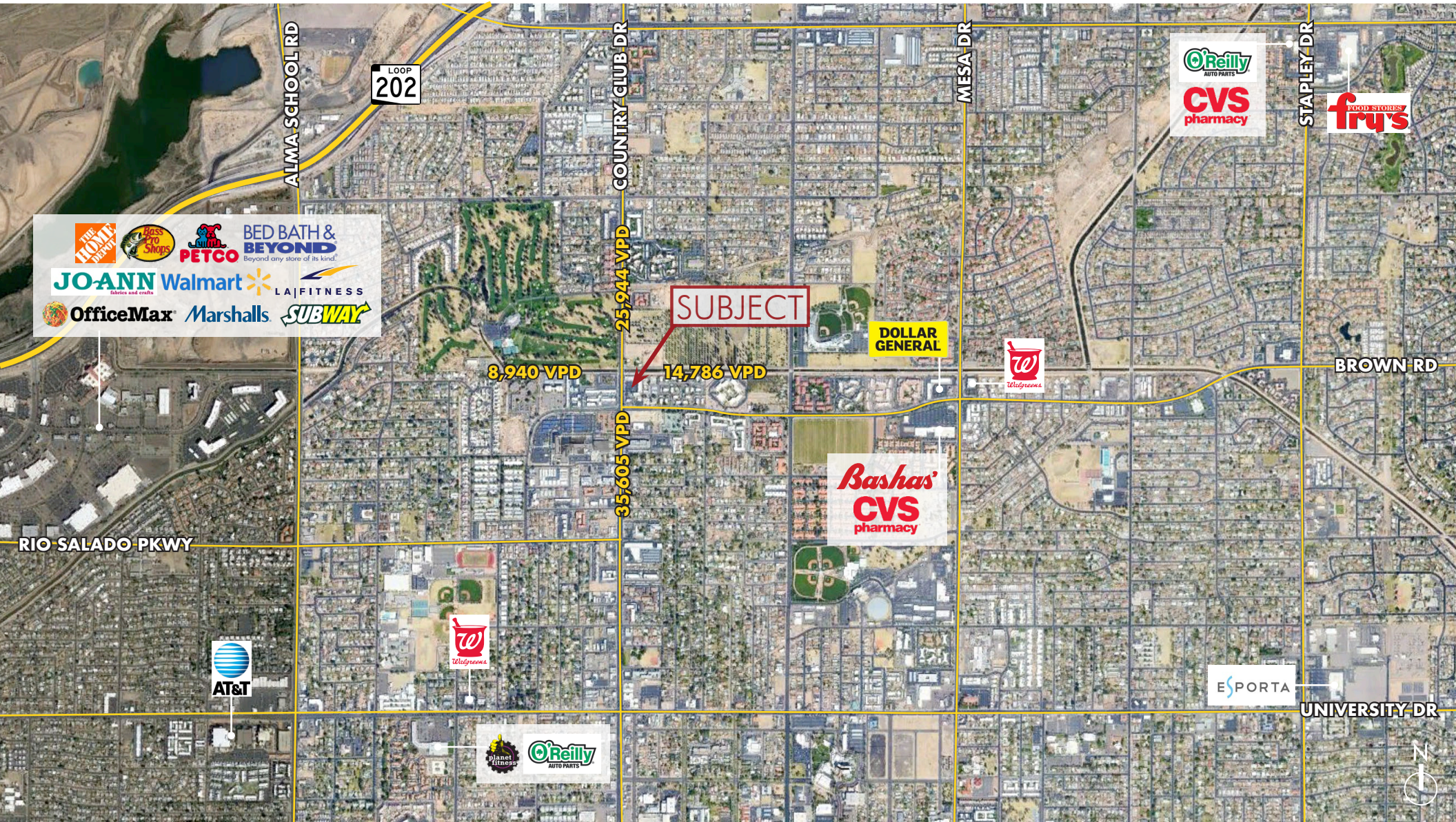

8767 E. Via de Ventura
Suite 290
Scottsdale, AZ 85258
RGcre.com

JAKE ERTLE

480.214.9419
Jake@RGcre.com

NIC CHAVIRA

480.214.9409
Nic@RGcre.com