

FOR LEASE

299 Farrell Road  
Syracuse, New York 13209



Join Busy Dunkin'!



## Up to 3,200± SF Retail Space

### Property Highlights

- High profile location in the new Dunkin Plaza
- Can be subdivided to two tenant spaces
- Located on the corner of John Glenn Blvd and Farrell Road
- Great signage available on 35' pylon and building
- Easy ingress/egress at traffic light
- Excellent access to I-690 east/west as well as the New York State Thruway (I-90)
- Unimproved space can be finished to tenant specifications
- Neighbors include CocaCola, Metro Mattress, Old Dominion, Americold Logistics and Clarion Inn & Suites

Demographic	1 Mile	3 Miles	5 Miles
Population	744	29,524	95,755
Households	312	12,757	40,959
Average H.H. Income	\$78,332	\$81,246	\$83,140
Daytime Employees	2,388	10,669	43,550
Source: ESRI Business Analyst 2021			

Traffic Counts	
John Glenn Blvd	24,622 AADT
Farrell Road	2,510 AADT
Long Branch Road	1,869 AADT
Source: NYS DOT 2019	

### Contact

**CHRISTOPHER SAVAGE**  
Real Estate Salesperson  
+1 315 445 8519  
csavage@pyramidbrokerage.com

**MARK AUSTIN**  
Real Estate Salesperson  
+1 315 445 8538  
maustin@pyramidbrokerage.com

5845 Widewaters Pkwy, Suite 200  
East Syracuse, New York 13057  
+1 315 445 1030  
pyramidbrokerage.com

FOR LEASE

299 Farrell Road | Syracuse, New York

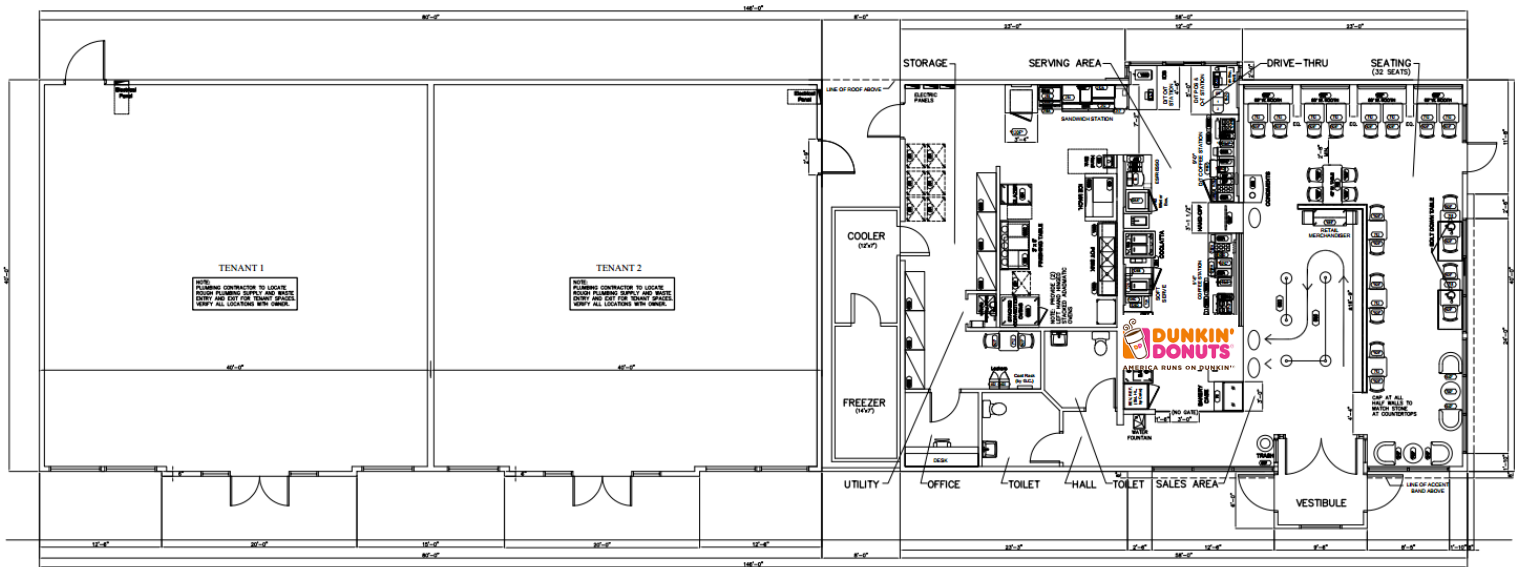

FLOOR PLAN  
SCALE: 3/16" = 1'-0"



**FOR LEASE**

**299 Farrell Road | Syracuse, New York**

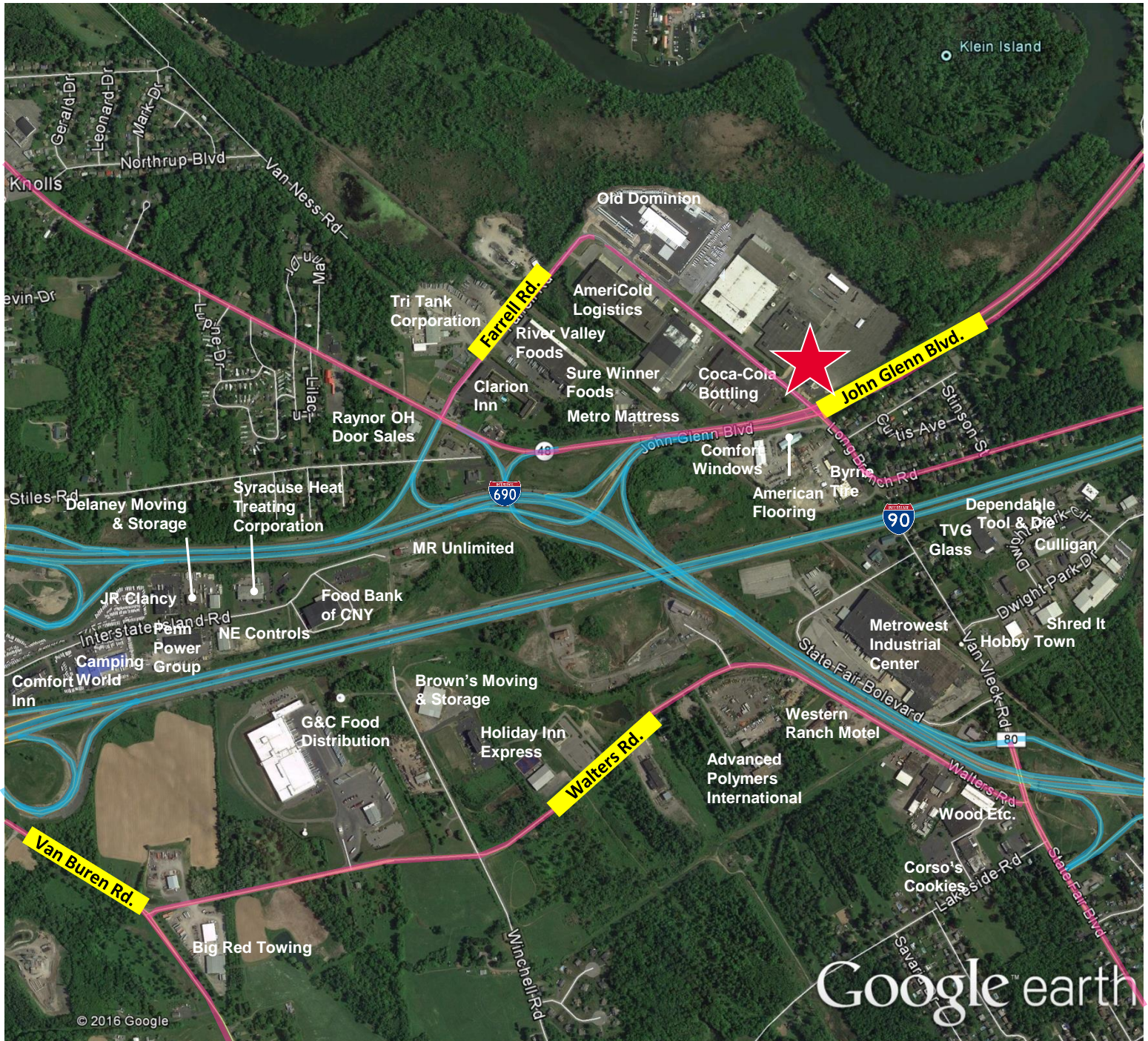

Independently Owned and Operated / A Member of the Cushman & Wakefield Alliance

Cushman & Wakefield Copyright 2022. No warranty or representation, express or implied, is made to the accuracy or completeness of the information contained herein, and same is submitted subject to errors, omissions, change of price, rental or other conditions, withdrawal without notice, and to any special listing conditions imposed by the property owner(s). As applicable, we make no representation as to the condition of the property (or properties) in question.