

**3 Months of
Rent Abatement**
with a minimum 3 Year Contract



MARGARITA PROFESSIONAL BUILDING

Office Space or Medical Use
FOR LEASE

43920 MARGARITA ROAD | TEMECULA | CALIFORNIA | 92592

FOR MORE INFORMATION CONTACT:

Cyndi Light
SENIOR VICE PRESIDENT
951.297.7427
cyndil@cbsocalgroup.com
CalDRE # 01717659



**COLDWELL BANKER
COMMERCIAL**
SC

27368 Via Industria | Suite 102 | Temecula | California | 92590
t 951.200.7683 | f 951.239.3147 | cbsocalgroup.com

MARGARITA PROFESSIONAL BUILDING

PROFESSIONAL OFFICE SPACE
FOR LEASE

43920 MARGARITA ROAD | TEMECULA | CALIFORNIA | 92592

PROPERTY FEATURES

- Available:
Suite D \pm 1,096 SF
Suite B \pm 1,186 SF
Suite H \pm 2,768 SF
- Office or Medical Use
- Outstanding architecturally designed professional office space
- 4:1,000 parking plus reciprocal parking with adjacent buildings
- FiOS enabled
- Lush landscaping
- High quality construction and materials used throughout
- Located on corner of Margarita Road and De Portola Road with easy access to the I-15 via Temecula Parkway
- Within walking distance to shopping and dining, just one block from Temecula Valley Hospital
- **Contact Agent for Showing**



MARGARITA PROFESSIONAL BUILDING

PROFESSIONAL OFFICE SPACE FOR LEASE

43920 MARGARITA ROAD | TEMECULA | CALIFORNIA | 92592

SUITE	SIZE (SF)	LEASE RATE	COMMENTS
B	±1,186	\$1.95 PSF, MG	private offices, conference room, and reception area
D	±1,096	\$1.95 PSF, MG	private offices, conference room, and reception area
H	±2,768	\$1.95 PSF, MG	private offices, conference room, and reception area

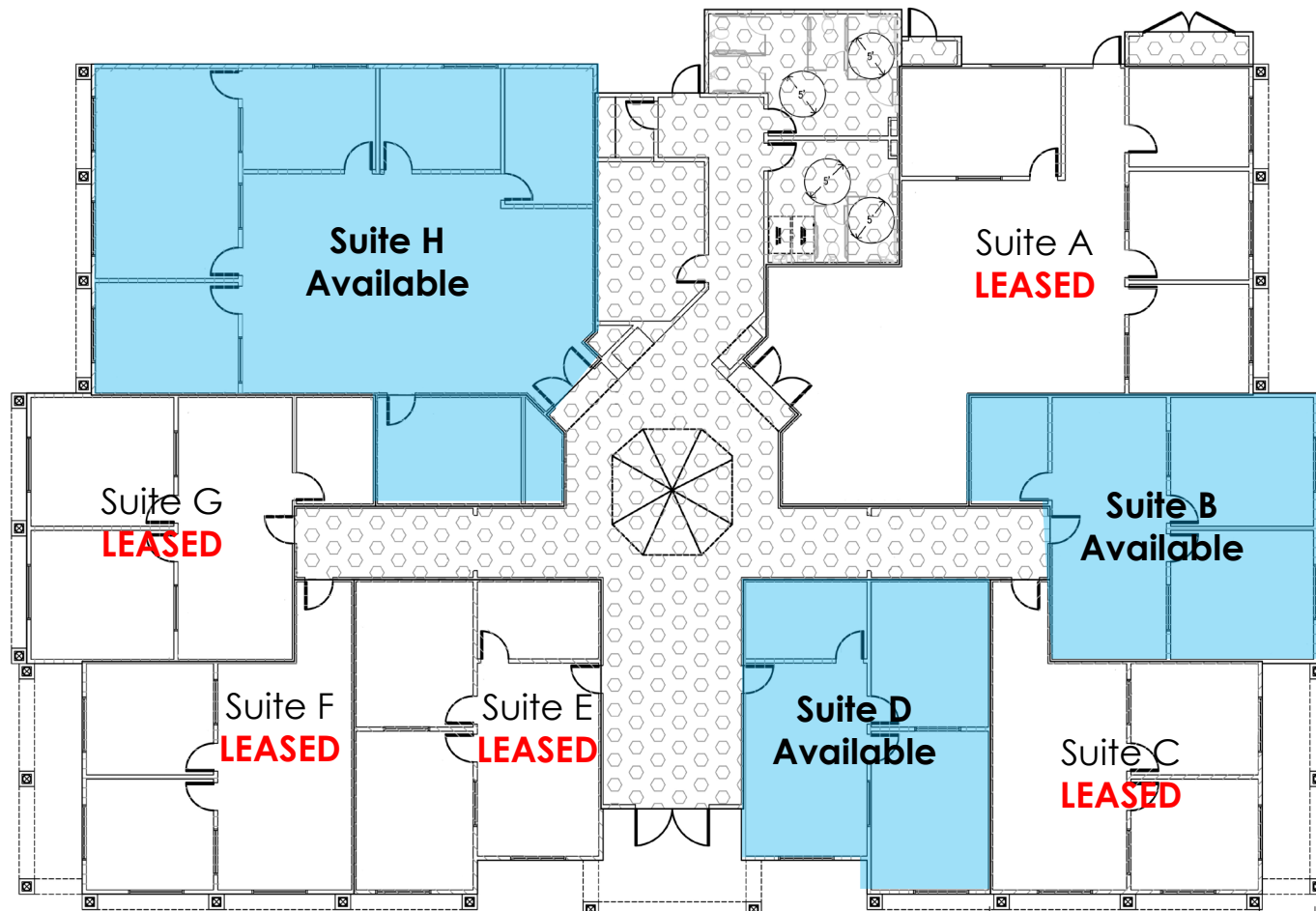

MARGARITA PROFESSIONAL BUILDING

PROFESSIONAL OFFICE SPACE
FOR LEASE

43920 MARGARITA ROAD | TEMECULA | CALIFORNIA | 92592



COLDWELL BANKER COMMERCIAL AND THE COLDWELL BANKER COMMERCIAL LOGO ARE REGISTERED SERVICE MARKS LICENSED TO COLDWELL BANKER COMMERCIAL AFFILIATES. EACH OFFICE IS INDEPENDENTLY OWNED AND OPERATED. ALL INFORMATION CONTAINED HEREIN HAS BEEN OBTAINED FROM SOURCES DEEMED RELIABLE. HOWEVER, NO WARRANTY OR GUARANTEE IS MADE AS TO THE ACCURACY OF THE INFORMATION.
CALDRE LICENSE # 02089395

MARGARITA PROFESSIONAL BUILDING

PROFESSIONAL OFFICE SPACE
FOR LEASE

43920 MARGARITA ROAD | TEMECULA | CALIFORNIA | 92592

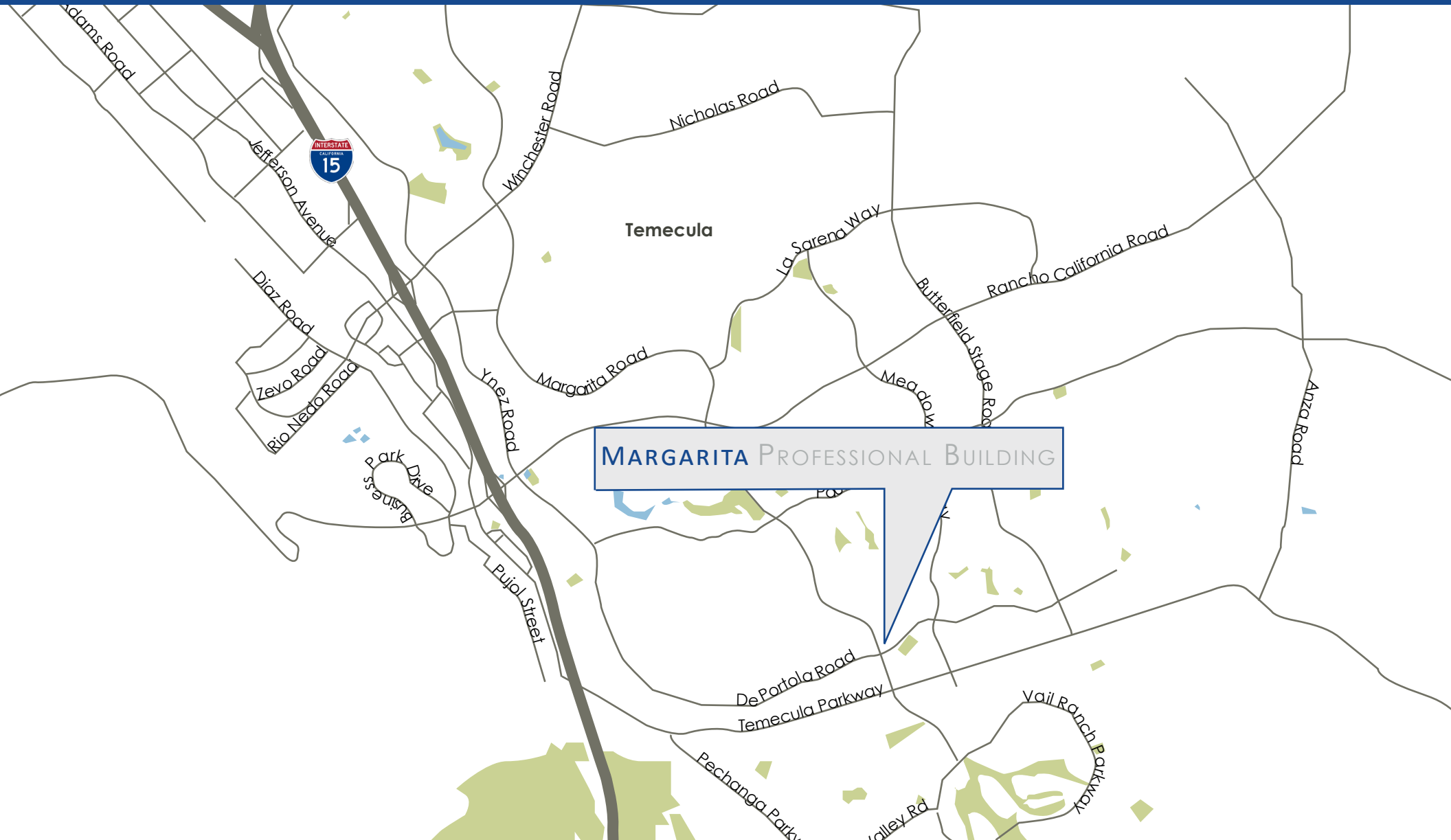

MARGARITA PROFESSIONAL BUILDING

PROFESSIONAL OFFICE SPACE
FOR LEASE

43920 MARGARITA ROAD | TEMECULA | CALIFORNIA | 92592



© 2023 Coldwell Banker Commercial® is a registered trademark licensed to Coldwell Banker Real Estate Corporation. An Equal Opportunity Company. Each Office is Independently Owned and Operated Except Offices Owned and Operated by NRT Incorporated.

Coldwell Banker Commercial and the Coldwell Banker Commercial Logo are registered service marks licensed to Coldwell Banker Commercial Affiliates. Each Office is Independently Owned and Operated. All information contained herein has been obtained from sources deemed reliable. However, no warranty or guarantee is made as to the accuracy of the information. CalBRE License # 01998652

FOR MORE INFORMATION CONTACT:

Cyndi Light
SENIOR VICE PRESIDENT
951.297.7427
cyndil@cbsocalgroup.com
CalDRE # 01717659



COLDWELL BANKER
COMMERCIAL
SC

27368 Via Industria | Suite 102 | Temecula | California | 92590
† 951.200.7683 | f 951.239.3147 | cbsocalgroup.com