



**BERKSHIRE
HATHAWAY**
HomeServices

Stein & Summers
Real Estate



**\$11-16/SF
GROSS**

TIFFANY SPRINGS OFFICE SPACE

FOR MORE INFORMATION,
PLEASE CONTACT:

Jayce Keller
816.332.8925
jkeller@bhhsstein.com

PROPERTIES:

7505 & 7509
NW Tiffany Springs Pkwy,
Kansas City, MO 64153

PROPERTY FOR LEASE



ABOUT THE PROPERTY

MOVE IN READY! 7505 & 7509 NW Tiffany Springs Pkwy, 2 buildings for lease and under new ownership and management. First-class upgrades coming to the lobbies, common areas, and break room. Life Safety systems, handicap accessibility, and fiber internet. Located just 5 min from Kansas City International Airport and 15 min from Downtown Kansas City. Easy highway access, close to restaurants and hotels/convention centers, and Tiffany Greens Golf Course just down the road. Small to large floor plans, ranging from 400 - 4,302 SF between both buildings. Building signage for right size tenant and ample parking at no extra cost. The \$8-16/SF Gross is for as-is condition and space. Janitorial cleaning of tenant's space is not included in the Gross Lease.

PROPERTY DETAIL



SQ FT. 500 - 4,302



AMPLE PARKING



RIGHT OFF I-29

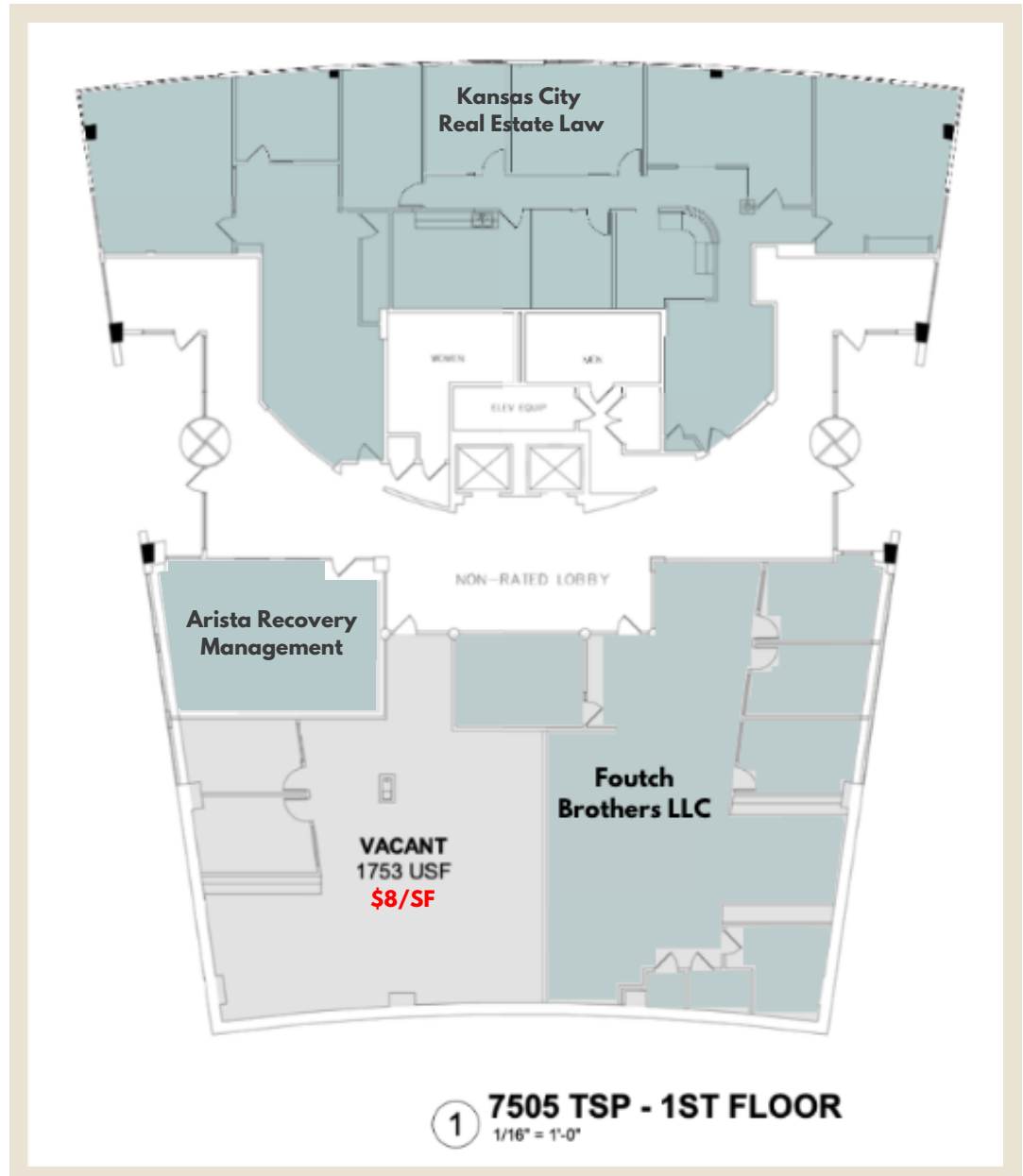

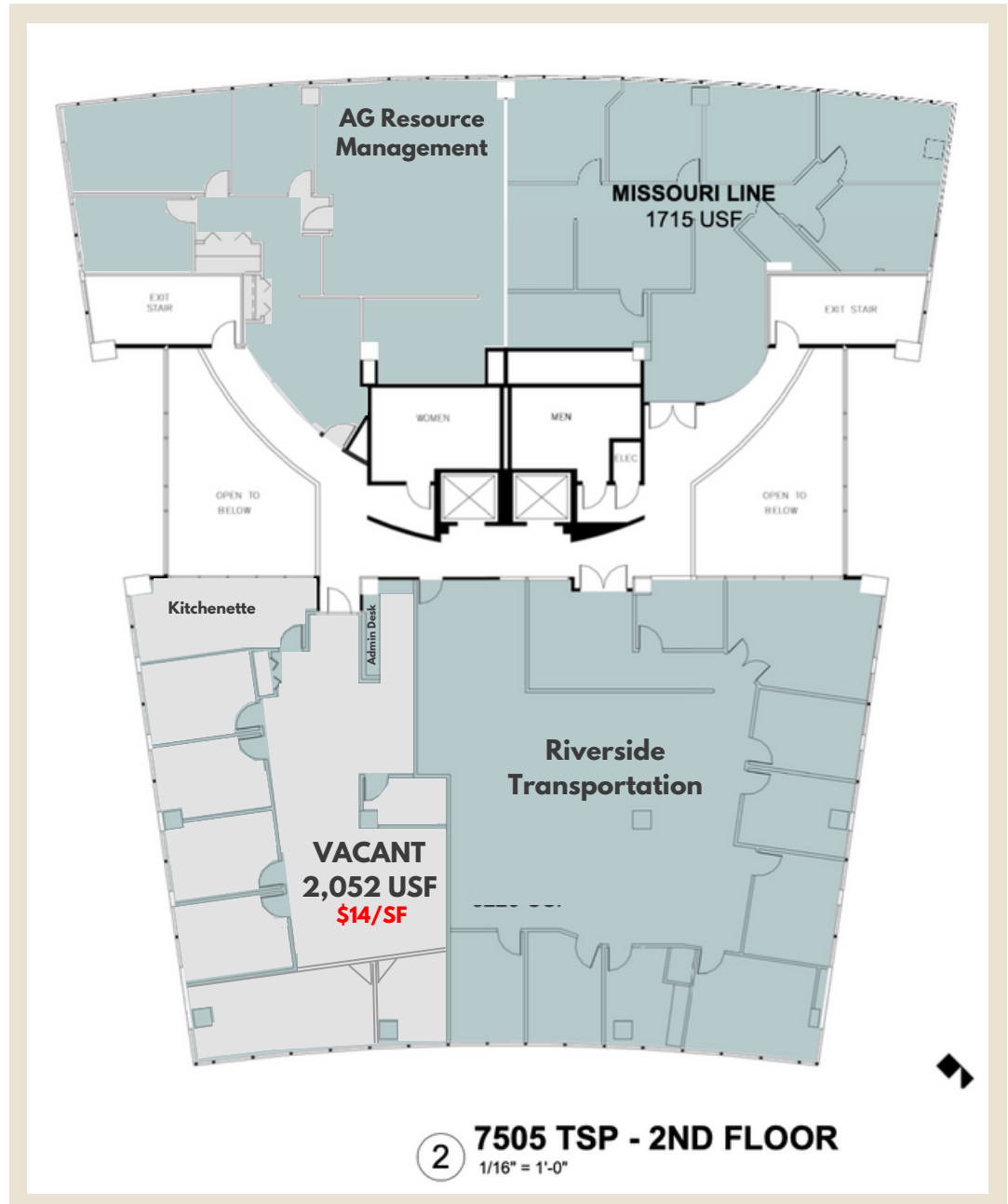

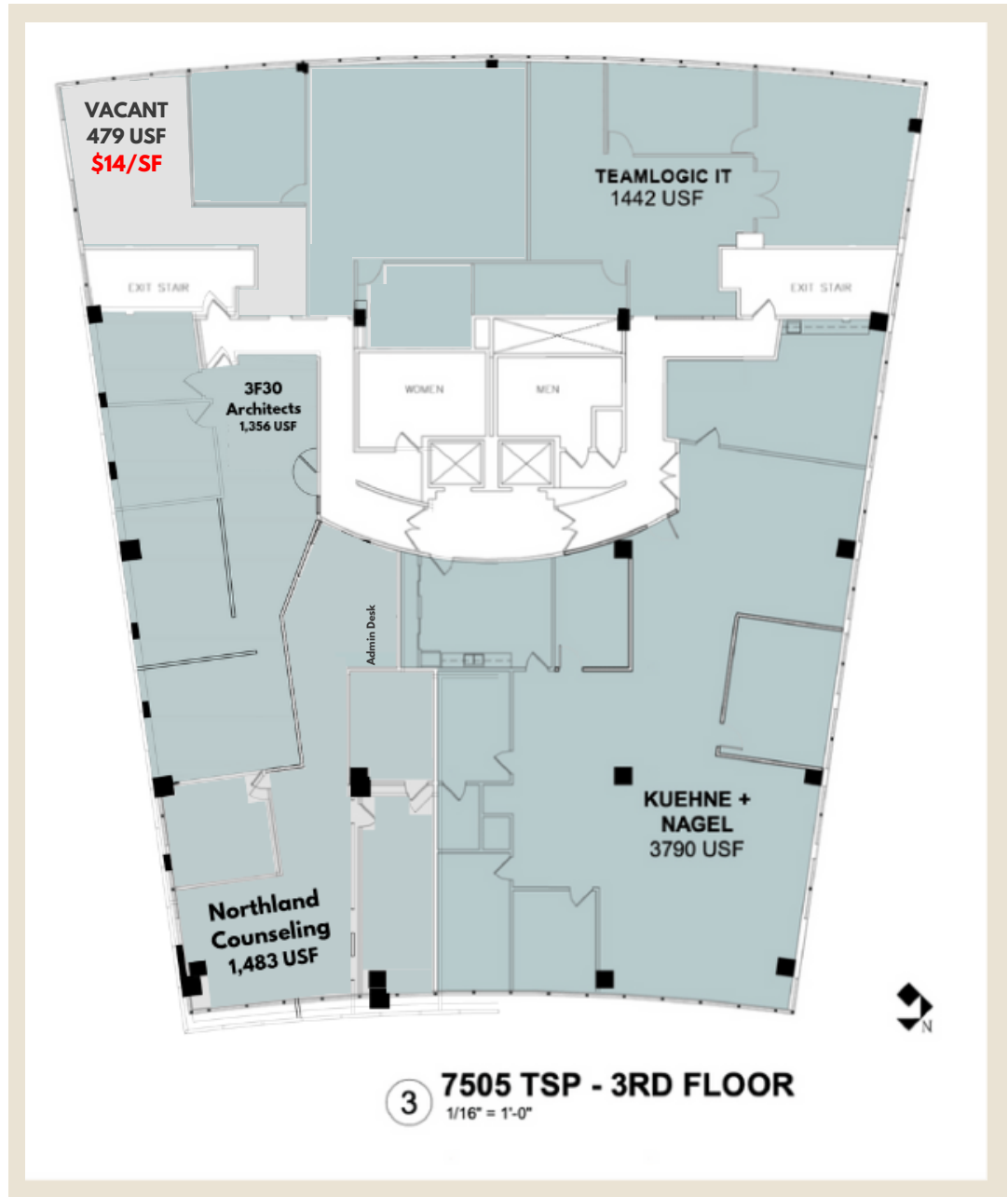

3 7505 TSP - 3RD FLOOR
1/16" = 1'-0"

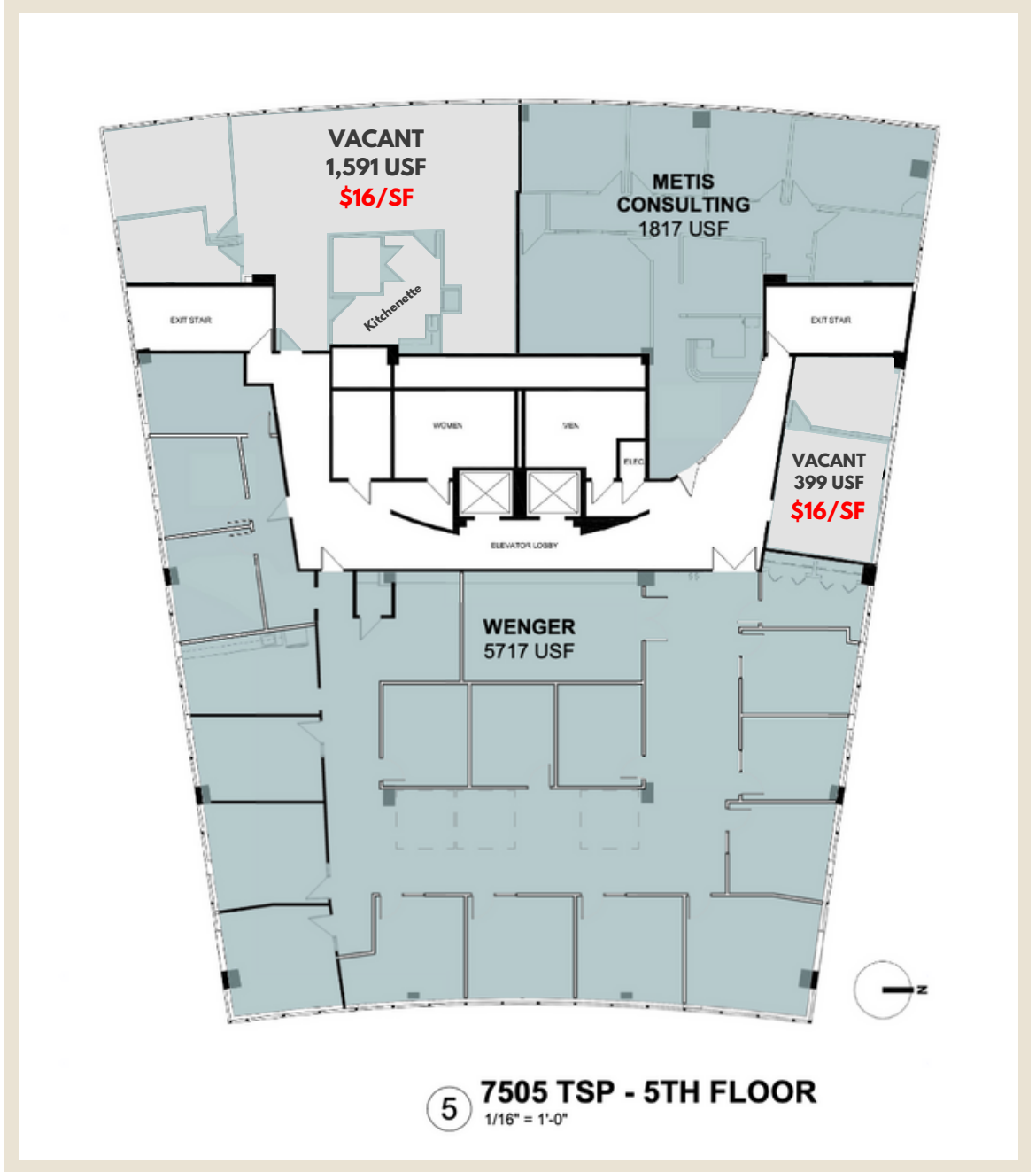

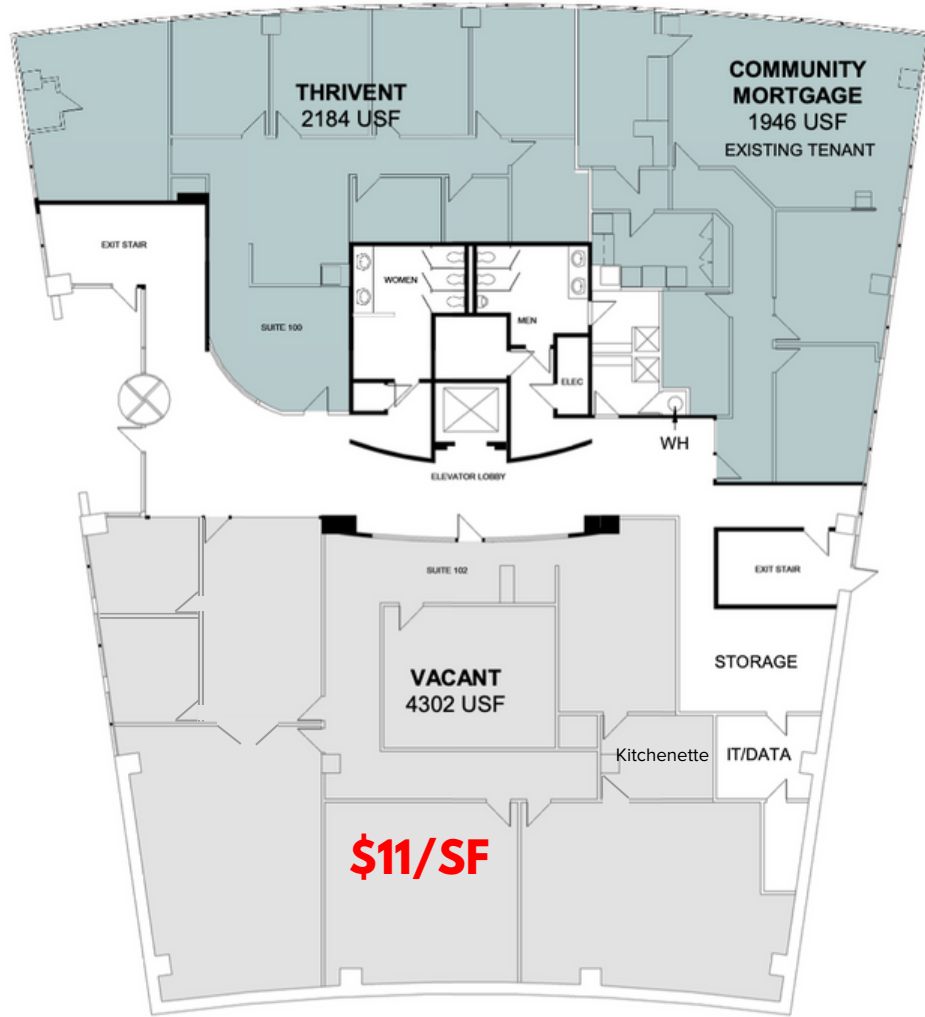

\$11/SF

1 7509 TSP - 1ST FLOOR
1/16" = 1'-0"



Businesses Nearby

1.5 MILES

- Jason's Deli
- Dickey's BBQ Pit
- Five Guys
- Nothing Bundt Cakes
- Golden Corral
- Chuck E. Cheese's
- Phillips 66
- Marshalls

2.5 MILES

- Gap
- Old Navy
- Chipotle
- Lowe's
- Wal-Mart
- Sonic
- Buffalo Wild Wings
- McDonald's
- Jimmy John's
- Granite City
- Applebees
- Chilis
- Office Max
- Hooters
- Subway
- Taco Bell
- Starbucks
- Panera Bread
- Panda Express
- Chick-Fil-A