



Macro Aerial

Potranco Rd & Hwy 211 | San Antonio, TX 78245



Legal notice: The information herein was obtained from sources deemed reliable; however, Ashton Gray LLC makes no gaurentees, warranties, or representations as to the accuracy or completeness therof. The presentaion of this property is subject to errors, changes of price, prior sale or lease, or withdrawal without notice.

Summary

- Lease Rate: Call for Pricing
- Building Size: 11,980 SF
- Available For Lease: 1,433-3,414 SF
- Completion Date: Immediate Availability
- Co-Tenants: Swish Dental, Smoothie King, Nueva Vista Eyecare, Verizon

Property Overview

- Excellent AHHI exceeding \$115,000 near multiple residential communities
- Highly desirable retail frontage in Potranco Rd Corridor (28,000+ VPD)
- Located adjacent to brand new Chick-fil-A, HEB, and QuickTrip

Demographics

2025 Population

5,128	39,072	103,113
1 Mile	3 Mile	5 Mile

2029 Projected Growth ('25-'29)

4,387	30,691	76,981
1 Mile	3 Mile	5 Mile

Avg. Household Income

\$118,083	\$115,245	\$112,170
1 Mile	3 Mile	5 Mile

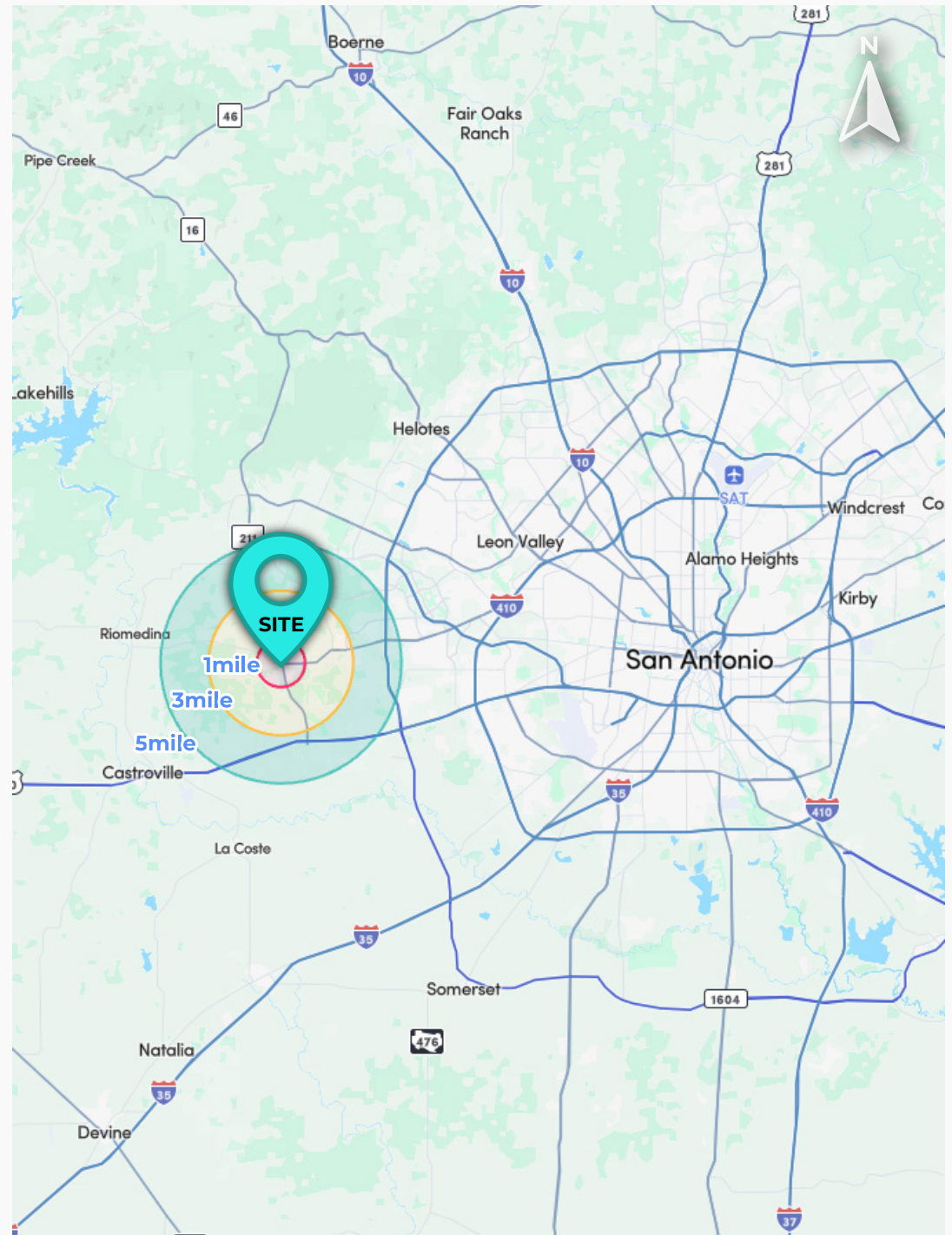

Site Plan

Potranco Rd & Hwy 211 | San Antonio, TX 78245

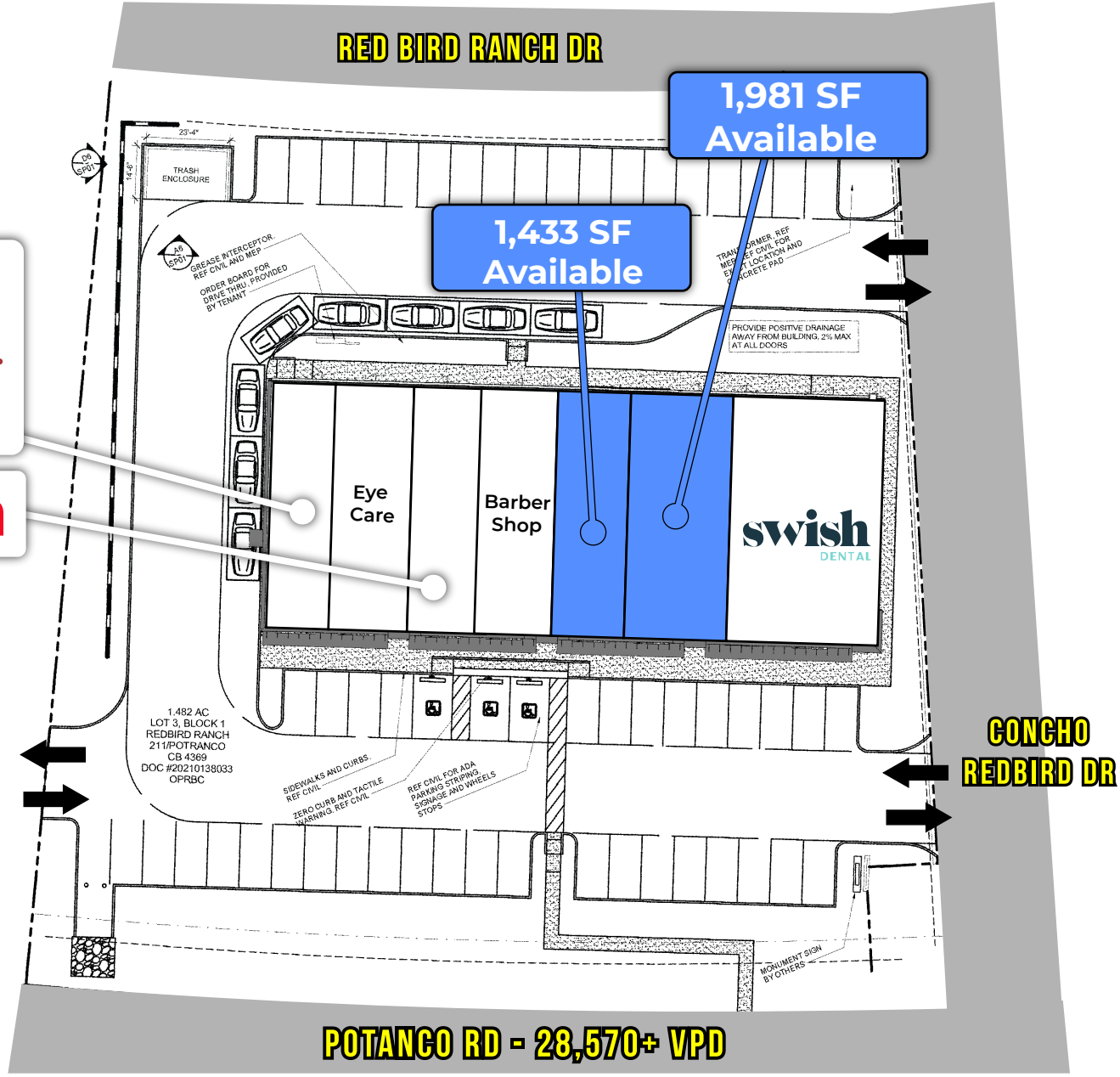

Floor Plan

Potranco Rd & Hwy 211 | San Antonio, TX 78245





Michael Feighny
Director, Retail Leasing - Texas

O: +1 (405) 300-4003
P: +1 (405) 361-9778
E: michaelfeighny@ashtongray.com



Jack Geurkink
Director, Healthcare Leasing

O: +1 (405) 300-4003
P: +1 (405) 249-0890
E: jackgeurkink@ashtongray.com

