

METROPOLIS ARCHITECTURE

1401 WESTWOOD BLVD., #320
 LOS ANGELES, CA 90024
 EMAIL: ATABAK80@GMAIL.COM
 TEL: (310) 503-7123

OWNER:

SOHEIL DARVISH

1401 WESTWOOD BLVD., #320
 LOS ANGELES, CA 90024

ARCHITECT:

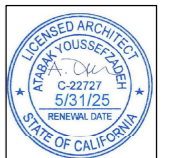

METROPOLIS ARCHITECTURE

PROJECT TITLE:

923 W CARSON AVE,
 TORRANCE, CA 90502

PROJECT INFO:

PROJECT #	
PERMIT APP #	
DRAWN BY	MKD
CHECKED BY	AY
DATE	07.14.2023

ISSUED / REVISIONS

No.	Date	Item

THESE DRAWINGS, SPECIFICATIONS, IDEAS AND DESIGNS ARE INSTRUMENTS OF SERVICE AND ARE THE PROPERTY OF THE ARCHITECT. ALL DESIGNS AND DRAWINGS ARE FOR THE USE ON THE SPECIFIED PROJECT AND SHALL NOT BE USED OTHERWISE WITHOUT THE EXPRESSED WRITTEN PERMISSION OF THE ARCHITECT. VISUAL CONTACT WITH THESE DRAWINGS OR SPECIFICATIONS SHALL CONSTITUTE CONCLUSIVE EVIDENCE OF ACCEPTANCE OF THESE RESTRICTIONS.

PLAN CHECK

SHEET TITLE

SITE PLAN

SHEET NUMBER

A1.00

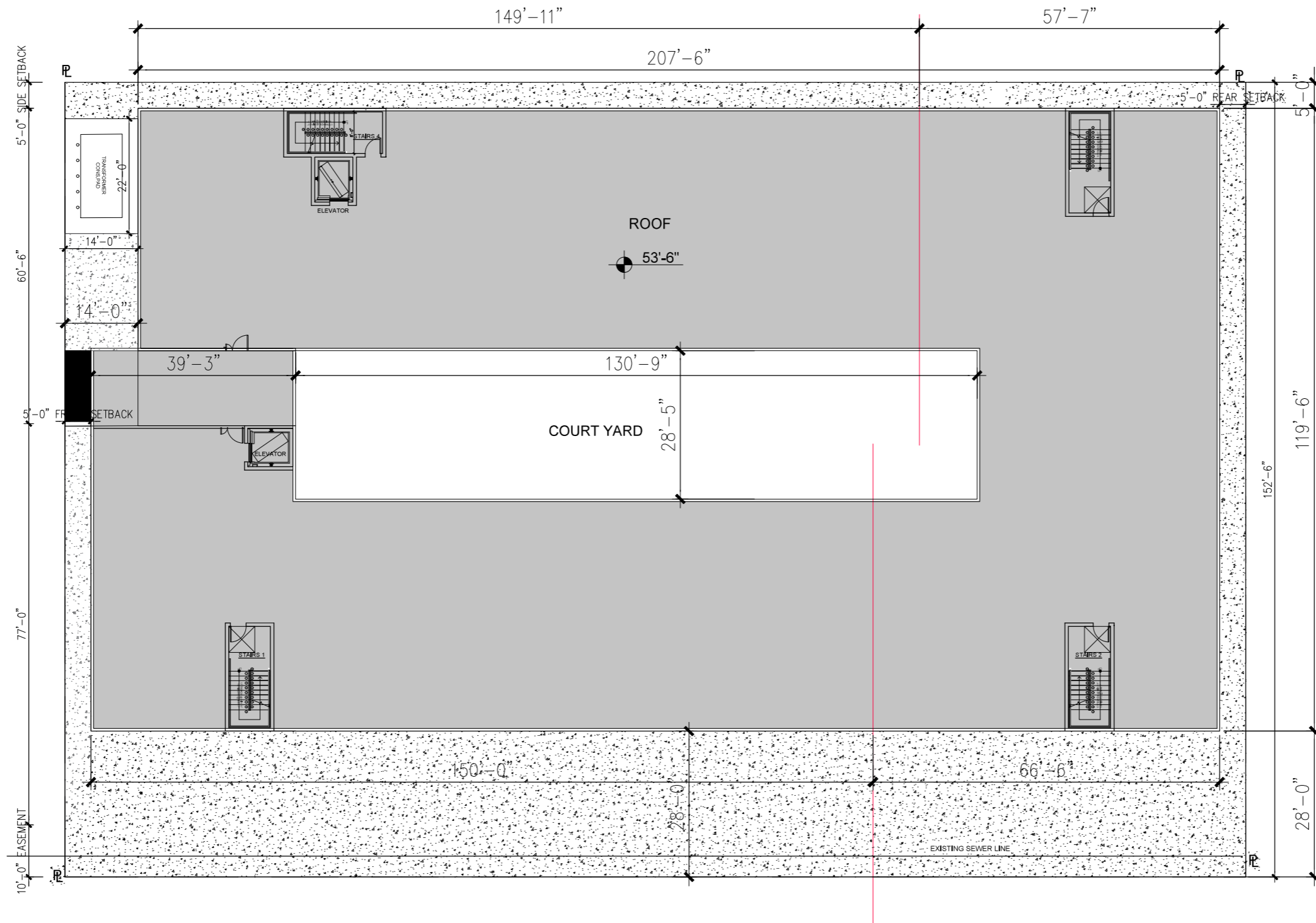

1 SITE PLAN
 SCALE: 3/32"=1'0"

LEGEND		NOTE	
W-2	CORRIDOR WALL	W-17	1 HR. EXTERIOR WALL
W-5	INTERIOR WALL	A	ONE BEDROOM
W-6	PLUMING WALL	B	STUDIO
W-9	1 HR. SEPRATION WALL		
W-15	1 HR. SHAFT (INTERIOR)		

- ALL FIRE PARTITION WALLS (LABC 708) SHALL BE 1 HOUR RATED STC50
- WALLS (FIRE BARRIERS 707.3.1) IN SHAFTS AS ELEVATOR STAIRS, ETC.
- ALL BEARING WALLS SHALL BE 1 HOUR RATED WALLS (FIRE BARRIERS 707.3.1) IN SHAFTS AS ELEVATOR STAIRS, ETC.
- FIRE PARTITION CORRIDORS SHALL BE 1 HOUR RATED
- THE FLOOR/CEILING ASSEMBLIES SHALL BE 1 HOUR RATED STC50.
- NON-COMBUSTIBLE DRAFT STOP SHALL BE PROVIDED.

PLOTTED PAPER SIZE (DRAWING HAS BEEN SCALED IF DIFFERENT): ARCH FULL BLEED D (36.00 X 24.00 INCHES) PLOT SCALE: 1:1 PLOT STYLE: ARCH-BLACK-2020.CTB
 COPYRIGHT © 2023 METROPOLIS ARCHITECTURE, INC.