

FOR SALE OR LEASE

8140 N COMMERCIAL AVE

*23,980 SF Warehouse on 3.03 AC
with Immediate Access to I-5.*

PORTLAND, OR

N COLUMBIA BLVD

N VANCOUVER AVE

N COMMERCIAL AVE

KIDDER.COM

km Kidder
Mathews

8140 N COMMERCIAL AVE



*23,980 SF warehouse on 3.03 AC
with immediate access to I-5.*

ADDRESS	8140 N Commercial Ave, Portland, OR
BUILDING SIZE	23,980 SF
LAND AREA	131,987 SF
SITE COVERAGE	18.2%
YEAR BUILT	1941
ZONING	Heavy Industrial (IH)
CEILING HEIGHT	13' - 17.5'
POWER	3-phase
LOADING	6 grade doors
VISIBILITY	Great signage along Columbia Blvd
LOCATION	Easy access to I-5 and PDX

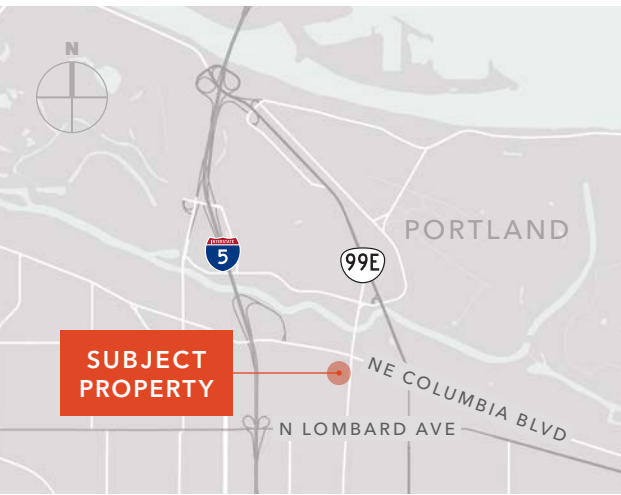

\$3.35M

SALE PRICE

CALL

FOR NNN LEASE RATE

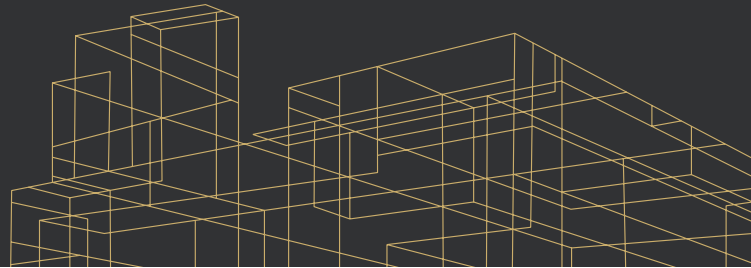

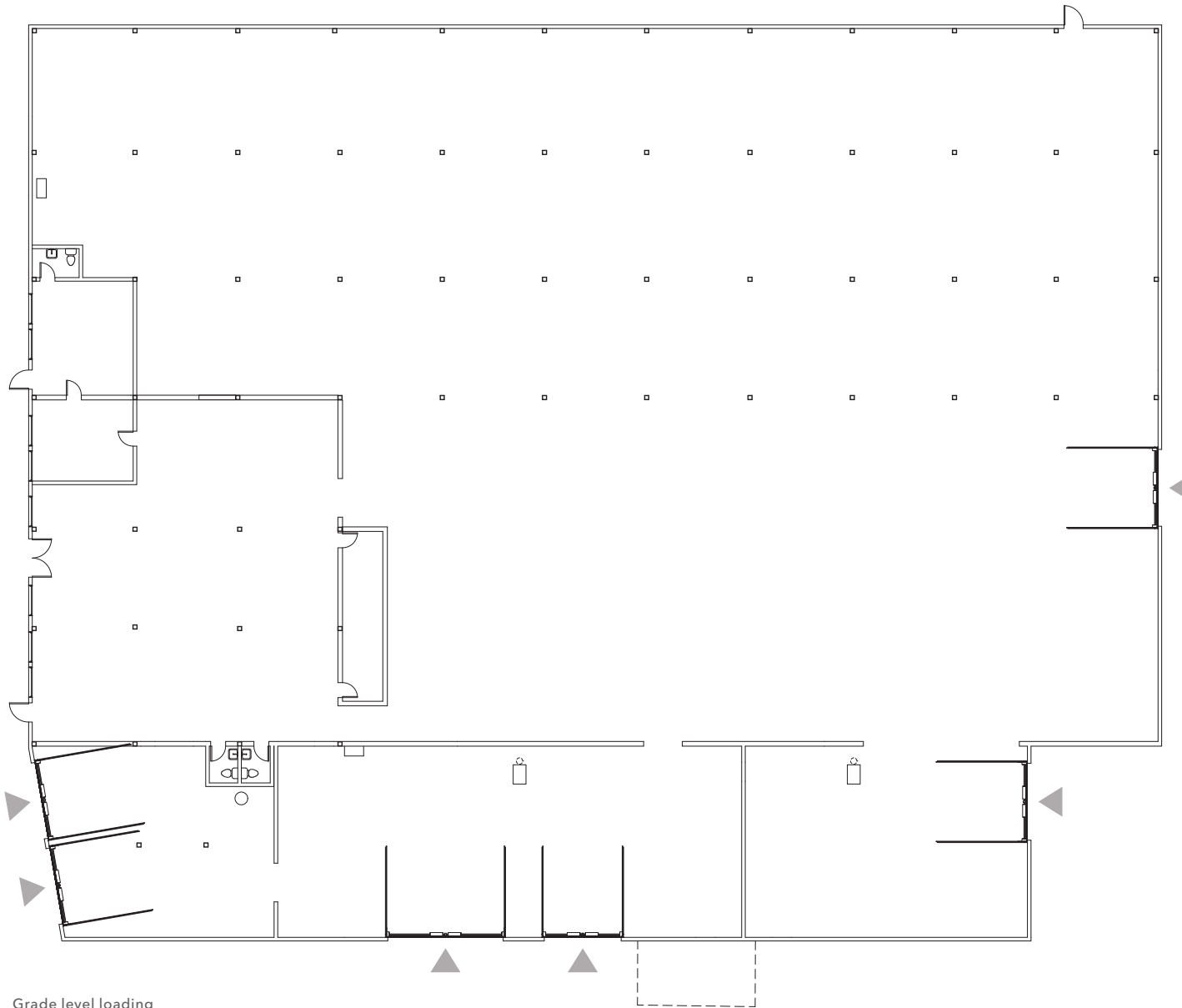

▲ Grade level loading

23,980 SF

AVAILABLE

13' - 17.5'

CLEAR HEIGHT

6

GRADE LEVEL DOORS

\$3.35M

SALE PRICE

CALL

FOR NNN LEASE RATE

8140 N COMMERCIAL AVE

Columbia River

PORTLAND INTERNATIONAL RACEWAY

DELTA PARK

LABOY	Guitar Center	DICK'S SPORTING GOODS
LOWE'S	Fleherman's Marine & Outdoor	COUNTRY INN & SUITES

HAYDEN MEADOWS SQUARE

COLUMBIA EDGEWATER COUNTRY CLUB

BLASEN & BLASEN LUMBER CORPORATION

PORTLAND

PDX INTERNATIONAL AIRPORT

amazon

CHRISTENSEN

FedEx

RIVERSIDE GOLF & COUNTRY CLUB

FERGUSON

SUBJECT PROPERTY

Ryder

McDonald's

PAPE

Fred Meyer

Mondelez

TEC Equipment

Javier's TACOS

NE COLUMBIA BLVD

WOODLAWN CITY PARK

NEW SEASONS MARKET

5

99E

PENINSULA PARK

Walgreens

CAMPANA

THE RESTAURANT

FERNHILL PARK

SAFeway

ALBERTA PARK

AVAILABLE FOR SALE OR LEASE

KIDDER MATHEWS





8140 N COMMERCIAL AVE

*For more information on
this property, please contact*

STEVE BOWERS
503.721.2715
steve.bowers@kidd.com

KIDDER.COM

This information supplied herein is from sources we deem reliable. It is provided without any representation, warranty, or guarantee, expressed or implied as to its accuracy. Prospective Buyer or Tenant should conduct an independent investigation and verification of all matters deemed to be material, including, but not limited to, statements of income and expenses. Consult your attorney, accountant, or other professional advisor.

