

Retail for Lease

1517-1523 S Harvard Ave

Tulsa, OK 74112



Retail for Lease

1517-1523 S Harvard Ave, Tulsa

Center Size: 12,678± SF

Available SF: Ste 1517: 940 - 4,005± SF
Ste 1523: 3,200± SF

Rate: Negotiable

Signage: Pylon

Traffic Counts: 17,182 vpd S. Harvard Ave
16,280 vpd E. 15th St
21,411 vpd S 33rd E Ave

- Highlights:**
- Remodeled exterior 2024
 - White-box ready interior
 - Abundant parking
 - Generous improvement allowance
 - Great location at 15th & Harvard
 - Easy access to Hwy 51
 - Building signage & pylon signage

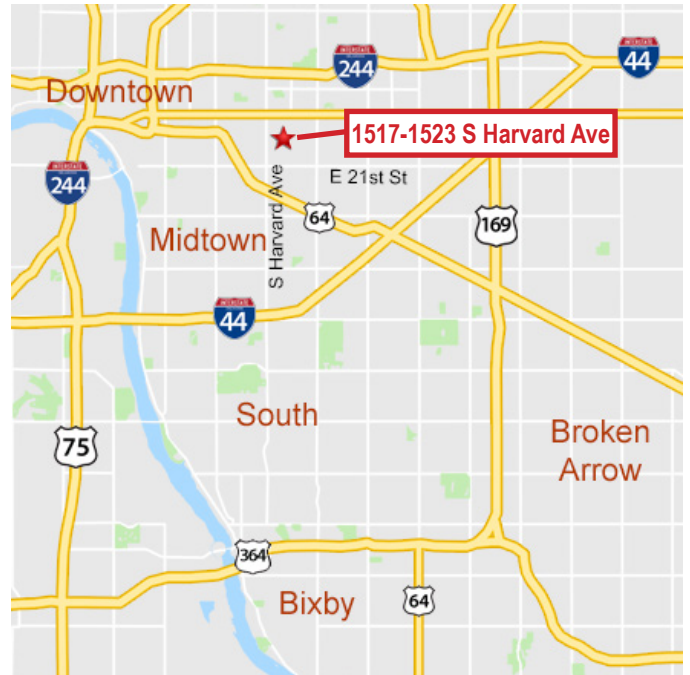

Demographics

2024	1 mile	3 miles	5 miles
Population	11,737	101,455	223,463
Average HH Income	\$83,703	\$80,712	\$70,312
Households	5,387	44,021	95,731

Vicki Patterson, CCIM 918.519.6731 || Erica Cunningham 918.829.5754

vpatterson@wiginprop.com | ecunningham@wiginprop.com | wiginprop.com

This material is provided for information purposes only. It is from sources believed to be reliable. However, Wiggin Properties makes no warranties or representations, expressed or implied, as to the accuracy or sufficiency of the information. It is presented subject to errors, omissions, changes or withdrawal without notice. Square footage per owner. Photos and graphics ©Costar, ©Wiggin Properties and/or ©independent contractors. Aerial maps © Google. Photos and graphics used by permission.

Retail for Lease

1517-1523 S Harvard Ave

Tulsa, OK 74112

WIGGIN
PROPERTIES, LLC



Vicki Patterson, CCIM 918.519.6731 || Erica Cunningham 918.829.5754

vpatterson@wigginprop.com | ecunningham@wigginprop.com | wigginprop.com

This material is provided for information purposes only. It is from sources believed to be reliable. However, Wiggin Properties makes no warranties or representations, expressed or implied, as to the accuracy or sufficiency of the information. It is presented subject to errors, omissions, changes or withdrawal without notice. Square footage per owner. Photos and graphics ©Costar, ©Wiggin Properties and/or ©Independent contractors. Aerial maps © Google. Photos and graphics used by permission.

1517-1523 S Harvard Floorplans

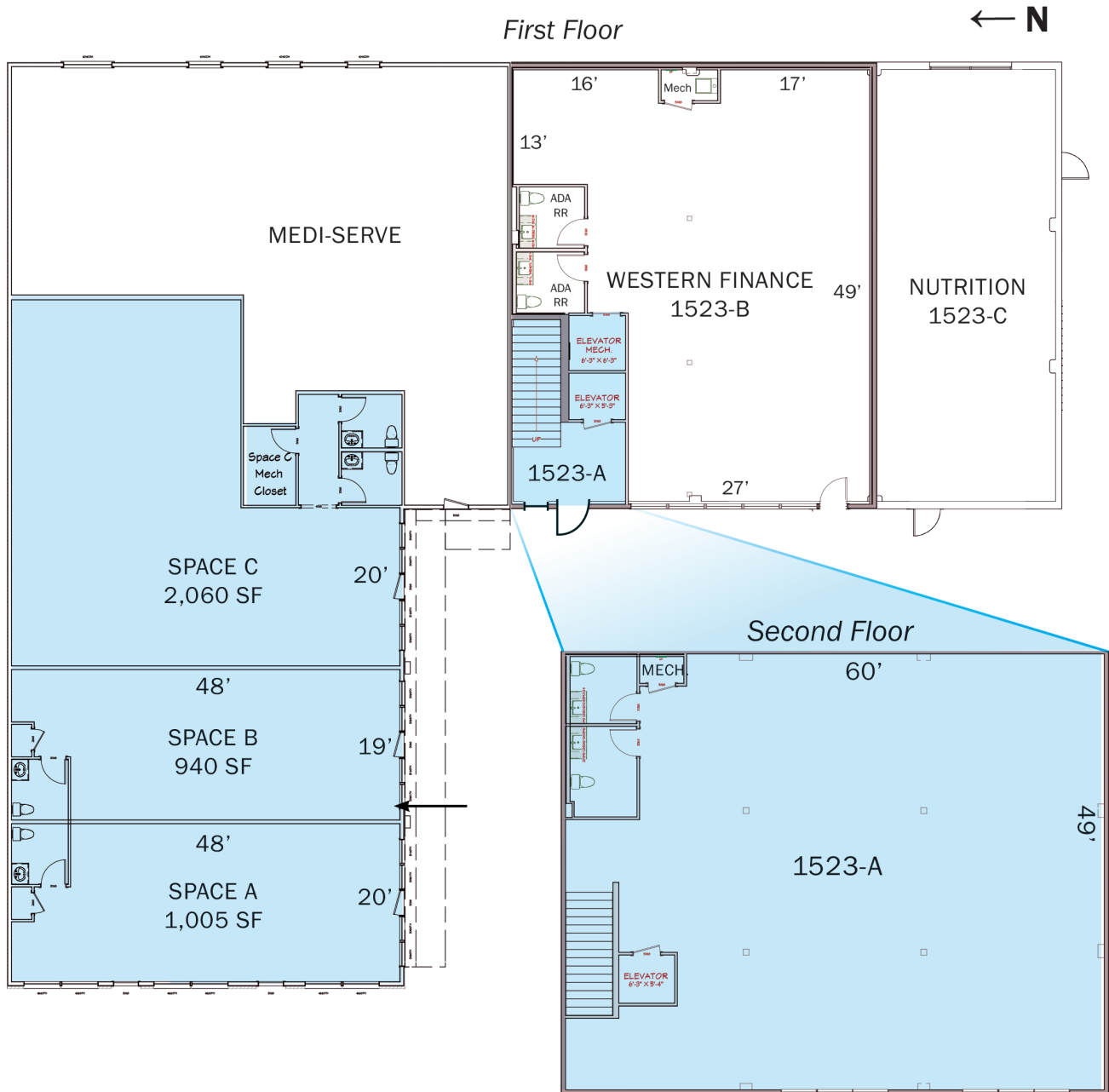

1517: ±940 - 4,005 sf

- New full height storefront entries
- New ADA restrooms
- High ceilings
- Frontage on Harvard Ave

1523-A: ±3,200 sf (2nd floor)

- Separate ground floor entry
- Elevator access
- Ready for buildout
- Exposed 9' ceilings

Vicki Patterson, CCIM 918.519.6731 || Erica Cunningham 918.829.5754

vpatterson@wiginprop.com | ecunningham@wiginprop.com | wiginprop.com