

5620 W. MAPLE ROAD
WEST BLOOMFIELD, MICHIGAN

MEDICAL FOR SALE
1,998 Square Feet Available



**SIGNATURE
ASSOCIATES**
KNOW SIGNATURE | KNOW RESULTS



PROPERTY FEATURES

- 1,998 square feet available
- Move-in-ready medical office building
- Situated in a highly desirable area with convenient parking and well-maintained building
- 14 parking spaces
- Great opportunity for healthcare providers, retail, and investors
- Sale Price: \$775,000 (\$387.89/sq. ft.)



For more information, please contact:

ANATOLA SESI
(248) 359 0629
asesi@signatureassociates.com

MARVIN PETROUS
(248) 359 0647
mpetrous@signatureassociates.com

SIGNATURE ASSOCIATES
One Towne Square, Suite 1200
Southfield, MI 48076
www.signatureassociates.com

5620 W. Maple Road – West Bloomfield, Michigan

Medical For Sale

1,998
Square Feet
AVAILABLE

Site Plan

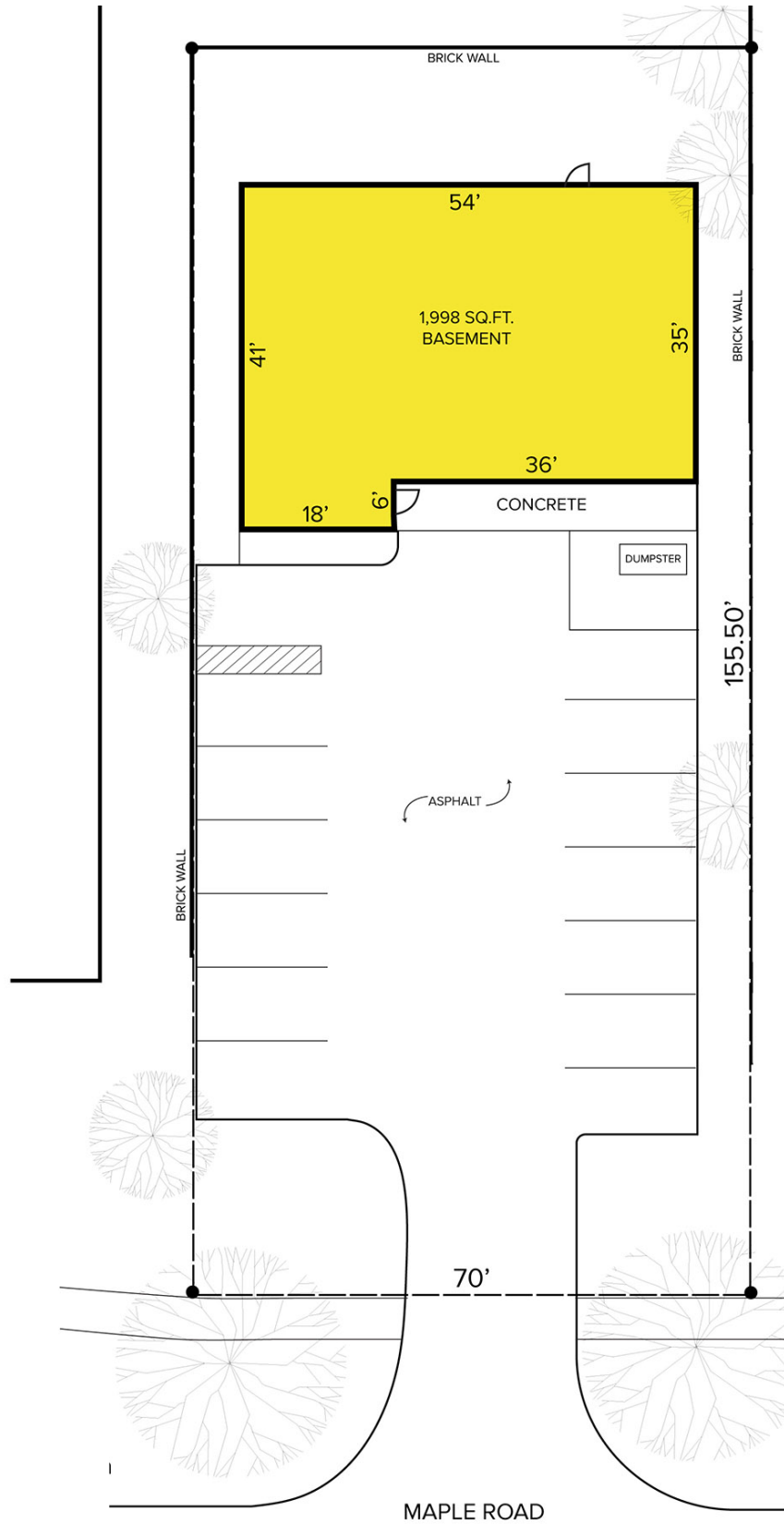

For more information, please contact:

ANATOLA SESI
(248) 359 0629
asesi@signatureassociates.com

MARVIN PETROUS
(248) 359 0647
mpetrous@signatureassociates.com

SIGNATURE ASSOCIATES
One Towne Square, Suite 1200
Southfield, MI 48076
www.signatureassociates.com

5620 W. Maple Road – West Bloomfield, Michigan

Medical For Sale

1,998
Square Feet
AVAILABLE

Aerial



For more information, please contact:

ANATOLA SESI
(248) 359 0629
asesi@signatureassociates.com

MARVIN PETROUS
(248) 359 0647
mpetrous@signatureassociates.com

SIGNATURE ASSOCIATES
One Towne Square, Suite 1200
Southfield, MI 48076
www.signatureassociates.com