



PREMIER
COMMERCIAL
PROPERTIES

FOR LEASE



Retail Space for Lease

1207 – 1275 Geneva Ave N
Oakdale, MN 55128

AVAILABLE SPACE

- 16,340 SF Neighborhood Retail Center
- Complete exterior remodel
- Multiple suites and sizes available
900 SF up to 10,650 SF available
- Single level building with great glass lines
- Monument and building signage
- Abundant parking with new parking lot
scheduled for Spring of 2025
- Building and Monument signage available
- Local and responsive ownership



Lease Rates: \$14 – \$16 PSF NNN
CAM & Tax: \$8.60 PSF (Estimate)

FOR MORE INFORMATION, CONTACT

Richard Lee

612-718-9919

richlee@premiercommercialproperties.com



PREMIER
COMMERCIAL
PROPERTIES

FOR LEASE

CONTACT: Richard Lee

MOBILE: 612-718-9919

EMAIL: richlee@premiercommercialproperties.com

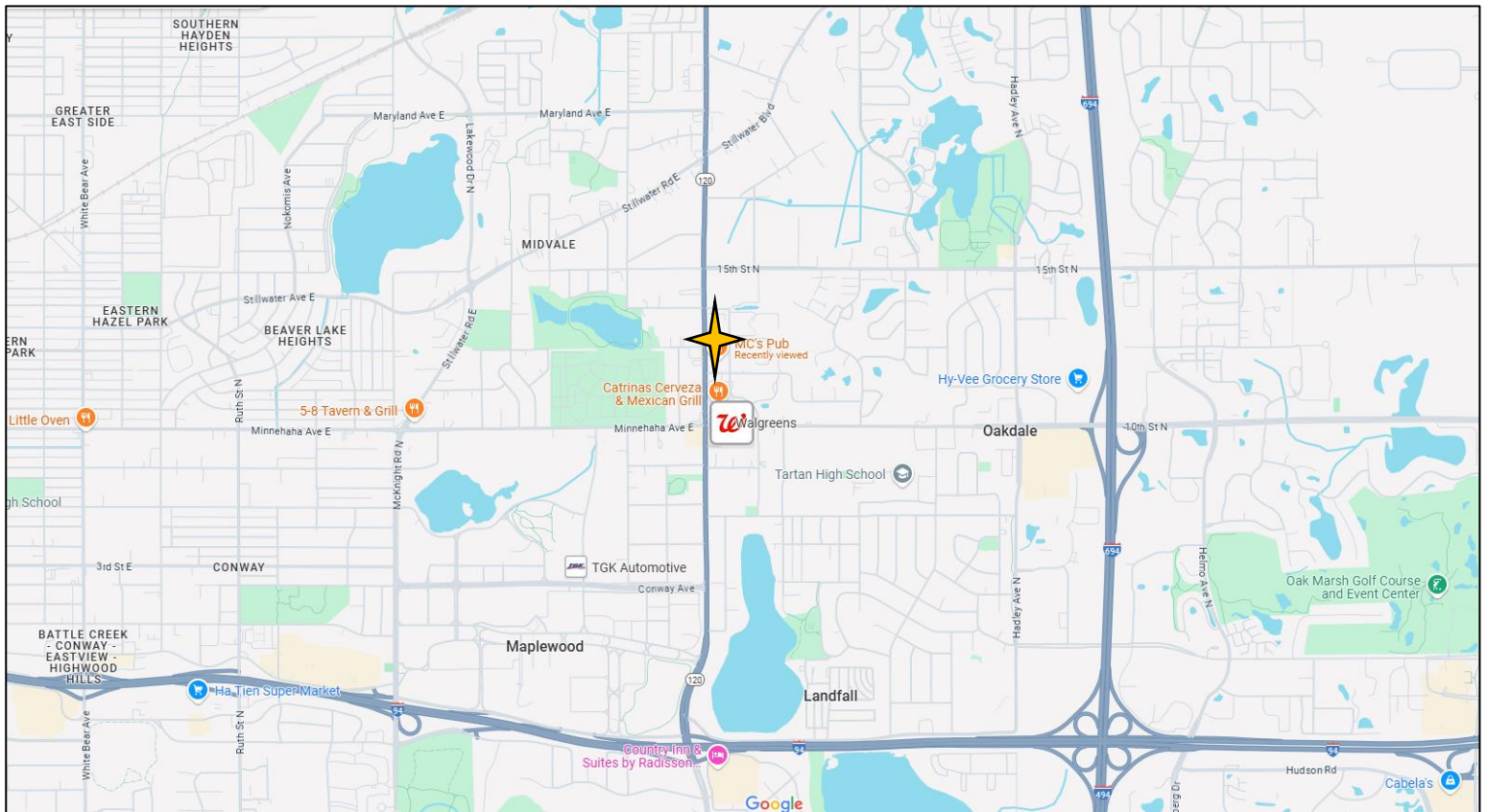
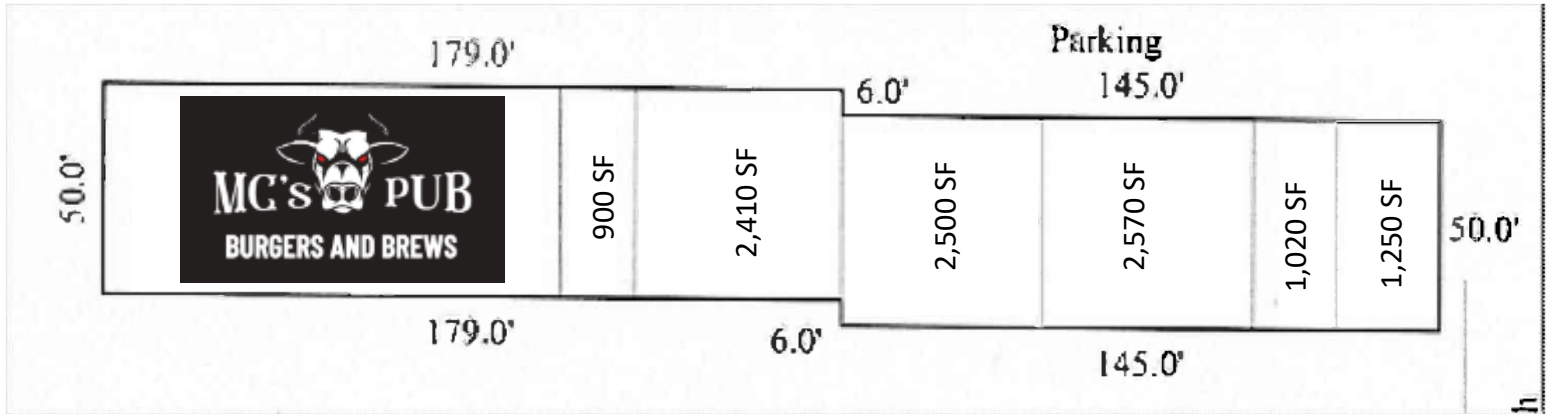



PREMIER
COMMERCIAL
PROPERTIES

FOR LEASE

CONTACT: Richard Lee

MOBILE: 612-718-9919

EMAIL: richlee@premiercommercialproperties.com

Trade Area Demographics		
1 Mile	3 Mile	5 Miles
\$93,138	\$87,531	\$96,594
Est. Avg. Income	Est. Avg. Income	Est. Avg. Income
9,699	100,480	221,106
Est. Population	Est. Population	Est. Population
4,041	35,556	76,692
Est. Households	Est. Households	Est. Households

