

16402

N 28TH AVE

PHOENIX, AZ

PROPOSED INDUSTRIAL PLAN

TW
GL
GL

LOADING AREA
UNDER CONSTRUCTION

POTENTIAL
FENCED YARD

FOR SALE OR LEASE

CBRE



PROPERTY FEATURES

 ±51,680 SF freestanding industrial building, divisible to ±20,000 & ±30,000 SF



±4.36 AC site with potential for large fenced yard or 6.58/1000 parking ratio



Industrial Park Zoning (City of Phoenix) allows outside storage



17' – 19' clear height (entire property currently has 10' drop ceiling environment)



±1,600 AMPS 277/480 V Power



100% air conditioned building



Two grade level doors and one truckwell door proposed (expandable)



Three points of ingress/egress



Professional business park environment



Located less than 10 miles from TSMC



Located ½ mile from full diamond interchange at Bell Rd & I-17

CONCEPTUAL PLANS

Planned truckwell and grade level loading renderings



FREEWAY ACCESS

±1/2 mile from full diamond interchange at I-17 & Bell Road



CORPORATE NEIGHBORS

ADTALEM
GLOBAL EDUCATION

ARIZONA COLLEGE[™]
of Nursing

CLIMATEC
A Bosch Company

Consumer
Cellular[™]

COX[®]

PAYCHEX[™]

TRIWEST
HEALTHCARE ALLIANCE[™]

WM
WASTE MANAGEMENT



FLOOR PLAN

±51,680 SF



PROPOSED LOADING AREA

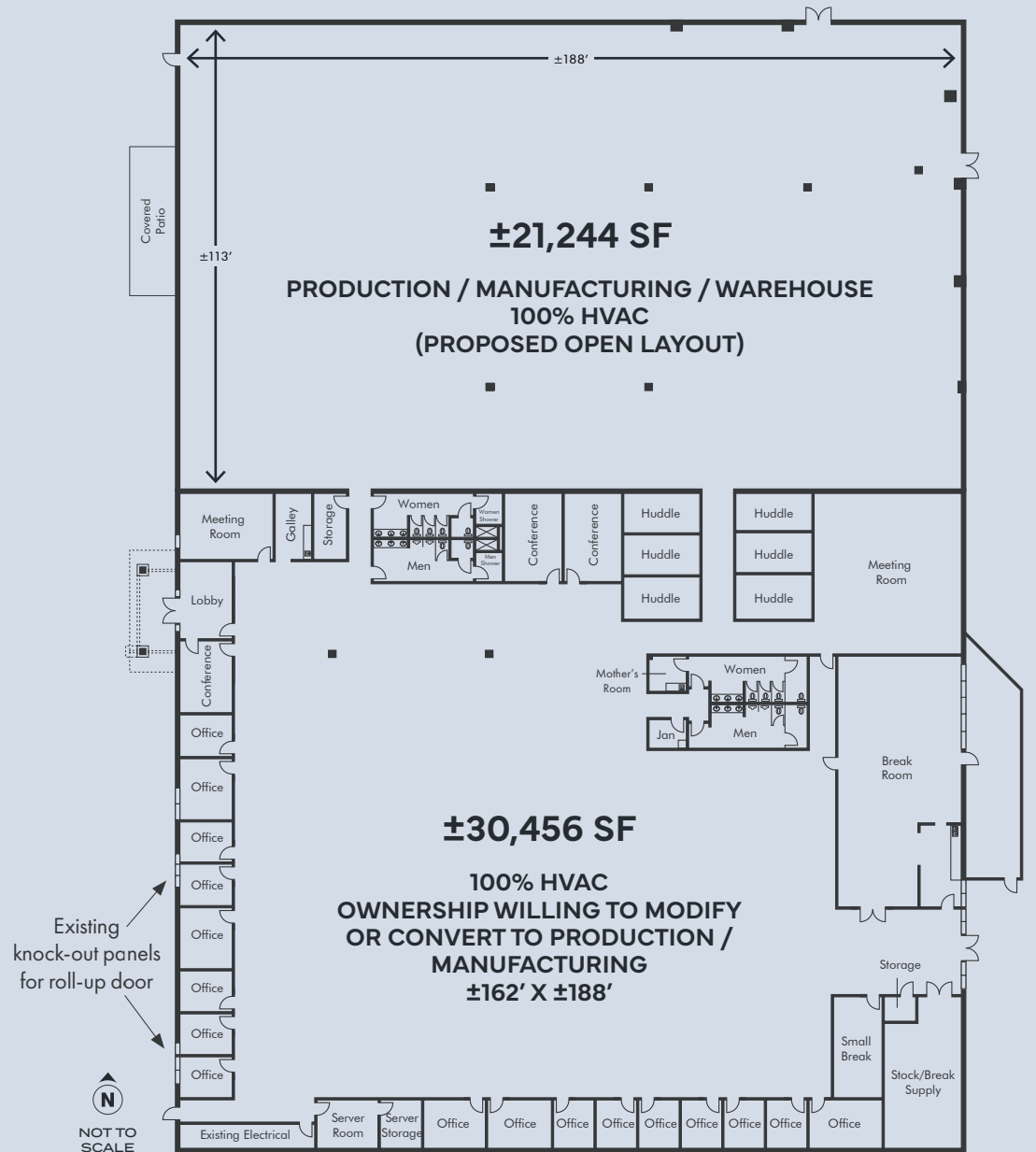

16402

N 28TH AVE

PHOENIX, AZ

FOR SALE OR LEASE



CONTACT US:

ANDREW BRIGHAM

First Vice President

+1 602 735 5678

andrew.brigham@cbre.com

BILL BAYLESS

Senior Vice President

+1 602 735 5652

bill.bayless@cbre.com

CBRE

© 2024 CBRE, Inc. All rights reserved. This information has been obtained from sources believed reliable, but has not been verified for accuracy or completeness. You should conduct a careful, independent investigation of the property and verify all information. Any reliance on this information is solely at your own risk. CBRE and the CBRE logo are service marks of CBRE, Inc. All other marks displayed on this document are the property of their respective owners, and the use of such logos does not imply any affiliation with or endorsement of CBRE. Photos herein are the property of their respective owners. Use of these images without the express written consent of the owner is prohibited.