



**FLEX
SUBLEASE**

MARYMOOR COMMERCE CENTER, Bldg B

17824 NE 65th St | Redmond, WA 98052

Caleb Farnworth, CCIM

425.289.2235

calebf@rosenharbottle.com

Stossi Tsantilas

425.279.7943

stossit@rosenharbottle.com

425.454.3030
rosenharbottle.com

PO Box 5003
Bellevue, WA 98009 - 5003



WAREHOUSE SPACE WITH OFFICE

8,316 SF Available

Approx. 2,500 SF Office

\$13,000/Month, NNN

PROPERTY DETAILS:

- 2025 NNNs: \$4,215/month
- Quick Access to SR 520, Union Hill & Downtown Redmond
- Nearby Amenities Include Home Depot, Whole Foods, Chipotle, Target, Kohl's, Costco & More
- Located Minutes From Future Light Rail Stations
- Abundant Parking



BUILDING B FLOOR PLAN

SUITE 17824 FEATURES:

- Available Now
- 8,316 SF (Approx. 2,500 SF Ofc)
- \$13,000/Month, NNN
- Expiration Date: 7/31/29
- Kitchenette
- Two Oversized GL Doors
- Two Dock High Doors
- 16' Clear Height
- Efficient Office Layout

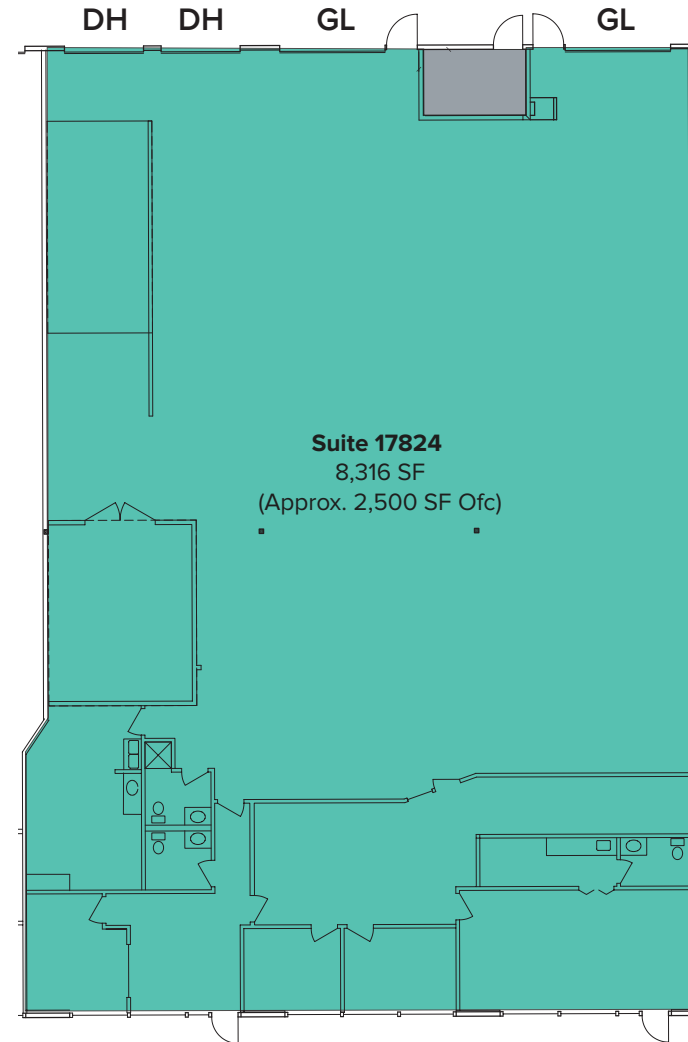

LOCATION MAP

