



AVAILABLE

# Plug & Play Space-Ready for Move-In Downtown Syracuse

441 SOUTH SALINA STREET



## PROPERTY FEATURES

- CLASS A OFFICE SPACE
- 7-STORY BUILDING IN DOWNTOWN SYRACUSE
- TOTAL SUB-LEASE AVAILABLE: 32,743 SF
  - ◊ 1ST FLOOR: 7,295 SF
  - ◊ 2ND FLOOR: 21,740 SF AND 3,708 SF
  - ◊ 3RD FLOOR:
- AVAILABLE IMMEDIATELY
- AMPLE PARKING AVAILABLE
- FURNITURE AVAILABLE

## 3D VIRTUAL TOUR LINKS



[Click Here to  
Take a Virtual Tour  
of the 1st Floor](#)



[Click Here to  
Take a Virtual Tour  
of the 2nd Floor](#)



FOR MORE  
INFORMATION  
CONTACT

**Greg Cleghorn**

315.579.0048

[gcleghorn@bellcornerstone.com](mailto:gcleghorn@bellcornerstone.com)

# Plug & Play Space-Ready for Move-In Downtown Syracuse

441 SOUTH SALINA STREET SYRACUSE, NY 13202

## 1st Floor - 7,295 SF Available

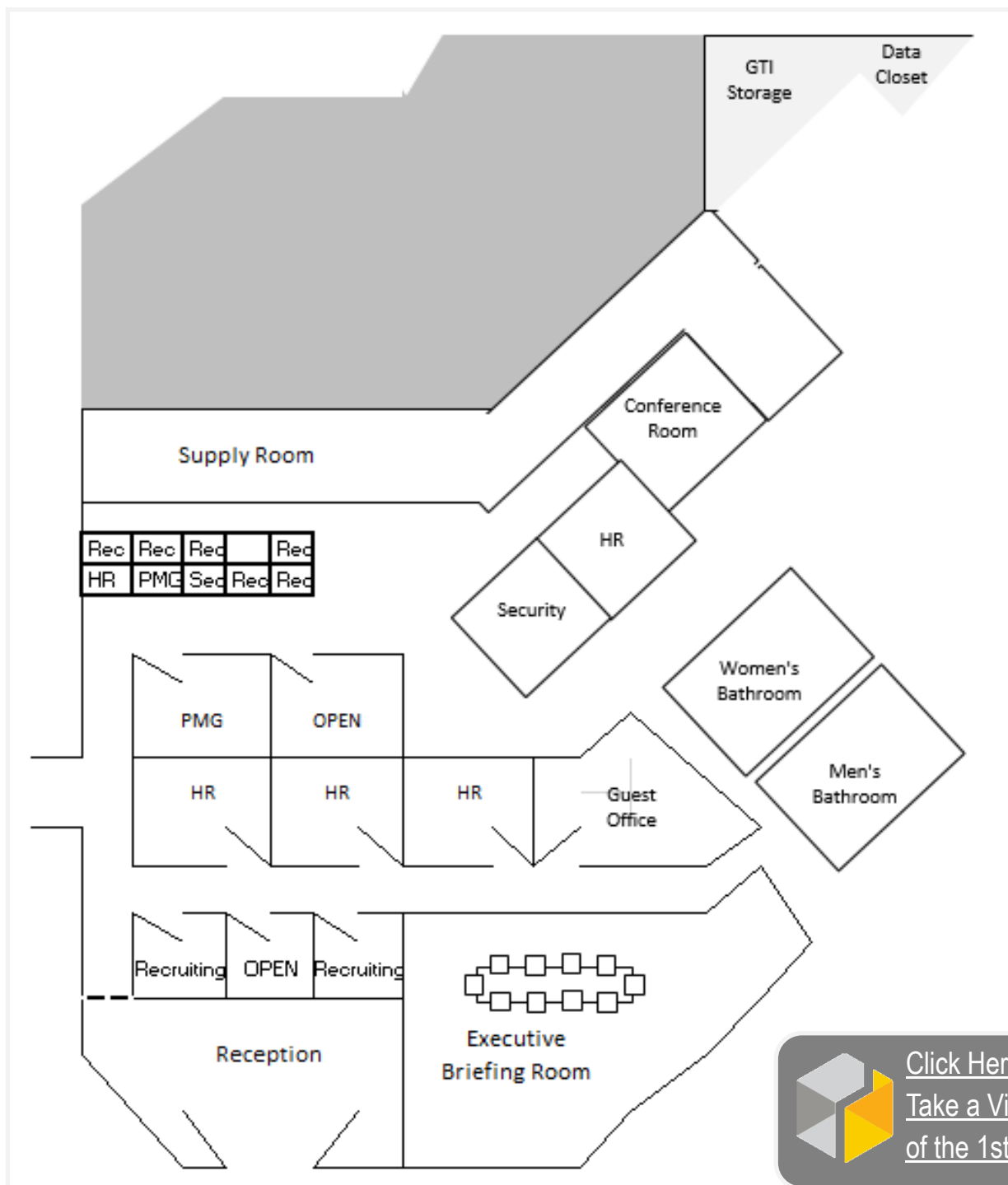

FOR MORE  
INFORMATION  
CONTACT

**Greg Cleghorn**

315.579.0048

[gcleghorn@bellcornerstone.com](mailto:gcleghorn@bellcornerstone.com)

# Plug & Play Space-Ready for Move-In Downtown Syracuse

441 SOUTH SALINA STREET SYRACUSE, NY 13202

## 2nd Floor - 3,708 SF Available

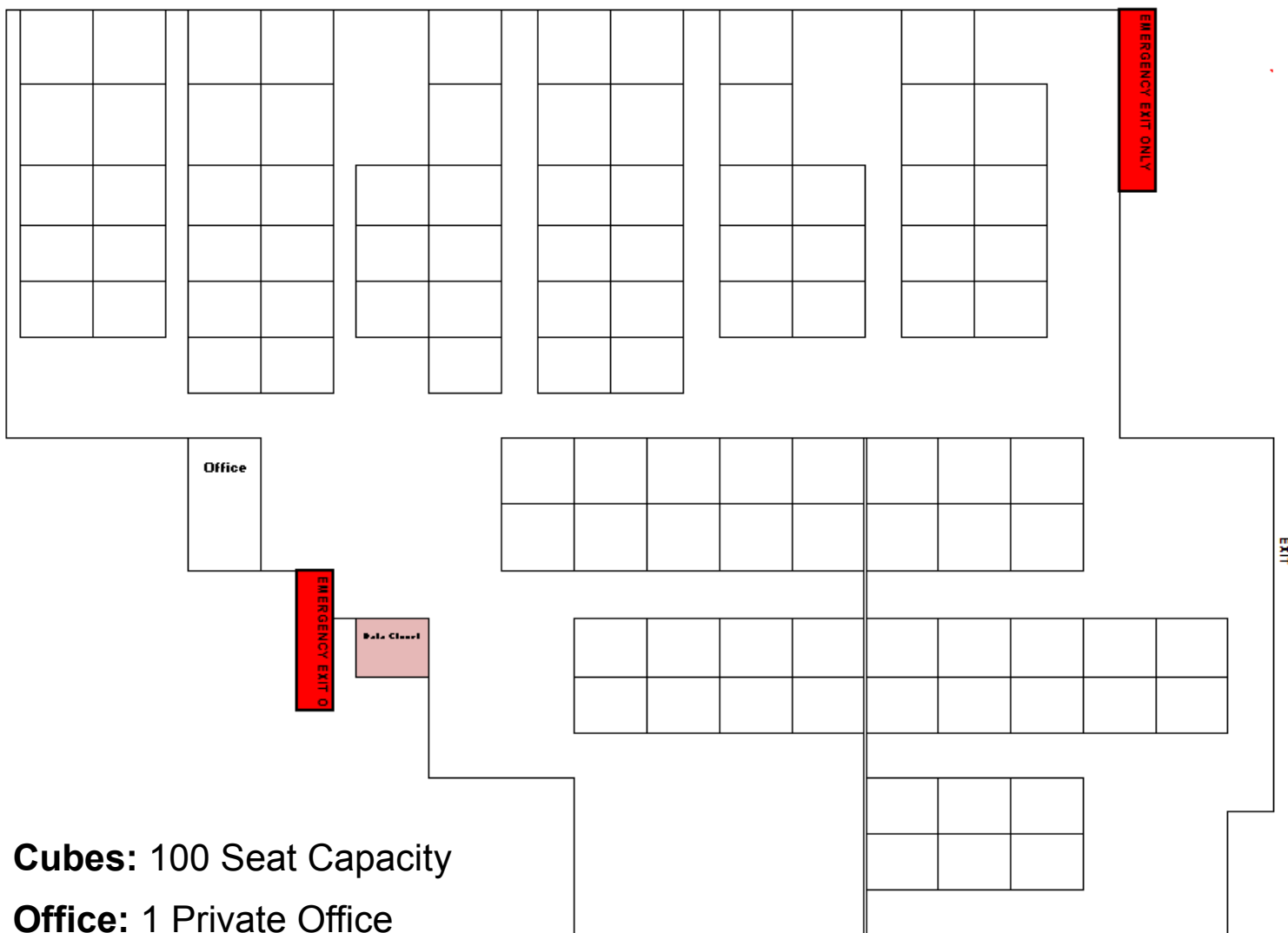

**Cubes:** 100 Seat Capacity

**Office:** 1 Private Office

 [Click Here to Take a Virtual Tour of the 2nd Floor](#)



FOR MORE  
INFORMATION  
CONTACT

**Greg Cleghorn**  
315.579.0048  
gcleghorn@bellcornerstone.com

## 2nd Floor - 21,740 SF Available

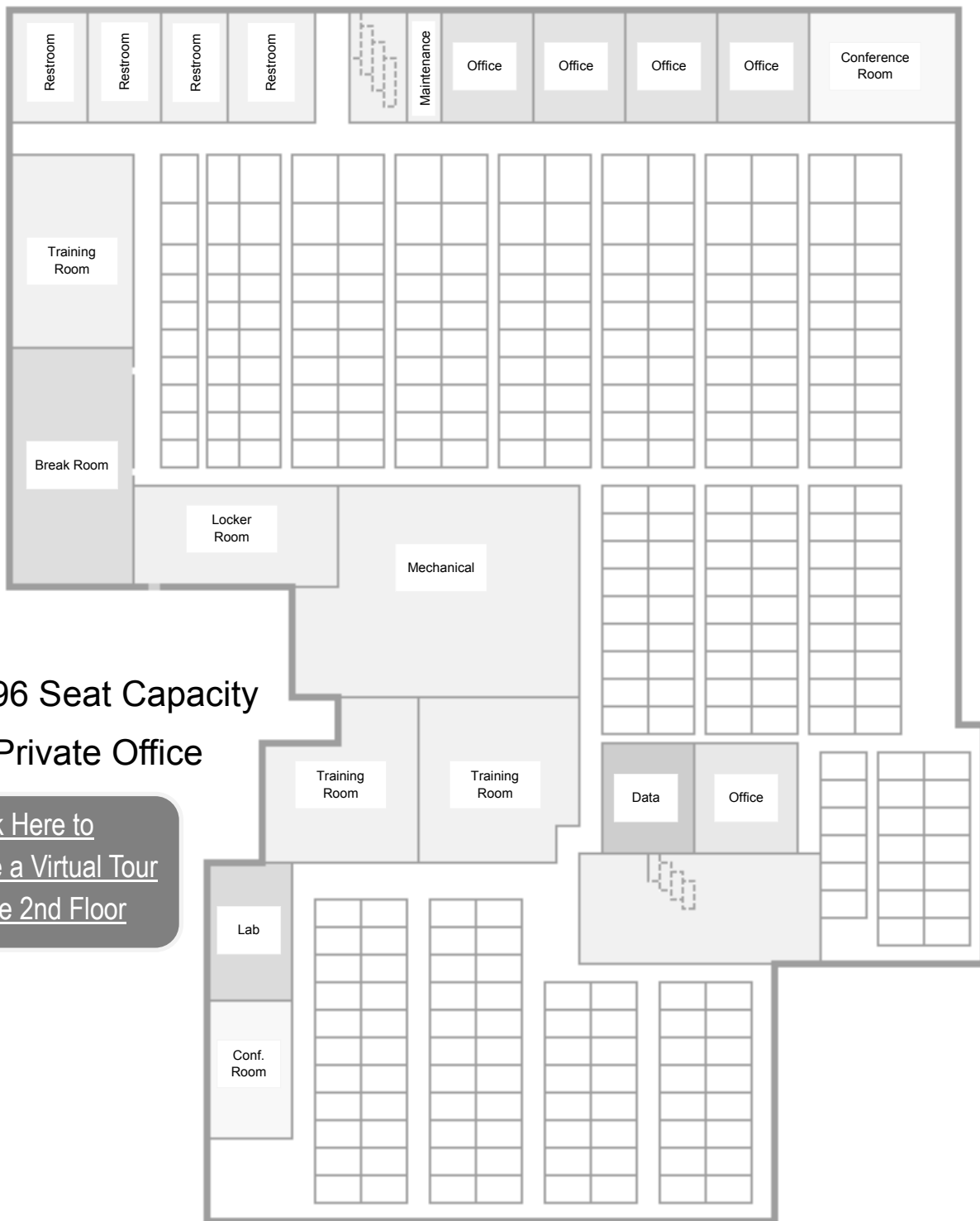

**Cubes:** 296 Seat Capacity

**Office:** 5 Private Office



[Click Here to  
Take a Virtual Tour  
of the 2nd Floor](#)



FOR MORE  
INFORMATION  
CONTACT

**Greg Cleghorn**  
315.579.0048  
[gcleghorn@bellcornerstone.com](mailto:gcleghorn@bellcornerstone.com)

# Plug & Play Space-Ready for Move-In Downtown Syracuse

441 SOUTH SALINA STREET SYRACUSE, NY 13202

## 3rd Floor - SF Available

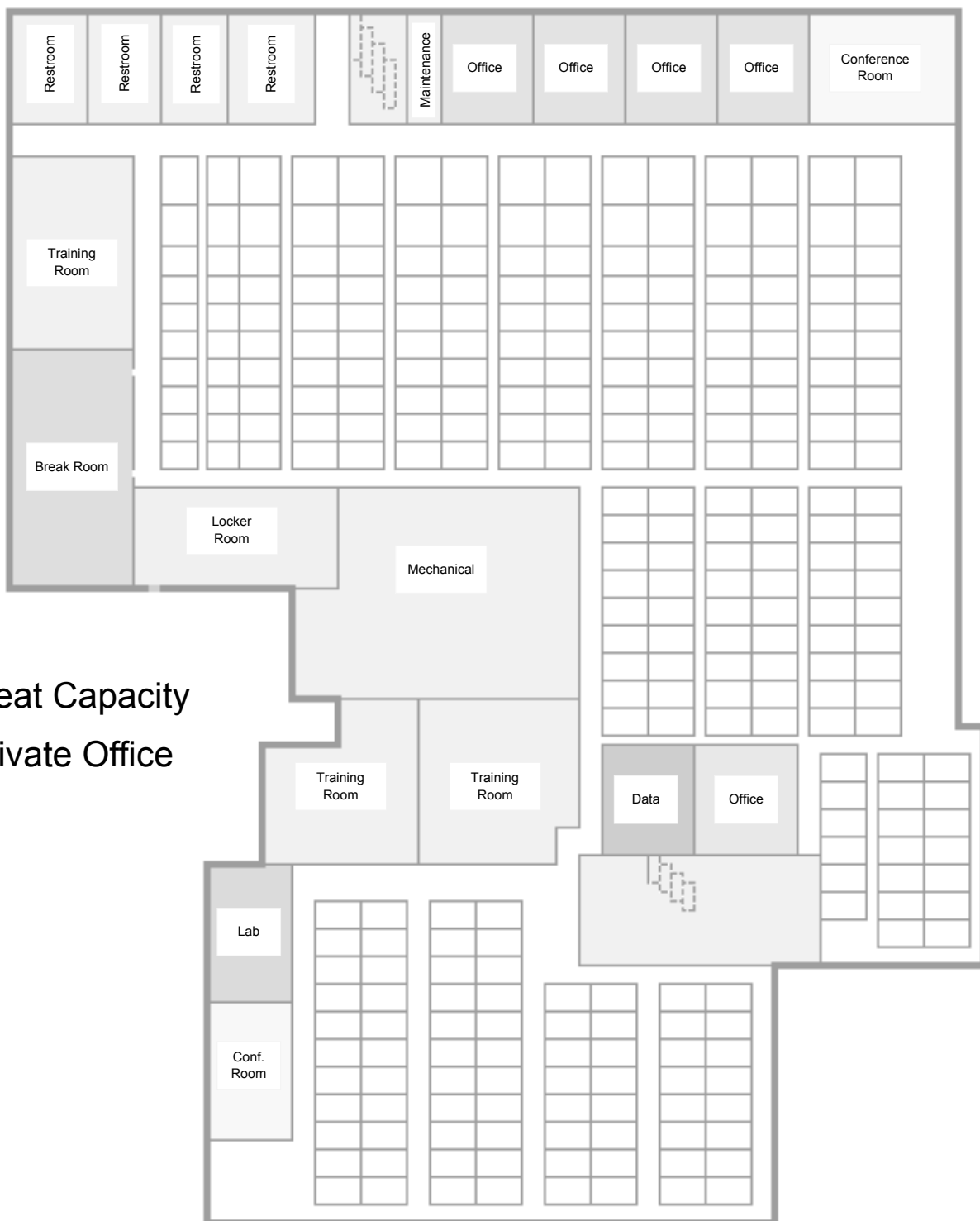

**Cubes:** Seat Capacity

**Office:** Private Office



FOR MORE  
INFORMATION  
CONTACT

**Greg Cleghorn**

315.579.0048

[gcleghorn@bellcornerstone.com](mailto:gcleghorn@bellcornerstone.com)



# Plug & Play Space-Ready for Move-In Downtown Syracuse

441 SOUTH SALINA STREET SYRACUSE, NY 13202



**Lobby  
First Floor Space**



**Conference Room  
First Floor Space**



**Call Center  
Second Floor Space**



**FOR MORE  
INFORMATION  
CONTACT**

**Greg Cleghorn**  
315.579.0048  
[gcleghorn@bellcornerstone.com](mailto:gcleghorn@bellcornerstone.com)

# Plug & Play Space-Ready for Move-In Downtown Syracuse

441 SOUTH SALINA STREET SYRACUSE, NY 13202

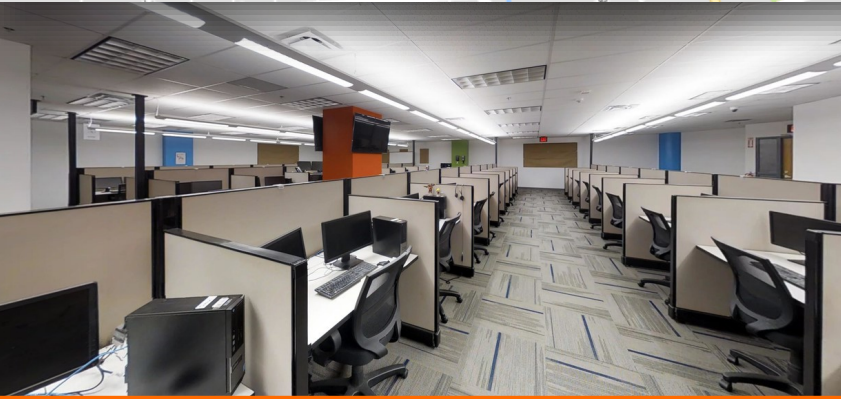
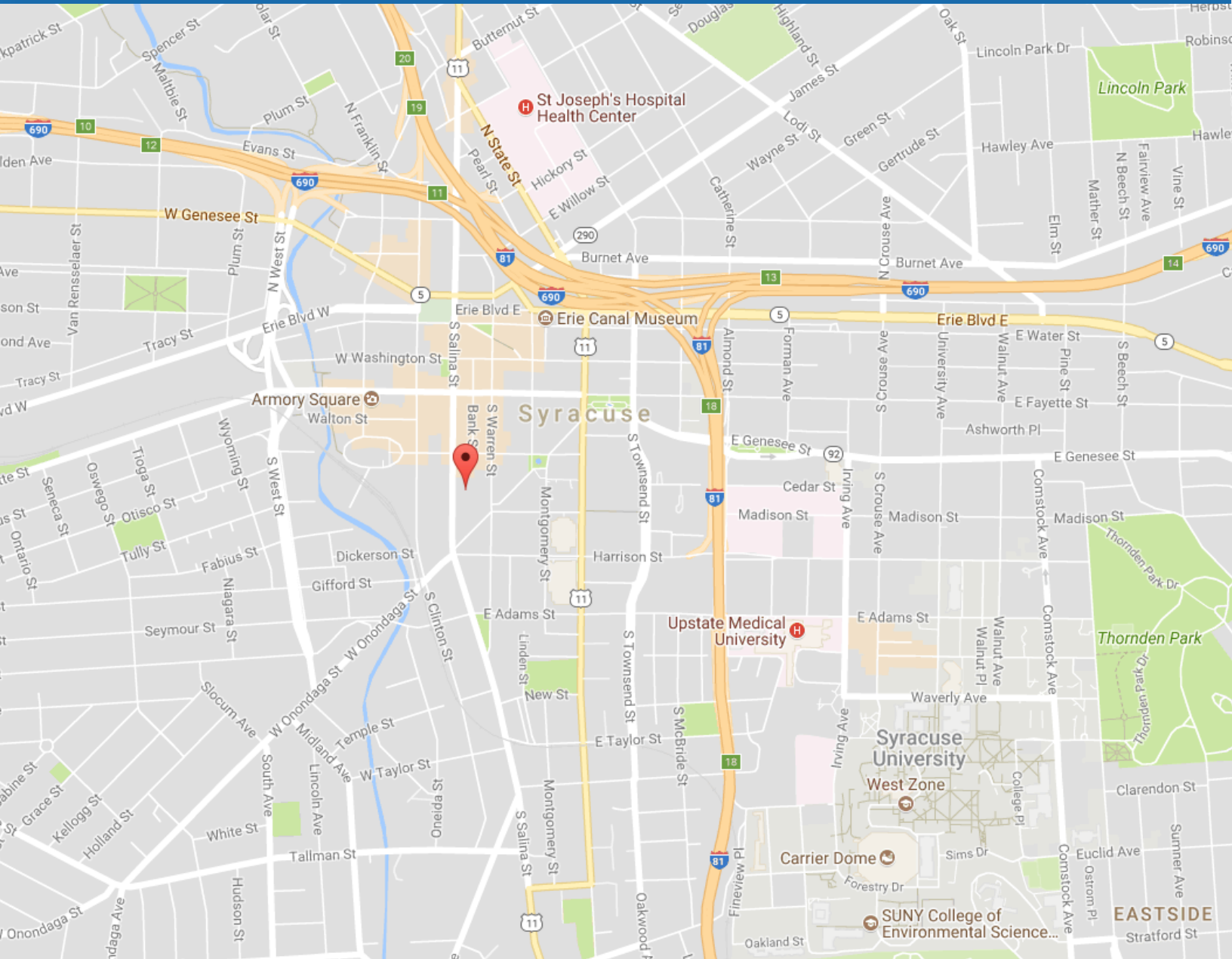

**FOR MORE  
INFORMATION  
CONTACT**

**Greg Cleghorn**

**315.579.0048**

**[gcleghorn@bellcornerstone.com](mailto:gcleghorn@bellcornerstone.com)**

CornerStone REO, LLC | 120 Walton Street, Ste. 400 | Syracuse, NY 13202