

# 711 THIRD AVENUE

SE CORNER OF EAST 45th STREET | MIDTOWN EAST





# 711 THIRD AVENUE

SE CORNER OF EAST 45th STREET | MIDTOWN EAST

## PROPERTY HIGHLIGHTS

### Prime retail in the heart of Midtown East

- Formerly *Santander Bank*
- All uses considered
- Space can be divided
- Situated at the base of 600,000 SF office tower
- Located just one block east of Grand Central Station district

### SIZE

Space A (Corner):  
2,308 SF Ground Floor

Space B (Inline):  
2,111 SF Ground Floor

### ASKING RENT

Upon Request

### POSSESSION

Immediate

### FRONTAGE

Space A: 127' Wraparound  
Space B: 23'

### TRANSPORTATION

S 4 5 6 7

CONTACT OUR BROKERS FOR MORE INFORMATION:

**ALBERT MANOPLA**  
AManopla@ksrny.com  
212.380.8369

**MARC SITT**  
MSitt@ksrny.com  
917.757.8863

**DOREL MELLOUL**  
DMelloul@ksrny.com  
347.922.4563

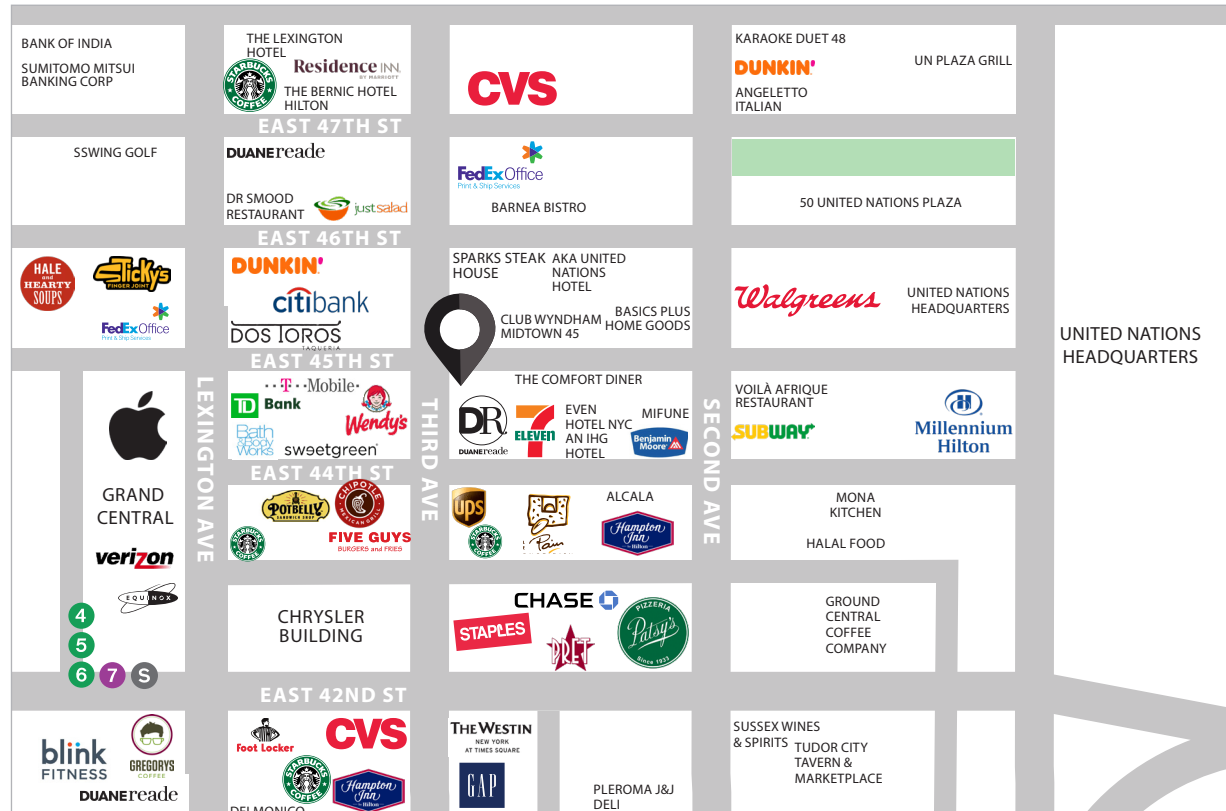

All information supplied in this marketing presentation and/or flyer is from sources deemed reliable and is furnished subject to errors, omissions, modifications, removal of listings from sale/lease and to any listing condition. Any square footage, dimensions, floor plans and/or technical data set forth are approximations and are subject to further elaboration/confirmation.

FLOOR PLAN:  
SINGLE TENANT PLAN

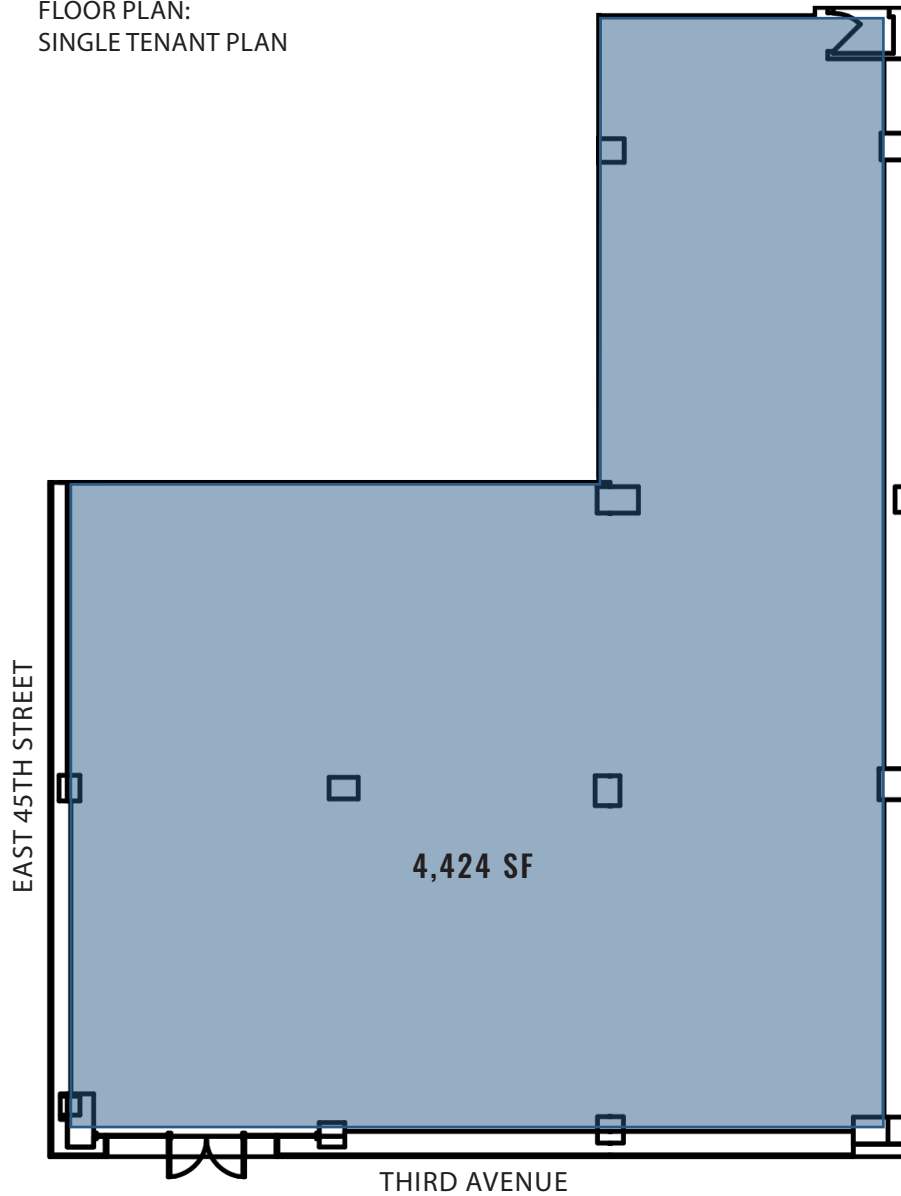

MULTI-TENANT PLAN

